



City Council Staff Report

Date: March 6, 2013 CONSENT CALENDAR

Subject: APPROVAL OF PLANS, SPECIFICATIONS AND ESTIMATE (PS&E)
AND AUTHORIZATION TO BID FOR THE 2012/2013 ANNUAL SLURRY
SEAL, CITY PROJECT 13-02

From: David H. Ready, City Manager

Initiated by: Public Works and Engineering Department

SUMMARY

The Public Works and Engineering Department schedules an annual slurry seal of various City streets. It is intended that every City street receive a slurry seal approximately every 5 to 7 years. The construction documents (Plans, Specifications and Estimate) are completed and, in accordance with 7.03.040 of the Procurement and Contracting Code the Council is required to approve and adopt plans, specifications and working details, and authorize the bid request for all public projects in excess of \$100,000. Approval of this project will allow staff to proceed with this public project, with an estimated cost of \$586,000.

RECOMMENDATION:

Approve the specifications and working details for the 2012/2013 Annual Slurry Seal, City Project 13-02, and authorize staff to advertise and solicit bids.

STAFF ANALYSIS:

The Public Works Department oversees the maintenance of the City's street system. Each year the Department assembles a capital project to continue its Slurry Seal Program on various City streets. The intention of the Slurry Seal Program is to provide a slurry seal within 5 to 7 years on every City street. This year's slurry seal project is funded by Measure J and consists of various streets throughout the City with a total anticipated application of 2,055,506 square feet. A complete listing of streets and maps of these areas are included in Attachment 1.

The slurry seal specifications have been prepared by Department staff, are ready for Council approval and the subsequent advertisement for construction bids.

Section 7.03.040 of the Procurement and Contracting Code requires that for public projects in excess of \$100,000 Council approve and adopt the plans, specifications and working details, and authorize staff to advertise for construction bids. The Engineer's Estimate for this project is \$586,000. Approval of the recommended action will allow staff to proceed with bidding of this project.

FISCAL IMPACT:

Funding for this project is made available through local Measure J funds in account 260-4493-50807.

SUBMITTED:

Prepared by:

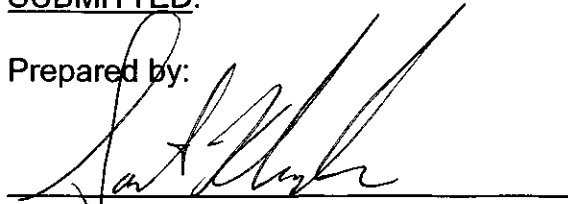

Savat Khamphou
Assistant Director of Public Works

Recommended by:



David J. Barakian
Director of Public Works/City Engineer

Approved by:

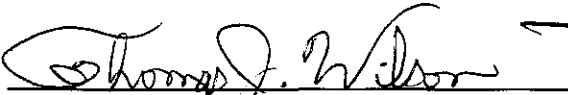

Thomas J. Wilson, Asst. City Manager

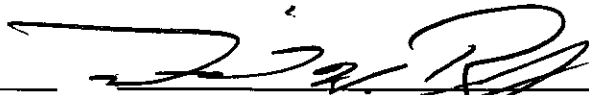

David H. Ready, City Manager

Attachments:

1. Street Listing and Maps

\$500K FOR 2013 SLURRY ROAD REHAB - PCI RANGE 80-99 (3.3M BUDGET)

Name	Section ID	From	To	Length	Width	True Area	Area Units	PCI
WHITWATER CLUB DRIVE	1-4-4-155	VERONA ROAD	VIA ESCUELA	1,263.00	32	40,416	SqFt	80
WHITWATER CLUB DRIVE	1-4-4-160	VIA ESCUELA	VISTA CHINO	1,271.00	32	40,672	SqFt	80
VENETIA ROAD	1-4-4-180	VIMINAL ROAD	VOLTURNO ROAD	925	24	22,200	SqFt	80
VALENCIA ROAD	1-4-4-185	VOLTURNO ROAD	VIMINAL ROAD	921	24	22,104	SqFt	77
VENTURA ROAD	1-4-4-190	VIMINAL ROAD	VOLTURNO ROAD	924	24	22,176	SqFt	80
VINCENTIA ROAD	1-4-4-225	VOLTURNO ROAD	VIMINAL ROAD	937	24	22,488	SqFt	80
VIMINAL ROAD	1-4-4-230	VINCENTIA ROAD	VIA ESCUELA	989	24	23,736	SqFt	80
WEST ACACIA ROAD	1-4-4-315	MAGNOLIA ROAD	VIA ESCUELA	620	24	14,880	SqFt	80
ACACIA ROAD	1-4-4-310	VICTORIA ROAD	MAGNOLIA ROAD	240	24	5,760	SqFt	86
EAST ACACIA ROAD	1-4-4-305	VIA ESCUELA	VICTORIA ROAD	615	24	14,760	SqFt	83
WEST NICOLA ROAD	1-4-4-360	DEBORAH ROAD	VIA ESCUELA	625	24	15,000	SqFt	80
NICOLA ROAD	1-4-4-355	SANDRA ROAD	DEBORAH ROAD	237	24	5,688	SqFt	83
EAST NICOLA ROAD	1-4-4-350	VIA ESCUELA	SANDRA ROAD	614	24	14,736	SqFt	83
VIA ESCUELA	1-4-4-440	SUNRISE WAY	FARRELL DRIVE	2,609.00	32	83,488	SqFt	80
VIA ESCUELA	1-4-4-445	FARRELL DRIVE	130' E OF WHITWATER	2,633.00	32	84,256	SqFt	80
ANDREAS HILLS DRIVE	1-5-4-010	REDFORD DRIVE	BOGERT TRAIL	1,950.00	40	77,322	SqFt	80
ANDREAS HILLS DRIVE	1-5-4-050	REDFORD DRIVE	BOGERT TRAIL	1,100.00	40	44,362	SqFt	80
CABRILLO ROAD	3-4-4-355	VISTA GRANDE AVENUE	GIRASOL AVENUE	282	24	6,768	SqFt	76
GIRASOL AVENUE	3-4-4-345	CABRILLO ROAD	VISTA GRANDE	975	23	23,386	SqFt	77
GIRASOL COURT	3-4-4-390	GIRASOL AVENUE	W END	236	28	8,334	SqFt	80
VISTA GRANDE AVENUE	3-4-4-350	GIRASOL AVENUE	CABRILLO ROAD	834	24	20,016	SqFt	79
BIRD CENTER LANE	7-4-5-100	TACHEVAH DRIVE	N END	898	48	43,104	SqFt	80
TACHEVAH DRIVE	7-4-5-105	GENE AUTRY TRAIL	BIRD CENTER LANE	503	48	24,144	SqFt	77
CAMINO CENTRO	10-4-4-300	N VIA LAS PALMAS	S VIA LAS PALMAS	400	25	8,696	SqFt	80
AVENIDA CABALLEROS	14-4-4-040	RAMON ROAD	TAHQUITZ CANYON WAY	2,565	60	147,600	SqFt	80
AMADO ROAD	14-4-4-056	CALLE ENCILIA	CALLE EL SEGUNDO	575	60	34,500	SqFt	80
ANDREAS ROAD	14-4-4-185	CALLE ENCILIA	CALLE EL SEGUNDO	512	60	30,720	SqFt	80
ANDREAS ROAD	14-4-4-190	CALLE EL SEGUNDO	CALLE ALVARADO	705	23	16,215	SqFt	80
19TH AVENUE	15-3-4-001	500' WEST OF INDIAN AVENUE	WEST END	2,073.00	30	62,190	SqFt	80
MCLANE STREET	15-3-4-020	ORR WAY	19TH AVENUE	1,291	52	67,132	SqFt	91
NEWHALL STREET	15-3-4-025	ORR WAY	19TH AVENUE	1,257	52	65,364	SqFt	91
RUPPERT STREET	15-3-4-030	20TH AVENUE	19TH AVENUE	1,692	60	101,520	SqFt	91
ORR WAY	15-3-4-035	NEWHALL STREET	MCLANE STREET	2,573	52	133,796	SqFt	91
CROSSLEY ROAD	20-4-5-005	34TH AVENUE	DINAH SHORE DRIVE	2,775.00	52	154,892	SqFt	80
RAMON ROAD	20-4-5-100	GENE AUTRY ROAD	SAN LUIS REY DRIVE	1,277.00	80	101,896	SqFt	80
CAMINO CALIDAD	22-4-4-000	RAMON ROAD	S END	460	31	17,206	SqFt	72
BARONA ROAD	25-4-4-005	E PALM CANYON DRIVE	800' S OF E PALM CANYON DRIVE	800.00	60	48,000	SqFt	80
BARONA ROAD	25-4-4-010	800' S OF E PALM CANYON DRIVE	130' N OF MORONGO TRAIL	350	44.5	15,575	SqFt	80
BARONA ROAD	25-4-4-015	130' N OF MORONGO TRAIL	JACARANDA ROAD	1,280.00	29	37,120	SqFt	81
BARONA ROAD	25-4-4-020	JACARANDA ROAD	S END	830	31	25,730	SqFt	80
JACARANDA ROAD	25-4-4-025	BARONA ROAD	E END	1,140.00	36	42,597	SqFt	86
CONCHO LANE	25-4-4-030	JACARANDA ROAD	N END	166	33	7,956	SqFt	80
34TH AVENUE	20-4-5-115	GOLF CLUB DRIVE	260' W OF LAWRENCE STREET	1,570	28	43,960	SqFt	80
MARGUERITE STREET	29-4-5-025	34TH AVENUE	MARTHA STREET	1,280.00	32	39,742	SqFt	80
MARTHA STREET	29-4-5-030	MARGUERITE STREET	LAWRENCE STREET	355	32	12,032	SqFt	76
LAWRENCE STREET	29-4-5-035	MARTHA STREET	34TH AVENUE	1,280.00	32	39,742	SqFt	80
BOB O' LINK LANE	29-4-5-065	BRENTWOOD DRIVE	CHERRY HILLS DRIVE	2,190.00	32	70,102	SqFt	80
CHEROKEE WAY	30-4-5-045	E PALM CANYON DRIVE	MATTHEW DRIVE	930	46	41,427	SqFt	80
						2,055,506	SqFt	81

Avg PCI

03

CITY OF PALM SPRINGS SECTION 1-T4S-R4E

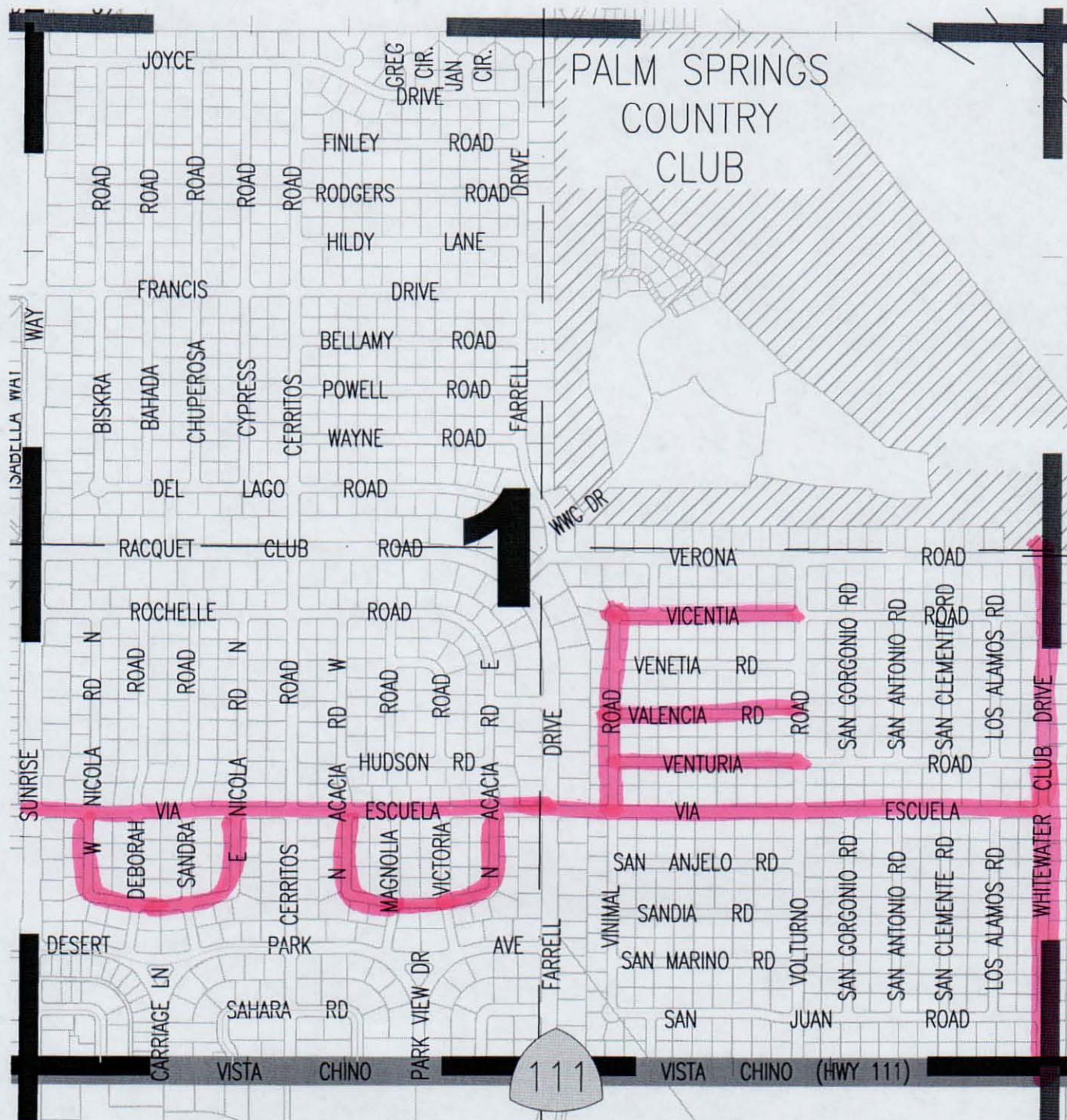

CITY OF PALM SPRINGS
SECTION 1-T5S-R4E

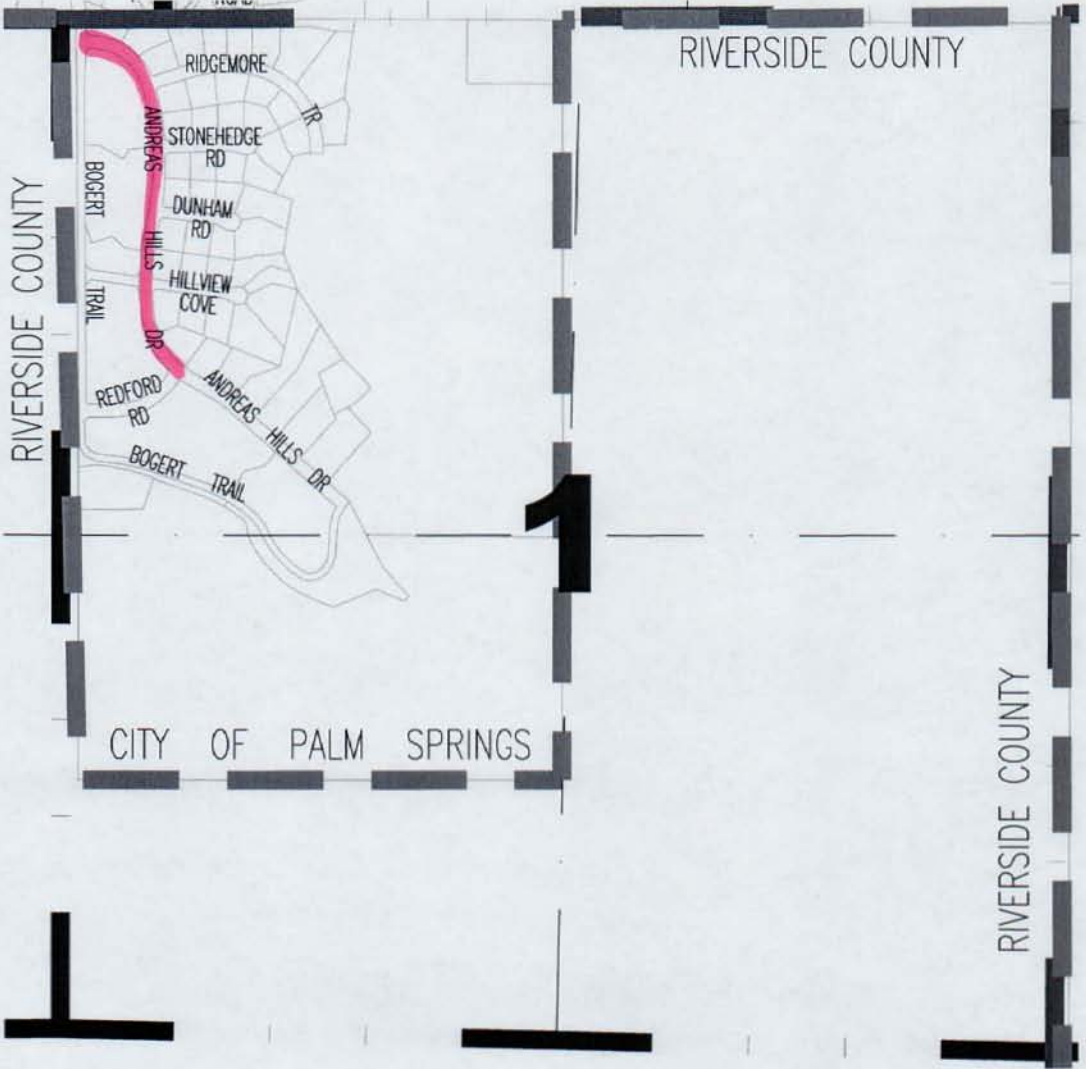

CITY OF PALM SPRINGS SECTION 3-T4S-R4E



CITY OF PALM SPRINGS
SECTION 7-T4S-R4E



CITY OF PALM SPRINGS
SECTION 10-T4S-R4E

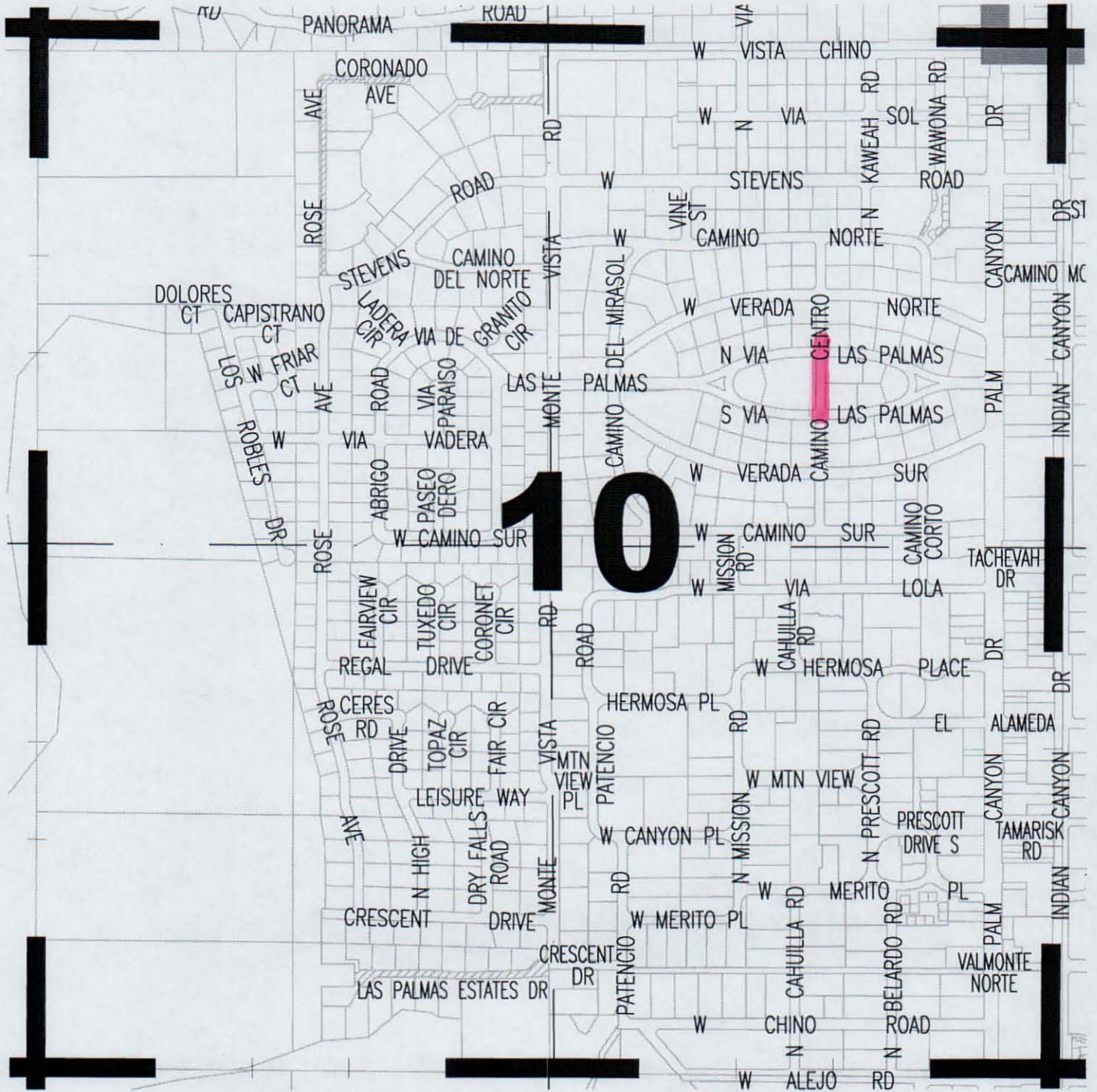

CITY OF PALM SPRINGS
SECTION 14-T4S-R4E

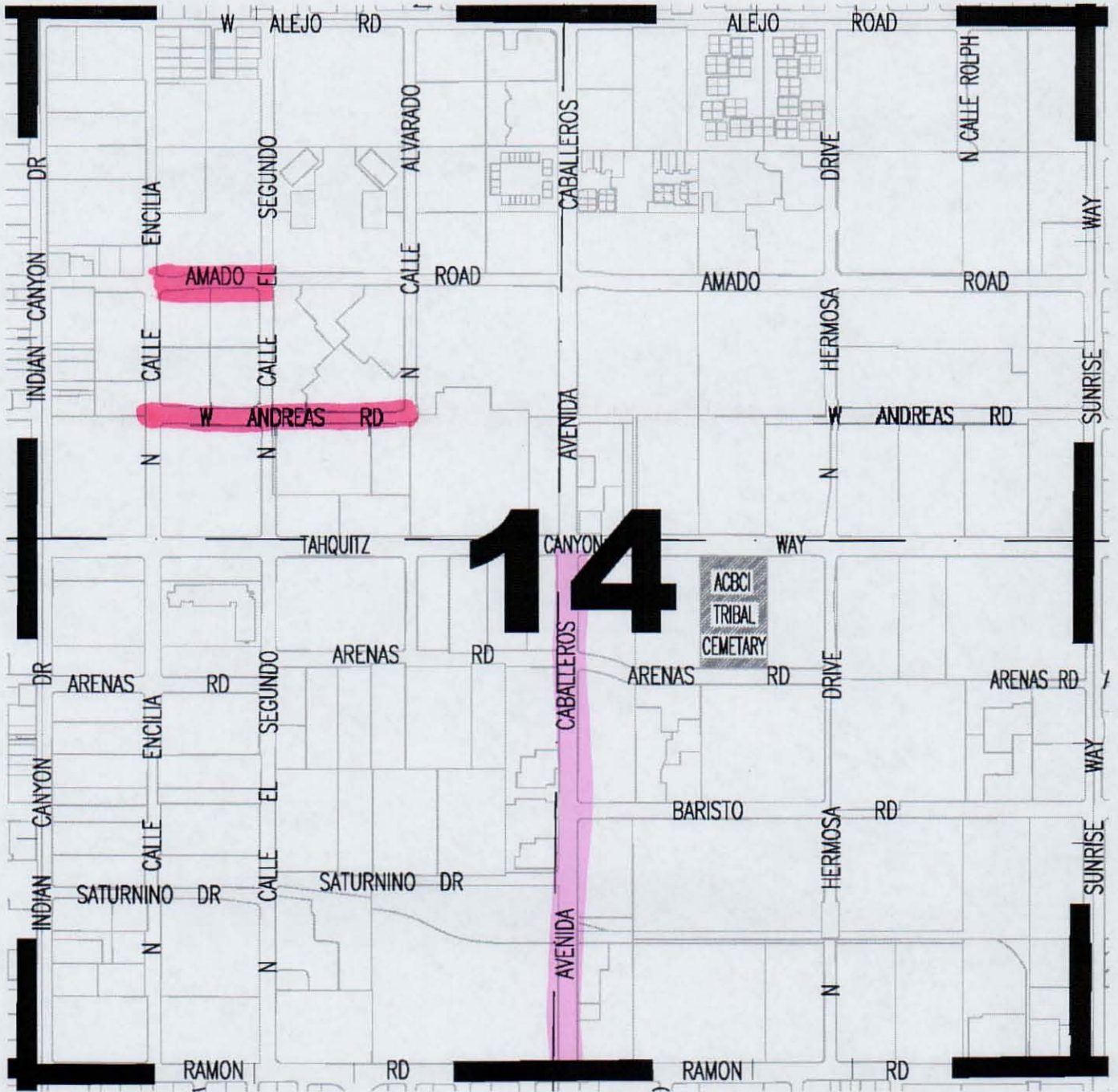

CITY OF PALM SPRINGS
SECTION 15-T3S-R4E

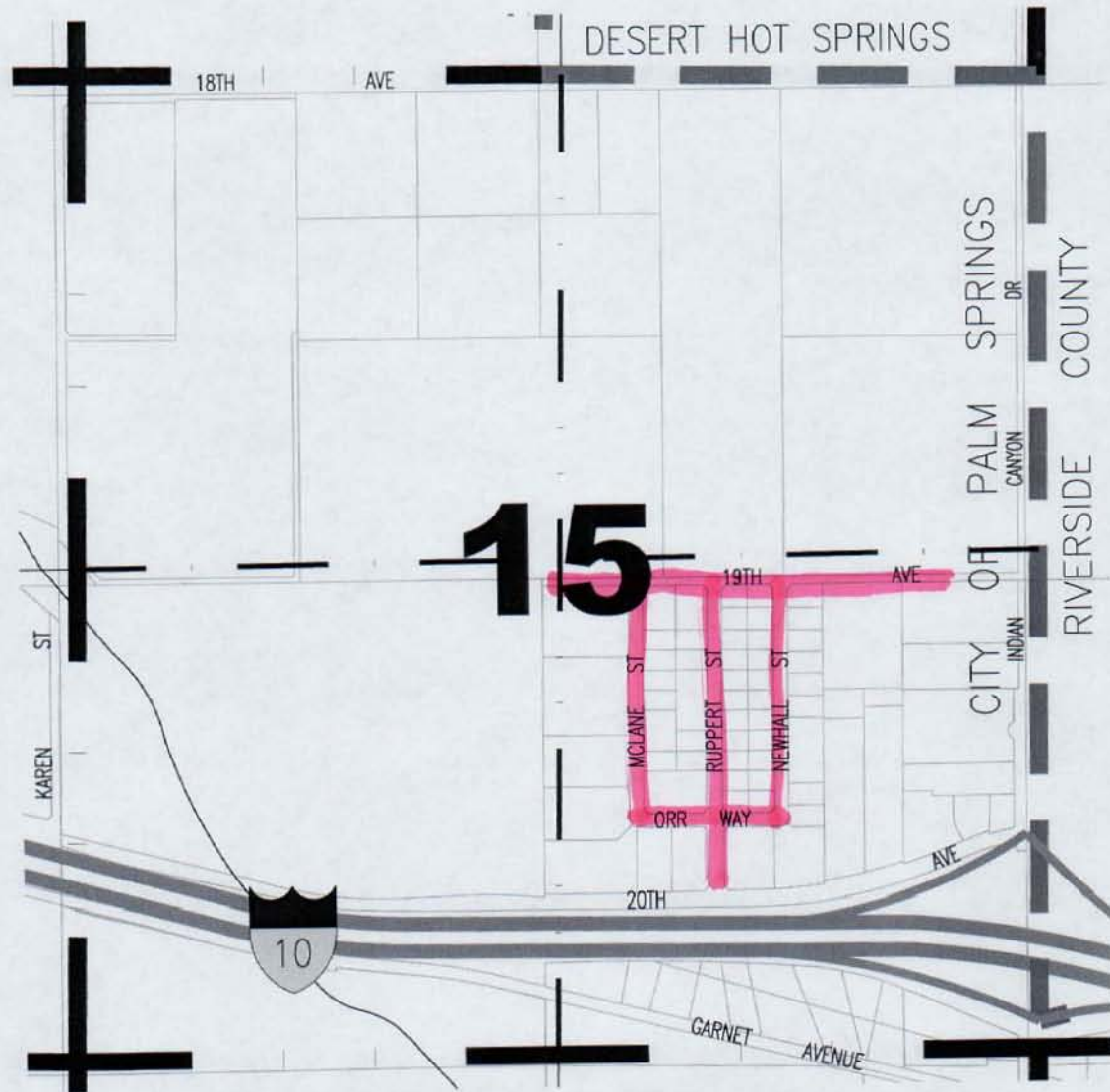

CITY OF PALM SPRINGS
SECTION 20-T4S-R5E

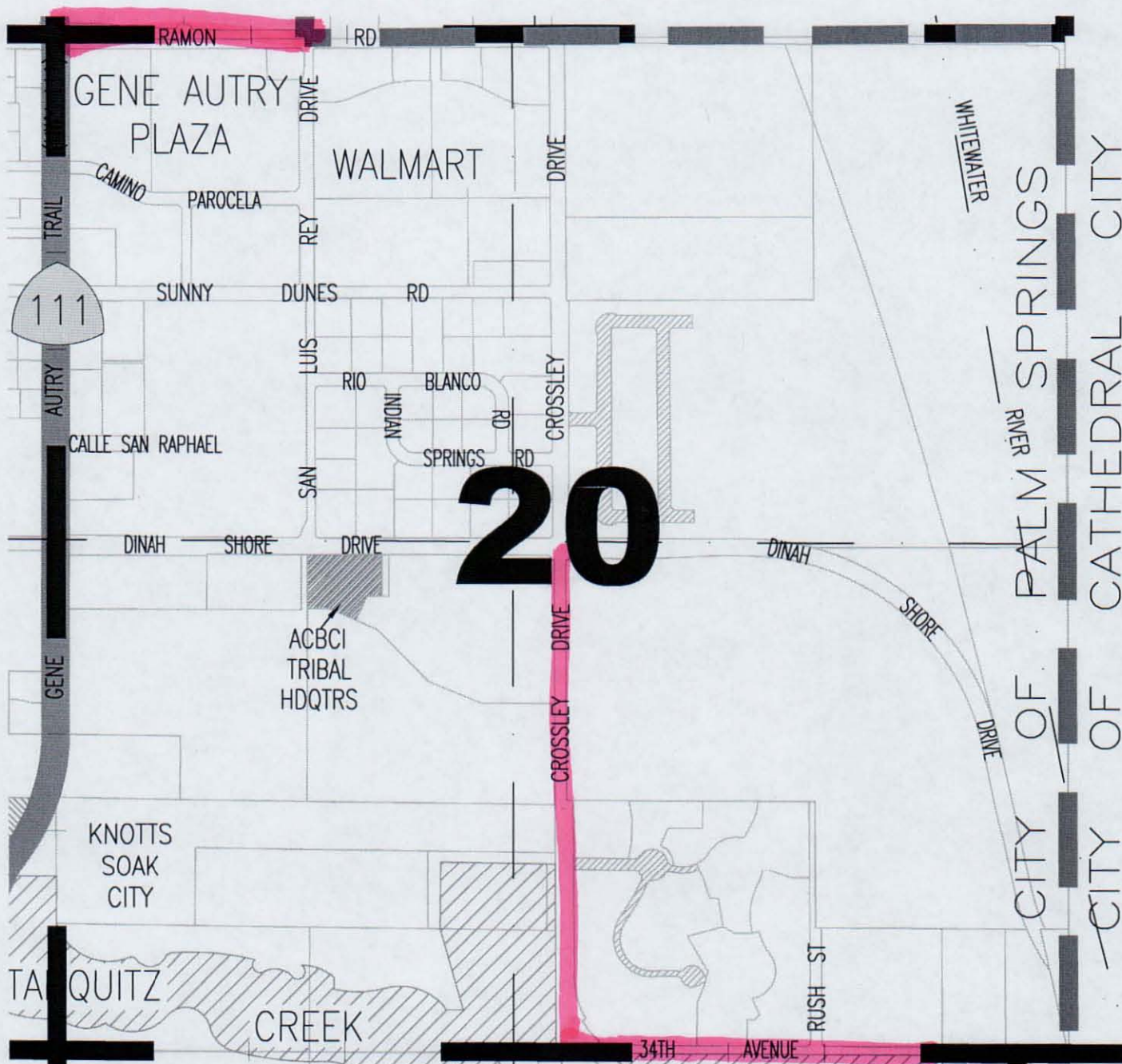

CITY OF PALM SPRINGS
SECTION 22-T4S-R4E

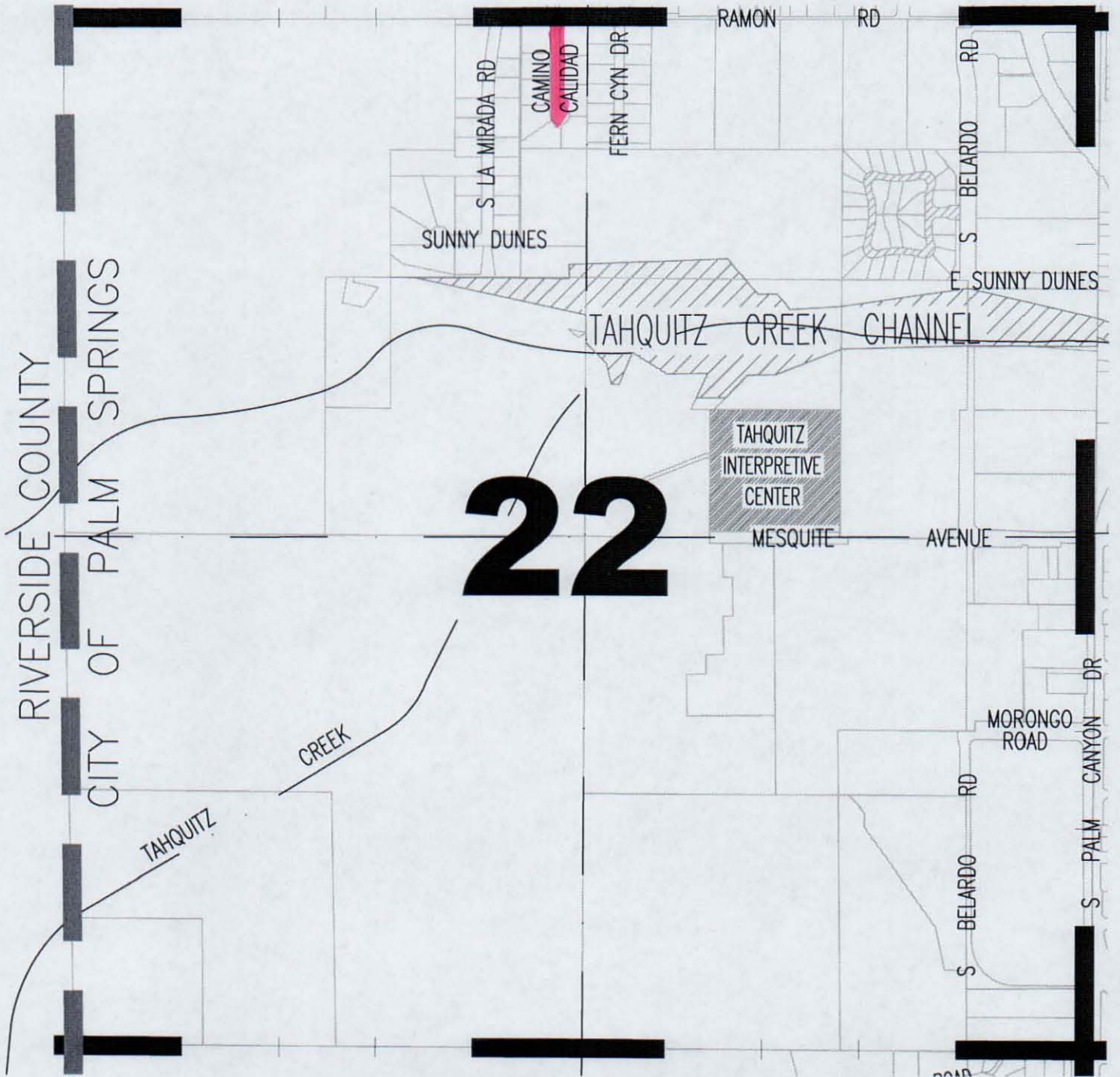

CITY OF PALM SPRINGS
SECTION 25-T4S-R4E

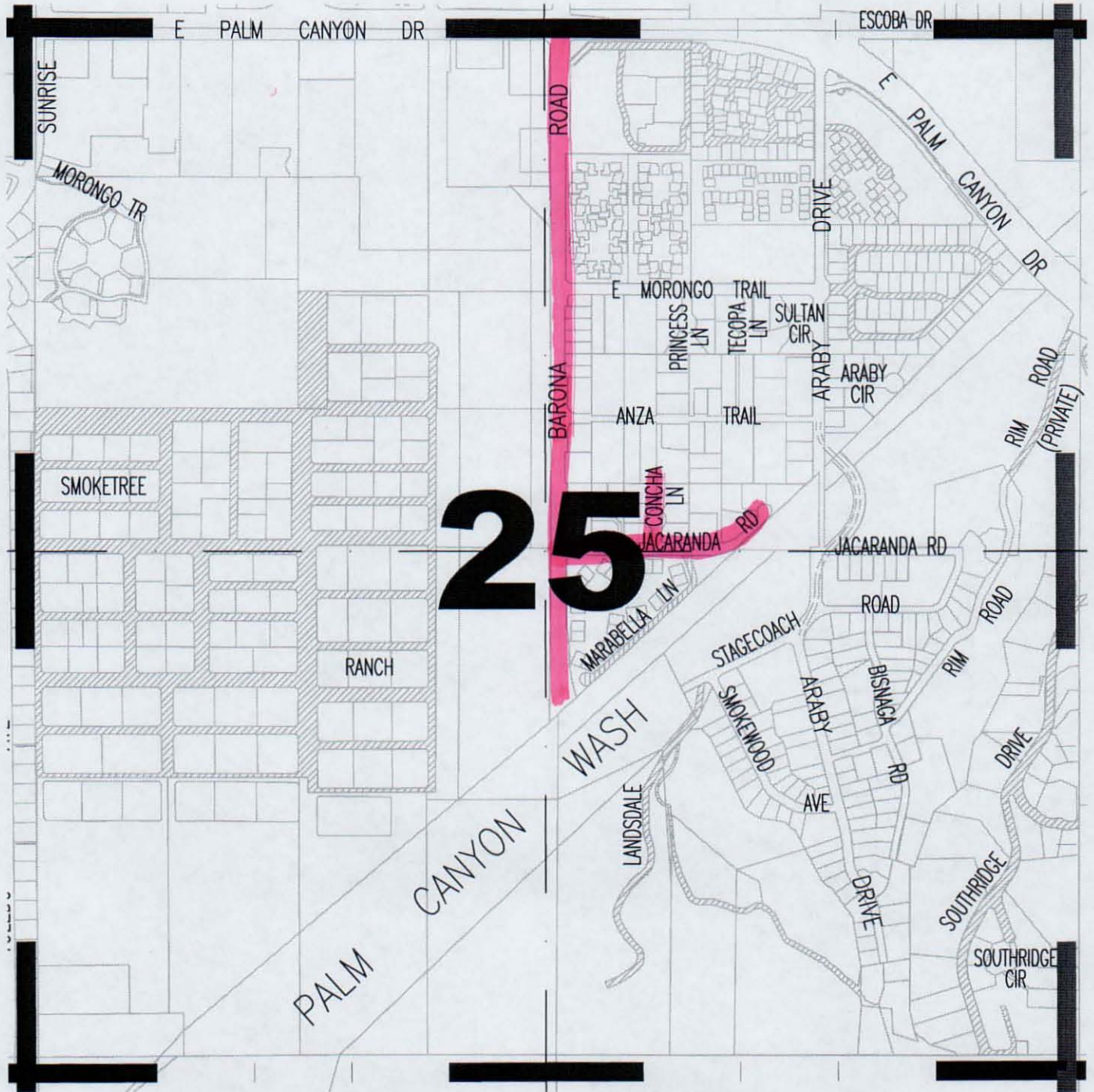

CITY OF PALM SPRINGS
SECTION 29-T4S-R5E

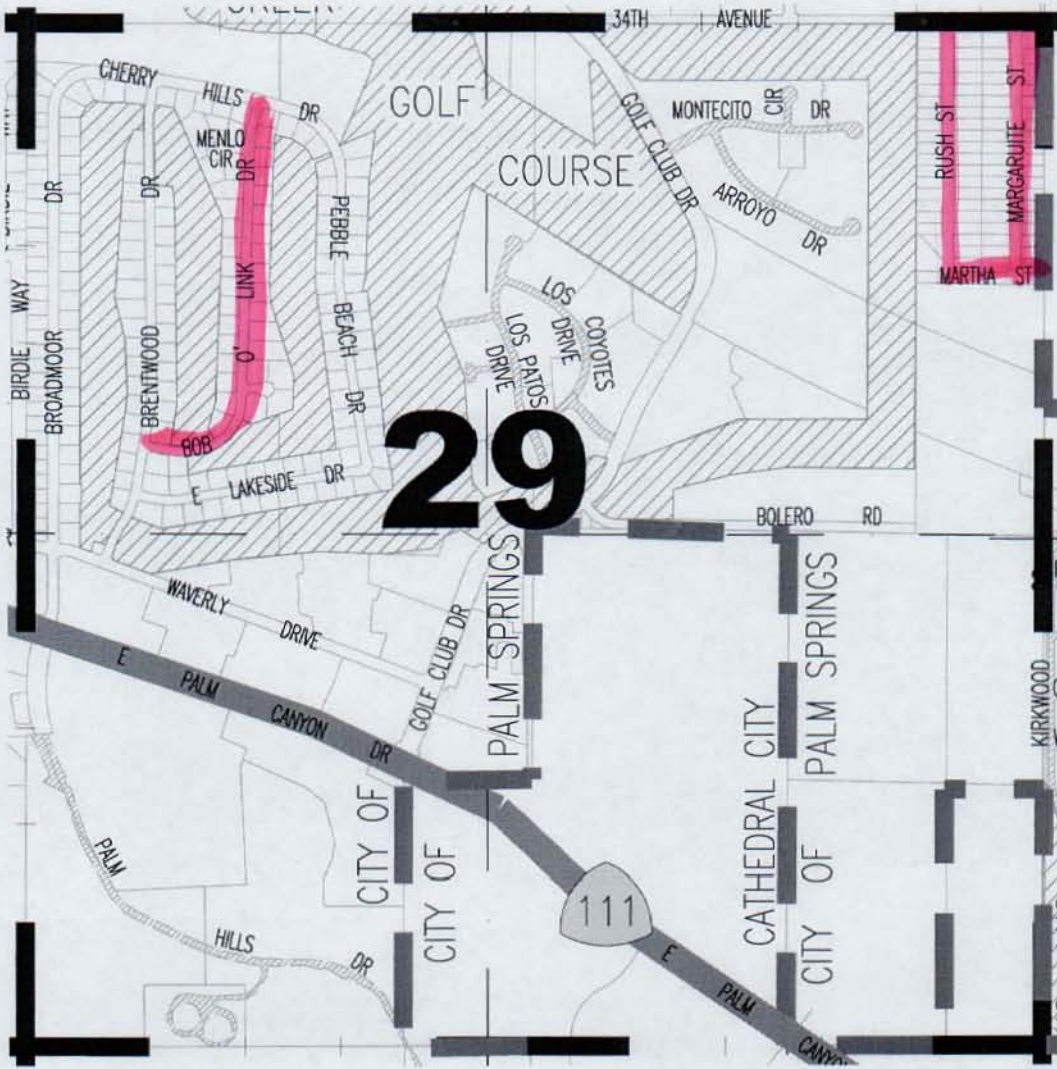

CITY OF PALM SPRINGS
SECTION 30-T4S-R5E

