



## City Council Staff Report

Date: March 5, 2014 CONSENT CALENDAR

Subject: APPROVAL OF PLANS, SPECIFICATIONS AND ESTIMATE (PS&E)  
AND AUTHORIZATION TO BID FOR THE 2013/2014 ANNUAL SLURRY  
SEAL, CITY PROJECT NO. 14-03.

From: David H. Ready, City Manager

Initiated by: Public Works and Engineering Department

---

### SUMMARY

The Public Works and Engineering Department schedules an annual slurry seal of various City streets. It is intended that every City street receive a slurry seal approximately every 5 to 7 years. The construction documents (Plans, Specifications and Estimate) are completed and, in accordance with 7.03.040 of the Procurement and Contracting Code the Council is required to approve and adopt plans, specifications and working details, and authorize the bid request for all public projects in excess of \$100,000. Approval of this project will allow staff to proceed with this public project, with an estimated cost of approximately \$405,400.

### RECOMMENDATION:

Approve the specifications and working details for the 2013/2014 Annual Slurry Seal, City Project 14-03, and authorize staff to advertise and solicit bids.

### STAFF ANALYSIS:

The Public Works and Engineering Department oversees the maintenance of the City's street system. Each year, the Department assembles a capital project to continue its Slurry Seal Program on various City streets. The intention of the Slurry Seal Program is to provide a slurry seal within 5 to 7 years on every City street.

This slurry seal project is funded by Measure A and consists of various streets throughout the City with a total anticipated application of approximately 1,560,000 square feet.

A complete listing of streets and maps of these areas are included in Attachment 1.

The City intends to move forward with this important street maintenance project for the listed areas, with an expectation of construction occurring by May 2014. Deferring this project until summer is not possible, as there are limitations on the maximum ambient temperature for installation of slurry seal.

The slurry seal specifications have been prepared by the Public Works and Engineering Department staff, are ready for Council approval, and the subsequent advertisement for construction bids.

Section 7.03.040 of the Procurement and Contracting Code requires that for public projects in excess of \$100,000 Council approve and adopt the plans, specifications and working details, and authorize staff to advertise for construction bids. The Engineer's Estimate for this project is \$405,400. Approval of the recommended action will allow staff to proceed with bidding of this project.

FISCAL IMPACT:

Funding for this project is made available through local Measure A funds in account 134-4498-50100.

SUBMITTED:

Prepared by:



Savat Khamphou  
Assistant Director of Public Works

Recommended by:



David J. Barakian  
Director of Public Works/City Engineer

Approved by:

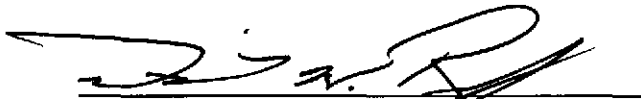

David H. Ready, City Manager

Attachments:

1. Street Listing and Maps

## MEASURE A PAVEMENT REHAB CITY STREETS - 2014 \$450K BUDGET (CP 14-03)

PCI Range	Rehab Type	\$450K BUDGET	Pavement SF	Cost Per Unit	Sub-Total
80-90	Slurry	\$450K	1,559,098	\$ 0.26	\$ 405,365
<b>Contingency, Administration, &amp; Inspection Costs 10%</b>					<b>\$ 45,000</b>
<b>Grand Total:</b>					<b>\$ 450,365</b>

### ROAD SLURRY - PCI RANGE 80-90

Name	Section ID	From	To	Length	Width	True Area	Area Units	PCI	Section Cost
CALLE SAN RAPHAEL	2045000	GENE AUTRY TRAIL	E END	430	64	26,600 SqFt		83	\$ 6,916
SAN LUIS REY DRIVE	2045035	DINAH SHORE DRIVE	SUNNY DUNES ROAD	1,260	22	30,120 SqFt		80	\$ 7,831
SAN LUIS REY DRIVE	2045040	SUNNY DUNES ROAD	RAMON ROAD	1,250	54	65,985 SqFt		83	\$ 17,156
CAMINO PAROCOLA	2045080	SAN LUIS REY DRIVE	GENE AUTRY TRAIL	1,280	46	58,374 SqFt		83	\$ 15,177
SUNNY DUNES ROAD	2045085	GENE AUTRY TRAIL	420' E OF GENE AUTRY TRAIL	420	48	20,160 SqFt		83	\$ 5,242
SUNNY DUNES ROAD	2045086	420' E OF GENE AUTRY TRAIL	SAN LUIS REY ROAD	1,269	29	27,324 SqFt		86	\$ 7,104
SUNNY DUNES ROAD	2045090	SAN LUIS REY DRIVE	CROSSLEY ROAD	1,132	36	40,752 SqFt		86	\$ 10,596
ARABY DRIVE	2544055	E PALM CANYON DRIVE	MORONGO ROAD	1,165	37	43,105 SqFt		83	\$ 11,207
ARABY DRIVE	2544060	MORONGO ROAD	ARABY CIRCLE	475	36	17,100 SqFt		85	\$ 4,446
ARABY DRIVE	2544065	ARABY CIRCLE	N SIDE OF WASH	373	30	11,190 SqFt		87	\$ 2,909
PRINCESS CIRCLE	2544047	MORONGO ROAD	S END	200	28	8,712 SqFt		75	\$ 2,265
SULTAN CIRCLE	2544048	ARABY DRIVE	W END	120	28	6,185 SqFt		75	\$ 1,608
GOLF CLUB DRIVE	2945005	STATE HWY 111 (E PALM CYN)	34TH AVENUE	4,500	64	284,000 SqFt		80	\$ 73,840
CREE ROAD	2945020	GOLF CLUB DRIVE	CAREY ROAD	510	32	19,282 SqFt		76	\$ 5,013
CREE ROAD	2945021	CAREY ROAD	JONES STREET	475	25	17,415 SqFt		76	\$ 4,528
BRENTWOOD DRIVE	2945080	CHERRY HILLS DRIVE	WAVERLY DRIVE	2,487	32	79,584 SqFt		78	\$ 20,692
WAVERLY DRIVE	2945040	WAVERLY DRIVE	BROADMOOR DRIVE	2,026	36	72,936 SqFt		76	\$ 18,963
BROADMOOR DRIVE	2945045	WAVERLY	CHERRY HILLS DRIVE	2,347	36	84,525 SqFt		78	\$ 21,977
BROADMOOR DRIVE	2945046	WAVERLY	STATE HWY III	406	36	14,630 SqFt		76	\$ 3,804
CHERRY HILLS DRIVE	2945050	BROADMOOR ROAD	BOB O'LINK	1,230	28	34,440 SqFt		84	\$ 8,954
PEBBLE BEACH DRIVE	2945055	CHERRY HILLS DRIVE	LAKESIDE DRIVE	1,655	32	52,960 SqFt		75	\$ 13,770
LAKESIDE DRIVE	2945060	PEBBLE BEACH DRIVE	BRENTWOOD DRIVE	1,241	32	39,742 SqFt		77	\$ 10,333
OSWEGO CIRCLE	2945070	BOB O'LINK LANE	E END	150	32	7,380 SqFt		76	\$ 1,919
LINDEN WAY	3045035	EAST PALM CANYON DRIVE	SEVEN LAKES DRIVE	1,158	37	43,749 SqFt		77	\$ 11,375
EAST PALM CANYON FRONTAGE ROAD	3045110	LINDEN WAY	E END	560	30	18,818 SqFt		80	\$ 4,893
EAGLE WAY	3045095	BIRDIE WAY	GENE AUTRY TRAIL	479	37	17,723 SqFt		73	\$ 4,608
SEVEN LAKES DRIVE	3045060	CHEROKEE WAY	CANYON SANDS ENTRANCE	1,500	36	54,000 SqFt		80	\$ 14,040
WAVERLY DRIVE	3045070	BROADMOOR DRIVE	GENE AUTRY TRAIL	746	36	27,126 SqFt		80	\$ 7,053
MATTHEW DRIVE	3045050	CHEROKEE WAY	950' E OF LINDEN WAY	950	30	28,500 SqFt		78	\$ 7,410
MATTHEW DRIVE	3045055	950' E OF LINDEN WAY	EAST PALM CANYON DRIVE	525	60	24,611 SqFt		76	\$ 6,399
BIRDIE WAY	3045075	WAVERLY DRIVE	EAGLE WAY	1563	36	57,888 SqFt		80	\$ 15,051
BOGERT TRAIL	3544030	REDFORD DRIVE	ANDREAS HILLS	1,155	36	48,412 SqFt		89	\$ 12,587
BOGERT TRAIL	3544035	REDFORD DRIVE	ANDREAS HILLS DRIVE	2,070	32	65,835 SqFt		89	\$ 17,117
DUNHAM ROAD	154025	ANDREAS HILLS ROAD	E END	418	36	15,325 SqFt		83	\$ 3,985
HILLVIEW COVE	154015	BOGERT TRAIL	ANDREAS HILLS DRIVE	39	243	8,215 SqFt		76	\$ 2,136
HILLVIEW COVE	154020	ANDREAS HILLS DRIVE	E END	490	39	19,591 SqFt		76	\$ 5,094
REDFORD DRIVE	154005	BOGERT TRAIL	ANDREAS HILLS DRIVE	540	32	17,280 SqFt		76	\$ 4,493
RIDGEMORE DRIVE	154035	ANDREAS HILLS DRIVE	E END	1,100	32	35,648 SqFt		84	\$ 9,268
STONE HEDGE ROAD	154030	ANDREAS HILLS DRIVE	E END	464	28	13,876 SqFt		76	\$ 3,608
						<b>1,559,098 SqFt</b>		<b>80</b>	<b>\$ 405,365</b>
								<b>Avg PCI</b>	

CITY OF PALM SPRINGS  
 CP 14-03 SLURRY SEAL  
 MAP

SECTION 20-T4S-R5E

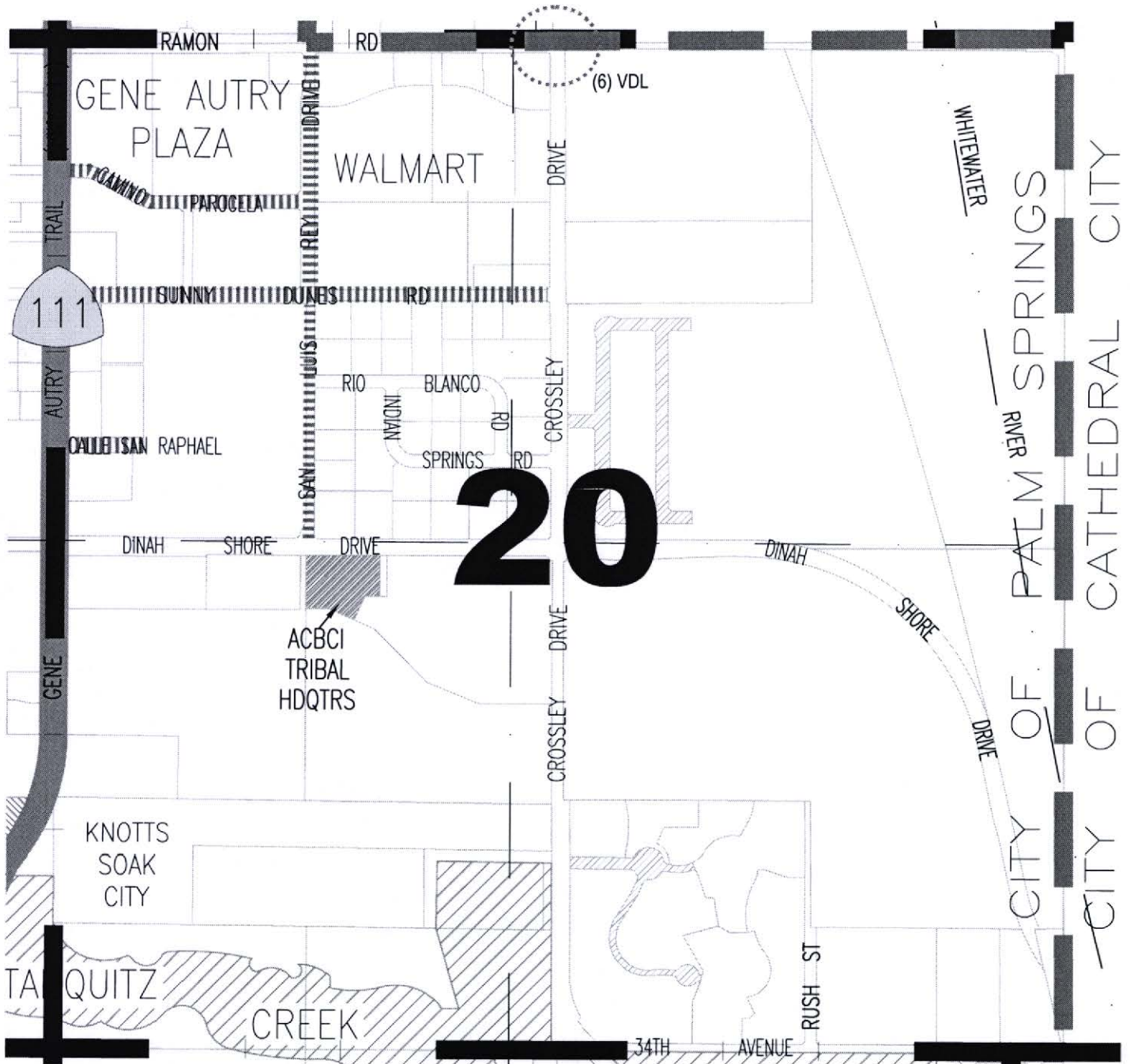

===== = 2014 SLURRY SEAL STREET  
 (#) VDL = NUMBER OR VEHICLE DETECTION LOOPS

CITY OF PALM SPRINGS  
CP 14-03 SLURRY SEAL  
MAP

SECTION 25-T4S-R4E

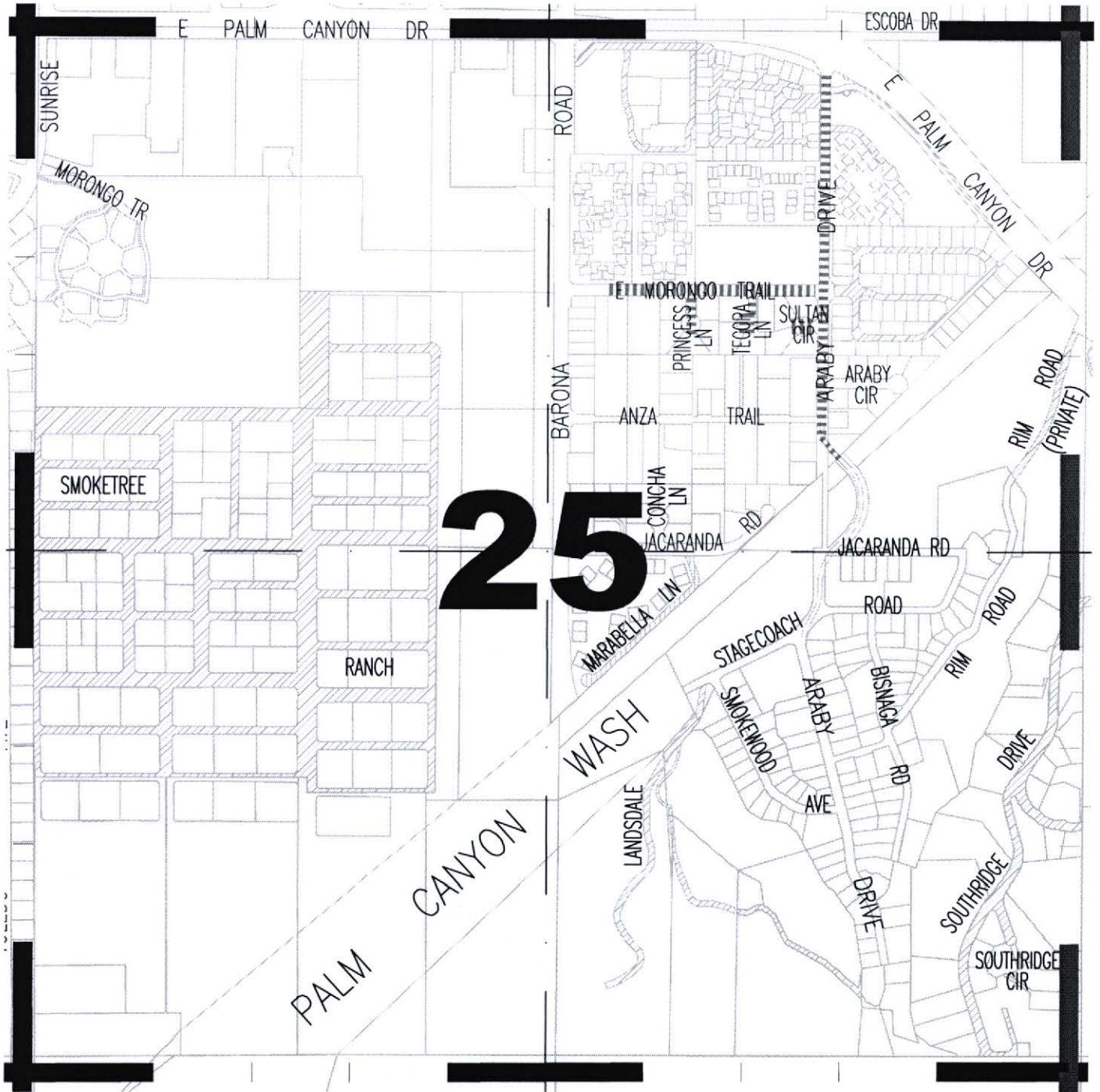

===== = 2014 SLURRY SEAL STREET

CITY OF PALM SPRINGS  
CP 14-03 SLURRY SEAL  
MAP

SECTION 29-T4S-R5E

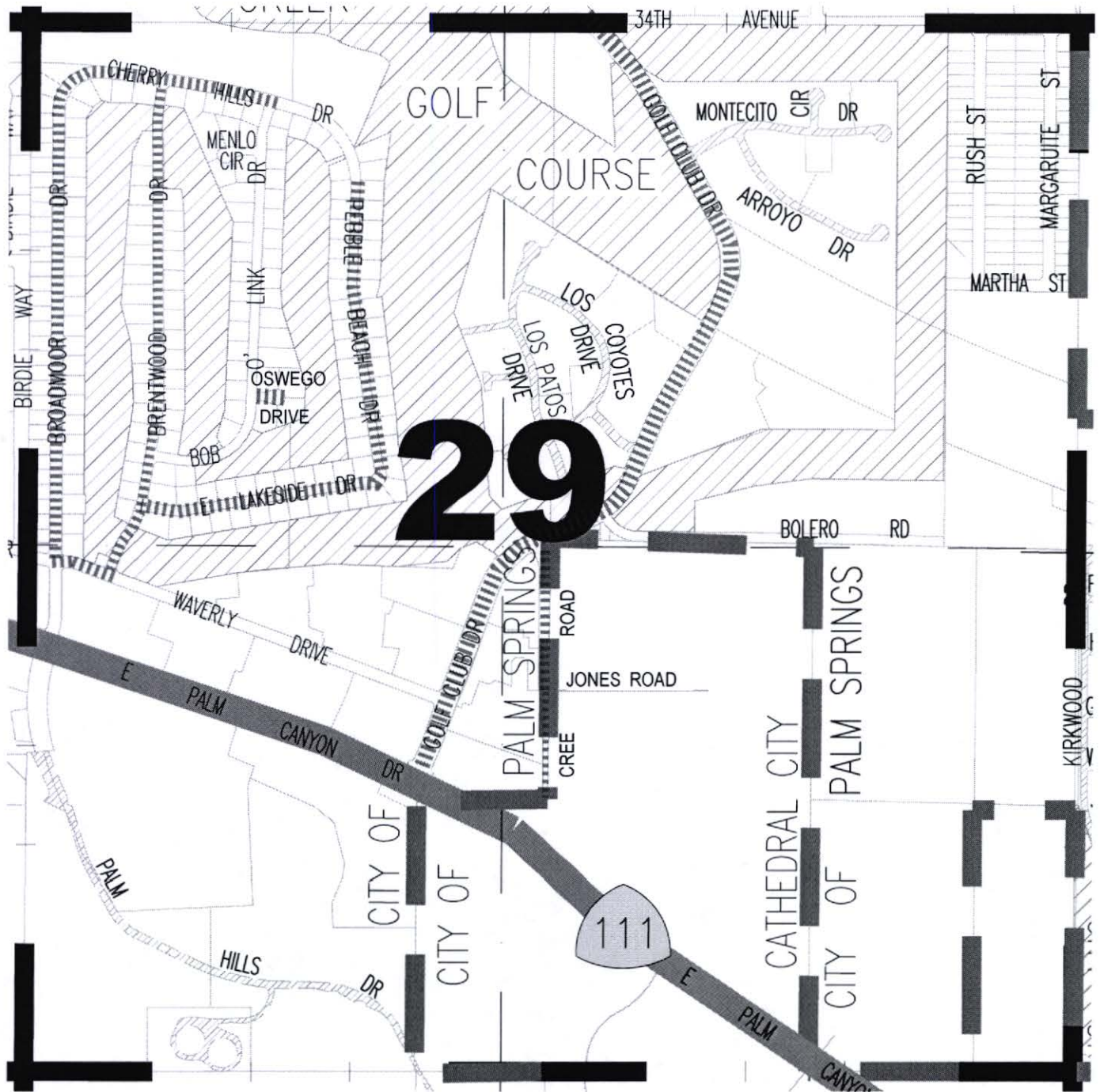

▨ = 2014 SLURRY SEAL STREET



CITY OF PALM SPRINGS  
CP 14-03 SLURRY SEAL  
MAP

SECTION 1-T5S-R4E

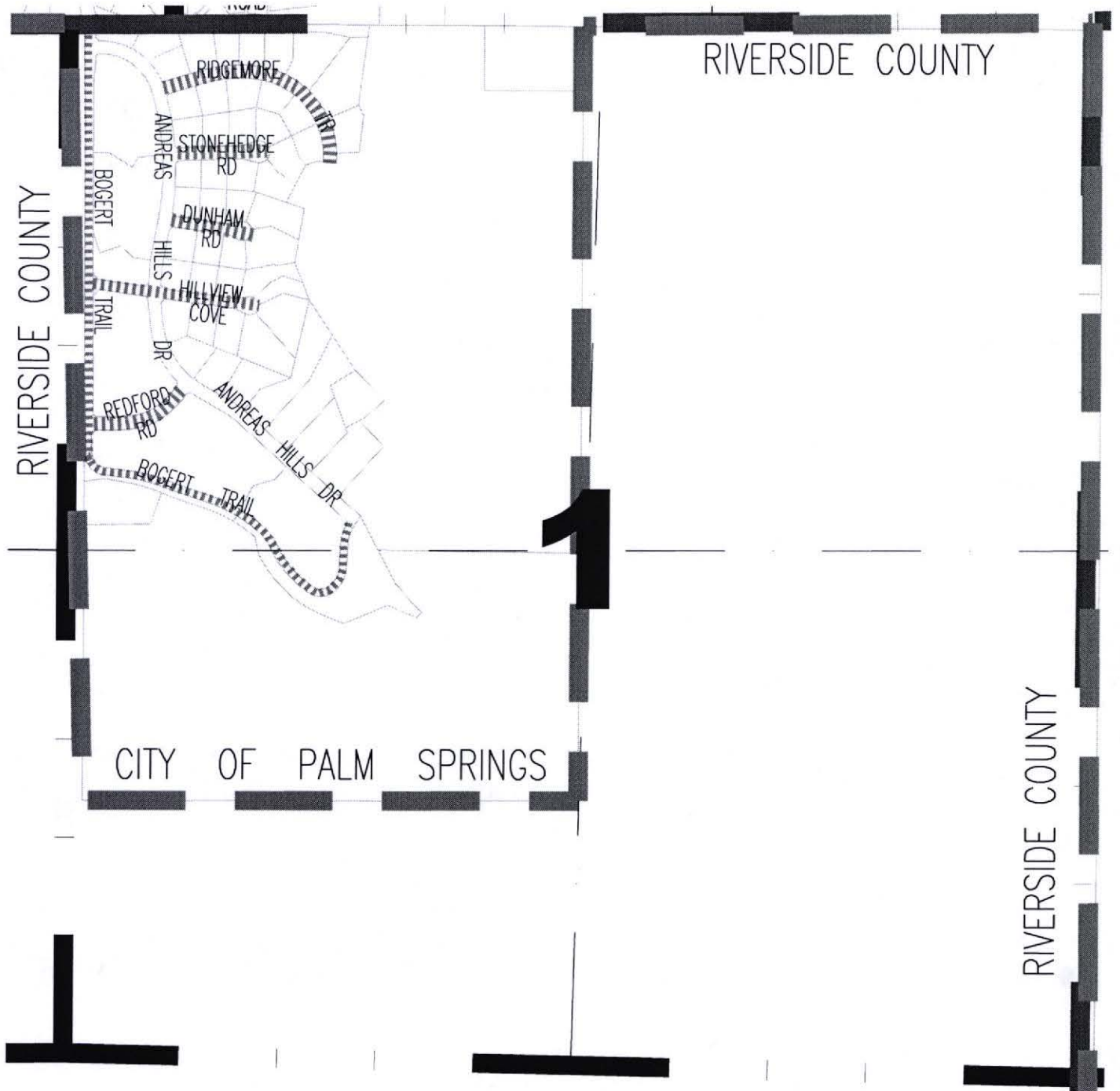

----- = 2014 SLURRY SEAL STREET