



## City Council Staff Report

Date: April 6, 2016 NEW BUSINESS

Subject: APPROVE TRAFFIC STRIPING TO IMPLEMENT A "ROAD DIET" CONVERSION ON MURRAY CANYON DRIVE AS PART OF THE 2015 CITYWIDE ANNUAL SLURRY SEAL, CITY PROJECT NO. 15-02

From: Marcus L. Fuller, Assistant City Manager/City Engineer

Initiated by: Public Works and Engineering Department

---

### SUMMARY

On October 7, 2015, the City Council awarded a construction contract to Intermountain Slurry Seal, for the 2015 Citywide Annual Slurry Seal, City Project No. 15-02, (the "Project"). The Project includes pavement maintenance and slurry seal of various City streets, including Murray Canyon Drive between S. Palm Canyon Drive and Toledo Avenue. Staff is recommending that in lieu of replacing the existing traffic striping on Murray Canyon Drive as a 4-lane roadway, that a "road diet" be implemented to convert the roadway to a 2-lane divided roadway with parking and buffered bicycle lanes. (The City Manager owns property within 500 feet of the Project, and is not participating in any actions associated with the Project).

### RECOMMENDATION:

Approve the implementation of a "road diet" on Murray Canyon Drive between S. Palm Canyon Drive and Toledo Avenue, to convert the existing 4-lane roadway to a 2-lane divided roadway with parking and buffered bicycle lanes, as part of the 2015 Citywide Annual Slurry Seal, City Project No. 15-02.

### BACKGROUND:

A full background on the City Council's award of the contract for the Project is included with the October 7, 2015, staff report, included as **Attachment 1**. The Project includes pavement maintenance and slurry seal on Murray Canyon Drive between S. Palm Canyon Drive and Toledo Avenue, an existing 4-lane "Secondary Thoroughfare" roadway as identified on the Circulation Element of the City's General Plan. An aerial view of a typical section of Murray Canyon Drive, and a street view photo, are shown in the following Figures on the next page.

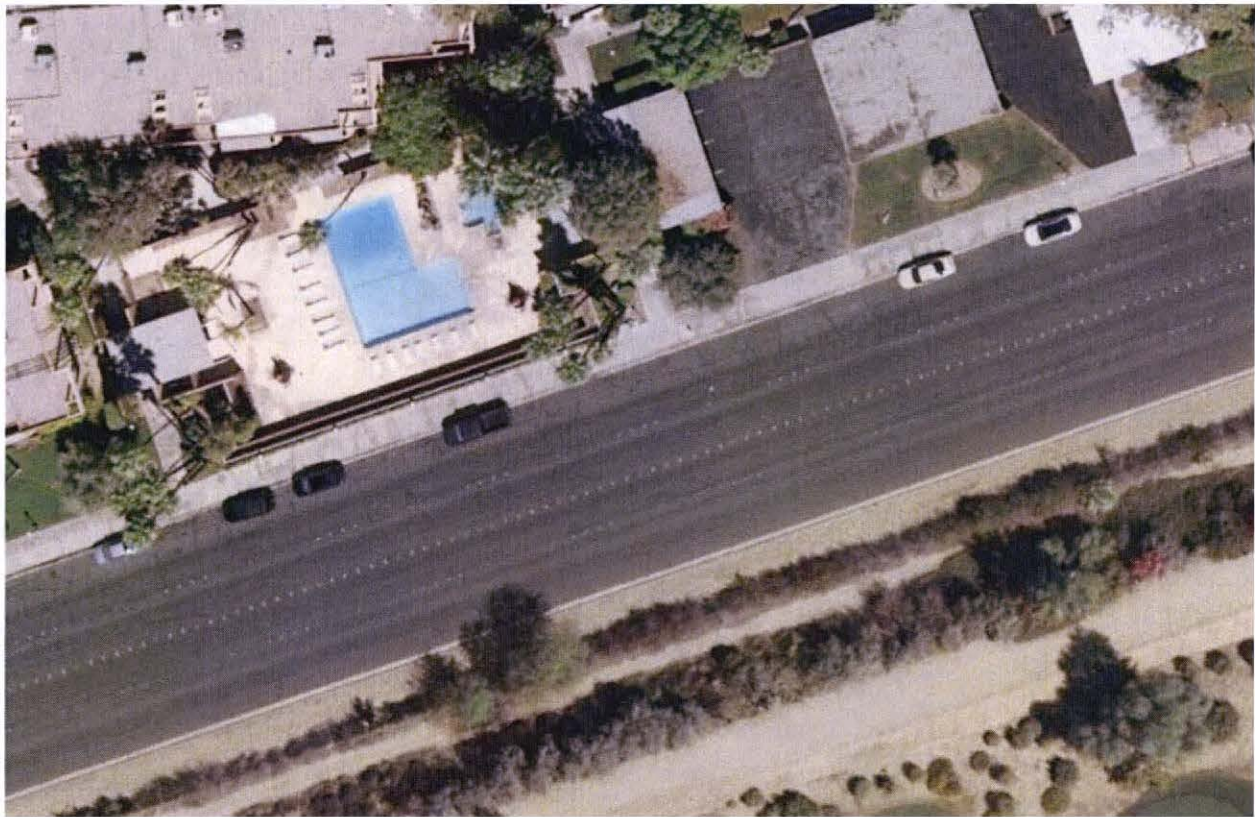

**Figure 1 – Plan View**



**Figure 2 – Section View**

The existing roadway has a cross-section of 64 feet, allowing for on-street parking and four (12 feet wide) lanes of traffic. The Project includes replacing existing traffic striping after completion of pavement repairs and slurry seal, and staff is recommending that the



City Council approve implementing a "road diet" to reduce the number of travel lanes to create buffered bicycle lanes, which would extend to and connect with a previously completed "road diet" on Toledo Avenue. Toledo Avenue is also scheduled for pavement repairs and slurry seal as part of the Project, and implementing a "road diet" on Murray Canyon Drive would help complete a portion of a bicycle loop in this area of the City.

The "road diet" concept captures excess capacity in an existing roadway by eliminating travel lanes and providing that area of the roadway for other mobility uses, including on-street parking and buffered bicycle lanes. A typical section for a 2-lane divided roadway with parking and buffered bicycle lanes is shown in the following Figures:

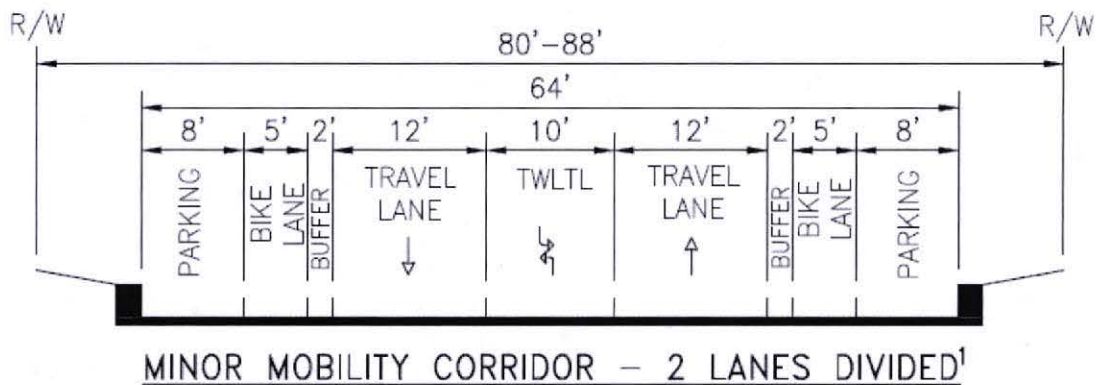

**Figure 3 – Typical Section**

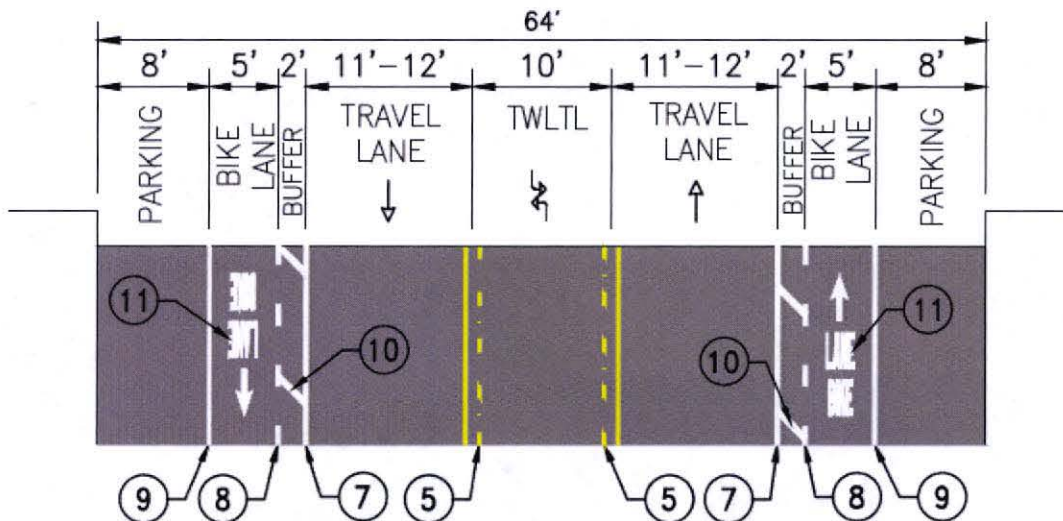

**Figure 4 – Plan View**

**General Plan Consistency Analysis**

Staff has been reviewing an ability to implement "road diets" on various 4-lane roadways throughout the City, including Murray Canyon Drive. The ability to implement "road diets" is determined by identifying existing and future traffic volumes that are



carried by each roadway, and evaluating if each roadway has sufficient excess capacity such that the capacity of the roadway may be reduced by eliminating the number of travel lanes. Staff is completing a City-wide traffic analysis of its Circulation Element to identify where "road diets" may be implemented to allow for additional Class 2 bicycle lane routes, and will be presenting this analysis to the City Council in the near future.

However, with the slurry seal repairs pending in the very near future on Murray Canyon Drive, staff is presenting the concept of implementing a "road diet" on this specific street ahead of a City-wide discussion, to allow for the physical traffic striping of Murray Canyon Drive to be completed consistent with a 2-lane divided roadway with parking and buffered bicycle lanes, rather than replacing the existing 4-lane roadway as it exists today.

The traffic analysis specific to Murray Canyon Drive shows that the existing 4-lane roadway currently carries approximately 3,500 vehicles per day, with a total capacity of 25,900 vehicles per day, which operates at Level of Service ("LOS") A, with a vehicle/capacity ratio ("V/C") of 0.14. The traffic analysis projected future traffic volumes by applying an inflation factor to represent growth of 1.5% in traffic volumes annually over 22 years, to identify future traffic volumes in 2035. On Murray Canyon Drive, the anticipated future traffic volume in 2035 is 4,700 vehicles per day, which maintains operation at LOS A, with a V/C = 0.18.

The Circulation Element of the City's General Plan, Policy CR2.1, regulates how the City's streets should operate to ensure against traffic congestion and the associated environmental impacts related to such congestion, and states:

*CR2.1 Maintain Level of Service D or better for the City's circulation network, as measured using "in season" peak hour conditions.*

A 4-lane roadway similar to Murray Canyon Drive with a capacity of 25,900 vehicles per day may operate at LOS D with up to 23,300 vehicles per day with V/C = 0.90. In this case, Murray Canyon Drive is expected to carry a maximum of 4,700 vehicles per day, and has excess capacity by which travel lanes may be reduced to implement a "road diet". The converted 2-lane divided roadway with parking and buffered bicycle lanes has a reduced capacity of 18,000 vehicles per day, and with an anticipated future traffic volume of 4,700 vehicles per day, the converted 2-lane roadway will still maintain an operation at LOS A, with a V/C = 0.26. The "road diet" will function consistent with the requirements of the Circulation Element of the City's General Plan. On this basis, staff recommends that the City Council approve implementing this "road diet".

#### ENVIRONMENTAL IMPACT:

Section 21084 of the California Public Resources Code requires Guidelines for Implementation of the California Environmental Quality Act ("CEQA"). The Guidelines are required to include a list of classes of projects which have been determined not to have a significant effect on the environment and which are exempt from the provisions



of CEQA. In response to that mandate, the Secretary for Resources identified classes of projects that do not have a significant effect on the environment, and are declared to be categorically exempt from the requirement for the preparation of environmental documents. In accordance with Section 15301 "Existing Facilities," Class 1 projects consist of the operation, repair, maintenance, permitting, leasing, licensing, or minor alteration of existing public structures, facilities, mechanical equipment or topographical features involving negligible or no expansion of use beyond that existing at the time of the lead agency's determination. Therefore, in accordance with Section 15301(c), staff has determined that the 2015 Citywide Annual Slurry Seal, City Project No. 15-02, is considered categorically exempt from CEQA and a Notice of Exemption has been prepared and filed with the Riverside County Clerk.

As it relates to the "road diet" to convert an existing 4-lane roadway to a 2-lane divided roadway with parking and buffered bicycle lanes, the City has determined, upon review of the proposed , that implementing the proposed "road diet" is exempt from the CEQA, insofar as the proposed traffic striping will occur entirely within existing, disturbed right of way; will only be implemented on Murray Canyon Drive which currently operates at acceptable levels of service, and will continue to operate at acceptance levels of service once the traffic striping has been completed; and the traffic striping will have no potential to impact the environment. The installation of the traffic striping to implement a "road diet" on Murray Canyon Drive is exempt from CEQA under the General Rule, Public Resources Code 21080, and CEQA Guidelines 15061(B)(3).

FISCAL IMPACT:

The cost to implement the "road diet" on Murray Canyon Drive between S. Palm Canyon Drive and Toledo Avenue, to convert the existing 4-lane roadway to a 2-lane divided roadway with parking and buffered bicycle lanes, is already included with and part of the contract awarded for the 2015 Citywide Annual Slurry Seal, City Project No. 15-02; no additional cost will be incurred.

SUBMITTED:



Marcus L. Fuller, MPA, P.E., P.L.S.  
Assistant City Manager/City Engineer



James Thompson  
Chief of Staff/City Clerk

Attachments:

1. October 7, 2015, staff report
2. Vicinity Map

# **ATTACHMENT 1**





## City Council Staff Report

Date: October 7, 2015

NEW BUSINESS

Subject: AWARD A CONSTRUCTION CONTRACT TO INTERMOUNTAIN SLURRY SEAL COMPANY, A CALIFORNIA CORPORATION, IN THE AMOUNT OF \$1,760,067; APPROVE AN ADDITIONAL LIST OF STREETS AND AUTHORIZE A CONSTRUCTION CONTRACT CHANGE ORDER NOT TO EXCEED \$540,000; AND AUTHORIZE A PURCHASE ORDER IN AN AMOUNT NOT TO EXCEED \$100,862 TO WILLDAN ENGINEERING FOR CONSTRUCTION MANAGEMENT AND INSPECTION SERVICES FOR THE 2015 CITYWIDE ANNUAL SLURRY SEAL, CITY PROJECT NO. 15-02

From: David H. Ready, City Manager

Initiated by: Public Works and Engineering Department

---

### SUMMARY

Award of this contract will allow the City to proceed with construction of the 2015 Citywide Annual Slurry Seal, City Project 15-02, (the "Project") funded by the City's Local Measure A Program. The low bid submitted by Intermountain Slurry Seal is less than the City's estimate, providing budget for additional streets; a list of additional streets to add to the Project is recommended for consideration by the City Council. Approval of a Purchase Order with Willdan Engineering will provide the City with construction inspection and administration support services required for the Project.

### RECOMMENDATION:

1. Award a construction contract (Agreement No. \_\_\_\_\_) to Intermountain Slurry Seal, Inc., a Wyoming corporation, in the amount of \$1,760,067 for the 2015 Citywide Annual Slurry Seal, City Project No. 15-02;
2. Approve the list of recommended additional streets to include in the 2015 Citywide Annual Slurry Seal, City Project No. 15-02, and authorize the City Manager to approve a Construction Contract Change Order in an amount not to exceed \$540,000;

07 ITEM NO. 50

3. Authorize a Purchase Order to Willdan Engineering, pursuant to On-Call Agreement No. 6688, in the amount of \$100,862 for construction management and inspection services for the 2015 Citywide Annual Slurry Seal, City Project No. 15-02;
4. Adopt Resolution No. \_\_\_\_\_ "A Resolution of the City Council of the City of Palm Springs, California amending the budget for Fiscal Year 2015-2016; and
5. Authorize the City Manager to execute all necessary documents.

**BACKGROUND:**

On March 4, 2015, staff presented a final report of the 2015 Pavement Management Program Update (the "2015 Update") to the City Council. The 2015 Update determined an overall Pavement Condition Index ("PCI") of 69 and confirmed that 75% of the entire City street network has a pavement condition rated at "Fair" or better condition. Staff provided copies of the 2015 Update and held meetings with various subcommittees of the Palm Springs Neighborhood Involvement Committee (PSNIC), now known as the Organized Neighborhoods of Palm Springs (One-PS), and the Measure J Commission to review and discuss the 2015 Update.

The Public Works & Engineering Department oversees the maintenance of the City's street system. Each year, the Department assembles a capital project to continue its Slurry Seal Program on various City streets. The intention of the Slurry Seal Program is to provide a slurry seal within 5 to 7 years on every City street. The City generally budgets \$500,000 for the Slurry Seal program, but with the deferral of a Slurry Seal project in 2014 and with additional funds accumulated in the local Measure A account from prior years, Public Works and Engineering was able to program a sizable amount of \$2,450,000 for the Project.

Staff and One-PS identified a final list of over 80 various streets throughout the City (4.8 million square feet of paved roadways) using a budget estimate of \$2.45 Million from the City's Local Measure A Fund. The List of Streets and corresponding Maps originally included with the Project are provided as **Attachment 1**. This year's slurry seal program is scheduled to include all streets with PCI ratings from 65 through 69. Streets with PCI scores of 70 were prioritized from arterials, collectors, to local roads.

On July 15, 2015, the City Council reviewed and approved the project specifications and the list of streets, and authorized staff to advertise and solicit bids for the Project. On July 5, and August 1, 2015, the project was advertised for bids, and at 3:00 p.m. on August 27, 2015, the Procurement and Contracting Division received five construction bids from the following contractors:

<b>Company</b>	<b>Location</b>	<b>Bid Amount</b>
Intermountain Slurry Seal	Watsonville, CA	\$1,760,067
American Asphalt South	Fontana, CA	\$2,094,885
Pavement Coatings Co.	Jurupa Valley, CA	\$2,130,062



<b>Company</b>	<b>Location</b>	<b>Bid Amount</b>
All American Asphalt	Corona, CA	\$2,407,280
Telfer Highway Technologies	McClellan, CA	\$2,794,915

Using actual bid item costs from prior projects completed by the City, staff determined an Engineer's estimate of \$2,450,000 with an expectation that given the large scale of streets to be slurry sealed with the project with a programmed budget of nearly five times that is annually programmed, an economy of scale would result in competitive bidding and lower overall cost. As expected, the low bid submitted by Intermountain Slurry Seal was significantly less than the engineer's estimate at \$1,760,067. A full bid summary is included as **Attachment 2**.

#### ***Public Works Contractor Registration Law (SB 854)***

Under California Labor Code Section 1771.1, as amended by Senate Bill (SB) 854 (2014), unless registered with the State of California Department of Industrial Relations (DIR), a contractor may not bid, nor be listed as a subcontractor, for any bid proposal submitted for public works projects on or after March 1, 2015. Similarly, a public entity cannot award a public works contract to a non-registered contractor, effective April 1, 2015. Staff has reviewed the DIR's contractor registration database, and has confirmed that Intermountain Slurry Seal, and the listed subcontractors, are registered with the DIR, and are appropriately licensed.

Intermountain Slurry Seal, of Watsonville, California submitted the lowest responsive bid. Staff reviewed the bid, references, and contractor's license, and found the Contractor to be properly licensed and qualified. A construction contract with Intermountain Slurry Seal, for the Project is included as **Attachment 3**.

#### ***Local Business Preference Compliance***

Section 7.09.030 of the Palm Springs Municipal Code, "Local Business Preference Program," requires prime contractors to use good faith efforts to sub-contract the supply of materials and equipment to local business enterprises and to sub-contract services to businesses whose work force resides within the Coachella Valley; submission of good faith efforts is required. Of the five bids received, none of the prime contractors were located within the Coachella Valley. The lowest bidder has submitted proof of good faith efforts.

#### ***City Council Approval of Additional Streets with Remaining Budget***

As a result of the economy of scale and reduced bid unit costs obtained through the competitive bidding on the Project, the low bid submitted by Intermountain Slurry Seal was significantly less than the final estimate, at \$1,760,067, and provides a remaining budget of approximately \$540,000 (after accounting for updated costs and contingencies) from which additional streets may be included in the Project. One-PS and staff have identified an additional list of streets with both arterial and collector



streets, included as **Attachment 4**. One-PS has reviewed and recommended approval of the additional list of streets; a copy of the One-PS letter is included as **Attachment 5**.

Staff recommends that the City Council approve the additional list of recommended streets, and authorize the City Manager to approve a Construction Contract Change Order in an amount not to exceed \$540,000 to implement inclusion of such list as part of the Project.

### ***Construction Management and Inspection Services***

On April 1, 2015, the City Council approved agreements for on-call Public Works capital project construction management and inspection services with Dudek & Associates, Interwest Consulting Group, Inc., and Willdan Engineering to provide first class as-needed construction management and inspection ("Owner's Rep") services associated with a variety of future Public Works capital projects. Staff is recommending the services of Willdan Engineering given their on-going construction management oversight for the 2015 Pavement Rehabilitation Project (City Project No. 15-01); staff recommends that the City Council approve the proposal submitted by Willdan Engineering, in the amount of \$100,862 which should be no more than 5% of the construction costs inclusive of the additional street list. Staff was able to include the additional streets in the proposal, therefore, costs for construction management, inspection, and material testing reflects the additional scope. A copy of the proposal for construction phase services provided by Willdan Engineering is included as **Attachment 6**.

### **ENVIRONMENTAL IMPACT:**

Section 21084 of the California Public Resources Code requires Guidelines for Implementation of the California Environmental Quality Act ("CEQA"). The Guidelines are required to include a list of classes of projects which have been determined not to have a significant effect on the environment and which are exempt from the provisions of CEQA. In response to that mandate, the Secretary for Resources identified classes of projects that do not have a significant effect on the environment, and are declared to be categorically exempt from the requirement for the preparation of environmental documents. In accordance with Section 15301 "Existing Facilities," Class 1 projects consist of the operation, repair, maintenance, permitting, leasing, licensing, or minor alteration of existing public structures, facilities, mechanical equipment or topographical features involving negligible or no expansion of use beyond that existing at the time of the lead agency's determination. Therefore, in accordance with Section 15301(c), staff has determined that the 2015 Citywide Annual Slurry Seal, City Project No. 15-02, is considered categorically exempt from CEQA and a Notice of Exemption has been prepared and will be filed with the Riverside County Clerk. A copy of the Notice of Exemption is included as **Attachment 7**.



**FISCAL IMPACT:**

The Local Measure A Program (Fund 134) had approximately \$2,200,000 available in unscheduled capital projects (Account No. 134-4498-50000) at the end of the 2014-2015 Fiscal Year, and a remaining balance of approximately \$900,000 from the prior year's annual slurry seal program. The City Council adopted the Measure A Local Streets and Roads 5-Year Capital Improvement Plan ("CIP"), which identified a total of \$2,000,000 anticipated for expenditure for the annual slurry seal program; the actual amount will be revised in the subsequent annual approval of the Measure A 5-Year CIP.

The Project's overall budget, and incurred expenditures, are identified in the following Table 1.

<b>Table of Project Costs</b>	<b>Amount</b>
Local Measure A FY 15/16 Allocation	\$2,450,000
Project Administration (Estimated)	(\$15,000)
Construction Engineering & Inspection (Willdan)	(\$100,852)
Construction Contract	(\$1,760,067)
Construction Contingency	(\$540,000)
<b>Remaining Balance</b>	<b>\$34,081</b>

**Table 1**

Sufficient funding for the Project is available through the Local Measure A Fund (Fund 134) in Account No. 134-4498-50100.

**SUBMITTED:**

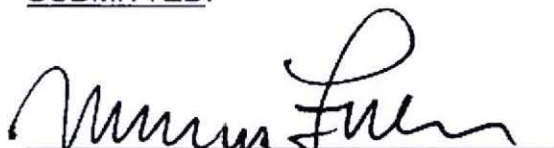
  
Marcus L. Fuller, MPA, P.E., P.L.S.  
Assistant City Manager/City Engineer

  
David H. Ready, Esq., Ph.D.  
City Manager

**Attachments:**

1. Map and Listing of Approved Streets for Slurry Seal
2. Bid Summary
3. Agreement (Contract)
4. Additional List of Streets
5. One-PS Letter/Memorandum
6. Willdan Proposal
7. CEQA Notice of Exemption

# **ATTACHMENT 1**



**2015 ANNUAL SLURRY SEAL, CITY PROJECT NO. 15-02**

Branch ID	Name	From	To	Length (FT)	Width (FT)	True Area	Accumulated Area	Inspection Sign Off
CPS 01-4-4	BISKRA ROAD	N/S FRANCIS DRIVE	S/S JOYCE DRIVE	1,137	33	37,521	37,521	
CPS 01-4-4	VIMINAL ROAD	S/S VIA ESCUELA	S/S SAN JUAN ROAD	1,014	24	24,336	61,857	
CPS 02-4-4	AVENIDA CABALLEROS	N/S VISTA CHINO	N/S VIA ESCUELA	1,304	60	78,240	140,097	
CPS 02-4-4	DESERT WILLOW CIRCLE	W/S STARR ROAD	W END (CDS)	631	32	22,302	162,399	
CPS 02-4-4	RACQUET CLUB ROAD	E/S AURORA DRIVE	W/S SUNRISE WAY	1,913	60	114,780	277,179	
CPS 02-4-4	SUNRISE WAY	N/S VIA ESCUELA	S/S RACQUET CLUB ROAD	1,344	66	88,704	365,883	
CPS 03-4-4	DE ANZA ROAD	S/S DOMINGUEZ ROAD	N/S CORTEZ ROAD	659	18	10,544	376,427	
CPS 03-4-4	PICO ROAD	W/S ZANJERO ROAD	E/S DE ANZA ROAD	646	22	14,212	390,639	
CPS 03-4-4	SEPULVEDA ROAD	E/S LOS FELICES ROAD	W/S DE ANZA ROAD	738	22	16,236	406,875	
CPS 03-4-4	VIA ESCUELA	E/S INDIAN CANYON DRIVE	W/S PALM CANYON DRIVE	680	36	24,480	431,355	
CPS 03-4-4	VIA MONTE VISTA	S/S VIA OLIVERA	S END	308	20	6,120	437,475	
CPS 03-4-4	YORBA ROAD	W/S LOS FELICES ROAD	E/S PALM CANYON DRIVE	320	36	11,520	448,995	
CPS 03-4-4	ZANJERO ROAD	S/S CORTEZ ROAD	N/S RACQUET CLUB ROAD	215	18	3,870	452,865	
CPS 10-3-3	TIPTON ROAD	1685' N/O WENDY ROAD	2900' N/O WENDY ROAD	1,215	50	60,750	513,615	
CPS 10-4-4	GRANVIA VALMONTE	W/S VIA MIRALESTE	E/S VIA CORTA	264	20	5,280	518,895	
CPS 11-4-4	AVENIDA CABALLEROS	N/S TACHEVAH DRIVE	N/S PASEO EL MIRADOR	824	46	38,085	556,980	
CPS 11-4-4	AVENIDA CABALLEROS	N/S TAMARISK ROAD	N/S TACHEVAH DRIVE	1,322	60	75,500	632,480	
CPS 11-4-4	AVENIDA CABALLEROS	N/S ALEJO ROAD	N/S TAMARISK ROAD	1,312	58	76,096	708,576	
CPS 11-4-4	AVENIDA PALOS VERDES	S/S TAMARISK ROAD	N/S VIA ALTAMIRA	285	27	8,595	717,171	
CPS 11-4-4	CAMINO REAL	S/S SOUTH RIVERSIDE	N/S MESQUITE AVENUE	488	58	28,304	745,475	
CPS 11-4-4	CAMINO REAL	N/S SONORA ROAD	E/S INDIAN TRAIL	1,261	50	63,050	808,525	
CPS 11-4-4	COTTONWOOD ROAD	W/S AVENIDA CABALLEROS	E/S VIA MIRALESTE	1,275	32	40,800	849,325	
CPS 11-4-4	COTTONWOOD ROAD	W/ S VIA MIRALESTE	E/S CHAPARRAL ROAD	822	33	27,126	876,451	
CPS 11-4-4	GRANVIA VALMONTE	W/S INDIAN CANYON DRIVE	E/S PALM CANYON DRIVE	277	26	7,202	883,653	
CPS 11-4-4	GRANVIA VALMONTE	W/S AVENIDA CABALLEROS	E/S VIA MIRALESTE	1,273	33	42,009	925,662	
CPS 11-4-4	HERMOSA DRIVE	S/S TACHEVAH DRIVE	N/S TAMARISK ROAD	1,298	36	46,728	972,390	
CPS 11-4-4	HERMOSA DRIVE	S/S TAMARISK ROAD	N/S ALEJO ROAD	1,279	36	46,044	1,018,434	
CPS 11-4-4	MEL AVENUE	W/S VIA MIRALESTE	E/S INDIAN CANYON DRIVE	1,250	32	40,000	1,058,434	
CPS 11-4-4	TACHEVAH DRIVE	W/S PASEO DE ANZA	W/S SUNRISE WAY	645	43	29,088	1,087,522	
CPS 11-4-4	TAMARISK ROAD	W/S AVENIDA CABALLEROS	E/S VIA MIRALESTE	1,264	36	43,722	1,131,244	
CPS 11-4-4	VALMONTE NORTE	W/S VIA CORTA	E/S VIA CHICA	673	20	14,364	1,145,608	
CPS 11-4-4	VALMONTE SUR	E/S VIA CHICA	W/S VIA CORTA	682	18	12,906	1,158,514	
CPS 11-4-4	VAQUERO ROAD	S/S CHUCKWALLA ROAD	N/S CHIA ROAD	626	33	21,058	1,179,572	

**2015 ANNUAL SLURRY SEAL, CITY PROJECT NO. 15-02**

Branch ID	Name	From	To	Length (FT)	Width (FT)	True Area	Accumulated Area	Inspection Sign Off
CPS 11-4-4	VIA CORTA	N/S VIA COLUSA	S/S VIA ALTAMIRA	840	20	17,703	1,197,275	
CPS 11-4-4	VIA MIRALESTE	S/S TACHEVAH DRIVE	318' S. OF TACHEVAH	318	60	19,080	1,216,355	
CPS 11-4-4	VIA MIRALESTE	318' S. OF TACHEVAH DRIVE	N/S TAMARISK ROAD	955	50	47,750	1,264,105	
CPS 12-4-4	TACHEVAH DRIVE	E/S SUNRISE WAY	W/S CERRITOS ROAD	1,278	60	76,680	1,340,785	
CPS 12-4-4	TAMARISK ROAD	W/S FARRELL DRIVE	E/S CERRITOS ROAD	1,646	36	59,256	1,400,041	
CPS 13-4-4	ANDREAS ROAD	W/S LOUELLA ROAD	E/S FARRELL DRIVE	950	36	34,200	1,434,241	
CPS 13-4-4	BARISTO ROAD	E/S FARRELL DRIVE	W/S CIVIC DRIVE	1,519	60	91,140	1,525,381	
CPS 14-4-4	AMADO ROAD	E/S CALLE SEGUNDO	E/S CALLE ALVARADO	710	60	42,600	1,567,981	
CPS 15-4-4	AMADO ROAD	E/S PALM CANYON DRIVE	W/S INDIAN CANYON DRIVE	320	48	14,510	1,582,491	
CPS 19-4-5	CALLE SAN RAPHAEL	W/S EUGENE ROAD	E/S WILLIAMS ROAD	291	35	10,185	1,592,676	
CPS 19-4-5	DESERT VIEW DRIVE	S/S RAMON ROAD	N/S SUNNY DUNES ROAD	1,274	28	35,672	1,628,348	
CPS 19-4-5	PONDEROSA WAY	N/S ESCOBA DRIVE	E END (CDS)	922	32	32,229	1,660,577	
CPS 19-4-5	RAMON ROAD	E/S EL CIELO ROAD	E/S VELLA ROAD	4,012	80	320,960	1,981,537	
CPS 23-3-3	TIPTON ROAD	N/S HWY 111	S/S RAILROAD	382	25	9,550	1,991,087	
CPS 23-4-4	CALLE CHIA	S/S CAMINO PAROCOLA	N/S CALLE ROCA	217	32	6,944	1,998,031	
CPS 23-4-4	CALLE PALO FIERRO	S/S MESQUITE AVENUE	E/S CAMINO REAL	1,057	36	38,052	2,036,083	
CPS 23-4-4	CALLE PALO FIERRO	W/S CAMINO REAL	N/S PALM CANYON DRIVE	2,123	36	76,428	2,112,511	
CPS 23-4-4	CAMINO REAL	N/S ALEJO ROAD	S/S GRANVIA VALMONTE	622	33	20,526	2,133,037	
CPS 23-4-4	CAMINO REAL	N/S GRANVIA VALMONTE	N END (CDS)	300	33	12,010	2,145,047	
CPS 23-4-4	CAMINO REAL	N/S SUNNY DUNES ROAD	S/S RAMON ROAD	1,271	46	58,466	2,203,513	
CPS 23-4-4	INDIAN CANYON DRIVE	S/S RAMON ROAD	N/S CAMINO PAROCOLA	614	60	36,840	2,240,353	
CPS 23-4-4	NORTH RIVERSIDE DRIVE	E/S CAMINO REAL	W/S SUNRISE WAY	3,169	30	95,070	2,335,423	
CPS 23-4-4	PALO VERDE AVENUE	E/S S PALM CANYON DRIVE	N/S OCOTILLO AVENUE	1,930	36	69,480	2,404,903	
CPS 23-4-4	RIVERSIDE PLACE	N/S N RIVERSIDE DRIVE	N END	264	33	8,712	2,413,615	
CPS 23-4-4	SAN LORENZO ROAD	E/S RANDOM ROAD	W/S CAMINO REAL	1,085	32	34,720	2,448,335	
CPS 23-4-4	SUNNY DUNES ROAD	W/S GREN FALL ROAD	W/S SUNRISE WAY	2,130	38	80,940	2,529,275	
CPS 23-4-4	SUNNY DUNES ROAD	W/S CALLE PALO FIERRO	W/S GREN FALL ROAD	1,820	38	69,160	2,598,435	
CPS 23-4-4	SUNRISE WAY	N/S BRIDGE	S/S RAMON ROAD	1,861	66	122,826	2,721,261	
CPS 23-4-4	WARM SANDS DRIVE	N/S SUNNY DUNES ROAD	S/S RAMON ROAD	1,598	33	52,734	2,773,995	
CPS 24-4-4	ANDEE DRIVE	N/S E PALM CANYON DRIVE	S/S SONORA ROAD	1,231	36	44,316	2,818,311	
CPS 24-4-4	AVERY DRIVE	W.S BEVERLY DRIVE	E/S COMPADRE ROAD	756	36	27,936	2,846,247	
CPS 24-4-4	MESQUITE AVENUE	E/S SUNRISE WAY	W/S CERRITOS ROAD	1,275	60	76,500	2,922,747	
CPS 24-4-4	VERA CRUZ ROAD	W/S BEVERLY DRIVE	E/S LA BREA ROAD	500	33	16,500	2,939,247	



**2015 ANNUAL SLURRY SEAL, CITY PROJECT NO. 15-02**

Branch ID	Name	From	To	Length (FT)	Width (FT)	True Area	Accumulated Area	Inspection Sign Off
CPS 25-4-4	E PALM CANYON DRIVE	W/S FARRELL DRIVE	PALM CANYON WASH	2,930	80	234,400	3,173,647	
CPS 26-4-4	CADIZ CIRCLE	S/S LA VERNE WAY	S END (CDS)	388	32	14,663	3,188,310	
CPS 26-4-4	CALLE PALO FIERRO	N/S AVENIDA GRANADA	S/S LA VERNE WAY	2,570	36	92,520	3,280,830	
CPS 26-4-4	CALLE PALO FIERRO	N/S TWIN PALMS	S/S E PALM CANYON DRIVE	450	36	16,200	3,297,030	
CPS 26-4-4	E PALM CANYON DRIVE	E/S S PALM CANYON DRIVE	E/S CAMINO REAL	2,000	64	128,000	3,425,030	
CPS 26-4-4	E PALM CANYON DRIVE	E/S CAMINO REAL	E/S SUNRISE WAY	3,280	70	229,600	3,654,630	
CPS 26-4-4	LA VERNE WAY	E/S CAMINO REAL	W/S CALIENTE ROAD	1,600	60	96,000	3,750,630	
CPS 26-4-4	LA VERNE WAY	W/S CALIENTE ROAD	S/S E PALM CANYON DRIVE	2,426	60	145,560	3,896,190	
CPS 26-4-4	TOLEDO AVENUE	S/S LA VERNE WAY	N/S SIERRA WAY	1,646	60	98,760	3,994,950	
CPS 26-4-4	TOLEDO AVENUE	N/S SIERRA WAY	N/S MURRAY CANYON DRIVE	2,970	60	178,200	4,173,150	
CPS 27-4-4	CAMINO CARMELITA	W/S S PALM CANYON DRIVE	W END	860	22	22,070	4,195,220	
CPS 29-4-5	PALM HILLS DRIVE	S/S STATE HWY 111	S END	483	74	30,942	4,226,162	
CPS 34-3-4	ANZA ROAD	S/S RADIO ROAD	S/S DEL SOL ROAD	475	24	12,123	4,238,285	
CPS 34-3-4	DEL SOL ROAD	S/S OASIS ROAD	S/S RADIO ROAD	310	30	9,300	4,247,585	
CPS 34-3-4	GATEWAY DRIVE	E/S PAMELA DRIVE	E/S STATE HWY 111	680	36	24,480	4,272,065	
CPS 34-3-4	GRANADA AVENUE	S/S TRAMVIEW ROAD	N/S ROSA PARKS ROAD	1,235	37	45,695	4,317,760	
CPS 34-3-4	RADIO ROAD	135' W/O ANZA ROAD	465' W/O ANZA ROAD	330	24	7,920	4,325,680	
CPS 34-3-4	ROSA PARKS ROAD	W/S INDIAN CANYON DRIVE	E/S EASTGATE ROAD	2,707	36	98,307	4,423,987	
CPS 35-4-4	AVENIDA SEVILLA	W/S BOGERT TRAIL	W END (CDS)	954	32	33,253	4,457,240	
CPS 35-4-4	CALLE PALO FIERRO	N/S SANTIAGO WAY	S/S AVENIDA GRANADA	1,440	36	54,202	4,511,442	
CPS 35-4-4	MURRAY CANYON DRIVE	W/S TOLEDO AVENUE	E/S CAMINO REAL	2,334	60	140,040	4,651,482	
CPS 35-4-4	MURRAY CANYON DRIVE	E/S CAMINO REAL	E/S S PALM CANYON DRIVE	3,366	60	201,960	4,853,442	

**2015 ANNUAL SLURRY SEAL, CITY PROJECT NO. 15-02**

Branch ID	Name	From	To	Length (FT)	Width (FT)	True Area	Accumulated Area	Inspection Sign Off
CPS 14-4-4	AMADO ROAD	E/S CALLE SEGUNDO	E/S CALLE ALVARADO	710	60	42,600	42,600	
CPS 15-4-4	AMADO ROAD	E/S PALM CANYON DRIVE	W/S INDIAN CANYON DRIVE	320	48	14,510	57,110	
CPS 24-4-4	ANDEE DRIVE	N/S E PALM CANYON DRIVE	S/S SONORA ROAD	1,231	36	44,316	101,426	
CPS 13-4-4	ANDREAS ROAD	W/S LOUELLA ROAD	E/S FARRELL DRIVE	950	36	34,200	135,626	
CPS 34-3-4	ANZA ROAD	S/S RADIO ROAD	S/S DEL SOL ROAD	475	24	12,123	147,749	
CPS 02-4-4	AVENIDA CABALLEROS	N/S VISTA CHINO	N/S VIA ESCUELA	1,304	60	78,240	225,989	
CPS 11-4-4	AVENIDA CABALLEROS	N/S TACHEVAH DRIVE	N/S PASEO EL MIRADOR	824	46	38,085	264,074	
CPS 11-4-4	AVENIDA CABALLEROS	N/S TAMARISK ROAD	N/S TACHEVAH DRIVE	1,322	60	75,500	339,574	
CPS 11-4-4	AVENIDA CABALLEROS	N/S ALEJO ROAD	N/S TAMARISK ROAD	1,312	58	76,096	415,670	
CPS 11-4-4	AVENIDA PALOS VERDES	S/S TAMARISK ROAD	N/S VIA ALTAMIRA	285	27	8,595	424,265	
CPS 35-4-4	AVENIDA SEVILLA	W/S BOGERT TRAIL	W END (CDS)	954	32	33,253	457,518	
CPS 24-4-4	AVERY DRIVE	W.S BEVERLY DRIVE	E/S COMPADRE ROAD	756	36	27,936	485,454	
CPS 13-4-4	BARISTO ROAD	E/S FARRELL DRIVE	W/S CIVIC DRIVE	1,519	60	91,140	576,594	
CPS 01-4-4	BISKRA ROAD	N/S FRANCIS DRIVE	S/S JOYCE DRIVE	1,137	33	37,521	614,115	
CPS 26-4-4	CADIZ CIRCLE	S/S LA VERNE WAY	S END (CDS)	388	32	14,663	628,778	
CPS 23-4-4	CALLE CHIA	S/S CAMINO PAROCOLA	N/S CALLE ROCA	217	32	6,944	635,722	
CPS 23-4-4	CALLE PALO FIERRO	S/S MESQUITE AVENUE	E/S CAMINO REAL	1,057	36	38,052	673,774	
CPS 23-4-4	CALLE PALO FIERRO	W/S CAMINO REAL	N/S PALM CANYON DRIVE	2,123	36	76,428	750,202	
CPS 26-4-4	CALLE PALO FIERRO	N/S AVENIDA GRANADA	S/S LA VERNE WAY	2,570	36	92,520	842,722	
CPS 26-4-4	CALLE PALO FIERRO	N/S TWIN PALMS	S/S E PALM CANYON DRIVE	450	36	16,200	858,922	
CPS 35-4-4	CALLE PALO FIERRO	N/S SANTIAGO WAY	S/S AVENIDA GRANADA	1,440	36	54,202	913,124	
CPS 19-4-5	CALLE SAN RAPHAEL	W/S EUGENE ROAD	E/S WILLIAMS ROAD	291	35	10,185	923,309	
CPS 27-4-4	CAMINO CARMELITA	W/S S PALM CANYON DRIVE	W END	860	22	22,070	945,379	
CPS 11-4-4	CAMINO REAL	S/S SOUTH RIVERSIDE	N/S MESQUITE AVENUE	488	58	28,304	973,683	
CPS 11-4-4	CAMINO REAL	N/S SONORA ROAD	E/S INDIAN TRAIL	1,261	50	63,050	1,036,733	
CPS 23-4-4	CAMINO REAL	N/S ALEJO ROAD	S/S GRANVIA VALMONTE	622	33	20,526	1,057,259	
CPS 23-4-4	CAMINO REAL	N/S GRANVIA VALMONTE	N END (CDS)	300	33	12,010	1,069,269	
CPS 23-4-4	CAMINO REAL	N/S SUNNY DUNES ROAD	S/S RAMON ROAD	1,271	46	58,466	1,127,735	
CPS 11-4-4	COTTONWOOD ROAD	W/S AVENIDA CABALLEROS	E/S VIA MIRALESTE	1,275	32	40,800	1,168,535	
CPS 11-4-4	COTTONWOOD ROAD	W/ S VIA MIRALESTE	E/S CHAPARRAL ROAD	822	33	27,126	1,195,661	
CPS 03-4-4	DE ANZA ROAD	S/S DOMINGUEZ ROAD	N/S CORTEZ ROAD	659	16	10,544	1,206,205	
CPS 34-3-4	DEL SOL ROAD	S/S OASIS ROAD	S/S RADIO ROAD	310	30	9,300	1,215,505	
CPS 19-4-5	DESERT VIEW DRIVE	S/S RAMON ROAD	N/S SUNNY DUNES ROAD	1,274	28	35,672	1,251,177	



**2015 ANNUAL SLURRY SEAL, CITY PROJECT NO. 15-02**

Branch ID	Name	From	To	Length (FT)	Width (FT)	True Area	Accumulated Area	Inspection Sign Off
CPS 02-4-4	DESERT WILLOW CIRCLE	W/S STARR ROAD	W END (CDS)	631	32	22,302	1,273,479	
CPS 25-4-4	E PALM CANYON DRIVE	W/S FARRELL DRIVE	PALM CANYON WASH	2,930	80	234,400	1,507,879	
CPS 26-4-4	E PALM CANYON DRIVE	E/S S PALM CANYON DRIVE	E/S CAMINO REAL	2,000	64	128,000	1,635,879	
CPS 26-4-4	E PALM CANYON DRIVE	E/S CAMINO REAL	E/S SUNRISE WAY	3,280	70	229,600	1,865,479	
CPS 34-3-4	GATEWAY DRIVE	E/S PAMELA DRIVE	E/S STATE HWY 111	680	36	24,480	1,889,959	
CPS 34-3-4	GRANADA AVENUE	S/S TRAMVIEW ROAD	N/S ROSA PARKS ROAD	1,235	37	45,695	1,935,654	
CPS 10-4-4	GRANVIA VALMONTE	W/S VIA MIRALESTE	E/S VIA CORTA	264	20	5,280	1,940,934	
CPS 11-4-4	GRANVIA VALMONTE	W/S INDIAN CANYON DRIVE	E/S PALM CANYON DRIVE	277	26	7,202	1,948,136	
CPS 11-4-4	GRANVIA VALMONTE	W/S AVENIDA CABALLEROS	E/S VIA MIRALESTE	1,273	33	42,009	1,990,145	
CPS 11-4-4	HERMOSA DRIVE	S/S TACHEVAH DRIVE	N/S TAMARISK ROAD	1,298	36	46,728	2,036,873	
CPS 11-4-4	HERMOSA DRIVE	S/S TAMARISK ROAD	N/S ALEJO ROAD	1,279	36	46,044	2,082,917	
CPS 23-4-4	INDIAN CANYON DRIVE	S/S RAMON ROAD	N/S CAMINO PAROCOLA	614	60	36,840	2,119,757	
CPS 26-4-4	LA VERNE WAY	E/S CAMINO REAL	W/S CALIENTE ROAD	1,600	60	96,000	2,215,757	
CPS 26-4-4	LA VERNE WAY	W/S CALIENTE ROAD	S/S E PALM CANYON DRIVE	2,426	60	145,560	2,361,317	
CPS 11-4-4	MEL AVENUE	W/S VIA MIRALESTE	E/S INDIAN CANYON DRIVE	1,250	32	40,000	2,401,317	
CPS 24-4-4	MESQUITE AVENUE	E/S SUNRISE WAY	W/S CERRITOS ROAD	1,275	60	76,500	2,477,817	
CPS 35-4-4	MURRAY CANYON DRIVE	W/S TOLEDO AVENUE	E/S CAMINO REAL	2,334	80	140,040	2,617,857	
CPS 35-4-4	MURRAY CANYON DRIVE	E/S CAMINO REAL	E/S S PALM CANYON DRIVE	3,366	60	201,960	2,819,817	
CPS 23-4-4	NORTH RIVERSIDE DRIVE	E/S CAMINO REAL	W/S SUNRISE WAY	3,169	30	95,070	2,914,887	
CPS 29-4-5	PALM HILLS DRIVE	S/S STATE HWY 111	S END	483	74	30,942	2,945,829	
CPS 23-4-4	PALO VERDE AVENUE	E/S S PALM CANYON DRIVE	N/S OCOTILLO AVENUE	1,930	36	69,480	3,015,309	
CPS 03-4-4	PICO ROAD	W/S ZANJERO ROAD	E/S DE ANZA ROAD	646	22	14,212	3,029,521	
CPS 19-4-5	PONDEROSA WAY	N/S ESCOBA DRIVE	E END (CDS)	922	32	32,229	3,061,750	
CPS 02-4-4	RACQUET CLUB ROAD	E/S AURORA DRIVE	W/S SUNRISE WAY	1,913	60	114,780	3,176,530	
CPS 34-3-4	RADIO ROAD	135' W/O ANZA ROAD	465' W/O ANZA ROAD	330	24	7,920	3,184,450	
CPS 19-4-5	RAMON ROAD	E/S EL CIELO ROAD	E/S VELLA ROAD	4,012	80	320,960	3,505,410	
CPS 23-4-4	RIVERSIDE PLACE	N/S N RIVERSIDE DRIVE	N END	264	33	8,712	3,514,122	
CPS 34-3-4	ROSA PARKS ROAD	W/S INDIAN CANYON DRIVE	E/S EASTGATE ROAD	2,707	36	98,307	3,612,429	
CPS 23-4-4	SAN LORENZO ROAD	E/S RANDOM ROAD	W/S CAMINO REAL	1,085	32	34,720	3,647,149	
CPS 03-4-4	SÉPULVEDA ROAD	E/S LOS FELICES ROAD	W/S DE ANZA ROAD	738	22	16,236	3,663,385	
CPS 23-4-4	SUNNY DUNES ROAD	W/S GRENFALL ROAD	W/S SUNRISE WAY	2,130	38	80,940	3,744,325	
CPS 23-4-4	SUNNY DUNES ROAD	W/S CALLE PALO FIERRO	W/S GRENFALL ROAD	1,820	38	69,160	3,813,485	
CPS 02-4-4	SUNRISE WAY	N/S VIA ESCUELA	S/S RACQUET CLUB ROAD	1,344	66	88,704	3,902,189	

**2015 ANNUAL SLURRY SEAL, CITY PROJECT NO. 15-02**

Branch ID	Name	From	To	Length (FT)	Width (FT)	True Area	Accumulated Area	Inspection Sign Off
CPS 23-4-4	SUNRISE WAY	N/S BRIDGE	S/S RAMON ROAD	1,861	66	122,826	4,025,015	
CPS 11-4-4	TACHEVAH DRIVE	W/S PASEO DE ANZA	W/S SUNRISE WAY	645	43	29,088	4,054,103	
CPS 12-4-4	TACHEVAH DRIVE	E/S SUNRISE WAY	W/S CERRITOS ROAD	1,278	60	76,680	4,130,783	
CPS 11-4-4	TAMARISK ROAD	W/S AVENIDA CABALLEROS	E/S VIA MIRALESTE	1,264	36	43,722	4,174,505	
CPS 12-4-4	TAMARISK ROAD	W/S FARRELL DRIVE	E/S CERRITOS ROAD	1,646	36	59,256	4,233,761	
CPS 10-3-3	TIPTON ROAD	1685' N/O WENDY ROAD	2900' N/O WENDY ROAD	1,215	50	60,750	4,294,511	
CPS 23-3-3	TIPTON ROAD	N/S HWY 111	S/S RAILROAD	382	25	9,550	4,304,061	
CPS 26-4-4	TOLEDO AVENUE	S/S LA VERNE WAY	N/S SIERRA WAY	1,646	60	98,760	4,402,821	
CPS 26-4-4	TOLEDO AVENUE	N/S SIERRA WAY	N/S MURRAY CANYON DRIVE	2,970	60	178,200	4,581,021	
CPS 11-4-4	VALMONTE NORTE	W/S VIA CORTA	E/S VIA CHICA	673	20	14,364	4,595,385	
CPS 11-4-4	VALMONTE SUR	E/S VIA CHICA	W/S VIA CORTA	682	18	12,906	4,608,291	
CPS 11-4-4	VAQUERO ROAD	S/S CHUCKWALLA ROAD	N/S CHIA ROAD	626	33	21,058	4,629,349	
CPS 24-4-4	VERA CRUZ ROAD	W/S BEVERLY DRIVE	E/S LA BREA ROAD	500	33	16,500	4,645,849	
CPS 11-4-4	VIA CORTA	N/S VIA COLUSA	S/S VIA ALTAMIRA	840	20	17,703	4,663,552	
CPS 03-4-4	VIA ESCUELA	E/S INDIAN CANYON DRIVE	W/S PALM CANYON DRIVE	680	36	24,480	4,688,032	
CPS 11-4-4	VIA MIRALESTE	S/S TACHEVAH DRIVE	318' S. OF TACHEVAH	318	60	19,080	4,707,112	
CPS 11-4-4	VIA MIRALESTE	318' S. OF TACHEVAH DRIVE	N/S TAMARISK ROAD	955	50	47,750	4,754,862	
CPS 03-4-4	VIA MONTE VISTA	S/S VIA OLIVERA	S END	306	20	6,120	4,760,982	
CPS 01-4-4	VIMINAL ROAD	S/S VIA ESCUELA	S/S SAN JUAN ROAD	1,014	24	24,336	4,785,318	
CPS 23-4-4	WARM SANDS DRIVE	N/S SUNNY DUNES ROAD	S/S RAMON ROAD	1,598	33	52,734	4,838,052	
CPS 03-4-4	YORBA ROAD	W/S LOS FELICES ROAD	E/S PALM CANYON DRIVE	320	36	11,520	4,849,572	
CPS 03-4-4	ZANJERO ROAD	S/S CORTEZ ROAD	N/S RACQUET CLUB ROAD	215	18	3,870	4,853,442	



CITY OF PALM SPRINGS  
SECTION 10-T3S-R3E

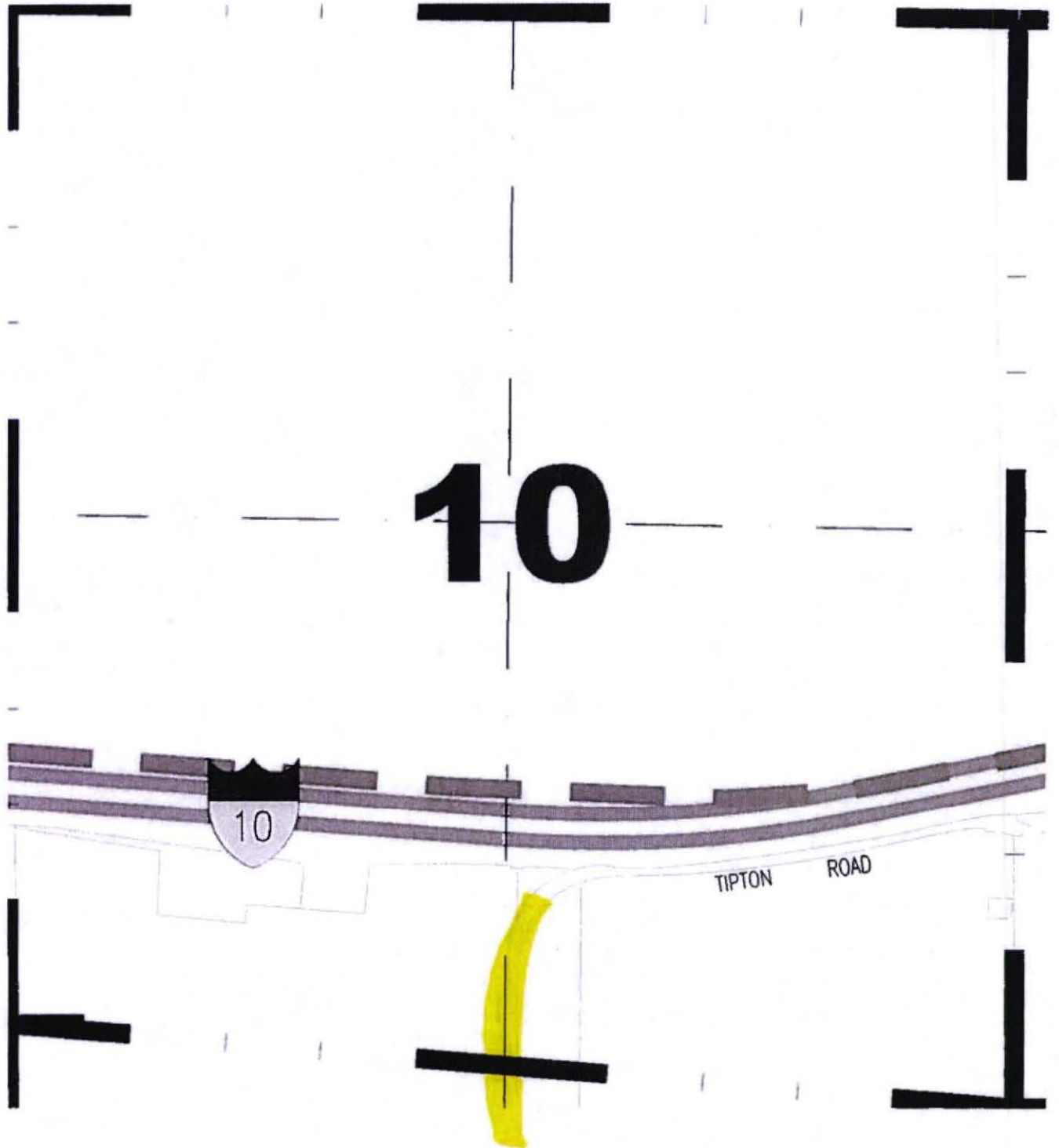

CITY OF PALM SPRINGS  
SECTION 15-T3S-R3E

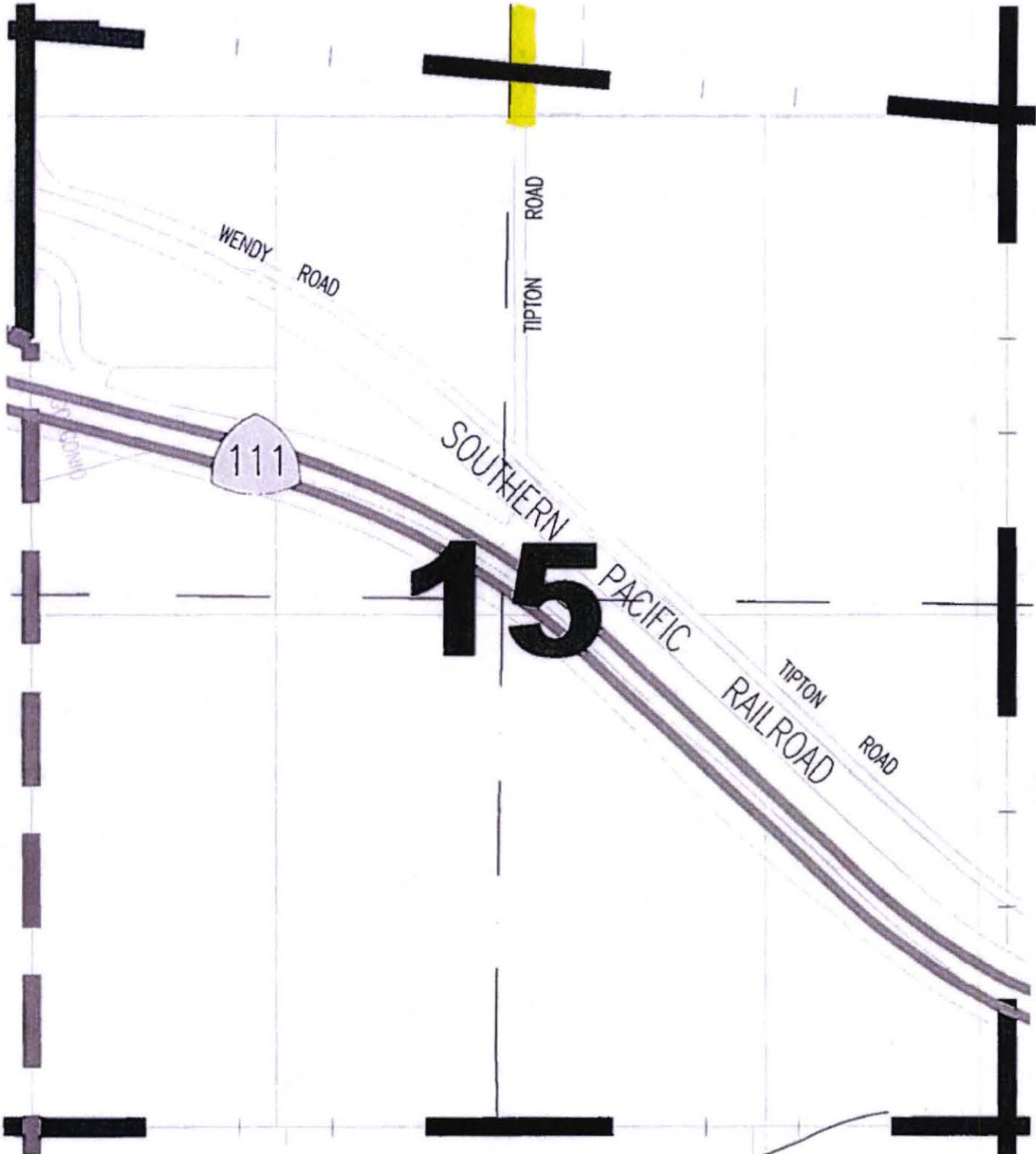



CITY OF PALM SPRINGS  
SECTION 14-T3S-R3E

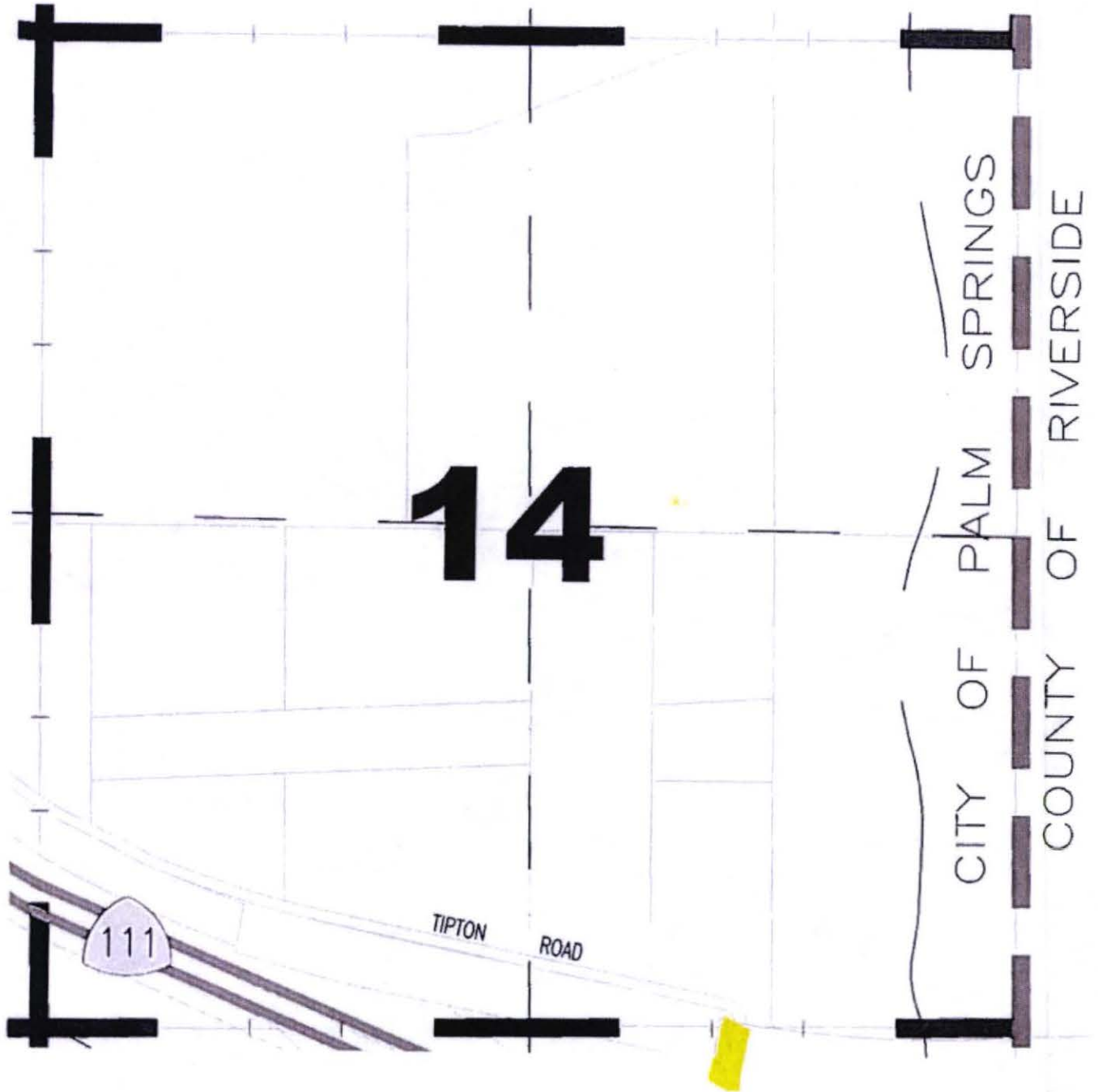

CITY OF PALM SPRINGS  
SECTION 34-T3S-R4E

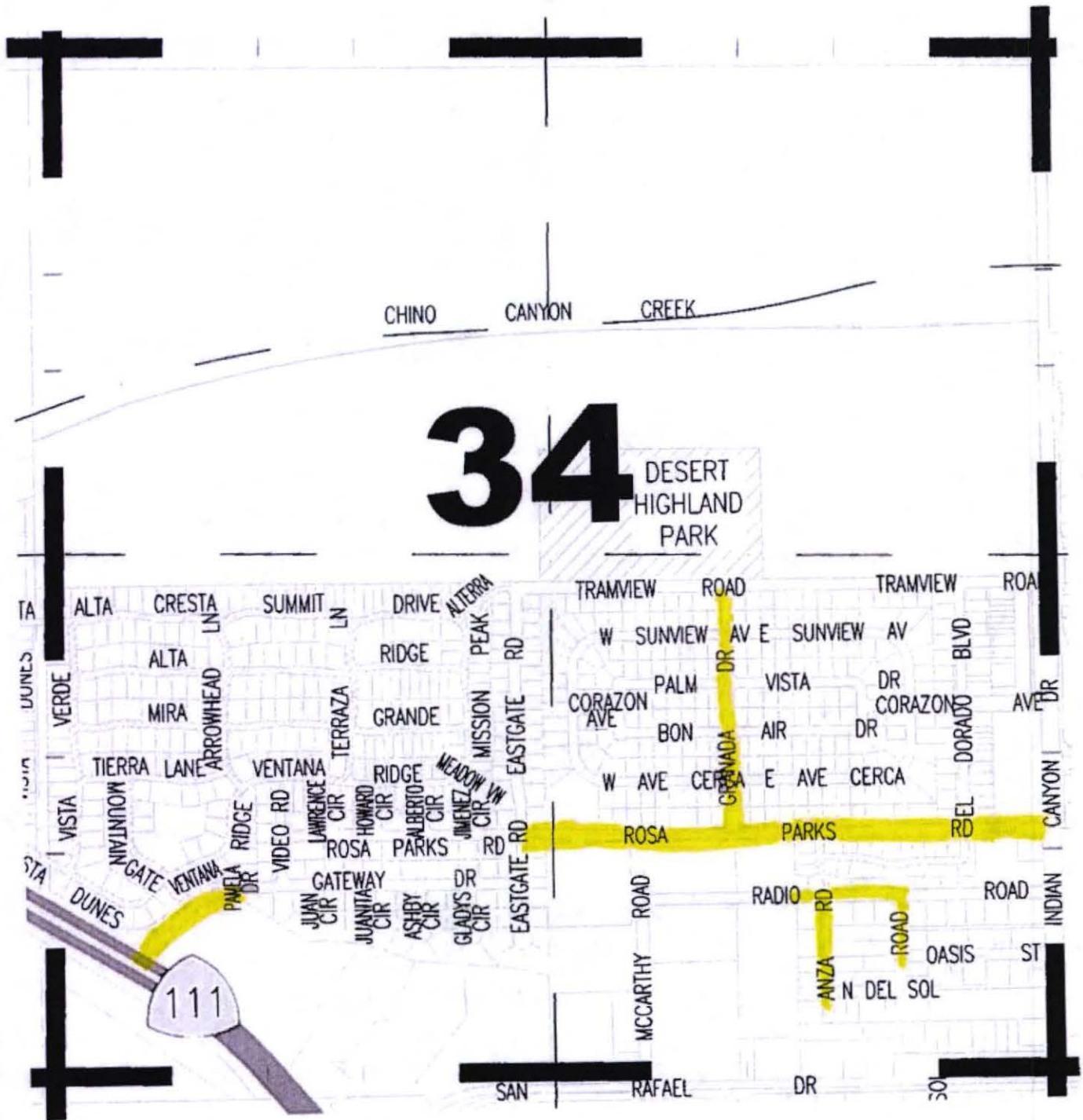



CITY OF PALM SPRINGS  
SECTION 1-74S-R4E



# CITY OF PALM SPRINGS SECTION 2-T4S-R4E

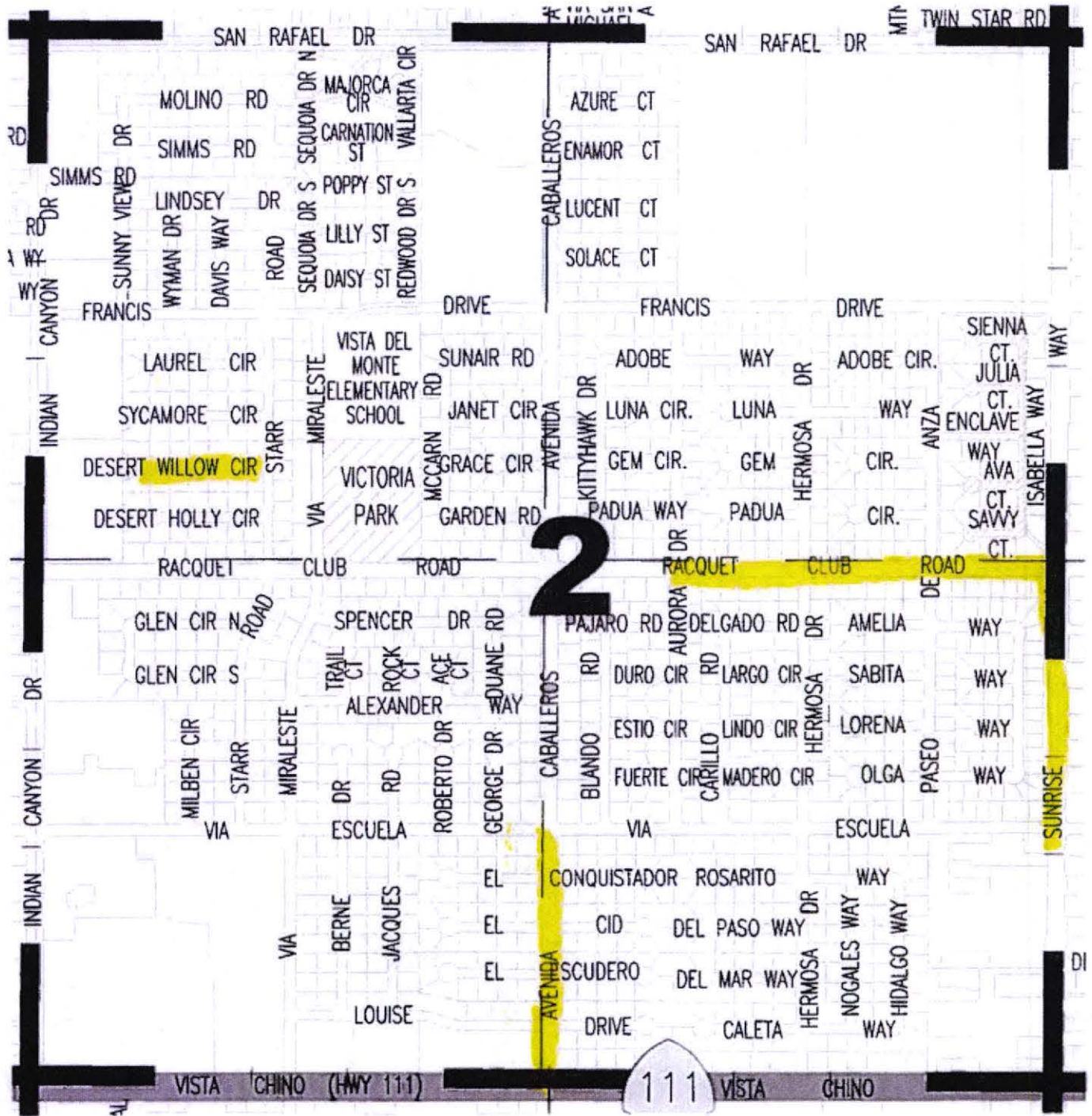



CITY OF PALM SPRINGS  
SECTION 3-T4S-R4E

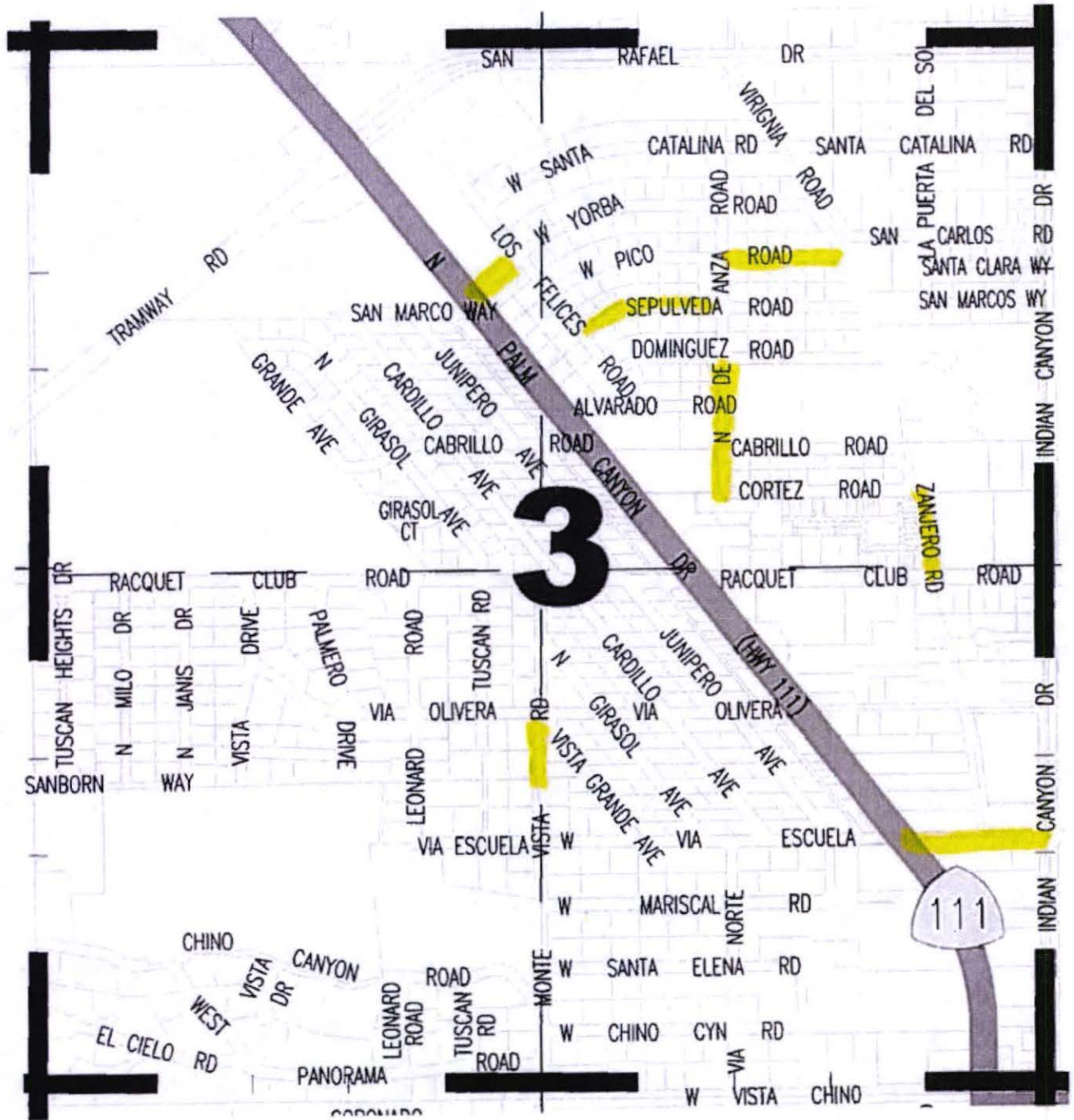

# CITY OF PALM SPRINGS SECTION 10-T4S-R4E

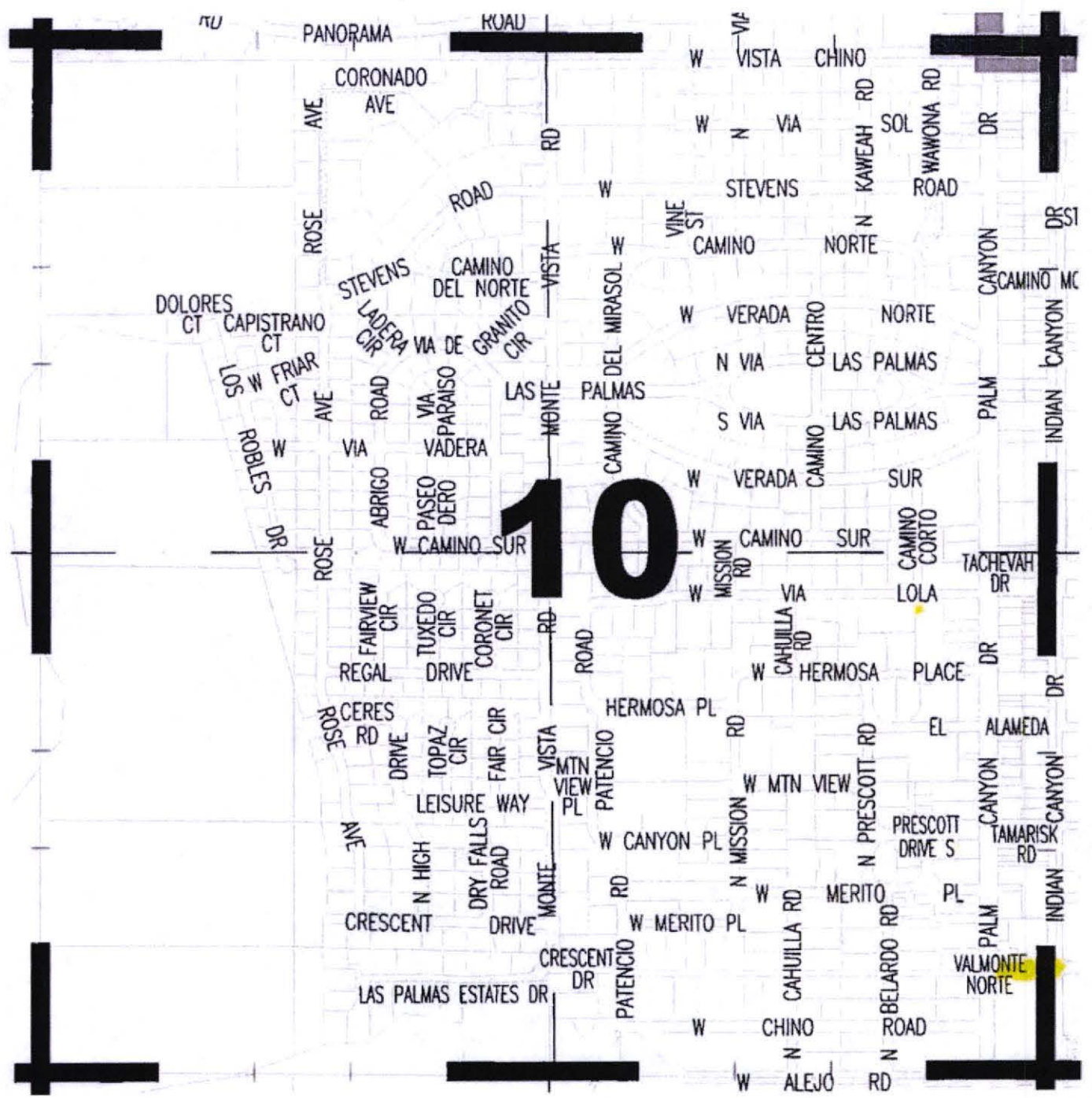



# CITY OF PALM SPRINGS SECTION 11-T4S-R4E

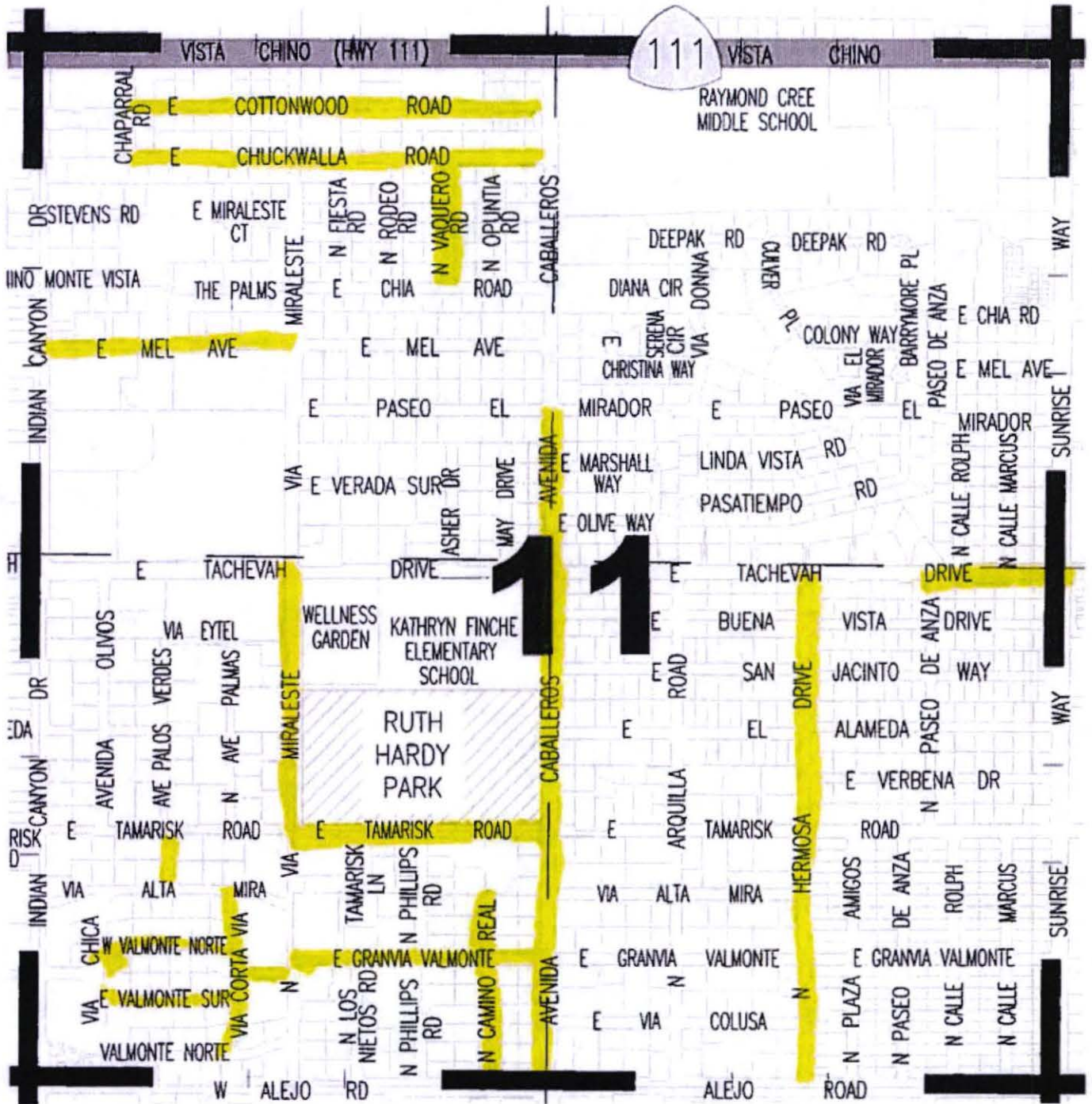

CITY OF PALM SPRINGS  
SECTION 12-T4S-R4E

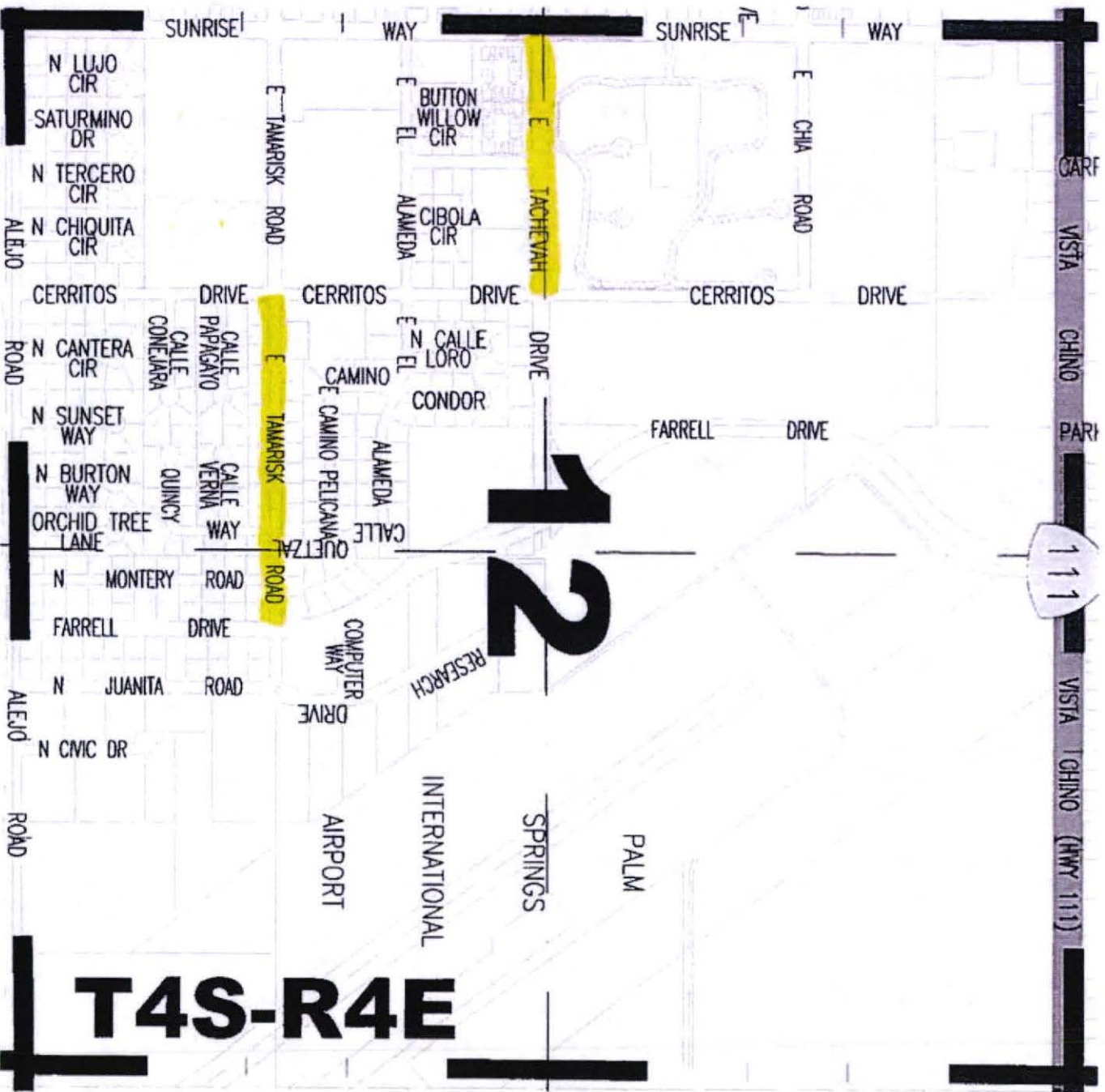



RIVERSIDE COUNTY

CITY OF PALM SPRINGS

15

CITY OF PALM SPRINGS  
SECTION 15-T4S-R4E

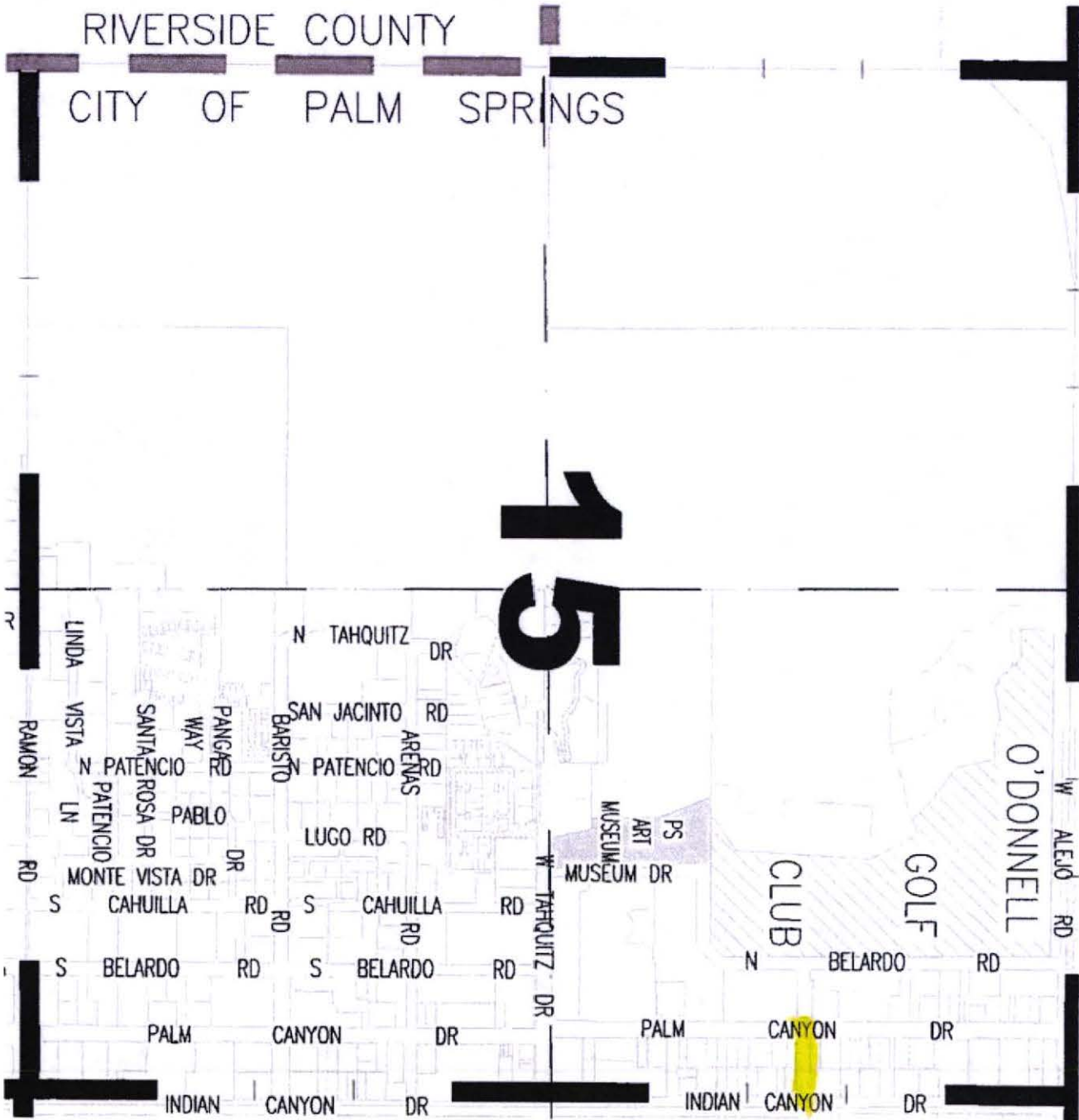

CITY OF PALM SPRINGS  
SECTION 14-T4S-R4E

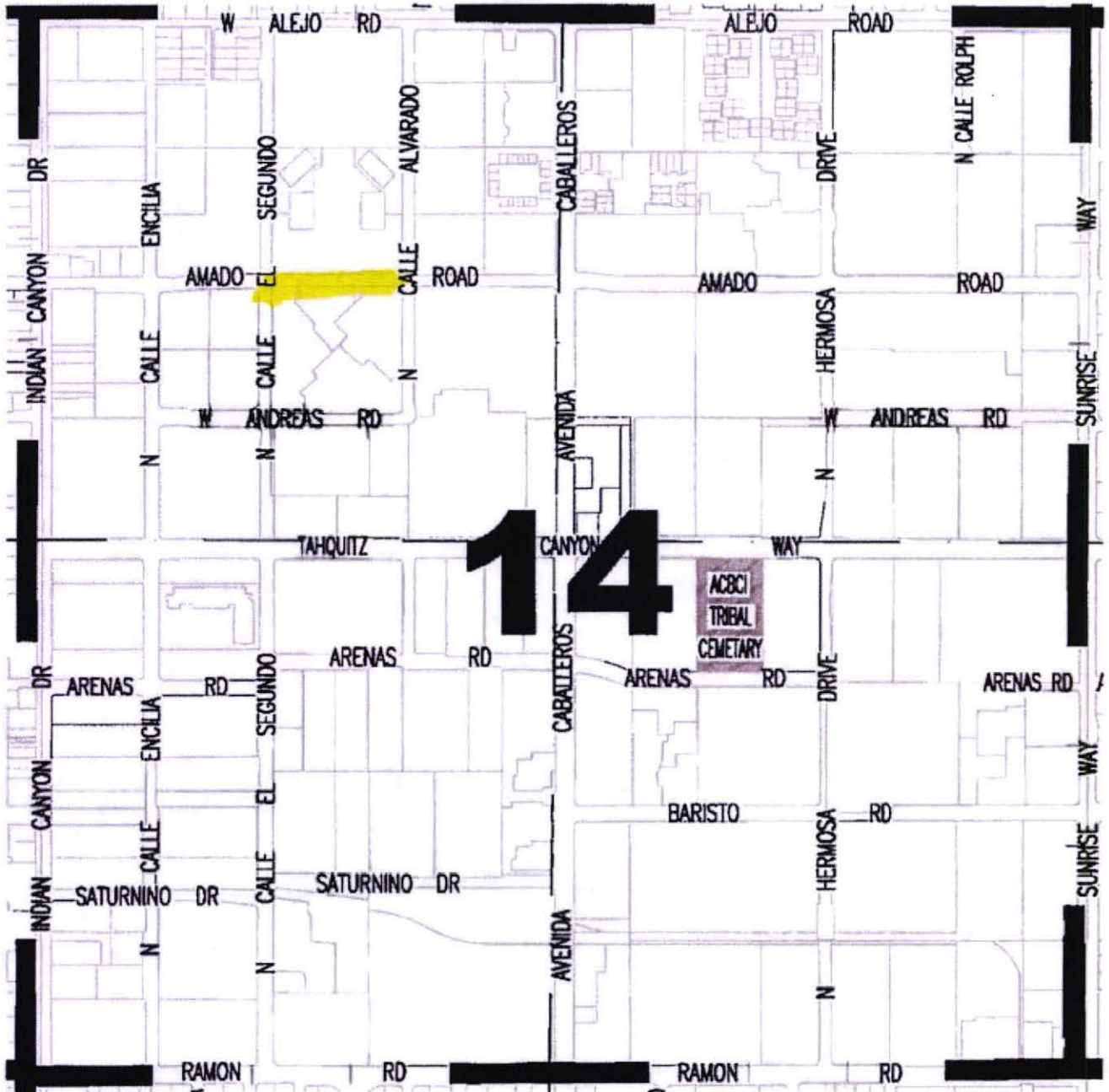



CITY OF PALM SPRINGS  
SECTION 13-T4S-R4E

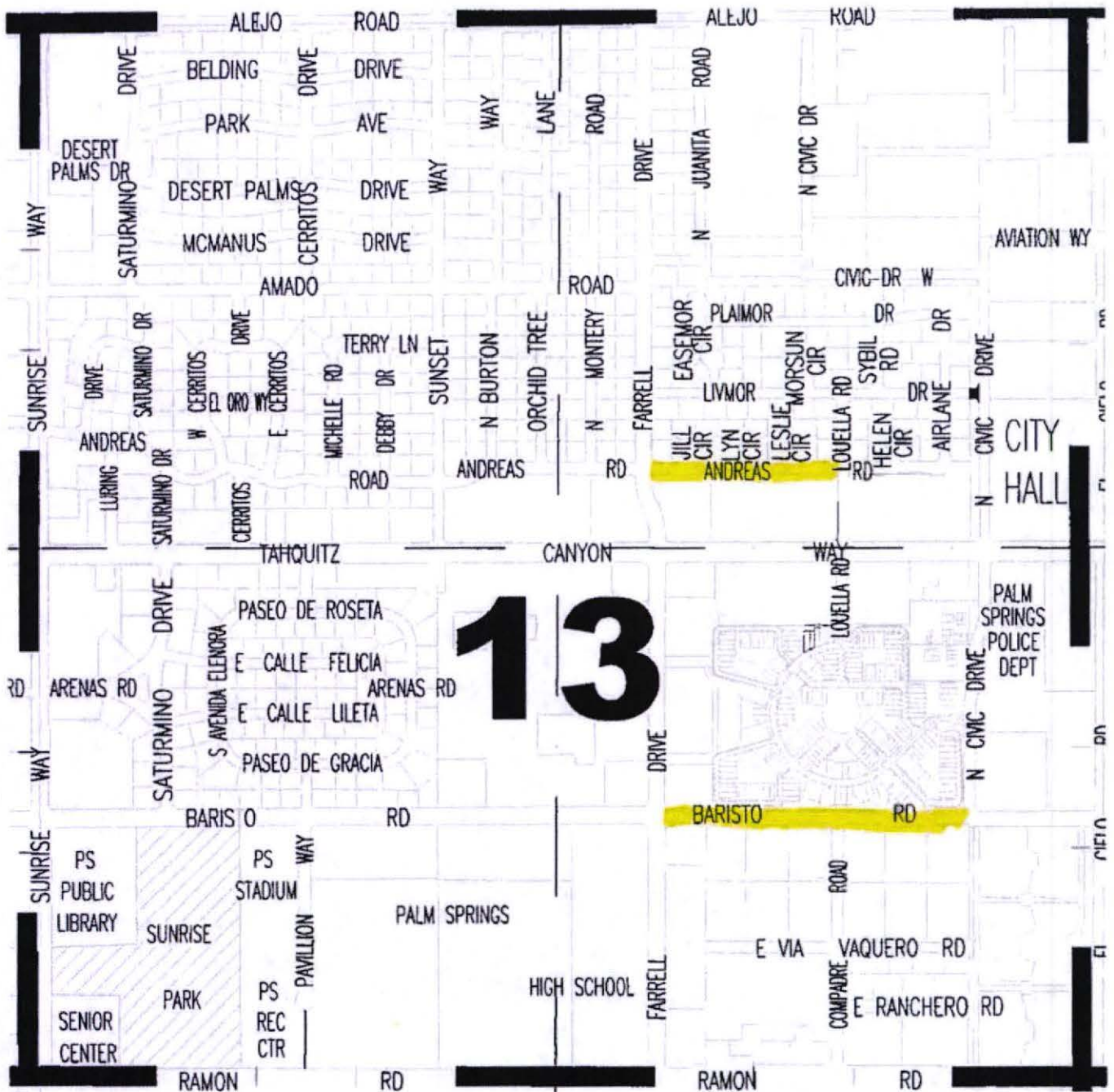

CITY OF PALM SPRINGS  
SECTION 18-T4S-R5E

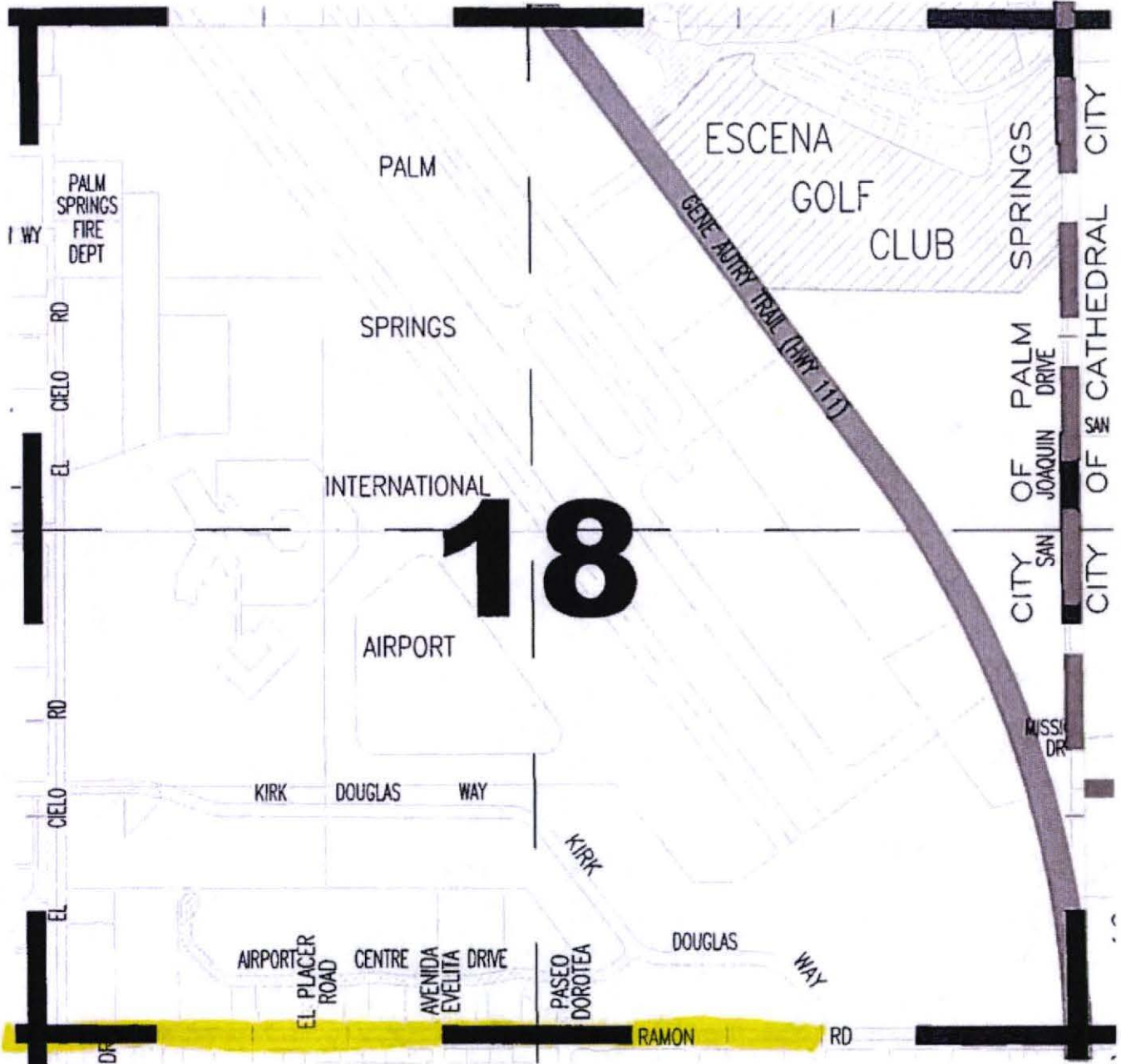





CITY OF PALM SPRINGS  
SECTION 24-T4S-R4E

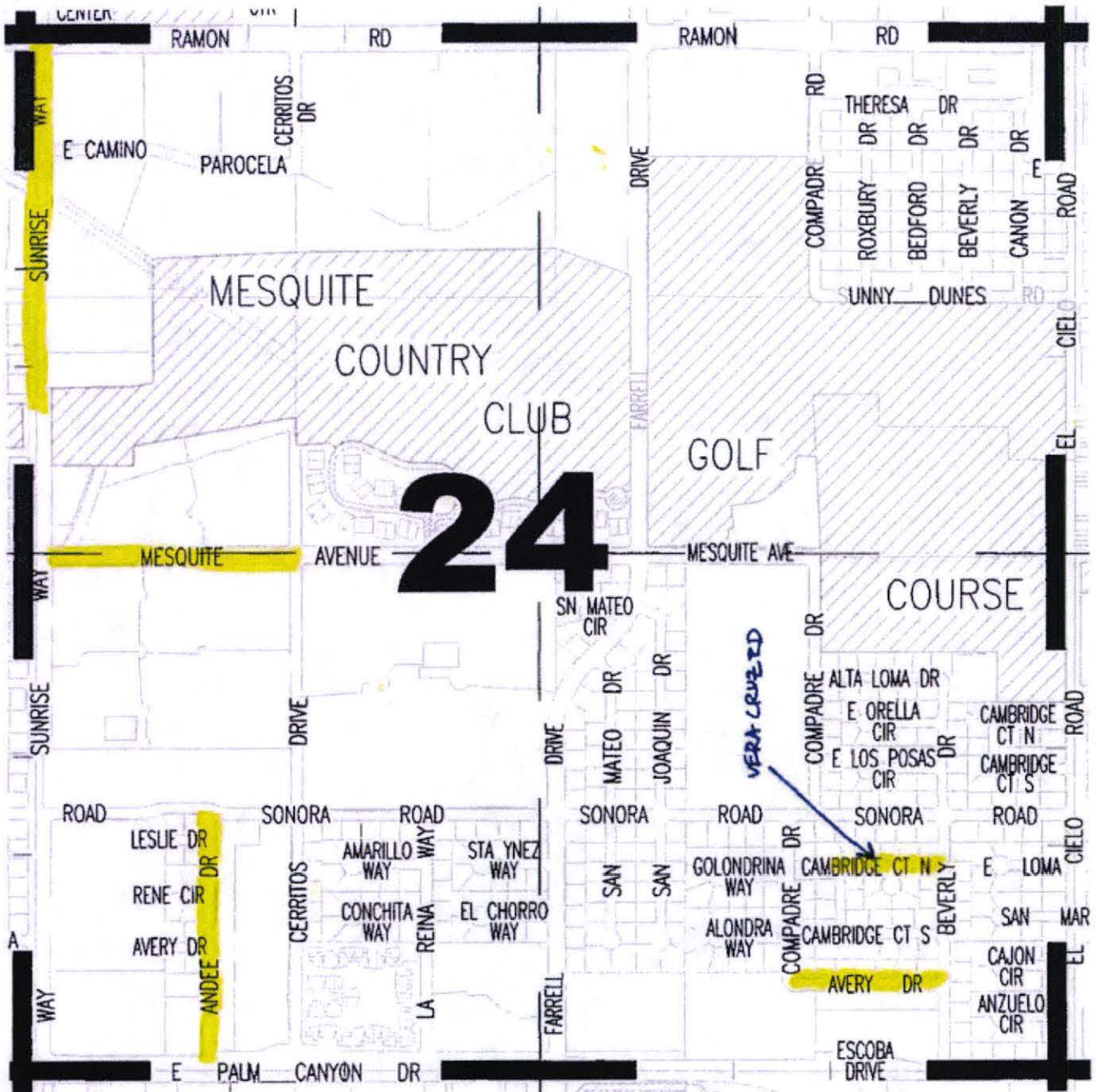



CITY OF PALM SPRINGS  
SECTION 25-T4S-R4E

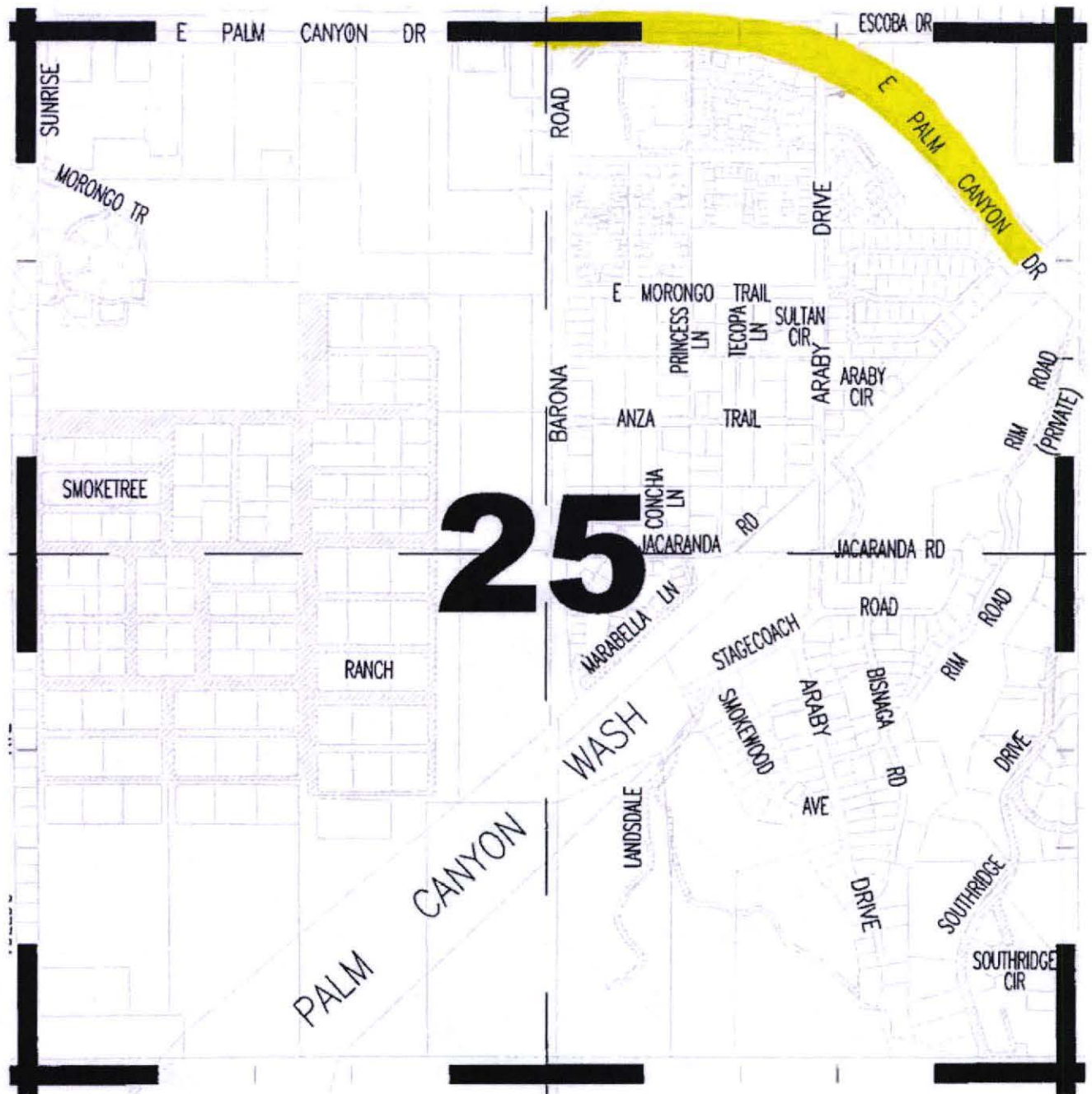

CITY OF PALM SPRINGS  
SECTION 19-T4S-R5E

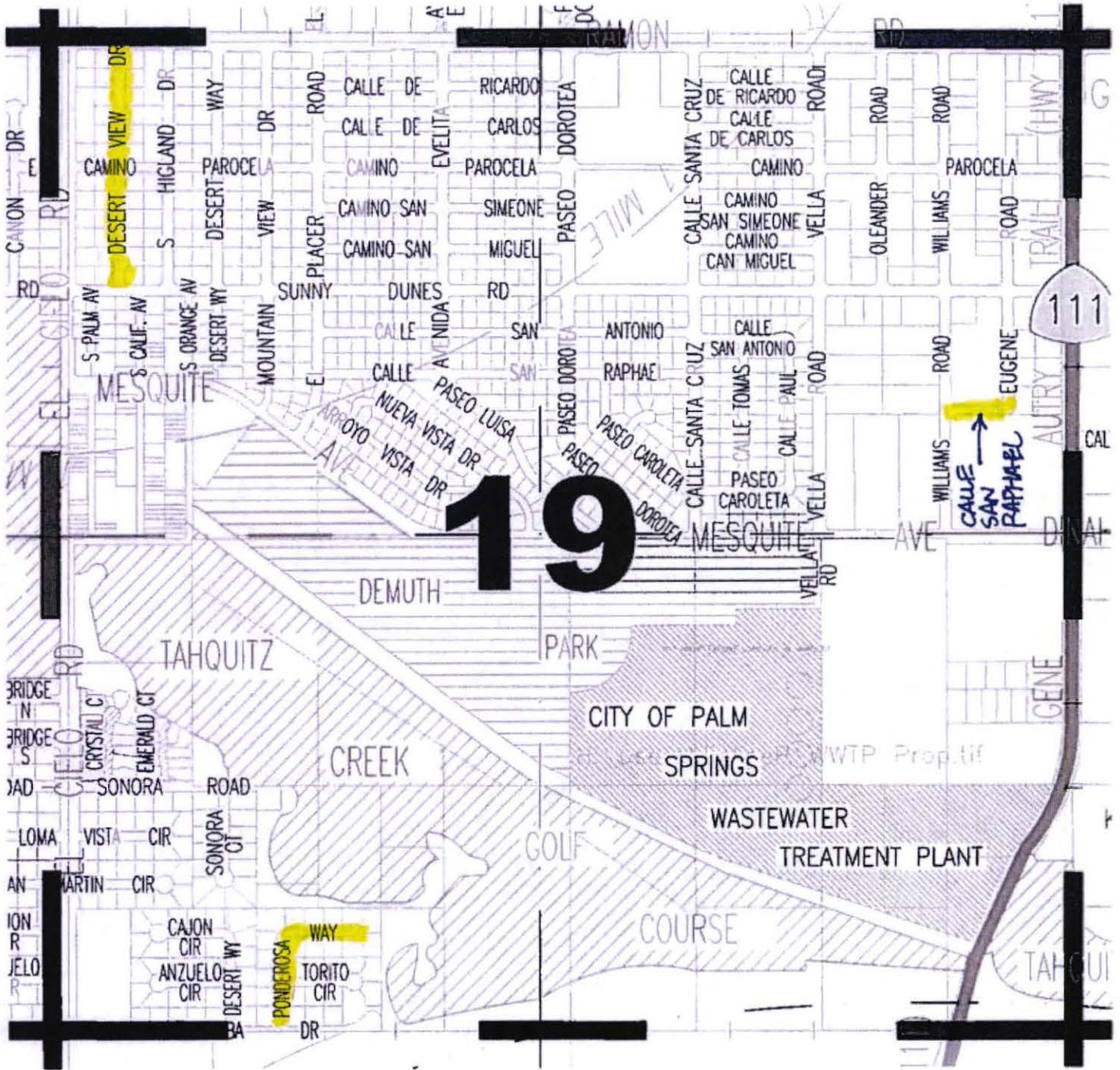



CITY OF PALM SPRINGS  
SECTION 27-T4S-R4E

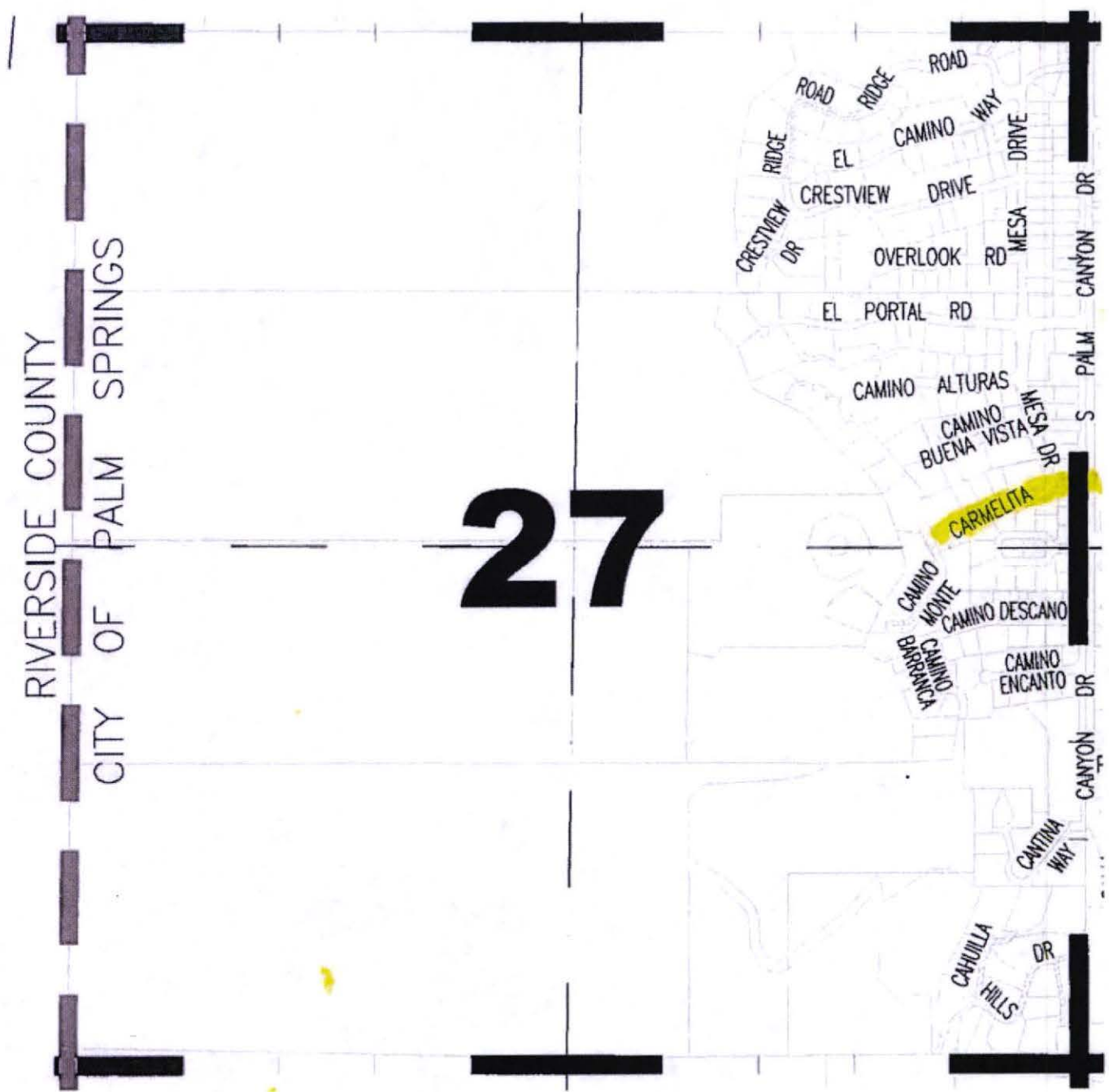

CITY OF PALM SPRINGS  
SECTION 26-T4S-R4E

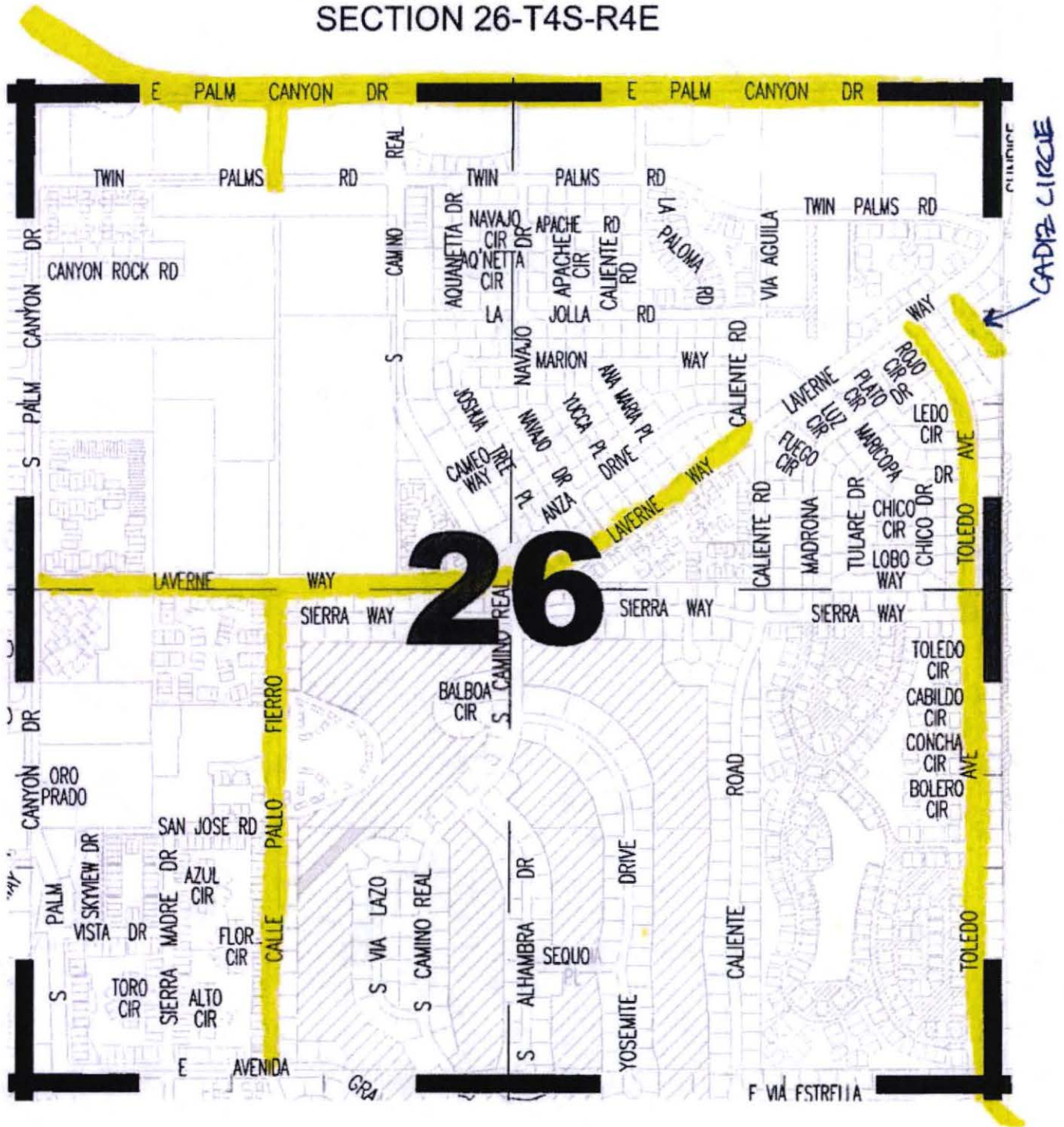



CITY OF PALM SPRINGS  
SECTION 35-T4S-R4E

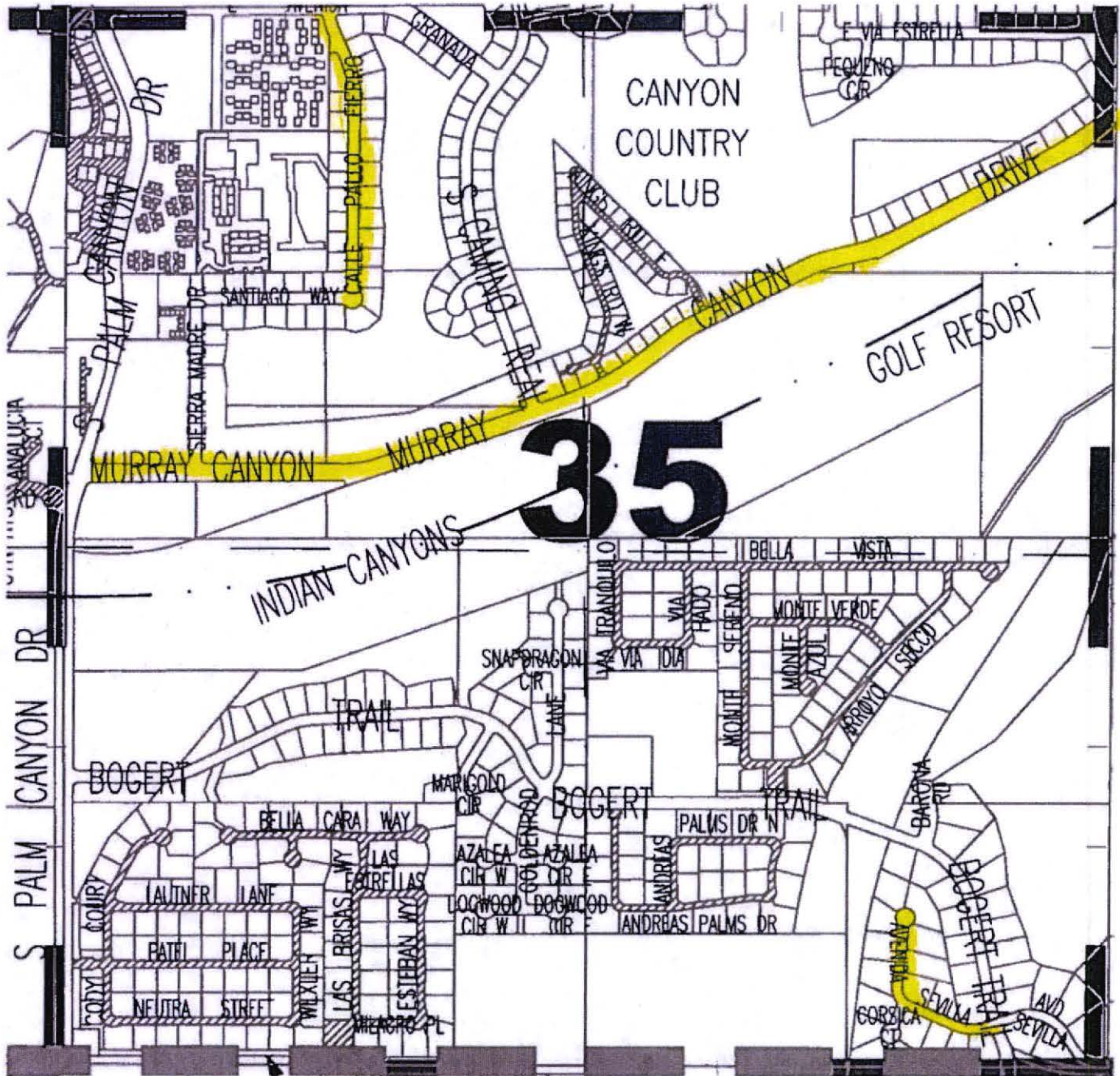

CITY OF PALM SPRINGS  
CP 14-03 SLURRY SEAL  
MAP

SECTION 29-T4S-R5E

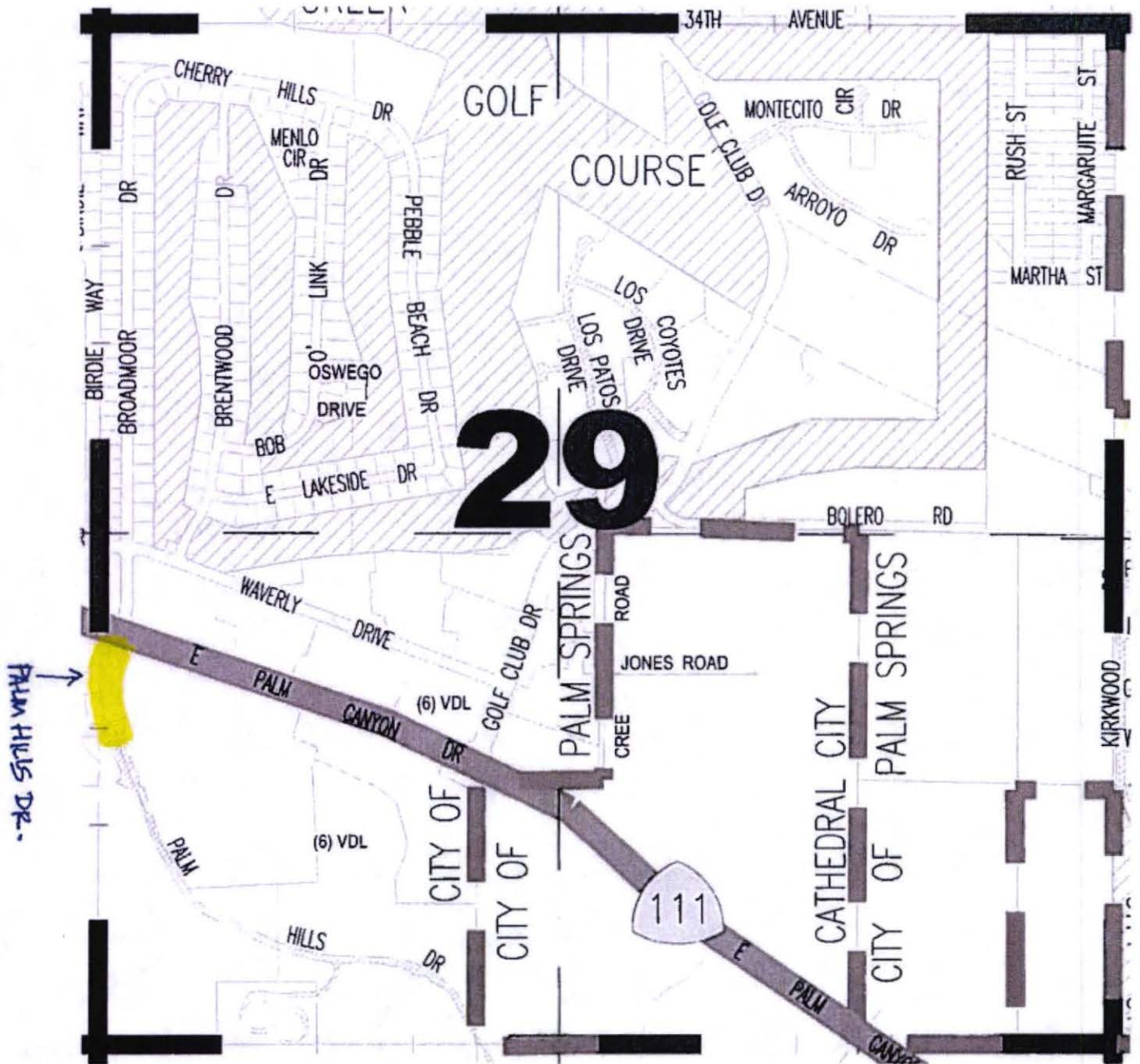



# **ATTACHMENT 2**

2015 CITYWIDE ANNUAL SLURRY SEAL

CITY PROJECT 15-02

BID SUMMARY

Bid Opening: August 27, 2015

BID ITEM	BID SCHEDULE (CONTIN.) ITEM DESCRIPTION	QUANT.	UNIT	ENG. Estim.	INTERMOUNTAIN SLURRY SEAL		AMERICAN ASPHALT SOUTH		PAVEMENT COATINGS CO.	
					UNIT PR.	TOTAL	UNIT PR.	TOTAL	UNIT PR.	TOTAL
1	Mobilization	1	LS		\$30,000.00	\$30,000.00	\$37,785.00	\$37,785.00	\$8,300.00	\$8,300.00
2	Temporary Traffic Control	1	LS		\$175,783.64	\$175,783.64	\$90,000.00	\$90,000.00	\$203,125.00	\$203,125.00
3	Uniform Micro-Milling 1/2" of Existing Asphalt Concrete Pavement	4,900,000	SF		\$0.05	\$245,000.00	\$0.13	\$612,500.00	\$0.11	\$558,600.00
4	Crack-sealing and crack-filling construction of Rubber Polymer Modified Slurry (RPMS), and all appurtenant work.	4,900,000	SF		\$0.21	\$1,029,000.00	\$0.22	\$1,078,000.00	\$0.22	\$1,097,600.00
5	Install Type E Detector Loop	122	EA		\$403.03	\$49,169.66	\$300.00	\$36,600.00	\$258.50	\$31,537.00
6	Removal of all existing traffic striping and pavement markings; installation of new traffic striping; and installation of thermoplastic pavement markings.	1	LS		\$231,113.70	\$231,113.70	\$240,000.00	\$240,000.00	\$230,900.00	\$230,800.00
<b>\$2,400,000.00</b>					<b>TOTAL</b>	<b>\$1,760,067.00</b>	<b>TOTAL</b>	<b>\$2,094,885.00</b>	<b>TOTAL</b>	<b>\$2,130,062.00</b>

1

2

3

Minimum Unit Price	Average Unit Price	Maximum Unit Price	Low Bidder Unit Price
\$8,300.00	\$49,617.00	\$147,000.00	\$30,000.00
\$90,000.00	\$180,181.73	\$302,000.00	\$175,783.64
\$0.05	\$0.11	\$0.13	\$0.05
\$0.21	\$0.24	\$0.29	\$0.21
\$240.00	\$297.31	\$403.03	\$403.03
\$230,900.00	\$278,951.74	\$443,745.00	\$231,113.70

BID ITEM	BID SCHEDULE (CONTIN.) ITEM DESCRIPTION	QUANT.	UNIT	ENG. Estim.	ALL AMERICAN ASPHALT		TELFER HIGHWAY TECHNOLOGIES	
					UNIT PR.	TOTAL	UNIT PR.	TOTAL
1	Mobilization	1	LS		\$147,000.00	\$147,000.00	\$25,000.00	\$25,000.00
2	Temporary Traffic Control	1	LS		\$130,000.00	\$130,000.00	\$302,000.00	\$302,000.00
3	Uniform Micro-Milling 1/2" of Existing Asphalt Concrete Pavement	4,900,000	SF		\$0.12	\$588,000.00	\$0.12	\$568,400.00
4	Crack-sealing and crack-filling construction of Rubber Polymer Modified Slurry (RPMS), and all appurtenant work.	4,900,000	SF		\$0.26	\$1,274,000.00	\$0.29	\$1,421,000.00
5	Install Type E Detector Loop	122	EA		\$240.00	\$29,280.00	\$285.00	\$34,770.00
6	Removal of all existing traffic striping and pavement markings; installation of new traffic striping; and installation of thermoplastic pavement markings.	1	LS		\$239,000.00	\$239,000.00	\$443,745.00	\$443,745.00
<b>TOTAL</b>					<b>\$2,407,280.00</b>	<b>\$2,407,280.00</b>	<b>TOTAL</b>	<b>\$2,794,915.00</b>

4

5



# **ATTACHMENT 3**

**AGREEMENT  
(CONSTRUCTION CONTRACT)**

**THIS AGREEMENT** made this \_\_\_ day of \_\_\_\_\_, 2015, by and between the City of Palm Springs, a charter city, organized and existing in the County of Riverside, under and by virtue of the laws of the State of California, hereinafter designated as the City, and Intermountain Slurry Seal, Inc., a Wyoming corporation, hereinafter designated as the Contractor.

The City and the Contractor, in consideration of the mutual covenants hereinafter set forth, agree as follows:

**ARTICLE 1 -- THE WORK**

For and in consideration of the payments and agreements to be made and performed by City, Contractor agrees to furnish all materials and perform all work required to complete the Work as specified in the Contract Documents, and as generally indicated under the Bid Schedule(s) for the Project entitled:

**2015 CITYWIDE ANNUAL SLURRY SEAL  
CITY PROJECT NO. 15-02**

The Work includes application of weed killer to all pavement cracks or joints; cleaning, routing, and installation of crack-sealant and asphalt pavement in all pavement cracks or joints ¼" or wider; uniform micro-milling of existing asphalt concrete pavement; construction of Rubber Polymer Modified Slurry (RPMS); removal and replacement of existing traffic striping and markings; and all appurtenant work on various City streets.

**ARTICLE 2 -- COMMENCEMENT AND COMPLETION**

The Work to be performed under this Contract shall commence on the date specified in the Notice to Proceed by the City, and the Work shall be fully completed within the time specified in the Notice to Proceed.

The City and the Contractor recognize that time is of the essence of this Agreement, and that the City will suffer financial loss if the Work is not completed within the time specified in Article 2, herein, plus any extensions thereof allowed in accordance with applicable provisions of the Standard Specifications, as modified herein. They also recognize the delays, expense, and difficulties involved in proving in a legal proceeding the actual loss suffered by the City if the Work is not completed on time. Accordingly, instead of requiring any such proof, the City and the Contractor agree that as liquidated damages or delay (but not as a penalty), the Contractor shall pay the City the sum specified in Section 6-9 of the Special Provisions for each calendar day that expires after the time specified in Article 2, herein. In executing the Agreement, the Contractor acknowledges it has reviewed the provisions of the Standard Specifications, as modified herein, related to liquidated damages, and has made itself aware of the actual loss incurred by the City due to the inability to complete the Work within the time specified in the Notice to Proceed.



### **ARTICLE 3 -- CONTRACT PRICE**

The City shall pay the Contractor for the completion of the Work, in accordance with the Contract Documents, in current funds the Contract Price(s) named in the Contractor's Bid Proposal and Bid Schedule(s), and any duly authorized Construction Contract Change Orders approved by the City. The amount of the initial contract award in accordance with the Contractor's Bid Proposal is **One Million Seven Hundred Sixty Thousand Sixty Seven Dollars (\$1,760,067).**

Contractor agrees to receive and accept the prices set forth herein, as full compensation for furnishing all materials, performing all work, and fulfilling all obligations hereunder. Said compensation shall cover all expenses, losses, damages, and consequences arising out of the nature of the Work during its progress or prior to its acceptance including those for well and faithfully completing the Work and the whole thereof in the manner and time specified in the Contract Documents; and, also including those arising from actions of the elements, unforeseen difficulties or obstructions encountered in the prosecution of the Work, suspension or discontinuance of the Work, and all other unknowns or risks of any description connected with the Work.

### **ARTICLE 4 -- THE CONTRACT DOCUMENTS**

The Contract Documents consist of the Notice Inviting Bids, Instructions to Bidders, the prevailing rate of per diem wages as determined by the Director of the California Department of Industrial Relations, the accepted Bid and Bid Schedule(s), List of Subcontractors, Local Business Preference Program – Good Faith Efforts, Non-Discrimination Certification, Non-Collusion Declaration, Bidder's General Information, Bid Security or Bid Bond, this Agreement, Worker's Compensation Certificate, Performance Bond, Payment Bond, Standard Specifications, Special Provisions, the Drawings, Addendum number 1, and all Construction Contract Change Orders and Work Change Directives which may be delivered or issued after the Effective Date of the Agreement and are not attached hereto.

### **ARTICLE 5 -- MUTUAL OBLIGATIONS**

For and in consideration of the payments and agreements to be made and performed by the City, the Contractor agrees to furnish all materials and perform all work required for the above stated project, and to fulfill all other obligations as set forth in the aforesaid Contract Documents.

City hereby agrees to employ, and does hereby employ, Contractor to provide the materials, complete the Work, and fulfill the obligations according to the terms and conditions herein contained and referred to, for the Contract Price herein identified, and hereby contracts to pay the same at the time, in the manner, and upon the conditions set forth in the Contract Documents.

Contractor specifically acknowledges and agrees to be bound by the Wage Rates and Labor Code requirements specified in the Contract Documents, including the requirement to furnish electronic certified payroll records directly to the Labor Commissioner (via the Division of Labor Standards Enforcement), and shall pay the general prevailing rate of per diem wages as determined by the Director of the Department of Industrial Relations of the State of California.

**ARTICLE 6 -- PAYMENT PROCEDURES**

The Contractor shall submit Applications for Payment in accordance with the Standard Specifications as amended by the Special Provisions. Applications for Payment will be processed by the City Engineer as provided in the Contract Documents.

**ARTICLE 7 -- NOTICES**

Whenever any provision of the Contract Documents requires the giving of a written Notice between the parties, it shall be deemed to have been validly given if delivered in person to the individual or to a member of the firm or to an officer of the corporation for whom it is intended, or if delivered at or sent by registered or certified mail, postage prepaid, to the last business address known to the giver of the Notice.

**ARTICLE 8 -- INDEMNIFICATION**

The Contractor agrees to indemnify and hold harmless the City, and all of its officers and agents from any claims, demands, or causes of action, including related expenses, attorney's fees, and costs, based on, arising out of, or in any way related to the Work undertaken by the Contractor hereunder. This Article 8 incorporates the provisions of Section 7-15 "Indemnification," of the Special Provisions, which are hereby referenced and made a part hereof.

**ARTICLE 9 -- NON-DISCRIMINATION**

The Contractor represents and agrees that it does not and will not discriminate against any subcontractor, consultant, employee, or applicant for employment because of race, religion, color, sex, or national origin in any matter including without limitation employment upgrading, demotion, transfers, recruitment, recruitment advertising, layoff, termination, rates of pay, or other forms of compensation and selection for training, including apprenticeship.

**ARTICLE 10 -- MISCELLANEOUS**

Terms used in this Agreement which are defined in the Standard Specifications and the Special Provisions will have the meanings indicated in said Standard Specifications and the Special Provisions. No assignment by a party hereto of any rights under or interests in the Contract Documents will be binding on another party hereto without the written consent of the party sought to be bound; and specifically, but without limitation, monies that may become due and monies that are due may not be assigned without such



consent (except to the extent that the effect of this restriction may be limited by law), and unless specifically stated to the contrary in any written consent to an assignment, no assignment will release or discharge the assignor from any duty or responsibility under the Contract Documents.

The City and the Contractor each binds itself, its partners, successors, assigns, and legal representatives, to the other party hereto, its partners, successors, assigns, and legal representatives, in respect of all covenants, agreements, and obligations contained in the Contract Documents.

***SIGNATURES ON NEXT PAGE***

**IN WITNESS WHEREOF**, the City and the Contractor have caused this Agreement to be executed the day and year first above written.

**CITY OF PALM SPRINGS,  
CALIFORNIA**

**APPROVED BY THE CITY COUNCIL:**

By \_\_\_\_\_  
David H. Ready  
City Manager

Date \_\_\_\_\_

Agreement No. \_\_\_\_\_

**ATTEST:**

By \_\_\_\_\_  
James Thompson  
City Clerk

**APPROVED AS TO FORM:**

By \_\_\_\_\_  
Douglas Holland  
City Attorney

**RECOMMENDED:**

By \_\_\_\_\_  
Marcus L. Fuller, PE, PLS  
Assistant City Manager/City Engineer



**CONTRACTOR**

By: \_\_\_\_\_  
Intermountain Slurry Seal, Inc.

By: \_\_\_\_\_  
Signature (notarized)

By: \_\_\_\_\_  
Signature (notarized)

Name: \_\_\_\_\_

Name: \_\_\_\_\_

Title: \_\_\_\_\_

Title: \_\_\_\_\_

A notary public or other officer completing this certificate verifies only the identity of the individual who signed the document to which this certificate is attached, and not the truthfulness, accuracy or validity of that document.

(This Agreement must be signed in the above space by one having authority to bind the Contractor to the terms of the Agreement.)

(This Agreement must be signed in the above space by one having authority to bind the Contractor to the terms of the Agreement.)

State of \_\_\_\_\_ )  
County of \_\_\_\_\_ )ss

State of \_\_\_\_\_ )  
County of \_\_\_\_\_ )ss

On \_\_\_\_\_  
before me, \_\_\_\_\_  
personally appeared \_\_\_\_\_

On \_\_\_\_\_  
before me, \_\_\_\_\_  
personally appeared \_\_\_\_\_

who proved to me on the basis of satisfactory evidence to be the person(s) whose name(s) is/are subscribed to the within instrument and acknowledged to me that he/she/they executed the same in his/her/their authorized capacity(ies), and that by his/her/their signatures(s) on the instrument the person(s), or the entity upon behalf of which the person(s) acted, executed the instrument.

who proved to me on the basis of satisfactory evidence to be the person(s) whose name(s) is/are subscribed to the within instrument and acknowledged to me that he/she/they executed the same in his/her/their authorized capacity(ies), and that by his/her/their signatures(s) on the instrument the person(s), or the entity upon behalf of which the person(s) acted, executed the instrument.

I certify under PENALTY OF PERJURY under the laws of the State of California that the foregoing paragraph is true and correct.

I certify under PENALTY OF PERJURY under the laws of the State of California that the foregoing paragraph is true and correct.

WITNESS my hand and official seal.  
Notary Signature:

WITNESS my hand and official seal.  
Notary Signature:

Notary Seal:

Notary Seal:

# **ATTACHMENT 4**

Additional Street for Slurry Seal (CP 15-01)

ADDITIONAL STREETS TO BE SLURRY SEALED FROM BID SAVINGS								
NAME	FROM	TO	LENGTH	WIDTH	TRUE AREA	PCI	ACCUM. AREA	**COST
<b>ARTERIAL/COLLECTOR STREETS</b>								
E PALM CANYON DRIVE	E/S S PALM CANYON DRIVE	E/S CAMINO REAL	2,000	64	128,000	70	128,000	\$ 64,000.00
*VISTA CHINO	330' W/O EAST CITY LIMITS	EAST CITY LIMITS	330	65	21,450	70	149,450	\$ 74,725.00
CALLE EL SEGUNDO	N/S AMADO ROAD	S/S ALEJO ROAD	1,229	60	73,740	71	223,190	\$ 111,595.00
AVENIDA CABALLEROS	N/S VIA ESCUELA	S/S RACQUET CLUB ROAD	1,348	60	80,760	72	303,950	\$ 151,975.00
AVENIDA CABALLEROS	N/S RACQUET CLUB ROAD	S/S FRANCIS DRIVE	1,327	60	79,620	72	383,570	\$ 191,785.00
CROSSLEY ROAD	N/S 34TH AVENUE	S/S DINAH SHORE DRIVE	2,750	56	154,000	72	537,570	\$ 268,785.00
EAST PALM CANYON DRIVE	PALM CANYON WASH	W/S CHEROEE WAY	3,090	71	261,298	72	798,868	\$ 399,434.00
EAST PALM CANYON DRIVE	W/S CHEROKEE WAY	W/S GENE AUTRY TRAIL	1,988	71	183,057	72	981,925	\$ 490,962.50
*RAMON ROAD	E/S S. PALM CANYON DRIVE	W/S S INDIAN CANYON DRIVE	309	60	18,540	72	1,000,465	\$ 500,232.50
SAN RAFAEL ROAD	E/S VIRGINIA ROAD	E/S PALM CANYON DRIVE	2,063	60	123,780	72	1,124,245	\$ 562,122.50
							<b>1,124,245</b>	<b>\$ 562,122.50</b>
* DELETE IF NECESSARY TO MEET BUDGET LIMIT OF \$540,000.								
<b>ADDITIONAL STREETS IF MORE FUNDING BECOMES AVAILABLE:</b>								
<b>COLLECTOR STREETS</b>								
ANDREAS ROAD	614' W/O SUNRISE WAY	E/S HERMOSA DRIVE	638	60	38,280	72	38,280	\$ 19,140.00
CERRITOS ROAD	S/S FRANCIS DRIVE	N/S DEL LAGO ROAD	967	33	31,911	72	70,191	\$ 35,095.50
CERRITOS ROAD	S/S DEL LAGO ROAD	N/S RACQUET CLUB DRIVE	277	33	9,141	72	79,332	\$ 39,666.00
CERRITOS ROAD	S/S RACQUET CLUB DRIVE	N/S VIA ESCUELA	1,286	33	42,438	72	121,770	\$ 60,885.00
CERRITOS ROAD	S/S VIA ESCUELA	N/S VISTA CHINO	1,286	33	42,438	72	164,208	\$ 82,104.00
DE ANZA ROAD	S/S SEPULVEDA ROAD	N/S DOMINGUEZ ROAD	241	20	4,820	72	169,028	\$ 84,514.00
FRANCIS DRIVE	E/S FARRELL DRIVE	E END	138	33	4,554	72	173,582	\$ 86,791.00
FRANCIS DRIVE	E/S INDIAN CANYON DRIVE	W/S AVENIDA CABALLEROS	2,606	34	88,604	72	262,186	\$ 131,093.00
FRANCIS DRIVE	W/S AVENIDA CABALLEROS	W/S SUNRISE WAY	2,572	36	92,592	72	354,776	\$ 177,389.00
HERMOSA DRIVE	N/S RACQUET CLUB ROAD	S/S FRANCIS DRIVE	1,294	36	46,584	72	401,362	\$ 200,681.00
MESQUITE AVENUE	E/S VELLA ROAD	W/S GENE AUTRY TRAIL	1,240	60	74,400	72	475,762	\$ 237,881.00
RACQUET CLUB ROAD	E/S JUNIPERO AVENUE	E/S LEONARD ROAD	1,120	48	53,760	72	529,522	\$ 264,761.00
RAMON ROAD	W/S S PALM CANYON DRIVE	E/S RELARDO ROAD	282	60	16,920	72	546,442	\$ 273,221.00
TAMARISK ROAD	W/S SUNRISE WAY	E/S AVENIDA CABALLEROS	2,585	28	76,331	72	622,473	\$ 311,236.50
VIA MIRALETE	N/S MEL AVENUE	S/S PASEO EL MIRADOR	370	64	23,680	72	646,153	\$ 323,076.50
VIA MIRALETE	N/S TAMARISK ROAD	N/S ALEJO ROAD	1,338	36	48,168	72	694,321	\$ 347,160.50
TRAMVIEW ROAD	W/S INDIAN CANYON ROAD	1486' W/O INDIAN CANYON ROAD	1,486	36	53,496	73	747,817	\$ 373,908.50
							<b>747,817</b>	<b>\$ 373,908.50</b>
<b>**COST ESTIMATE OF \$0.50 PER SQ. FT. PROVIDED BY PUBLIC WORKS</b>								



# **ATTACHMENT 5**

MEMORANDUM

DATE: September 14, 2015

TO: Savat Khamphou, Assistant Director of Public Works/Assistant City Engineer

FROM: Curt Watts, Chair of ONE-PS Code Enforcement & Public Works Committee

Per our discussion of earlier today, attached is a copy of the additional streets suggested by our Committee for slurry sealing to utilize the approximate \$540,000 in recent bid savings on the project.

This list of suggested streets maintains the recent philosophy of focusing on arterial and collector streets when faced with limited budget funds available for slurry sealing (rather than prioritizing all streets with PCI ratings of 70 to 72 based on their alphabetical order and without regard to traffic loads).

As you and I discussed, based on your estimate of \$0.50 per square foot of street area, the estimated cost for slurry sealing the suggested additional streets total approximately \$20,000 over the \$540,000 budget. We hope that the final cost estimates will make it possible to cover the entire list of suggested additional streets, but if that is not the case, we would suggest that the two streets marked with an asterisk (\*) be eliminated first given their limited impact compared to the other streets on the list.

Should you need any additional information please don't hesitate to contact me at (760) 219-6250.

THANK YOU for this opportunity to provide comments on this important project for the neighborhoods and citizens of Palm Springs.

Curt Watts, Chairperson  
ONE-PS Code Enforcement & Public Works Committee

Attachment:

- List of Suggested Additional Streets for Slurry Sealing

# **ATTACHMENT 6**



September 17, 2015

Mr. Savat Khamphou  
Assistant Director of Public Works  
City of Palm Springs  
3200 E. Tahquitz Canyon Way  
Palm Springs, CA 92262

**Subject: Proposal for Construction Engineering Services – 2015 Slurry Seal, City Project No. 15-02**

Dear Mr. Khamphou:

Willdan Engineering is pleased to submit this proposal to provide professional construction engineering services for the subject project. Willdan's proposal includes the public works inspection of the application of slurry seal to various streets throughout the City of Palm Springs. We are proposing to utilize the services of Alberto Rosiles, Senior Public Works Inspector to provide the requested construction engineering services. Mr. Rosiles will be on the project full-time and has over 35 years of public works construction experience.

Willdan's proposal is based on the City's original 60 working day construction schedule, plus an additional 20 working days required for the additional streets that may be added to the contract.

The following is our proposed scope of work and estimated fee:

#### **SCOPE OF WORK**

##### **TASK #1 - Construction Management**

1. Assist the City with public awareness and information program to keep residents and local stakeholders advised of project status along with the impacts to traffic flow circulation, including answering questions from the public about the project.
2. Prepare the construction file.
3. Ensure that the contractor distributes public construction notices and places construction and information signs.
4. Prepare special concerns to be presented at the preconstruction conference.
5. Conduct meeting and prepare preconstruction meeting minutes and distribute to attendees.
6. Review contractor's safety program in consultation with City staff.

7. Through Willdan's system of project control, monitor activities related to the project such that the project is constructed pursuant to contract documents, LAPM, and in a timely fashion.
8. Log, track, and process submittals, RFIs, RFCs, CCOs, field directives, NOPCs, Non-Conformance Reports (NCRs), construction schedule, and detailed traffic control plan.
9. Closely review schedule and advise contractor to take action on schedule slippage.
10. Document contractor's 20-day notices, mechanic's liens, and stop notices.
11. Monitor and coordinate activities of design engineering support, surveying, testing, and work by utilities or other agencies.
12. Prepare weekly statement of working days and submit to the contractor and the City.
13. Provide monthly progress report.
14. Establish and conduct weekly construction progress meetings to:
  - Resolve all old business issues to the maximum extent possible
  - Address all items of new business as presented by any party
  - Review project schedule and address any deviations
  - Review submittal log in terms of items needed and resubmittals required and review RFI, RFC, CCO, NCR, and NOPC logs
  - List status of construction items recently undertaken or ongoing
  - List planned construction items for the next two weeks, usually known as the two-week look ahead schedule
  - Review SWPPP issues
  - Review contractor's safety program
15. Prepare minutes for the weekly construction progress meeting.
16. Provide claims mitigation monitoring, including proactively applying foresight to discover unforeseen conflicts prior to contractor encounter.
17. Evaluate and respond to the contractor's requests for clarification of plans and specifications.
18. Ensure that all questions, conflicts, and issues are immediately brought to the City's attention and addressed with appropriate directives to the contractor.
19. Conduct special site meetings, when necessary, with the contractor and City staff to review job progress, scheduling, and coordination.
20. Perform quantity, time, and cost analyses required for negotiation of contract changes.
21. Negotiate and prepare change orders, including memorandum of explanation and cost estimates to substantiate change order costs and provide to City for review.

22. Monitor and perform immediate and thorough analysis of validity of all potential claims that arise.
23. Maintain all data for change orders and record information with regard to the time of dispute, time of notification by the contractor, and action taken by the inspector.
24. Monitor materials documentation and testing results and enforce corrections.
25. Review for approval the contractor's progress payment requests, including verifying LAPM compliance status and impact on payment; negotiate differences over the amount with the contractor; and process payments through the City's Project Manager.
26. Monitor preparation of a punch list at substantial completion and follow up.
27. Routinely review construction files to ensure conformance to City standards and good construction management practice.
28. Ensure City received as-built set of drawings at completion.
29. Assist City with stop notices and release of retention.
30. Provide memorandum of clearance to issue the notice of completion.
31. Finalize and deliver all construction files and supplies to the City for their records.

**TASK #2 - Construction Inspection**

1. Review plans, specifications, and all other contract- and construction-related documents.
2. Conduct a field investigation of the project area to become familiar with the existing facilities and the project environment.
3. Become familiar with traffic control plans, construction schedule, construction sequence, and permit requirements from other agencies.
4. Verify that the contractor conforms to the design survey line and grades.
5. Attend weekly progress meetings with the resident engineer, contractor, and subcontractors.
6. Provide full-time and as-needed construction inspection, including night inspection, of the work to monitor materials and methods for compliance with plans, specifications, and contract documents; address and document non-conforming items as they are discovered.
7. Monitor compliance with Cal OSHA requirements and compliance with all local, state, and federal regulations. Although Willdan will monitor the activities, it is the contractor's sole responsibility to provide workers with a safe working environment.



8. Provide Willdan's labor compliance manager with federally-compliant labor and equipment reports, labor classification interviews, and assist with certified payroll review.
9. Monitor compliance with the Clean Air Act and the Clean Water Act (National Pollutant Discharge Elimination System – NPDES best management practices). Also, monitor the contractor's compliance with approved SWPPP.
10. Meet with the contractor at the beginning of each day and review the proposed work plan, including specific details that may affect progress.
11. Conduct daily measurements of quantities of work with the contractor.
12. Review actual contractor performance throughout the day and discuss discrepancies with the contractor as they occur.
13. Assist in coordination of engineering support, surveying, specialty inspections, and fieldwork by utility companies.
14. Ensure compliance of Underground Service Alert notification/delineation.
15. Evaluate the contractor's operation and production with respect to quality and progress and report to the resident engineer.
16. Photograph continuous property frontages along the street alignment once prior to construction and once immediately following construction. Maintain a photographic record of key elements of each major operation of work each day, with increased detail in situations of potential changes or claims.
17. Closely monitor testing results and require the contractor to provide corrective measures to achieve compliance.
18. Maintain copies of all permits needed to construct the project and enforce special requirements of each.
19. Prepare and maintain detailed daily diary inspector reports on construction progress.
20. Prepare clear and concise letters and memoranda, as needed. Establish a solid paper trail.
21. Maintain field file bound workbooks during construction, including a cumulative record of quantities constructed, daily and weekly reports, working day reports, change order documentation, photographs, and other documentation.
22. Review the construction schedule and enforce requirements for updating schedules and maintaining appropriate progress of the work.
23. Analyze delays and review claims on a timely basis and make recommendations to the construction manager.
24. Assist with the review and evaluation of change order work.

25. Provide complete measurements and calculations documented to administer progress payments.
26. Maintain and submit a clean set of plans marked in red for as-built corrections on record drawings to be filed with the City. (City's design consultant will transfer the contractor's record drawings to original Mylar drawings.)
27. Prepare a punch list at substantial completion and follow up with the contractor regarding progress of corrections.
28. Schedule a final inspection with the City and applicable agencies; prepare, distribute, and inspect corrections to the final punch list for completion; and recommend final acceptance.
29. Prepare documentation for final payment to the contractor.
30. Upon project completion, provide the finished set of project workbooks to the City.
31. Provide random material testing services.

#### **PROJECT TEAM**

Willdan proposes the following team members.

**Mr. Christopher Baca, RCI**, will serve as the **Construction Manager**. Mr. Baca has over 28 years of construction management experience including construction management of large-scale projects in areas of water systems, street improvements, park improvements, storm drains, sanitary sewers, asphalt resurfacing (including asphalt-rubber products), concrete paving, landscaped medians, and traffic signals. In addition to his experience with Community Development Block Grant (CDBG) funded projects, Mr. Baca is also familiar with the inspection and contract administration of other federally-funded projects in accordance with Caltrans Local Program Manual. Mr. Baca's recent experience includes the City of Rialto's Pepper Avenue Extension Project. The project extended Pepper Avenue ½ mile crossing the Lytle Creek drainage endangered species habitat to CA 210. Approximately 100,000 cubic yards of import soil, four 10' by 10' reinforced box culverts and a Verdura Wall were used to span the drainage area. The project included 2,814 feet of curb, gutter, sidewalk, AC paving parkway landscaping and irrigation, as well as a new water line, sewer line, SCE conduits and street lighting. This project was the result of 12 years of planning and design with an overall \$15 million budget and a construction cost of \$7 million.

**Mr. Alberto Rosiles, Senior Public Works Observer** has over 30 years of experience in the construction industry here in southern California. Mr. Rosiles' experience includes street rehabilitation projects in various cities where his responsibilities included quality control, quantity calculations, and project management. His areas of expertise includes A.C. heater remix, A.C. rubber paving, overlay, P.C.C., slurry seal, underground facilities, cast-in-place pipe, A.C. and P.C.C. batch plant inspection, roadways, highways, bridges, landscape, and vertical construction.

**FEE**

Our proposed not-to-exceed fee for the Scope of Work identified above is **\$77,056.00** and is based on a construction timeline of 60 working days. Invoices will be submitted monthly with back-up information substantiating all charges to date. All work associated with this proposal will be performed pursuant to Willdan's current City of Palm Springs on-call construction engineering contract. The following is Willdan's cost breakdown to provide construction engineering services:

<b>Classification</b>	<b>Rate</b>	<b>Hrs.</b>	<b>Total</b>
Construction Manager	\$154	64 Hrs.	\$9,856.00
Senior Public Works Observer	\$105	480 Hrs.	\$50,400.00
Senior Public Works Observer (Additional Streets)	\$105	160 Hrs.	\$16,800.00
Testing			\$23,806.00
<b>Total Not-to-Exceed Fee</b>			<b>\$100,862.00</b>

Thank you for this opportunity to be of continuing service to the City of Palm Springs. We recognize the importance of this project to the City and are committed to realizing its timely and successful completion. Should you have any questions regarding this proposal, please contact Mr. Chris Baca at (562) 364-8198.

Respectfully submitted,

Approval and Authorization to Proceed By:

**WILLDAN ENGINEERING**

**CITY OF PALM SPRINGS**



Chris Baca  
Deputy Director of Construction Management

\_\_\_\_\_  
Signature

\_\_\_\_\_  
Date

Enclosure

91005\06-150\P15-193\_11733



## **Christopher D. Baca, RCI, CESSWI**

Deputy Director, Construction Management and Inspection Services

### **Education**

*BS, Public Administration,  
California State University,  
Fullerton*

*Public Works Inspection,  
California State University,  
Los Angeles Extension*

*Asphalt Paving, Contract  
Administration and Change  
Orders for Federally Funded  
Projects Seminars*

*Inspection Principles, Public  
Contact, Slurry Seal, and  
Traffic Signal Inspection and  
Design Seminars*

### **Registration/Certification**

*Registered Construction  
Inspector, Division IV, Public  
Works, California No. 4161*

*Registered Construction  
Inspector, Division I,  
Engineering, California No.  
5161*

*Certified Erosion, Sediment  
and Storm Water Inspector,  
No. 2957*

### **Affiliations**

*American Construction  
Inspectors Association*

**26 Years' Experience**

**Mr. Christopher D. Baca** is responsible for directing and monitoring public works inspection services and overseeing construction observation personnel. His experience includes construction management of large-scale projects in areas of water systems; street improvements; park improvements; storm drains; sanitary sewers; asphalt resurfacing, including asphalt-rubber products; concrete paving; landscaped medians; and traffic signals. In addition to his experience with Community Development Block Grant (CDBG) funded projects, Mr. Baca is also familiar with inspection and contract administration of other federally funded projects in accordance with Caltrans' Local Program Manual. During his 26 years of experience, Mr. Baca has served as a senior public works observer, as well as a permit inspector in the cities of Bell Gardens, Paramount, and Rosemead. Currently, Mr. Baca directs construction management and inspection services in Los Angeles and Orange Counties. He interfaces with California Department of Transportation on a regular basis.

Prior to joining Willdan, Mr. Baca worked for a soils engineering firm conducting field inspections and performing laboratory testing.

### **Relevant Project Experience**

#### **Capital Improvement Projects**

**I-210 Logistics Phase II, City of Rialto, California.** Project Manager. Willdan provided PS&E package for the City of Rialto's I-210 Logistics Phase II Project.

**Lakewood Boulevard Street Widening, City of Downey, California.** Project Manager responsible for overall oversight and scheduling of construction administration and inspection services for the project. The project involved installing 12-inch DIP potable water main, 8-inch DIP reclaimed water main, 24-inch RCP to new 28-foot catch basin, pedestrian lights, traffic signals; relocating utilities; removing curb, gutter, and sidewalk; and installing sidewalk with enhanced scoring and integral color-stamped ADA-compliant access ramps, landscaping with controls, bus stop, and asphalt paving with 2-inch ARHM cap.

**Ninth Street Improvements, City of Highland, California.** Project Manager responsible for overall oversight and scheduling of construction administration and inspection services for the City of Highland's 9th Street Project. The project involved the removal and replacement of damaged asphalt, repair of existing concrete improvements, asphalt overlay and slurry seal installation. Willdan tracked quantities, provided claims mitigation, responded to RFI's, track submittals, and maintained the construction file.

**Transit Priority, City of Santa Monica, California.** Project Manager responsible for overall oversight and scheduling of construction administration and inspection services for the City's Transit Priority Project. The project involved the installation of new fiber optic, some minor traffic signal modification and other appurtenant work. In addition to construction management services, Willdan provided public outreach services to the local businesses and residents.

**Bradford/Madison Street Improvement, City of Placentia, California.** Project Manager responsible for overall oversight and scheduling of construction administration and inspection services for the Bradford/Madison Street Improvement Project. Willdan provided labor compliance, construction management, and construction inspection services for the ARRA funded project. The project involved

Christopher D. Baca, RC1  
*Continued*

the removal and replacement of damaged street sections, asphalt overlay, miscellaneous concrete repairs to sidewalks and curbs, planting of street trees, and other appurtenant work.

**Tustin Metrolink Station, Griffin Holdings Inc.** Project Manager responsible for overall oversight and scheduling of construction administration and inspection services for installation of various underground facilities.

**Third Street Improvement, City of Calimesa, California.** Project Manager responsible for overall oversight and scheduling of construction administration and inspection services for the Third Street Improvement Project. Willdan provided labor compliance, construction management, and construction inspection services for the ARRA funded project. The project involved the removal and replacement of damaged street sections, asphalt overlay, miscellaneous concrete repairs to sidewalk and curbs, planting of street trees, and other appurtenant work.

**Ramona B Street Improvement, City of Baldwin Park, California.** Project Manager responsible for overall oversight and scheduling of construction administration and inspection services for the Ramona B Street Improvement Project. Willdan is providing labor compliance, construction management, and construction inspection services for the ARRA funded project. The project involves the removal and replacement of damaged street sections, asphalt overlay, miscellaneous concrete repairs to sidewalks and curbs, planting of street trees, and other appurtenant work.

**Palos Verdes Drive North, City of Rolling Hills Estates, California.** Project Manager responsible for overall oversight and scheduling of construction administration and inspection services for rehabilitation of Crenshaw Boulevard to Rolling Hills Road. Once the design was complete, Willdan provided bid advertisement, bid analysis, and other preconstruction services. Once the project was awarded, Willdan provided labor compliance, construction management, and construction inspection services for the project. The project was funded through the Federal Highway Administration (FHWA) American Recovery and Reinvestment Act (ARRA) at a total project cost of approximately \$400,000.

#### **Slurry Seal**

**Slurry Seal for Fiscal Year 2005, City of Paramount, California.** Project Manager responsible for overall oversight and scheduling of construction administration and inspection services for application of slurry seal emulsion of various City streets.

## M. Alberto Rosiles

### Senior Public Works Observer

#### Education

*Los Angeles Trade Tech*

*Courses in plan reading, concrete inspection, and building codes.*

*Orange Coast College*

*Soil mechanics course in field and laboratory techniques, soils testing, and inspections.*

*Secretary of Public Works in Departments of Projects and Laboratories*

*Courses and work in exploration, soil mechanics, concrete, pavements, and inspections on numerous projects in Mexico.*

*Secretary of Public Works Department of Highways*

*Intensive courses in surveying and road locations on numerous projects in Mexico.*

#### Registration

*Reg. 2474, State Examination for registration as a Construction Inspector Earthworks and Concrete*

*Reg. 527, City of Long Beach Registered Deputy Pile Inspector*

*Reg. 432, City of Irvine Registered Deputy Grading and Asphalt Inspector*

*CPN 13488, Certified Nuclear Gauges Technician*

#### 31 Years' Experience

**Mr. M. Alberto Rosiles** has over 31 years of construction observation experience. Mr. Rosiles' experience included street rehabilitation projects in various cities where his responsibilities included quality control, quantity calculations, and project management. His areas of expertise includes A.C. heater remix, A.C. rubber paving, overlay, P.C.C., slurry seal, underground facilities, cast-in-place pipe, A.C. and P.C.C. batch plant inspection, roadways, highways, bridges, landscape, and vertical construction.

#### Relevant Project Experience

**Bradford/Madison Street Improvement, City of Placentia, California.** Public Works Observer. This project involved providing professional construction engineering and funding administration for the Bradford/Madison Street Improvement Project. Willdan provided labor compliance, construction management, and construction inspection services for the ARRA funded project. The project involved the removal and replacement of damaged street sections, asphalt overlay, miscellaneous concrete repairs to sidewalks and curbs, planting of street trees, and other appurtenant work.

**Third Street Improvement Project, City of Calimesa, California.** Public Works Observer. This project involved providing professional construction engineering and funding administration for the Third Street Improvement Project. Willdan provided labor compliance, construction management, and construction inspection services for the ARRA funded project. The project involved the removal and replacement of damaged street sections, asphalt overlay, miscellaneous concrete repairs to sidewalk and curbs, planting of street trees, and other appurtenant work.

**Ramona B Street Improvement Project, City of Baldwin Park, California.** Public Works Observer. This project involves providing construction engineering and funding administration for the Ramona B Street Improvement Project. Willdan is providing labor compliance, construction management, and construction inspection services for the ARRA funded project. The project involves the removal and replacement of damaged street sections, asphalt overlay, miscellaneous concrete repairs to sidewalks and curbs, planting of street trees, and other appurtenant work.

**Placentia Avenue Overlay Project, City of Placentia, California.** Public Works Observer. Willdan provided construction management, public works observation, material testing, and labor compliance services for the City of Placentia's Placentia Avenue Overlay Project. The project will involve the removal and replacement of damaged curb/gutter, sidewalk, and the installation of an Asphalt-Rubber Hot Mix (ARHM) overlay.

**Recreation Center Master Plan Expansion - Construction Services, City of Fountain Valley, California.** Senior Public Works Observer. The work effort included design and construction management services to rough and mass grade the site for constructing roadways, parking lots, pedestrian walkways, sports facilities, and amenities. These amenities included landscaping, irrigation, playing fields, stadium facilities, jogging paths, a maintenance building, and lighting. The project amenities are spread over 76 acres near the Mile Square Park area. Willdan's design team provided construction support and construction staking services throughout construction. Our construction management team provided program management, construction management, inspection, and materials testing for this \$17.5 million project.



M. Alberto Rosiles  
*Continued*

**Dillon Road Grade Separation Project, City of Coachella, California.** Construction Inspector. The project involved the construction of a new bridge at Dillon Road and the existing UPRR tracks. The new structure carries Dillon Road traffic over Indio Boulevard and the UPRR's two existing tracks by means of a reinforced concrete bridge. In addition, the project involves the following specific items of work: new traffic signals, construction of approach fills for the new bridge, installation of new curbs and gutters, installation of new signing, construction of new drainage facilities, and other appurtenant work. It is anticipated to take approximately 14 months and \$22 million dollars to construct the new bridge.

**Intersection Widening at Brookhurst/Ellis, City of Fountain Valley, California.** Construction Inspector. This widening project involved underground utilities, traffic signal modification, added sidewalks, retaining walls, and street rehabilitation. Project also included relocation of OCWD new vault and striping. Mr. Rosiles was responsible for public works inspection, management, and assisting the City Engineer.

**Newhope Street Extension, City of Fountain Valley, California.** Resident Inspector. The project included the extension of Newhope Street from Talbert Avenue to Interstate 405. The main features of the project included demolition of multiple businesses, median construction, landscaping, storm drain construction, sidewalks, traffic signal modifications, signing, striping, and Caltrans coordination for the northbound 405 ramp widening and remodeling.

**Talbert from Brookhurst to East City Limit, City of Fountain Valley, California.** Construction Inspector. Project involved public works inspection of complete driveways, replacement road widening overlay, new medians (AC AHRM), management, and assisting the City Engineer.

**Edinger/Harbor, City of Fountain Valley, California.** Construction Inspector. This project involved widening, new median islands, bus stop pads, removing and remodeling handicap ramps, sidewalks, signal loop installation and striping. Mr. Rosiles was responsible for all public works inspection, management, and assisting the City Engineer.

**FY 2000-01 Slurry Seal and Street Resurfacing, City of Lake Forest, California.** Construction Inspector. Street resurfacing projects are part of the City's annual street maintenance program. Project elements included crack sealing and base repairs, asphalt concrete overlays, slurry seals, adjusting surface utilities to grade, replacement of traffic loops, re-striping and reestablishing City survey control points.

**Brookhurst Street Rehabilitation and Resurfacing, City of Fountain Valley, California.** Construction Inspector. Project involved the construction inspector staff augmentation services on Brookhurst Street from Talbert Avenue to Warner Avenue, and from Heil Avenue to North City limits project. The project required expertise in the removal and disposal of existing asphalt concrete/aggregate base roadway section, cold milling, placing asphalt concrete leveling course and base course, asphalt rubber hot mix (AHRM), adjusting survey well monument covers, utility covers and manholes to grade, PCC curb, gutter, driveway approaches, access ramps and median, traffic delineation, signs, and signal loops.

**I-215, Beltway, Section 7B, 8 and 9, Drainage Facilities, Clark County, Nevada.** Construction Inspector. This \$58 million project consisted of the construction of major drainage facilities, interim frontage roads and partial highway along a 6.4 mile alignment of the future Beltway around the valley. The drainage facilities accounted for \$24 million of the project. Drainage improvements included the installation of cast-in-place box culverts ranging in size from 10'X10' to 23'X10' in lengths from 500' to 2,800', reinforced concrete pipe from 18" to 96", trapezoidal channels, rectangular channels, and transition structures.

# **ATTACHMENT 7**

Notice of Exemption

Appendix E

To: Office of Planning and Research
P.O. Box 3044, Room 113
Sacramento, CA 95812-3044

From: (Public Agency): City of Palm Springs
3200 E. Tahquitz Canyon Way
Palm Springs, CA 92262

County Clerk
County of: Riverside
P.O. Box 751
Riverside, CA 92502-0751

(Address)

Project Title: 2015/2016 Annual Slurry Seal, City Project No. 15-02

Project Applicant: City of Palm Springs

Project Location - Specific:

Various streets throughout the City of Palm Springs (over 90 streets).

Project Location - City: Palm Springs Project Location - County: Riverside

Description of Nature, Purpose and Beneficiaries of Project:

The project comprises preparation of pavement cracks, micro-milling, and application of slurry seal to various City streets, as identified on Exhibit "A" attached hereto.

Name of Public Agency Approving Project: City of Palm Springs

Name of Person or Agency Carrying Out Project: City of Palm Springs

Exempt Status: (check one):

- Ministerial (Sec. 21080(b)(1); 15268);
Declared Emergency (Sec. 21080(b)(3); 15269(a));
Emergency Project (Sec. 21080(b)(4); 15269(b)(c));
Categorical Exemption. State type and section number: 15301 (c) Existing Facilities
Statutory Exemptions. State code number:

Reasons why project is exempt:

Section 15301 "Existing Facilities," Class 1 projects consist of the repair, maintenance, or minor alteration of existing public structures involving negligible or no expansion of use; therefore, pursuant to Section 15301(c), the Project is considered exempt from CEQA.

Lead Agency Contact Person: Marcus L. Fuller Area Code/Telephone/Extension: (760) 323-8253

If filed by applicant:

- 1. Attach certified document of exemption finding.
2. Has a Notice of Exemption been filed by the public agency approving the project? Yes No

Signature: [Signature] Date: 07/06/2015 Title: City Engineer

Signed by Lead Agency Signed by Applicant

Authority cited: Sections 21083 and 21110, Public Resources Code.
Reference: Sections 21108, 21152, and 21152.1, Public Resources Code.

Date Received for filing at OPR:



# **ATTACHMENT 8**

RESOLUTION NO.

A RESOLUTION OF THE CITY COUNCIL OF THE  
CITY OF PALM SPRINGS CALIFORNIA, AMENDING  
THE BUDGET FOR FISCAL YEAR 2015-16

WHEREAS, Resolution No. 23838 approving the Budget for the Fiscal Year 2015-2016 was adopted on June 17, 2015; and

WHEREAS, the City Manager has recommended, and the City Council desires to approve, certain amendments to the budget for Fiscal Year 2015-2016.

NOW, THEREFORE THE CITY COUNCIL DETERMINES, RESOLVES AND APPROVES AS FOLLOWS:

SOURCE(S):

Fund	Activity	Account	Amount
Local Measure A Fund 134		Fund Balance	\$2,540,000

ADDITION(S):

Fund	Activity	Account	Amount
Local Measure A Fund 134	4498	50100	\$2,540,000

PURPOSE: Replacement of broad base set of vehicles city wide.

ADOPTED THIS 7<sup>th</sup> DAY OF October, 2015.

CITY OF PALM SPRINGS

\_\_\_\_\_  
David H. Ready  
City Manager

ATTEST:

\_\_\_\_\_  
James Thompson  
City Clerk

CERTIFICATION

STATE OF CALIFORNIA )  
COUNTY OF RIVERSIDE ) ss.  
CITY OF PALM SPRINGS )

I, JAMES THOMPSON, City Clerk of the City of Palm Springs, hereby certify that Resolution No. \_\_\_\_ is a full, true and correct copy, and was duly adopted at a regular meeting of the City Council of the City of Palm Springs on October 7, 2015, by the following vote:

AYES:  
NOES:  
ABSENT:  
ABSTAIN:

---

James Thompson, City Clerk  
City of Palm Springs, California



# **ATTACHMENT 2**







