



## City Council Staff Report

Date: May 4, 2016 CONSENT CALENDAR

Subject: ACCEPTANCE OF THE VISTA CHINO AT FARRELL DRIVE STREET IMPROVEMENTS, FEDERAL AID PROJECT NUMBER CML 5282 (037), CITY PROJECT NO. 09-11

From: David H. Ready, City Manager

Initiated by: Public Works and Engineering Department

---

### SUMMARY

Formal City Council acceptance of the Vista Chino at Farrell Drive Street Improvements, Federal Aid Project No. CML 5282 (037), City Project No. 09-11, is required to document the completion of the public works improvement, and to allow the City's filing of a Notice of Completion with the Riverside County Recorder in accordance with Section 9200 of the California Civil Code.

### RECOMMENDATION:

- 1) Accept the public works improvement identified as the Vista Chino at Farrell Drive Street Improvements, Federal Aid Project No. CML 5282 (037), City Project No. 09-11, as completed in accordance with the plans and specifications; and
- 2) Authorize the City Engineer to execute and file for recordation with the Riverside County Recorder a Notice of Completion for the Vista Chino at Farrell Drive Street Improvements, Federal Aid Project No. CML 5282 (037), City Project No. 09-11, (A6593).

### STAFF ANALYSIS:

On March 30, 2009, the Coachella Valley Association of Governments (CVAG) Executive Committee approved a Call for Projects for CVAG and its member jurisdictions using CVAG's allocation of Congestion Mitigation and Air Quality (CMAQ) funds made available through the current highway funding bill, the Safe, Accountable, Flexible, Efficient Transportation Equity Act: A Legacy for Users (SAFETEA-LU).

In response, on May 11, 2009, the Public Works and Engineering Department responded to CVAG's Call for Projects for CMAQ funding, requesting consideration of funding to design and construct a new northbound dedicated right-turn lane on Farrell Drive at Vista Chino. Currently, the Vista Chino/Farrell Drive intersection is configured with two through lanes and one left turn lane for northbound traffic. A high volume of northbound traffic turns east (right) onto Vista Chino at the intersection, especially during peak hours. Through traffic waiting at the traffic signal in the right hand through lane frequently delay long queues of traffic. The construction of a dedicated right-turn lane will allow eastbound traffic to avoid a long queue of vehicles waiting to proceed through the intersection that are waiting for the traffic signal.

The Public Works Department's request to CVAG was for \$426,980 in CMAQ federal funds for an estimated \$482,300 project, consistent with the CMAQ federal program reimbursement rate of 88.53% of project costs. On December 7, 2009, the CVAG Executive Committee reviewed and approved a total of \$409,317 in CMAQ federal funding for the project, (\$17,663 less than we requested). The Project has been identified as the Vista Chino at Farrell Drive Street Improvements, Federal Project No. CML 5282 (037), City Project No. 09-11, (the "Project"). A vicinity map of the project area is included as **Attachment 1**.

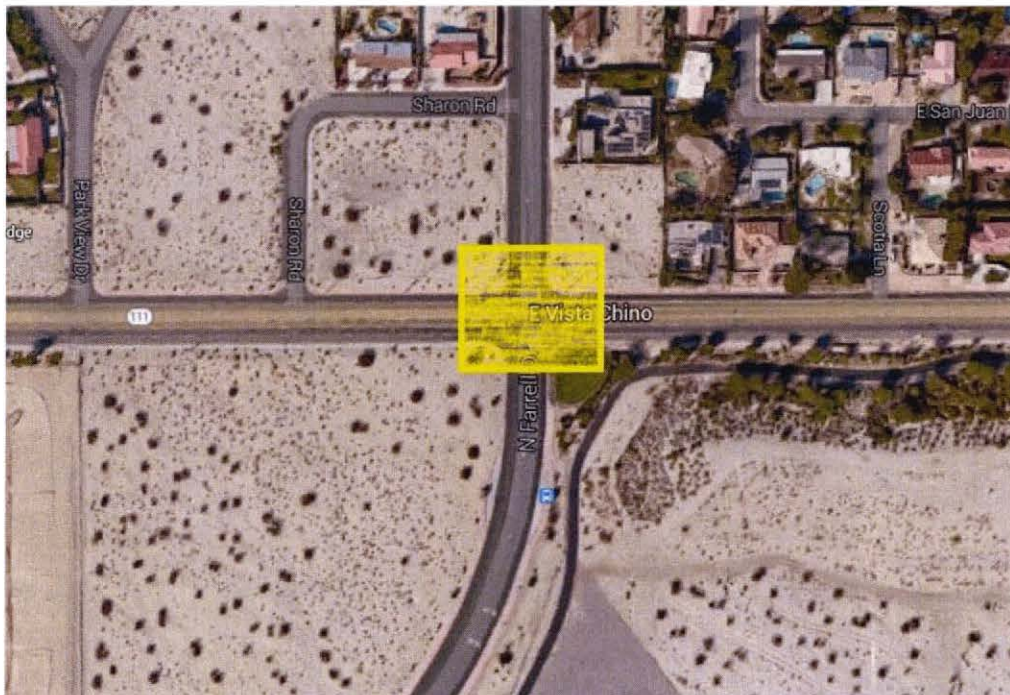

**Figure 1**

On September 3, 2014, the City Council awarded a construction contract in the amount of \$326,613 for the Project to Hillcrest Contracting, Inc.; included as part of the City Council's action was an authorization for the City Manager to approve cumulative change orders of up to 10% of the awarded construction contract amount (\$32,661.30).

On July 15, 2015, the City Council authorized approval of Construction Contract Change Order No. 1 (“CCO1”) in an amount not to exceed of \$48,267.39 for additional work not included in the original contract; included as part of the City Council’s action was an authorization for the City Manager to approve up to an additional \$25,000 in cumulative contract change orders. The total maximum contract price authorized by the City Council was \$399,880.39.

Staff ultimately negotiated a slightly reduced price of \$41,418.20 for the additional work approved by City Council via CCO1. Upon completion of the project, a final accounting of actual quantities of construction items was completed, and a final adjustment of the contract price was approved via Construction Contract Change Order No. 2 (“CCO2”) in the amount of \$28,911.41. The total adjusted contract price was \$396,942.61 less than the City Council’s authorization. A copy of CCO1 and CCO2 are included as **Attachment 2**.

The Project was administered by a consulting engineering firm, Transtech, who has acted as the City’s Resident Engineer. Transtech has determined that Hillcrest Contracting, Inc.; satisfactorily completed the Project on March 10, 2016, has conducted a final inspection and found the work to be in compliance with the plans, specifications and standards of the City of Palm Springs as evidenced by letter from Transtech received on April 25, 2016 and included as **Attachment 3**. Staff recommends that the City Council accept the Project, as required by Section 9200 of the California Civil Code, and authorize the City Engineer to file and record a Notice of Completion within 15 days of the City Council’s action. A copy of the Notice of Completion to be submitted to the County is included as **Attachment 4**.

ENVIRONMENTAL IMPACT:

Section 21084 of the California Public Resources Code requires Guidelines for Implementation of the California Environmental Quality Act (“CEQA”). The Guidelines are required to include a list of classes of projects which have been determined not to have a significant effect on the environment and which are exempt from the provisions of CEQA. In response to that mandate, the Secretary for Resources identified classes of projects that do not have a significant effect on the environment, and are declared to be categorically exempt from the requirement for the preparation of environmental documents. In accordance with Section 15301 “Existing Facilities,” Class 1 projects consist of the operation, repair, maintenance, permitting, leasing, licensing, or minor alteration of existing public structures, facilities, mechanical equipment involving negligible or no expansion of use beyond that existing at the time of the lead agency’s determination. Therefore, in accordance with Section 15301(a), staff determined that the Farrell Drive Right Turn Lane at Vista Chino (Hwy 111) Project is considered categorically exempt from CEQA; a Notice of Exemption was filed on December 27, 2011, and is included as **Attachment 5**.

On December 19, 2011, Caltrans, acting as the lead agency pursuant to the National Environmental Policy Act (“NEPA”), made an environmental determination that the Project does not individually or cumulatively have a significant impact on the environment as defined by NEPA and is excluded from the requirements to prepare an Environmental Assessment (“EA”) or Environmental Impact Statement (“EIS”), and there are no unusual circumstances pursuant to Section 6004 of 23 CFR 771.117. On the basis of this determination under federal delegation pursuant to Chapter 3 of Title 23, United States Code, Section 326 and a Memorandum of Understanding (“MOU”) dated June 7, 2010, executed between the Federal Highway Administration (“FHWA”) and the State of California, the State has determined that the Project is a Categorical Exclusion under 23 CFR 771.117 pursuant to activity (d)(1). A copy of the NEPA Categorical Exclusion is included as **Attachment 6**.

### FISCAL IMPACT

The City received a federal CMAQ grant of \$409,170 for the Project, with \$40,000 allocated to the design phase and \$369,170 allocated to the construction phase. Previously, the City budgeted \$37,910 from Special Projects (Fund 160), \$83,000 from Fund 133 (Special Gas Tax Improvement), and \$50,000 from Fund 134 (Measure A Improvements) for the Project. The Project’s overall budget, and incurred expenditures, is identified in Table 1:

<b>Table of Project Costs</b>	<b>Amount</b>
Special Projects	\$37,910
CMAQ Federal Aid Grant	\$409,170
Gas Tax Fund	\$83,000
Measure A Fund	\$50,000
Design Services	(\$98,600)
Project Administration	(\$32,184)
Construction Management Services	(\$49,180)
Construction Contract	(\$396,943)
<b>Remaining Balance</b>	<b>\$3,173</b>

**Table 1**

The Project did not require any General Fund (Fund 001) or Measure J Fund (Fund 260) budget. The City is holding retention of \$19,847.13 for Hillcrest Contracting pending acceptance of the improvements and filing of the Notice of Completion with the County Recorder’s office. Since this project is a conversion of a facility that already exists, the Finance Department does not need to add the cost of this project to the City’s fixed asset system, as no new assets have been created in compliance with Governmental Accounting Standard Board (GASB) 34 *Standards for Financial Reporting of Infrastructure Assets*.

SUBMITTED

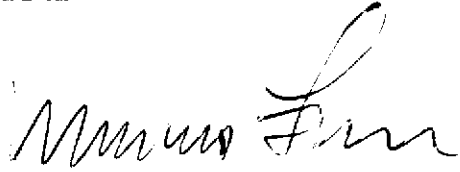

Marcus L. Fuller, MPA, P.E., P.L.S.  
Assistant City Manager/City Engineer

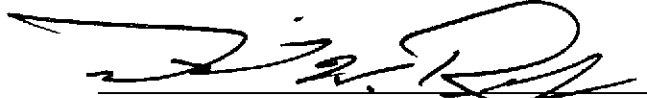

David H. Ready, Esq., Ph.D.  
City Manager

Attachments:

1. Vicinity Map
2. Contract Change Orders No. 1 and 2
3. Letter from Transtech
4. Notice of Completion (NOC)
5. Notice of Exemption (NOE) - CEQA
6. NEPA Categorical Exclusion

# **ATTACHMENT 1**



# Department of Public Works and Engineering Vicinity Map

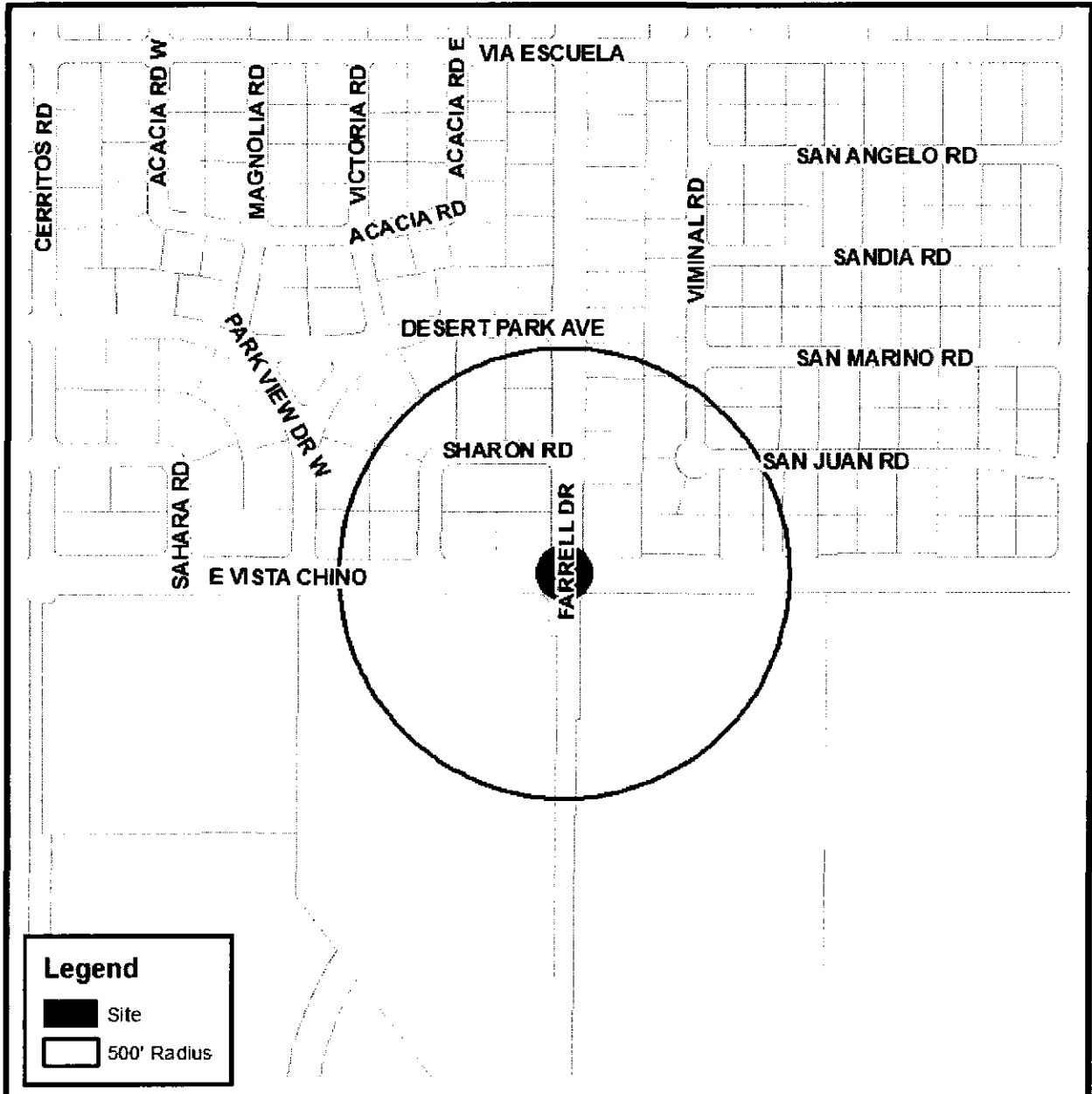
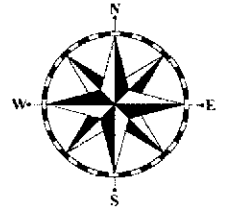

CITY OF PALM SPRINGS

# **ATTACHMENT 2**





## CITY OF PALM SPRINGS CONTRACT CHANGE ORDER

To: Hillcrest Contracting  
P.O. Box 1898  
Corona, CA 91718-1898  
Tel: (951) 273-9600

Date: February 5, 2016  
Project No: 09-11  
Project: Farrell Dr. Rt. Turn at Vista Chino  
Improvements  
Change Order No: 01  
Purchase Order: 15-1085  
Account: 133-4298-60076  
261-4491-60076  
160-4510-60076

Attn: Darcy Searle

### CHANGES IN WORK/COST:

This Contract Change Order No. 1 makes adjustments to an existing Bid Item and adds two new work items, generally identified as:

Bid Item No.	Description	Price	Quantity	Total
24	Traffic Signal, Lighting & Electrical System per Plan No. 5 of 6	-\$16,474.50	-0.168LS	-\$16,474.50

### NEW ITEMS

Item	Description	Price	Quantity	Total
A	Video Detection System	\$53,799.17	1	\$53,799.17
B	Wireless Modem	\$4,093.53	1	\$4,093.53

**TOTAL CHANGE ORDER AMOUNT      \$41,418.20**

### CHANGES TO CONTRACT TIME:

Zero (0) working days will be added for Contract Change Order No.1.

**DUPLICATE  
ORIGINAL**

**SOURCE OF FUNDS:**

The following accounts will be utilized:

Item	Description	Amount	Account Utilized
C.O. #1	Capital Project Fund	\$28,915.85	261-4491-60076
	Special Project Fund	\$989.33	160-4510-60076
	Gas Tax Fund	\$11,513.02	133-4298-60076

**REASONS FOR CHANGES:**

Following the bidding and award of the project it was determined that the approved plan did not sufficiently address the condition of the existing controller equipment cabinet. Specifically, that the electrical service was attached to the side of the cabinet and shared the same cast in place concrete base. This prevented the project from moving forward as designed. In an effort to avoid redesigning the project to include the purchase and construction of a new electrical service, it was determined that by switching from loop to video detection sufficient conduit space could be created in the existing controller base eliminating the need to demolish the base and install additional conduits.

On July 15, 2015 City Council approved Change Order No. 1 in an amount not to exceed \$48,267.39, the actual cost to complete this work was \$41,418.20. The associated changes are as follows:

**Bid Schedule, Item 24, Traffic Signal, Lighting & Electrical System:** The contract will be credited due the deletion of certain items of work that will no longer be necessary. These include the demolition and reconstruction of the signal controller base, the deletion of traffic loops and the elimination of new conduit runs. -\$16,474.50 Lump Sum/Agreed Price.

**New Item A, Video Detection System:** Furnish and install a 4 camera video detection system in accordance with the revised traffic signal drawing, at the Lump Sum/Agreed Price of \$53,799.17

**New Item B, Wireless Modem:** Caltrans has required that a wireless modem be provided and installed within the existing traffic signal controller cabinet. This will be completed for the lump sum/agreed Price of \$4,093.53.

**SUMMARY OF COSTS:**

Original Contract Amount:	\$326,613.00	Original Completion	January 6, 2016
This Change Order:	\$ 41,418.20	Days Added	0
Previous Change Order(s):	\$ 0.00	Previous Days Added:	0
Revised Contract Amount:	\$ \$368,031.20	Revised Completion	January 6, 2016

\*\*\*\* SIGNATURES ON NEXT PAGE \*\*\*\*

I have received a copy of this Change Order and the above AGREED PRICES are acceptable to Contractor

**Hillcrest Contracting**

      3-15-16  
Signature      Date

Darcy Seate Proj Mgr  
Printed Name and Title

**Transtech Engineers**

Recommended By:

      2-15-16  
for Kurt Pegg, Resident Engineer      Date

**City of Palm Springs**

Recommended By:

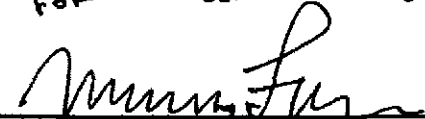
      3/24/16  
(SF) Marcus Fuller      Date  
Assistant City Manager/City Engineer

Approved By:

      3.30.16  
David H. Ready, City Manager      Date

Attest By:

      03/30/2016  
James Thompson, City Clerk      Date

**Distribution:**

**Original Conformed Copy:**

Contractor      (1)  
City Clerk      (1)

**Conformed - File Copy:**

Engineering Pay File      (1)  
City Project File      (1)  
Purchasing      (1)  
Finance      (1)

**APPROVED BY CITY COUNCIL**

7-16-16 JM A6693

# Vista Chino Farrel CCO Summary

## Contract Change Order Number 1

Bid Item #	Description	Price	Markup	Subtotal	Bond 1%	Total
24	Traffic Signal, Lighting and Electrical System per Plan No. 5 of 6					
	24.1 Eliminate TS loops and cable	3881	172			\$ (4,053.00)
	24.2 Eliminate temporary relocation of TS controller	2050	102.5			\$ (2,152.00)
	24.3 Eliminate new conduit and utilize existing	9780	489			\$ (10,269.00)
	Total					\$ (16,474.00)

New Items	Description	Price	Markup 5%	Subtotal	Bond 1%	Total
A	Video Detection System	\$ 50,730.00	\$ 2,536.50	\$ 53,266.50	\$ 532.67	\$ 53,799.17
B	Wireless Modem	\$ 3,860.00	\$ 193.00	\$ 4,053.00	\$ 40.53	\$ 4,093.53

**Total of Bid Items and New Items**

**\$ 41,418.70**

# HILLCREST CONTRACTING

General Engineering Contractors

License# 471664A

To: City of Palm Springs  
Public Works Department  
3200 Tahquitz Canyon Way  
Palm Springs, CA 92263

Date: 7/28/15 Revised October 1, 2015  
Subject: Request for Change Order#001  
Job Title: 09-11

Attention: Mike Lytar

Job Number: 2612

We are sending you  herewith the following  under separate cover:

**REQUEST FOR CHANGE ORDER# 001.1 – per the plan modifications of the traffic signals at the intersection of Vista Chino and Farrell Dr.**

<u>ITEMS</u>	<u>QTY</u>	<u>U/C</u>	<u>COST</u>
Furnish and install 4 camera video detection system	1 LS	\$53,799.17	\$53,799.17
Furnish and install wireless modem in existing TS Controller	1 LS	\$ 4,093.53	\$ 4,093.53
		<b>Total Adds</b>	<b>\$57,892.70</b>

### Items to be deducted off of contract

Delete the installation of TS loops and loop cable, & install advance loops as shown on revised plans	1 LS	-\$ 4,053.00	-\$ 4,053.00
Delete the temporary and relocation of the ex TS Controller cabinet	1 LS	-\$ 2,152.50	-\$ 2,152.50
Delete the installation of conduit #2,3,4, 5 & 6	1 LS	-\$10,269.00	-\$10,269.00
		<b>Total Deducts</b>	<b>-\$16,457.72</b>

For your: Perusal  Approval  Files  Quotation

Sincerely,

Darcy Searle  
Project Manager/QSP

2612- RFC#1 Electrical adds & deducts



Vendor # 1575

September 30, 2015

Hillcrest Contracting, Inc.  
1467 Circle City Dr.  
Corona, CA 92879

Serial No. 14-0035-006rev4

Attention: Ms. Darcy Seale, Project Manager  
Reference: Farrell Dr. Right Turn Lane at Vista Chino Project  
City of Palm Springs Project No. 09-11  
Belco Job No. 14-0035, Hillcrest Job No. 2612  
Subject: Price Proposal for Traffic Signal Modifications at the Intersection of Vista Chino and Farrell Dr.  
Belco PCO No. 14-0035-1.00rev

Dear Ms. Seale:

Elecnor Belco Electric is pleased to provide you with a price proposal for the modifications of the traffic signals at the intersection of Vista Chino and Farrell Dr. for the above referenced project. The following details are provided in this proposal:

- 1. PCO 14-0035-1.01 New Item A  
Scope of work: Furnish and install 4-camera video detection system.  
Lump sum price: \$50,730.00
- 2. PCO 14-0035-1.02 New Item B  
Scope of work: Furnish and install wireless modem in existing TS controller.  
Lump sum price: \$3,860.00
- 3. PCO 14-0035-1.03 Credit to Bid Item #24  
Scope of work: Delete the installation traffic signal loops and loop cable, and install advance loops as shown on revised drawing.  
Lump sum price: -\$3,881.00
- 4. PCO 14-0035-1.04 Credit to Bid Item #24  
Scope of work: Delete the temporary and relocation of the existing traffic signal controller cabinet.  
Lump sum price: -\$2,050.00



We think about a better world  
[www.elecnorbelco.com](http://www.elecnorbelco.com)

4331 Schaefer Ave.  
Chino, CA 91710  
(909) 993-5470 Office  
(909) 993-5476 Fax  
CA License 738518



5. PCO 14-0035-1.05

Scope of work: Delete the installation of Conduit Nos. 2, 3, 4, 5 and 6.

Lump sum price: -\$9,780.00

Credit Bid Item #24

6. PCO 14-0035-1.05

Scope of work: ~~Procure and store Traffic Signal poles, arm and gear (4 months @ \$500.00 ea.)~~

Lump sum price: ~~\$2,000.00~~

*denied*

If these proposals are acceptable, please provide a change order or written direction to proceed with this work. Should you have any questions or concerns, please do not hesitate to contact me at (909) 993-5470 ext. 234.

Sincerely,  
Elecnor Belco Electric, Inc.

Thomas Gebelin  
Project Manager  
Transportation Division



We think about a better world  
[www.elecnorbelco.com](http://www.elecnorbelco.com)

4331 Schaefer Ave.  
Chino, CA 91710  
(909) 993-5470 Office  
(909) 993-5476 Fax  
CA License 738518

FIELD MATERIAL AND LABOR PRICE SUMMARY (See Price Sheets for Details)				BELCO PGO NO:	14-0036-1.01rev	
DESCRIPTION				DATE:	9/30/2016	
MATERIALS PAGE 2	\$33,830.00	32.00				
MATERIALS PAGE 3	\$0.00	0.00				
MATERIALS PAGE 4	\$0.00	0.00				
MATERIALS PAGE 5	\$0.00	0.00				
MATERIALS PAGE 6	\$0.00	0.00				
MATERIALS PAGE 7	\$0.00	0.00				
SUBTOTAL	\$33,830.00	32				
SALES TAX @ 9.00%	\$3,044.70					
FREIGHT @ 4%	\$1,353.20					
MISCELLANEOUS HARDWARE @ 6%	\$1,601.60					
<b>TOTAL MATERIAL COSTS:</b>				<b>COST</b>	<b>MARKUP</b>	<b>TOTAL</b>
				\$39,919.40	\$5,987.91	\$45,907.31
<b>FIELD LABOR BREAKDOWN</b>						
GENERAL FOREMAN - REGULAR RATE	0	\$90.65	\$0.00			
GENERAL FOREMAN - OT RATE	0	\$128.10	\$0.00			
FOREMAN - REGULAR RATE	8	\$83.75	\$670.00			
FOREMAN - OT RATE	0	\$117.74	\$0.00			
JOURNEYMAN WIREMAN - REG. RATE	8	\$75.85	\$614.80			
JOURNEYMAN WIREMAN - OT RATE	0	\$107.39	\$0.00			
ELEC. APPRENTICE - REGULAR RATE	16	\$67.68	\$1,082.88			
ELEC. APPRENTICE - OT RATE	0	\$93.85	\$0.00			
LABORER - REGULAR RATE	0	\$64.10	\$0.00			
LABORER - OT RATE	0	\$88.76	\$0.00			
OPERATOR - REGULAR RATE	0	\$63.78	\$0.00			
OPERATOR - OT RATE	0	\$113.82	\$0.00			
<b>TOTAL LABOR COSTS:</b>				<b>COST</b>	<b>MARKUP</b>	<b>TOTAL</b>
				\$2,387.68	\$473.54	\$2,861.22
<b>ENGINEERING COSTS</b>						
PROJECT MANAGER	0	\$90.00	\$0.00			
DESIGN ENGINEER (COORDINATION)	0	\$75.00	\$0.00			
PROJECT ENGINEER	0	\$90.00	\$0.00			
CAD ENGINEER	0	\$60.00	\$0.00			
PROJECT ASSISTANT	0	\$40.00	\$0.00			
<b>TOTAL INDIRECT COSTS:</b>				<b>COST</b>	<b>MARKUP</b>	<b>TOTAL</b>
				\$0.00	\$0.00	\$0.00
CODE	EQUIP/CA/TRANS RATES \$/15	HOURS	RATE	EXT.		
06-12	PICKUP TRUCK/HR.	0	\$27.33	\$0.00		
20-28	UTILITY WORK TRUCK/HR.	16	\$71.82	\$1,149.12		
016-025	AIR COMPRESSOR ONLY/HR.	0	\$38.14	\$0.00		
20-28	BATCH TRUCK W/MIXER/HR.	0	\$40.38	\$0.00		
38-48	CRANE TRUCK/HR.	0	\$99.75	\$0.00		
12-20	BUCKET TRUCK/HR.	8	\$71.69	\$573.52		
3AXL	DUMP TRUCK (3 AXLES)/HR.	0	\$72.07	\$0.00		
20-28	DELIVERY TRUCK (20K-28K)/HR.	0	\$38.04	\$0.00		
12-20	WATER TRUCK (12K-20K)/HR.	0	\$33.46	\$0.00		
	DUMP TRAILER/HR.	0	\$15.00	\$0.00		
TM	ARROWBOARD/HR.	0	\$3.39	\$0.00		
250BJ	BACKHOE (JD 410G)/HR.	0	\$80.73	\$0.00		
	BACKHOE TRAILER/HR.	0	\$20.00	\$0.00		
	TRENCHER/DAY	0	\$225.00	\$0.00		
<b>TOTAL TOOLS/EQUIP. COSTS:</b>				<b>COST</b>	<b>MARKUP</b>	<b>TOTAL</b>
				\$1,722.64	\$268.40	\$1,991.04
<b>SUBCONTRACTS</b>						
	QTY	UNIT	EXT.			
			\$0.00			
			\$0.00			
			\$0.00			
<b>TOTAL SUBCONTRACT COSTS:</b>				<b>COST</b>	<b>MARKUP</b>	<b>TOTAL</b>
				\$0.00	\$0.00	\$0.00
<b>SUBTOTAL COSTS:</b>				<b>COST</b>	<b>MARKUP</b>	<b>TOTAL</b>
				\$44,008.72	\$6,719.84	\$50,728.56
<b>DESIGN SERVICES</b>						
	SUBTOTAL	PERCENT	EXT.			
	\$0.00	7.75%	\$0.00			\$0.00
<b>BONDING</b>						
	\$0.00	1.00%	\$0.00			\$0.00

GRAND TOTAL OF THIS CHANGE ORDER:

\$50,728.56

Backup for new Item A



BELCO  
MATERIALS AND OPERATIONS BREAKDOWN

PROJECT:

PCO NO:

DIRECTIVE NO:

ESTIMATED BY

CHECKED BY

DATE

9/30/2015

MATERIAL OR OPERATION	QTY	PRICE	PER	TEXT PRICE	LABOR UNIT	PER	TEXT LABOR
4 CAMERA VDS SYSTEM	1	32,480.00	E	32,480.00	16.00	E	16.00
ITERIS COAX CABLE	1,000	0.45	E	450.00		E	0.00
ITERIS VIDEO POWER CABLE	1,000	0.90	E	900.00		E	0.00
INSTALL VDS CABLES	1		E	0.00	16.00	E	16.00
				0.00			0.00
				0.00			0.00
				0.00			0.00
				0.00			0.00
				0.00			0.00
				0.00			0.00
				0.00			0.00
				0.00			0.00
				0.00			0.00
				0.00			0.00
				0.00			0.00
				0.00			0.00
				0.00			0.00
				0.00			0.00
				0.00			0.00
				0.00			0.00
				0.00			0.00
				0.00			0.00
				0.00			0.00
				0.00			0.00
				0.00			0.00
				0.00			0.00
				0.00			0.00
				0.00			0.00
				0.00			0.00
				0.00			0.00
				0.00			0.00
				0.00			0.00
				0.00			0.00
				0.00			0.00
				0.00			0.00
				0.00			0.00
				0.00			0.00
				0.00			0.00
				0.00			0.00
				0.00			0.00
				0.00			0.00
				0.00			0.00
				0.00			0.00
				0.00			0.00
				0.00			0.00
				0.00			0.00
				0.00			0.00
				0.00			0.00
				0.00			0.00
				0.00			0.00
				0.00			0.00
				0.00			0.00
				0.00			0.00
<b>TOTALS</b>				<b>33,830.00</b>			<b>32.00</b>

Backup for Install of Wireless Modem New Item B

FIELD MATERIAL AND LABOR PRICE SUMMARY (See Price Sheets for Details)				BELCO PGO NO: 14-0036-1.02rev		
DESCRIPTION				DATE: 9/30/2016		
				DESCRIPTION OF WORK OR CHANGE		
MATERIALS PAGE 2	\$2,487.00	4.00		FURNISH AND INSTALL LTE 4G WIRELESS MODEM WITH ETHERNET PORT AND TWO INTERNAL ANTENNAS IN THE EXISTING TS CONTROLLER AT THE INTERSECTION OF VISTA CHRNO AND FARREL DR.		
MATERIALS PAGE 3	\$0.00	0.00				
MATERIALS PAGE 4	\$0.00	0.00				
MATERIALS PAGE 5	\$0.00	0.00				
MATERIALS PAGE 6	\$0.00	0.00				
MATERIALS PAGE 7	\$0.00	0.00				
SUBTOTAL	\$2,487.00	4				
SALES TAX @ 9.00%	\$222.03					
FREIGHT @ 4%	\$98.68					
MISCELLANEOUS HARDWARE @ 5%	\$123.35					
<b>TOTAL MATERIAL COSTS:</b>				<b>\$2,911.06</b>	<b>\$439.66</b>	<b>\$3,347.72</b>
				<b>COST</b>	<b>MARKUP</b>	<b>TOTAL</b>
					15%	
FIELD LABOR BREAKDOWN				HOURS	RATE	EXT.
GENERAL FOREMAN - REGULAR RATE	0	\$90.85	\$0.00			
GENERAL FOREMAN - OT RATE	0	\$128.10	\$0.00			
FOREMAN - REGULAR RATE	0	\$83.75	\$0.00			
FOREMAN - OT RATE	0	\$117.74	\$0.00			
JOURNEYMAN WIREMAN - REG. RATE	2	\$75.85	\$151.70			
JOURNEYMAN WIREMAN - OT RATE	0	\$107.39	\$0.00			
ELEC. APPRENTICE - REGULAR RATE	2	\$67.88	\$135.76			
ELEC. APPRENTICE - OT RATE	0	\$93.05	\$0.00			
LABORER - REGULAR RATE	0	\$84.10	\$0.00			
LABORER - OT RATE	0	\$86.78	\$0.00			
OPERATOR - REGULAR RATE	0	\$43.79	\$0.00			
OPERATOR - OT RATE	0	\$113.82	\$0.00			
<b>TOTAL LABOR COSTS:</b>				<b>\$289.00</b>	<b>\$57.81</b>	<b>\$346.87</b>
				<b>COST</b>	<b>MARKUP</b>	<b>TOTAL</b>
					20%	
ENGINEERING COSTS				HOURS	RATE	EXT.
PROJECT MANAGER	0	\$90.00	\$0.00			
DESIGN ENGINEER (COORDINATION)	0	\$75.00	\$0.00			
PROJECT ENGINEER	0	\$80.00	\$0.00			
CAD ENGINEER	0	\$50.00	\$0.00			
PROJECT ASSISTANT	0	\$40.00	\$0.00			
<b>TOTAL INDIRECT COSTS:</b>				<b>\$0.00</b>	<b>\$0.00</b>	<b>\$0.00</b>
				<b>COST</b>	<b>MARKUP</b>	<b>TOTAL</b>
					20%	
EQ CODE	EQUIP./CALTRANS RATES 3/15	HOURS	RATE	EXT.		
08-12	PICKUP TRUCK/HR.	0	\$27.33	\$0.00		
20-28	UTILITY WORK TRUCK/HR.	2	\$71.82	\$143.64		
018-026	AIR COMPRESSOR ONLY/HR.	0	\$36.14	\$0.00		
20-28	BATCH TRUCK W/MIXER/HR.	0	\$40.38	\$0.00		
36-48	CRANE TRUCK/HR.	0	\$99.76	\$0.00		
12-20	BUCKET TRUCK/HR.	0	\$71.89	\$0.00		
3AXL	DUMP TRUCK (3 AXLES)/HR.	0	\$72.07	\$0.00		
20-28	DELIVERY TRUCK (20K-28K)/HR.	0	\$38.04	\$0.00		
12-20	WATER TRUCK (12K-20K)/HR.	0	\$33.48	\$0.00		
	DUMP TRAILER/HR.	0	\$16.00	\$0.00		
TM	ARROWBOARD/HR.	0	\$3.39	\$0.00		
2509J	BACKHOE (JD 410G)/HR.	0	\$80.73	\$0.00		
	BACKHOE TRAILER/HR.	0	\$20.00	\$0.00		
	TRENCHER/DAY	0	\$225.00	\$0.00		
<b>TOTAL TOOLS/EQUIP. COSTS:</b>				<b>\$143.64</b>	<b>\$21.55</b>	<b>\$165.19</b>
				<b>COST</b>	<b>MARKUP</b>	<b>TOTAL</b>
					15%	
SUBCONTRACTS				QTY	AMOUNT	EXT.
						\$0.00
						\$0.00
						\$0.00
<b>TOTAL SUBCONTRACT COSTS:</b>				<b>\$0.00</b>	<b>\$0.00</b>	<b>\$0.00</b>
				<b>COST</b>	<b>MARKUP</b>	<b>TOTAL</b>
					6%	
<b>SUBTOTAL COSTS:</b>				<b>\$3,343.76</b>	<b>\$518.02</b>	<b>\$3,859.78</b>
				<b>COST</b>	<b>MARKUP</b>	<b>TOTAL</b>
				SUBTOTAL	PERCENT	EXT.
DESIGN SERVICES				\$0.00	7.76%	\$0.00
BONDING				\$0.00	1.00%	\$0.00

GRAND TOTAL OF THIS CHANGE ORDER:

\$3,859.78



Backup to Deletion of Traffic Loops Bid  
Item #24 Credit

FIELD MATERIAL AND LABOR PRICE SUMMARY (See Price Sheets for Details)				BELCO PCO NO: 14-0035-1.03rev1	
DESCRIPTION	MATERIAL \$	LBR HRS.		DATE:	9/30/2015
MATERIALS PAGE 2	(\$212.00)	(4.00)			
MATERIALS PAGE 3	\$0.00	0.00			
MATERIALS PAGE 4	\$0.00	0.00			
MATERIALS PAGE 5	\$0.00	0.00			
MATERIALS PAGE 6	\$0.00	0.00			
MATERIALS PAGE 7	\$0.00	0.00			
SUBTOTAL	(\$212.00)	-4			
SALES TAX @ 9.00%	(\$19.08)				
FREIGHT @ 4%	(\$8.48)				
MISCELLANEOUS HARDWARE @ 5%	(\$10.50)				
				<b>COST</b>	<b>MARKUP</b>
					16%
					<b>TOTAL</b>
				(\$250.10)	(\$37.62)
					(\$287.08)
<b>TOTAL MATERIAL COSTS:</b>					
<b>FIELD LABOR BREAKDOWN</b>					
	HOURS	RATE	EXT \$		
GENERAL FOREMAN - REGULAR RATE	0	\$00.85	\$0.00		
GENERAL FOREMAN - OT RATE	0	\$128.10	\$0.00		
FOREMAN - REGULAR RATE	0	\$83.76	\$0.00		
FOREMAN - OT RATE	0	\$117.74	\$0.00		
JOURNEYMAN WIREMAN - REG. RATE	-2	\$78.85	(\$163.70)		
JOURNEYMAN WIREMAN - OT RATE	0	\$167.30	\$0.00		
ELEC. APPRENTICE - REGULAR RATE	-2	\$87.88	(\$175.36)		
ELEC. APPRENTICE - OT RATE	0	\$03.85	\$0.00		
LABORER - REGULAR RATE	0	\$84.10	\$0.00		
LABORER - OT RATE	0	\$80.78	\$0.00		
OPERATOR - REGULAR RATE	0	\$83.78	\$0.00		
OPERATOR - OT RATE	0	\$113.82	\$0.00		
				<b>COST</b>	<b>MARKUP</b>
					20%
					<b>TOTAL</b>
				(\$289.08)	(\$57.81)
					(\$346.87)
<b>TOTAL LABOR COSTS:</b>					
<b>ENGINEERING COSTS</b>					
	HOURS	RATE	EXT \$		
PROJECT MANAGER	0	\$90.00	\$0.00		
DESIGN ENGINEER (COORDINATION)	0	\$75.00	\$0.00		
PROJECT ENGINEER	0	\$80.00	\$0.00		
CAD ENGINEER	0	\$50.00	\$0.00		
PROJECT ASSISTANT	0	\$40.00	\$0.00		
				<b>COST</b>	<b>MARKUP</b>
					20%
					<b>TOTAL</b>
				\$0.00	\$0.00
					\$0.00
<b>TOTAL INDIRECT COSTS:</b>					
<b>CODE</b>	<b>EQUIP. (CALTRANS RATES 3M6)</b>	<b>HOURS</b>	<b>RATE</b>	<b>EXT \$</b>	
06-12	PICKUP TRUCK/HR.	0	\$27.33	\$0.00	
20-28	UTILITY WORK TRUCK/HR.	-2	\$71.82	(\$143.64)	
016-025	AIR COMPRESSOR ONLY/HR.	0	\$36.14	\$0.00	
20-28	BATCH TRUCK W/MIXER/HR.	0	\$40.38	\$0.00	
36-48	CRANE TRUCK/HR.	0	\$98.75	\$0.00	
12-20	BUCKET TRUCK/HR.	0	\$71.89	\$0.00	
3AXL	DUMP TRUCK (3 AXLES)/HR.	0	\$72.07	\$0.00	
20-28	DELIVERY TRUCK (20K-28K)/HR.	0	\$38.04	\$0.00	
12-20	WATER TRUCK (12K-20K)/HR.	0	\$33.48	\$0.00	
	DUMP TRAILER/HR.	0	\$15.00	\$0.00	
TM	ARROWBOARD/HR.	0	\$3.39	\$0.00	
250BJ	BACKHOE (JD 410G)/HR.	0	\$60.73	\$0.00	
	BACKHOE TRAILER/HR.	0	\$20.00	\$0.00	
	TRENCHER/DAY	0	\$226.00	\$0.00	
				<b>COST</b>	<b>MARKUP</b>
					18%
					<b>TOTAL</b>
				(\$143.64)	(\$21.55)
					(\$165.10)
<b>TOTAL TOOLS/EQUIP. COSTS:</b>					
<b>SUBCONTRACTS</b>					
	QTY	UM	EXT \$		
DELETE TYPE "D" LOOPS	7		(\$240.00)	(\$1,880.00)	
DELETE TYPE "E" LOOPS	17		(\$215.00)	(\$3,655.00)	
ADD TYPE E ADVANCE LOOPS	3		\$800.00	\$2,400.00	
				<b>COST</b>	<b>MARKUP</b>
					5%
					<b>TOTAL</b>
				(\$2,935.00)	(\$146.75)
					(\$3,081.75)
<b>TOTAL SUBCONTRACT COSTS:</b>					
<b>SUBTOTAL COSTS:</b>					
				<b>COST</b>	<b>MARKUP</b>
					<b>TOTAL</b>
				-\$3,617.98	-\$283.83
					-\$3,901.40
	<b>SUBTOTAL</b>	<b>PERCENT</b>	<b>EXT \$</b>		
DESIGN SERVICES	\$0.00	7.76%	\$0.00		\$0.00
BONDING	\$0.00	1.00%	\$0.00		\$0.00
<b>GRAND TOTAL OF THIS CHANGE ORDER:</b>					
					(\$3,901.40)

Backup to deletion of DLC Cable  
and installation. Bid Item #24  
Credit

**BELCO  
MATERIALS AND OPERATIONS BREAKDOWN**

PROJECT:

PCO NO:

DIRECTIVE NO:

ESTIMATED BY

CHECKED BY

DATE 9/30/2015

MATERIAL OR OPERATION	QTY	PRICE	PER	EXT. PRICE	LABOR UNIT	PER	EXT. LABOR
DELETE DLC CABLE	530	-0.40	E	-212.00	0.00	E	0.00
DELETE DLC CABLE (LABOR)	1	0.00	E	0.00	-4.00	E	-4.00
				0.00			0.00
				0.00			0.00
				0.00			0.00
				0.00			0.00
				0.00			0.00
				0.00			0.00
				0.00			0.00
				0.00			0.00
				0.00			0.00
				0.00			0.00
				0.00			0.00
				0.00			0.00
				0.00			0.00
				0.00			0.00
				0.00			0.00
				0.00			0.00
				0.00			0.00
				0.00			0.00
				0.00			0.00
				0.00			0.00
				0.00			0.00
				0.00			0.00
				0.00			0.00
				0.00			0.00
				0.00			0.00
				0.00			0.00
				0.00			0.00
				0.00			0.00
				0.00			0.00
				0.00			0.00
				0.00			0.00
				0.00			0.00
				0.00			0.00
				0.00			0.00
				0.00			0.00
				0.00			0.00
				0.00			0.00
<b>TOTALS</b>				<b>-212.00</b>			<b>-4.00</b>



Iteris, Inc.  
1700 Carnegie Avenue  
Suite 100  
Santa Ana, CA 92705-5551

Michael Girardot  
RodefX  
Phone:  
Email: [rodefx@verizon.net](mailto:rodefx@verizon.net)

EQUIPMENT QUOTATION

Quote #00002228

September 29, 2015

Contractor	Agency: Palm Springs, City of Contractor: Project Name: 2015061620 Palm Springs Vista Chino (SR-111) at Farrell Dr 4 camera system Reference: Palm Springs Vista Chino (SR-111) at Farrell Dr 4 camera system	Delivery Term: FOB Shipping Point Payment Terms: NET 30 Days
------------	--	---

Fax or email Purchase Orders to: 949-270-9441 or [rsorders@iteris.com](mailto:rsorders@iteris.com). Please include Quote Number on your Purchase Order. Prices are valid for 30 days from the date of quote unless extended in writing. Prices on this quote include material only unless otherwise stated. For questions regarding this quotation, please contact the representative listed above.

Vista Chino (SR-111) at Farrell Dr				
Product Name	Product Description	Qty	Unit Price	Ext. Price
EDGE2EM2-PAK	Vantage Edge2 Extension Module - 2 Channel, 24VDC, Includes RJ45 EMCABLE)	6		
EDGECONNECT-PAK	Iteris Vantage EdgeConnect, IP addressable Ethernet module (Includes EM Cables, Ethernet Patch Cable, Multi-Video Cable, Ethernet Crossover Cable, Null Modem Serial Cable, USB Mouse, Software, & Manual)	1		
MON-17IN	17in. LCD Color Monitor, w/ Drawer, (1U rack mount drawer w/ integrated fold down monitor)	1		
SURGEPAN	Power & Video Surge Protection Panel w/ mounting for up to 4 Suppressors (Din Rail Configuration)	1		
TURN ON SUPPORT	Turn on requests outside of normal business hours M-F 8:00am-5:00pm will require a \$1,250.00 additional charge.	1		
VEC-EDGE2-1N-PAK	Iteris Vantage Edge2 Processor with SmartCycle technology - 1 Camera Input, 24VDC (For use with VECTOR Sensor only)	4		
VECTOR	Iteris Vantage Vector Sensor System - Includes WDR camera in environmental enclosure, radar sensor, interface box, 120/240V internal power supply, manual, and ship kit	4		
				<b>\$32,480.00</b>

Important Notes:

This quotation and any resulting order are subject to Iteris' Roadway Sensor Products Standard Terms and Conditions of Sale attached hereto or available at <http://www.iteris.com/RS-Std-TC.pdf>, which are incorporated herein by this reference.

RodefX is an authorized Iteris Sales Representative for Iteris Roadway Sensors products and may sign quotations on Iteris' behalf with a total sales price of \$80,000 or less. Quotations that exceed \$80,000 in total price must be approved by an Authorized Iteris Signature.

SUBTOTAL	\$32,480.00
FREIGHT	
TAX	\$2,923.20
<b>TOTAL:</b>	<b>\$35,403.20</b>

\_\_\_\_\_

Authorized Iteris Signature
Date
Michael Girardot, RodefX



Attn: Tom Gebelin  
Belco-Electnor Group

Reg Change Order to  
Job# 14-0035

**QUOTATION**

<b>Quote #:</b>	SCC083115CO	<b>Estimator:</b>	Shellie Campbell
<b>Agency:</b>	Palm Springs City of		(760)734-5031
<b>Job Name:</b>	Farrell Drive Right Turn Lane at Vista Chino		scampbell@mccain-inc.com
<b>Bid Date:</b>	8/31/15		

<b>Bid Item</b>	<b>Description</b>	<b>Price</b>
	<i>Vista Chino at Farrell Dr</i>	
	Qty 1, Wireless Modem with (2) Antennas, and Tech Support.	\$2,467.00

NO other material is included with this bid

Standard lead-time is 4 weeks for delivery

Bid per receipt of revised Plans against Const Note# 1. Any request for revision may result to a price change.

**NO BID on Video Det Sys**

McCain Inc. is an international corporation with factories, vendors and suppliers located throughout the world. Unless specifically noted, we are not aware and/or may not comply with Buy America requirements particular to this project.

**This quote valid for 30 days.**

<b>Reference Total</b>	<b>\$2,467.00</b>
------------------------	-------------------

Prices firm for 30 days. Freight included. Add sales tax.  
Sale is subject to McCain's standard terms and conditions.

The information transmitted is intended only for the person or entity to which it is addressed and may contain confidential and/or legally privileged material. Any review, retransmission, dissemination or other use of, or taking of any action in reliance upon, this information by persons or entities other than the intended recipient is prohibited.

If you received this in error, please contact the sender and delete the material from any computer.

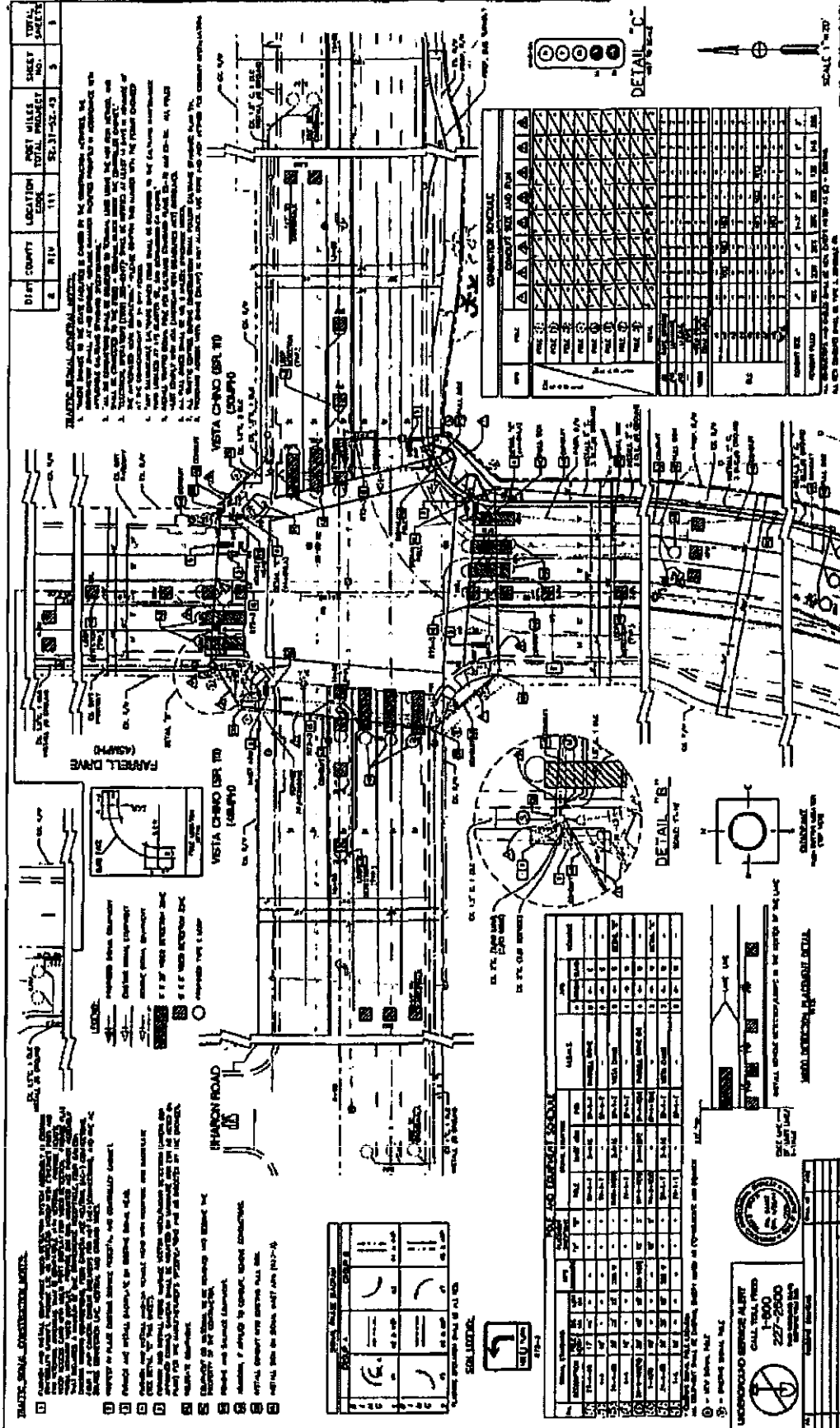

DIST. COMPT. 8 11.1 11.1 8 11.1 11.1 8 11.1 11.1

SHEET NO. 5

TOTAL SHEETS 5

SHEET 5 OF 5

DATE: 11-11-03

PROJECT NO. 227-2000

SCALE: 1"=20'

BY: [Signature]

APPROVED BY: [Signature]

NO.	DESCRIPTION	DATE	BY	CHKD.
1	10-10-03	JK	JK	
2	11-11-03	JK	JK	
3				
4				
5				
6				
7				
8				
9				
10				

NO.	DESCRIPTION	DATE	BY	CHKD.
1				
2				
3				
4				
5				
6				
7				
8				
9				
10				

CITY OF PALM SPRINGS, CALIFORNIA		TRAFFIC SIGNAL MODIFICATION	
NO. 5	TRAFFIC SIGNAL MODIFICATION		
NO. 5	TRAFFIC SIGNAL MODIFICATION		
NO. 5	TRAFFIC SIGNAL MODIFICATION		
NO. 5	TRAFFIC SIGNAL MODIFICATION		

Construction Set Sept-15



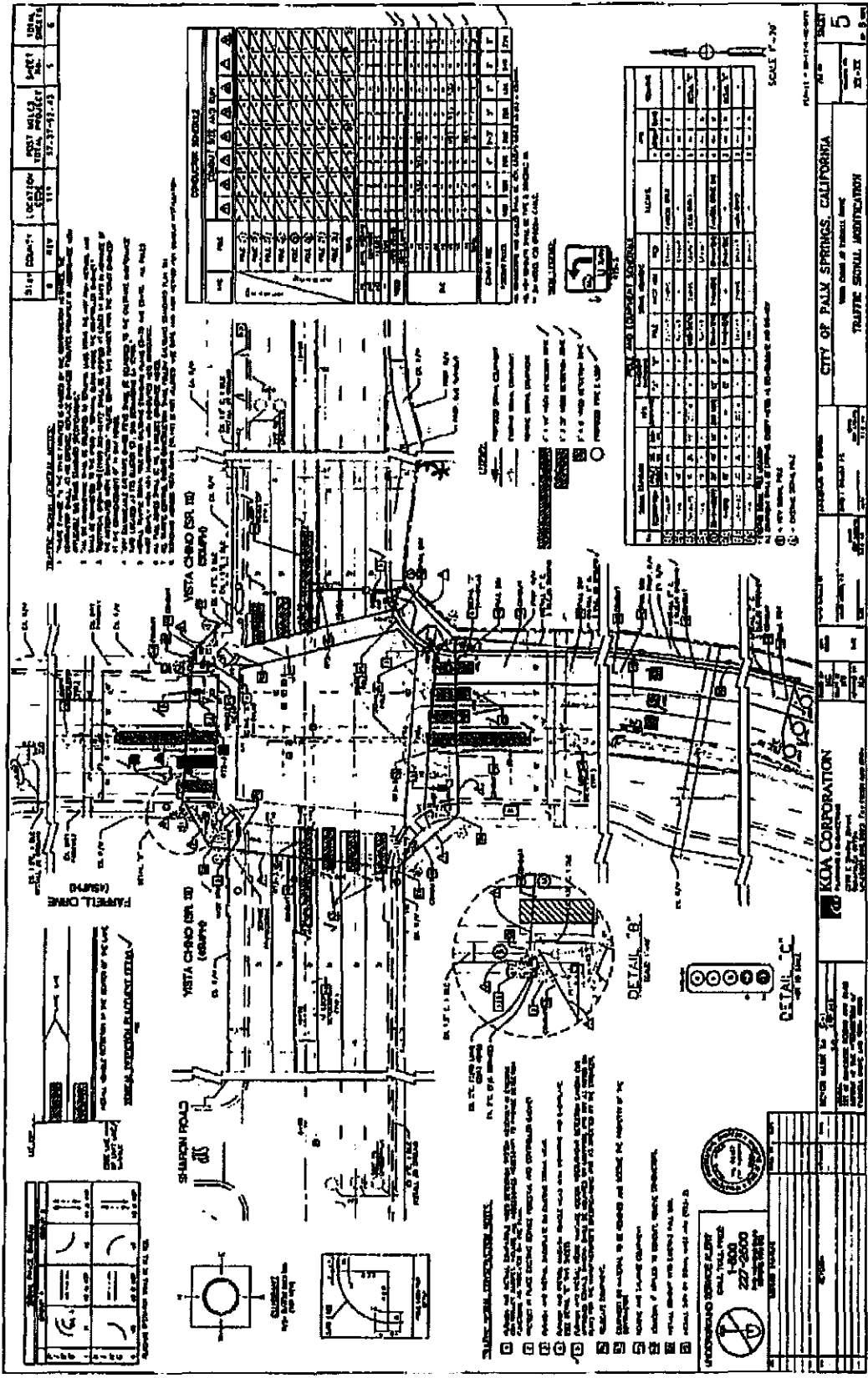

DATE	REVISION	BY	CHKD.	APP'D.
11/11/11	1	...	...	...
11/11/11	2	...	...	...
11/11/11	3	...	...	...
11/11/11	4	...	...	...
11/11/11	5	...	...	...
11/11/11	6	...	...	...

CONCRETE SIGNALS		LOCATION		TYPE		MOUNTING		HEIGHT		REMARKS	
NO.	TYPE	ST.	OFF.	TYPE	NO.	TYPE	NO.	TYPE	NO.	NO.	NO.
1	...	...	...	...	...	...	...	...	...	...	...
2	...	...	...	...	...	...	...	...	...	...	...
3	...	...	...	...	...	...	...	...	...	...	...
4	...	...	...	...	...	...	...	...	...	...	...
5	...	...	...	...	...	...	...	...	...	...	...
6	...	...	...	...	...	...	...	...	...	...	...
7	...	...	...	...	...	...	...	...	...	...	...
8	...	...	...	...	...	...	...	...	...	...	...
9	...	...	...	...	...	...	...	...	...	...	...
10	...	...	...	...	...	...	...	...	...	...	...
11	...	...	...	...	...	...	...	...	...	...	...
12	...	...	...	...	...	...	...	...	...	...	...
13	...	...	...	...	...	...	...	...	...	...	...
14	...	...	...	...	...	...	...	...	...	...	...
15	...	...	...	...	...	...	...	...	...	...	...
16	...	...	...	...	...	...	...	...	...	...	...
17	...	...	...	...	...	...	...	...	...	...	...
18	...	...	...	...	...	...	...	...	...	...	...
19	...	...	...	...	...	...	...	...	...	...	...
20	...	...	...	...	...	...	...	...	...	...	...
21	...	...	...	...	...	...	...	...	...	...	...
22	...	...	...	...	...	...	...	...	...	...	...
23	...	...	...	...	...	...	...	...	...	...	...
24	...	...	...	...	...	...	...	...	...	...	...
25	...	...	...	...	...	...	...	...	...	...	...
26	...	...	...	...	...	...	...	...	...	...	...
27	...	...	...	...	...	...	...	...	...	...	...
28	...	...	...	...	...	...	...	...	...	...	...
29	...	...	...	...	...	...	...	...	...	...	...
30	...	...	...	...	...	...	...	...	...	...	...
31	...	...	...	...	...	...	...	...	...	...	...
32	...	...	...	...	...	...	...	...	...	...	...
33	...	...	...	...	...	...	...	...	...	...	...
34	...	...	...	...	...	...	...	...	...	...	...
35	...	...	...	...	...	...	...	...	...	...	...
36	...	...	...	...	...	...	...	...	...	...	...
37	...	...	...	...	...	...	...	...	...	...	...
38	...	...	...	...	...	...	...	...	...	...	...
39	...	...	...	...	...	...	...	...	...	...	...
40	...	...	...	...	...	...	...	...	...	...	...
41	...	...	...	...	...	...	...	...	...	...	...
42	...	...	...	...	...	...	...	...	...	...	...
43	...	...	...	...	...	...	...	...	...	...	...
44	...	...	...	...	...	...	...	...	...	...	...
45	...	...	...	...	...	...	...	...	...	...	...
46	...	...	...	...	...	...	...	...	...	...	...
47	...	...	...	...	...	...	...	...	...	...	...
48	...	...	...	...	...	...	...	...	...	...	...
49	...	...	...	...	...	...	...	...	...	...	...
50	...	...	...	...	...	...	...	...	...	...	...

NO.	TYPE	LOCATION	REMARKS
1	...	...	...
2	...	...	...
3	...	...	...
4	...	...	...
5	...	...	...
6	...	...	...
7	...	...	...
8	...	...	...
9	...	...	...
10	...	...	...
11	...	...	...
12	...	...	...
13	...	...	...
14	...	...	...
15	...	...	...
16	...	...	...
17	...	...	...
18	...	...	...
19	...	...	...
20	...	...	...
21	...	...	...
22	...	...	...
23	...	...	...
24	...	...	...
25	...	...	...
26	...	...	...
27	...	...	...
28	...	...	...
29	...	...	...
30	...	...	...
31	...	...	...
32	...	...	...
33	...	...	...
34	...	...	...
35	...	...	...
36	...	...	...
37	...	...	...
38	...	...	...
39	...	...	...
40	...	...	...
41	...	...	...
42	...	...	...
43	...	...	...
44	...	...	...
45	...	...	...
46	...	...	...
47	...	...	...
48	...	...	...
49	...	...	...
50	...	...	...

SCALE 1" = 40'

TRAFFIC SIGNAL MODIFICATION

CITY OF PALM SPRINGS, CALIFORNIA

TRAFFIC SIGNAL MODIFICATION

NO. 5

DATE: 11/11/11

BY: [Signature]

CHKD.: [Signature]

APP'D.: [Signature]

PROJECT NO. 1111

PROJECT NAME: TRAFFIC SIGNAL MODIFICATION

LOCATION: VISTA CHINO (SR 10) AT SHILOH ROAD

DESIGNED BY: [Signature]

DRAWN BY: [Signature]

CHECKED BY: [Signature]

APPROVED BY: [Signature]

DATE: 11/11/11

SCALE: 1" = 40'

TRAFFIC SIGNAL MODIFICATION

CITY OF PALM SPRINGS, CALIFORNIA

TRAFFIC SIGNAL MODIFICATION

NO. 5

DATE: 11/11/11

BY: [Signature]

CHKD.: [Signature]

APP'D.: [Signature]

PROJECT NO. 1111

PROJECT NAME: TRAFFIC SIGNAL MODIFICATION

LOCATION: VISTA CHINO (SR 10) AT SHILOH ROAD

DESIGNED BY: [Signature]

DRAWN BY: [Signature]

CHECKED BY: [Signature]

APPROVED BY: [Signature]

DATE: 11/11/11

SCALE: 1" = 40'

TRAFFIC SIGNAL MODIFICATION

CITY OF PALM SPRINGS, CALIFORNIA

TRAFFIC SIGNAL MODIFICATION

NO. 5

DATE: 11/11/11

BY: [Signature]

CHKD.: [Signature]

APP'D.: [Signature]

PROJECT NO. 1111

PROJECT NAME: TRAFFIC SIGNAL MODIFICATION

LOCATION: VISTA CHINO (SR 10) AT SHILOH ROAD

DESIGNED BY: [Signature]

DRAWN BY: [Signature]

CHECKED BY: [Signature]

APPROVED BY: [Signature]

DATE: 11/11/11

SCALE: 1" = 40'

Revision 1 July-15

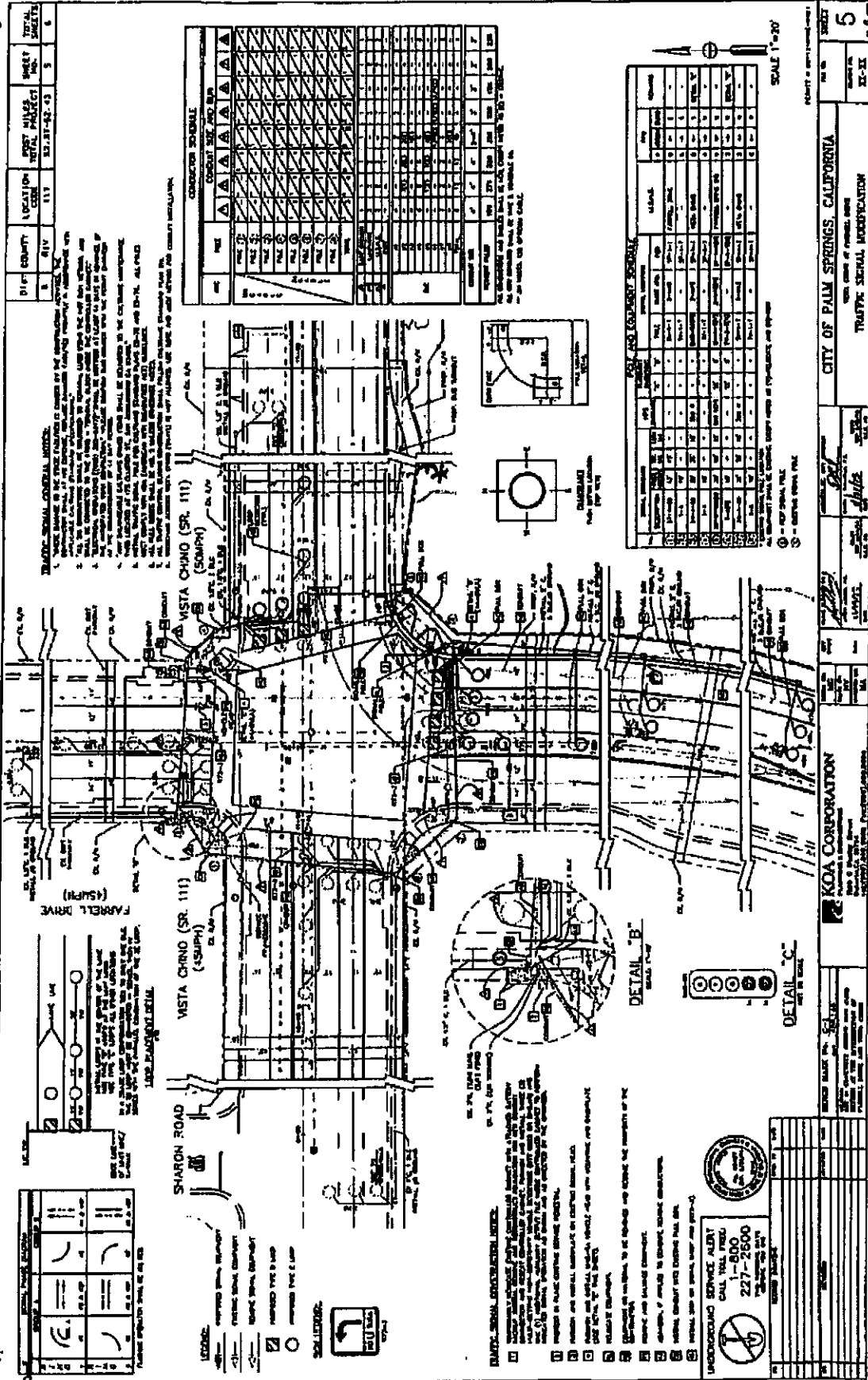

DIST. COUNTY:	111	RIV	53-RT-42-43	5	6
LOCATION CODE:					
TOTAL SHEETS:					

NO.	DESCRIPTION	AMOUNT	DATE
1	CONCRETE	100	1/15/80
2	STEEL	200	1/15/80
3	PAVING	300	1/15/80
4	UTILITIES	400	1/15/80
5	LANDSCAPE	500	1/15/80
6	TRAVEL	600	1/15/80
7	CONCRETE	700	1/15/80
8	STEEL	800	1/15/80
9	PAVING	900	1/15/80
10	UTILITIES	1000	1/15/80
11	LANDSCAPE	1100	1/15/80
12	TRAVEL	1200	1/15/80
13	CONCRETE	1300	1/15/80
14	STEEL	1400	1/15/80
15	PAVING	1500	1/15/80
16	UTILITIES	1600	1/15/80
17	LANDSCAPE	1700	1/15/80
18	TRAVEL	1800	1/15/80
19	CONCRETE	1900	1/15/80
20	STEEL	2000	1/15/80
21	PAVING	2100	1/15/80
22	UTILITIES	2200	1/15/80
23	LANDSCAPE	2300	1/15/80
24	TRAVEL	2400	1/15/80
25	CONCRETE	2500	1/15/80
26	STEEL	2600	1/15/80
27	PAVING	2700	1/15/80
28	UTILITIES	2800	1/15/80
29	LANDSCAPE	2900	1/15/80
30	TRAVEL	3000	1/15/80

NO.	DESCRIPTION	AMOUNT	DATE
31	CONCRETE	3100	1/15/80
32	STEEL	3200	1/15/80
33	PAVING	3300	1/15/80
34	UTILITIES	3400	1/15/80
35	LANDSCAPE	3500	1/15/80
36	TRAVEL	3600	1/15/80
37	CONCRETE	3700	1/15/80
38	STEEL	3800	1/15/80
39	PAVING	3900	1/15/80
40	UTILITIES	4000	1/15/80
41	LANDSCAPE	4100	1/15/80
42	TRAVEL	4200	1/15/80
43	CONCRETE	4300	1/15/80
44	STEEL	4400	1/15/80
45	PAVING	4500	1/15/80
46	UTILITIES	4600	1/15/80
47	LANDSCAPE	4700	1/15/80
48	TRAVEL	4800	1/15/80
49	CONCRETE	4900	1/15/80
50	STEEL	5000	1/15/80

SCALE: 1"=20'
CITY OF PALM SPRINGS, CALIFORNIA
TRAFFIC SIGNAL MODIFICATION
SHEET NO. 5

"Bid Set"

TRAFFIC SIGNAL MODIFICATION

CONTRACT NO. 53-RT-42-43

CONTRACT NO. 53-RT-42-43

CONTRACT NO. 53-RT-42-43



## CITY OF PALM SPRINGS CONTRACT CHANGE ORDER

To: Hillcrest Contracting  
P.O. Box 1898  
Corona, CA 91718-1898  
Tel: (951) 273-9600

Date: February 23, 2016  
Project No: 09-11  
Project: Farrell Dr. Rt. Turn at Vista Chino  
Improvements  
Change Order No: 2  
Purchase Order: 15-1085  
Account: 134-4498-60076

Attn: Darcy Searle

### CHANGES IN WORK/COST:

This Contract Change Order No. 1 makes adjustments to existing Bid Items and adds six new work items, generally identified as:

Bid Item No.	Description	Price	Quantity	Total
5	Project Info Signs	\$1,000.00	-2 each	(\$2,000.00)
6	3" AC	\$120.00	+33.47 tons	\$4,016.40
7	6" Base	\$104.00	+22.16 CY	\$2,304.64
8	Type A3 6" C&G	\$22.00	+3.00 lf	\$66.00
9	Type A2-8 8" C&G	\$23.00	-60 lf	(\$1,380.00)
10	4" PCC Colored Sidewalk	\$430.00	-10 cy	(\$4,300.00)
12	10" PCC Pavement	\$10.00	-900 sf	(\$9,000.00)
13	8" PCC Bus Pad	\$380.00	+7.50 cy	\$2,850.00
14	Type A1-8 8" Curb	\$15.00	-14 lf	(\$210.00)
15	Curb & Gutter Transition	\$25.00	+18 lf	\$450.00
18	Remove Ex AC Pavement	\$1.45	-1836 sf	(\$2,662.20)
19	Remove Ex PCC C&G	\$7.80	+7 lf	\$54.60
21	Relocate Bus Stop Eq.	\$4,000.00	-1 LS	(\$4,000.00)
22	Remove Existing Tree	\$1,200.00	+2 each	\$2,400.00
24	Traffic Signal, Lighting & Electrical System	\$10,269.00	+0.105 LS	\$10,269.00

SUBTOTAL (\$1,141.56)

### NEW ITEMS

Item	Description	Price	Quantity	Total
A	K-rail and Crash Cushions	\$11,004.00	1	\$11,004.00
B	Cold plane AC	\$5,520.00	1	\$5,520.00
C	R&R Pull Boxes	\$5,671.86	1	\$5,955.45
D	Install Thermo Marking for X Walks	\$1,940.00	1	\$1,940.00
E	Survey	\$805.00	1	\$805.00
F	Caltrans Permit Fees	\$4,828.52	1	\$4,828.52

SUBTOTAL \$30,052.97

**TOTAL CHANGE ORDER AMOUNT \$28,911.41**

**DUPLICATE ORIGINAL**

**CHANGES TO CONTRACT TIME:**

0 working days will be added for Contract Change Order No.2.

**SOURCE OF FUNDS:**

The following accounts will be utilized:

Item	Description	Amount	Account Utilized
C.O. #2	Local Measure A	\$28,911.41	134-4498-60076

**REASONS FOR CHANGES:**

**Bid Schedule, Items 5,6,7,8,9,10,12,13,14,15,18,19,21,22**

Actual quantities were more or less than the original estimate in the amounts indicated.

**Bid Schedule, Item 24, Traffic Signal, Lighting & Electrical System:** Caltrans insisted that new conduit runs be installed as indicated on the original plans and refused to utilize the existing conduit. This eliminated the credit of \$10,269.00 that had been taken on CCO 1 and the cost for this work was put back into the item.

**New Item A, K-rail and Crash Cushions:** Caltrans requested that the Contractor place crash cushions and K-rail along the right shoulder of eastbound Vista Chino (Rte 111). This work was not specified in the original contract. \$11,004.00 Lump Sum/Agreed Price.

**New Item B, Cold-plane Existing AC:** Cold-plane existing two NB Farrell lanes adjacent to the new right hand turn lane in order fix some localized pavement failures. \$5,520.00 Lump Sum/Agreed Price.

**New Item C, R&R Pull Boxes:** Project plans called for reusing the existing pull boxes. These boxes were broken and had to be replaced with new boxes. Work included removing and disposing of the old boxes, purchasing and installing new boxes and sidewalk repair. \$5,955.45 Lump Sum/Agreed Price.

**New Item D, Additional Striping and Markings:** Installation of button detail for lane lines that were removed by cold-planing. Repair of existing thermoplastic crosswalk markings. \$1,940.00 Lump Sum/Agreed Price.

**New Item E, Survey:** Install construction staking to facilitate the relocation of an existing water meter and backflow device prior to construction. \$805.00 Lump Sum/Agreed Price.

**New Item F, Caltrans Permit Fees:** Procure encroachment permit from Caltrans. Not originally identified in the project specifications. \$4,828.52 Lump Sum/Agreed Price.

Contract Change Order No. 2  
February 5, 2015  
Page 3

**SUMMARY OF COSTS:**

Original Contract Amount:	\$326,613.00	Original Completion	January 6, 2016
This Change Order:	\$ 28,911.41	Days Added	0
Previous Change Order(s):	\$ 41,418.20	Previous Days Added:	0
Revised Contract Amount:	<b>\$ \$396,942.61</b>	Revised Completion	January 6, 2016

**\*\*\*\* SIGNATURES ON NEXT PAGE \*\*\*\***

I have received a copy of this Change Order and the above AGREED PRICES are acceptable to Contractor

**Hillcrest Contracting**            3-15-14  
Signature      Date  
Dancy Seale pg mgr  
Printed Name and Title

**Transtech Engineers**

Recommended By:            3-15-16  
for Kurt Pegg, Resident Engineer      Date

**City of Palm Springs**

Recommended By:            3/24/16  
Marcus Fuller      Date  
Assistant City Manager/City Engineer

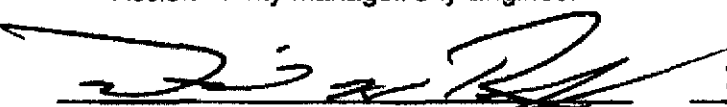
Approved By:            3.30.16  
David H. Ready, City Manager      Date

Attest By:            03/30/2016  
James Thompson, City Clerk      Date

Distribution:  
Original Conformed Copy:  
Contractor      (1)  
City Clerk      (1)

Conformed - File Copy:  
Engineering Pay File      (1)  
City Project File      (1)  
Purchasing      (1)  
Finance      (1)

APPROVED BY CITY COUNCIL  
7.15.15 am AB593

# Vista Chino Farrel CCO Summary

## Contract Change Order Number 2

Bid Item #	Description	Price	Markup 5%	Subtotal	Bond 1%	Total
5	Project Info Signs					\$ (2,000.00)
6	3" AC					\$ 4,016.40
7	6" Base					\$ 2,304.64
8	Type A3 6" C&G					\$ 66.00
9	Type A2-8 8" C&G					\$ (1,380.00)
10	4" PCC Colored Sidewalk					\$ (4,300.00)
12	10" PCC Pavement					\$ (9,000.00)
13	8" PCC Bus Pad					\$ 2,850.00
14	Type A1-8 8" Curb					\$ (210.00)
15	Curb & Gutter Transition					\$ 450.00
18	Remove Ex AC Pavement					\$ (2,662.20)
19	Remove Ex PCC C&G					\$ 54.60
21	Relocate Bus Stop Eq					\$ (4,000.00)
22	Remove Existing Tree					\$ 2,400.00
24	Traffic Signal, Lighting and Electrical System per Plan No. 5 of 6					\$ 10,269.00
	<b>Total</b>					\$ (1,141.56)

New Items	Description	Price	Markup 15%	Markup 5%	Subtotal	Bond 1%	Total
A	K-rail and Crash Cushions	\$ 11,004.00		\$ -		\$ -	\$ 11,004.00
B	Cold Plane AC	\$ 5,520.00		\$ -		\$ -	\$ 5,520.00
C	R&R Pull Boxes	\$ 5,671.86		\$ 283.59		\$ -	\$ 5,955.45
D	Install Thermo Marking for X Walks	\$ 1,940.00		\$ -		\$ -	\$ 1,940.00
E	Survey	\$ 700.00	\$ 105.00	\$ -		\$ -	\$ 805.00
F	Caltrans Permit Fees	\$ 4,828.52		\$ -	\$ -	\$ -	\$ 4,828.52

Total of Bid Items and New Items

\$ 28,911.41

# HILLCREST CONTRACTING

General Engineering Contractors

License# 471664A

City of Palm Springs  
Public Works Department  
3200 Tahquitz Canyon Way  
Palm Springs, CA 92263

Date: November 2, 2015 Revised 1/4/16  
Subject: Request for Change Order#002.1  
Job Title: 09-11

Attention: Mike Lytar

Job Number: 2612

We are sending you  herewith the following  under separate cover:

## REQUEST FOR CHANGE ORDER# 002.1 – Changed conditions from bid:

Our bid was based off the special provisions for Vista Chino and Farrell Drive, City project #09-11. We have run into some unknown changed conditions from our original bid to project conditions. The reason not known at bid time is that the original Caltrans permit and requirements was not included with the bid documents.

Additional to above, at bid time, we determined our work areas to be under the City's special provisions #7-1-21 items #4 and #5 which provided us with our area for excavations parallel to the lane for purpose of the concrete pavement/pavement widening. We designed our traffic control plans in accordance with the City's special provisions #7-1-21, #5 and Caltrans Std. provisions section # 7-7-01-04 which allows us to establish and maintain a 4:1 slope in lieu of using K-rail. After many months of plan reviews with Caltrans, the City requested us to provide K-rail due to Caltrans not approving the traffic control plans without it.

Caltrans Permit fee's	\$ 4,582.52	New Item F
Caltrans Permit extension fee's	\$ 246.00	
Traffic Control K-Rail and Crash Cushions	\$11,004.00	New Item A
<b>Total</b>	<b>\$15,832.52</b>	

We are requesting to be reimbursed for the associated cost with these changed conditions.

For your:  Perusal  Approval  Files  Quotation

Sincerely,

Darcy Searle  
Project Manager/QSP

2612- RFC#002.0



STATE OF CALIFORNIA · DEPARTMENT OF TRANSPORTATION  
**ENCROACHMENT PERMIT**  
 TR-0120 (REV. 6/2012)

Permit No.	
08-14-6-DP-1100	
Dist/Co/Rte/PM	
08-RIV-111 PM 52.37-PM 52.43	
Date	
04/06/2015	
Fee Paid	Deposit
\$	\$ 4582.52
Performance Bond Amount (1)	Payment Bond Amount (2)
\$ 0.00	\$ 0.00
Bond Company	
Bond Number (1)	Bond Number (2)

In compliance with:

- Your application of December 11, 2014
- Utility Notice No. \_\_\_\_\_ of \_\_\_\_\_
- Agreement No. \_\_\_\_\_ of \_\_\_\_\_
- R/W Contract No. \_\_\_\_\_ of \_\_\_\_\_

TO: Hillcrest Contracting, Inc.  
 1467 Circle City Drive  
 Corona, CA 92879  
 Attn: Darcy Searle, Project Manager (951) 273-9600

, PERMITTEE

and subject to the following, PERMISSION IS HEREBY GRANTED to:

Entering upon State right of way at the intersection of State Route 111 (SR-111) and Vista Chino, to add a right turn lane and modify the traffic signal as per plans date stamped October 24, 2013 by the Caltrans Encroachment Permit Office, and/or as directed by the Department Representative.

New Item F

A pre-job meeting with the assigned Caltrans Representative, Ebrahim Zbrahim, 909-383-4508, is required at least 7 days prior to start of any work under this permit! Failure to do so may result in permit revocation with no prejudice.

**THIS PERMIT IS NOT A PROPERTY RIGHT AND DOES NOT TRANSFER WITH THE PROPERTY TO A NEW OWNER.**

The following attachments are also included as part of this permit (Check applicable):

- Yes  No General Provisions
- Yes  No Utility Maintenance Provisions
- Yes  No Storm Water Special Provisions
- Yes  No Special Provisions
- Yes  No A Cal-OSHA permit, if required: Permit No. \_\_\_\_\_
- Yes  No As-Built Plans Submittal Route Slip for Locally Advertised Projects
- Yes  No Storm Water Pollution Prevention Plan / Water Pollution Control Plan

In addition to fee, the permittee will be billed actual costs for:

- Yes  No Review
- Yes  No Inspection
- Yes  No Field Work

(if any Caltrans effort expended)

- Yes  No The information in the environmental documentation has been reviewed and considered prior to approval of this permit.

This permit is void unless the work is completed before October 29, 2015

This permit is to be strictly construed and no other work other than specifically mentioned is hereby authorized.

No project work shall be commenced until all the other necessary permits and the environmental clearances have been obtained.

PERMIT ENGINEER: Surinder Sangha  
 RELATED PERMIT(S): 08-12-N-SN-0421  
 COPIES TO:  
 08-12-N-SN-0421: no plans  
 File  
 E. Ebrahim, TE, Elect.  
 M. Morris, TE, Civil  
 Banning Maintenance: no plans

APPROVED:

John Bullinski, Acting District Director

BY:

  
 RICHARD GOH, P.E., District Permit Engineer

**darcy@hillcrestcontracting.com**

---

**From:** darcy@hillcrestcontracting.com  
**Sent:** Wednesday, October 28, 2015 11:14 AM  
**To:** 'Sangha, Surinder S@DOT (surinder.sangha@dot.ca.gov)'  
**Cc:** 'fawzi.zedan@dot.ca.gov'; 'martin.morris@dot.ca.gov'  
**Subject:** FW: Submit Time Extension got permit #8-17-DP-1100 08--RIV-111-PM52.43

**Importance:** High

Surinder,

We are requesting a time extension for permit# 08-14-DP-1100 - 08-RIV-111-PM52.37-PM52.43

I will drop off a check in the amount of \$246.00 later this afternoon – should I make an appointment to see you?

Please let me know if I need to provide anything else.

New Item F



**Only rain water down storm drains**

The discharger shall comply with the requirements in this Order No. 2009-0009-DWQ NPDES no. CA5000002 to meet the provision contained in Division 7 of the California Water Code (commencing with section 13000) and regulations adopted there under, and the provisions of the federal clean water act and regulations and guidelines adopted thereunder.

A copy of the CGP is available for your review in my office –1467 Circle City Drive, Corona, CA 92879

Thank you,

*Darcy Searle*  
Project Manager/QSP/CESSWI/Storm Water Pollution Control Manager



**HILLCREST**  
CONTRACTING, INC.

951-858-9493 Cell#  
951-273-9600 ext # 113  
951-273-9608 Fax#

CONFIDENTIALITY NOTICE: This email may contain confidential and privileged material for the sole use of the intended recipient(s). Any review, use, distribution or disclosure by others is strictly prohibited. If you have received this communication in error, please notify the sender immediately by email and delete the message, and any file attachments from your computer. Thank you.

---

**From:** Morris, Martin@DOT [<mailto:malto:martin.morris@dot.ca.gov>]  
**Sent:** Friday, October 23, 2015 10:13 AM  
**To:** [darcy@hillcrestcontracting.com](mailto:darcy@hillcrestcontracting.com)  
**Cc:** Ebrahim, Ebrahim T@DOT  
**Subject:** Submit Time Extension

Please submit Time Extension for the project in Palm Springs. The Time extension expires on 10/29/2015.

Thanks.

Martin Morris  
Encroachment Permit Inspector  
909-383-4207



# PURCHASE ORDER

**HILLCREST**

CONTRACTING, INC.  
1487 CIRCLE CITY DRIVE  
P.O. BOX 1888  
CORONA, CA 92878-1888

PHONE (951)273-9600  
FAX (951)273-9608

P. O. No: **60400**

Job No: **2612**

Date: **9/3/2015**

<b>VENDOR:</b>	Jensen Precast Corporation	<b>Ship To:</b>	Chandler & E St.
	14221 SAN BERNARDINO AVE		San Bernardino
			SBDO-606-H-5
	FONTANA, CA 92335		
	Phone No. (760) 761-0896	FAX No. (909) 350-0654	

**Quote No.**

Job Location: FARRELL DR. RIGHT TURN LANE AT

Item	Description	Quantity	UM	Unit Price	Extended Price
1	Barrier Rental 20'	20.00	EA	100.000	2,000.00
2	delivery & handling charge	6.00	EA	600.000	3,600.00
3	crane truck	2.00	EA	900.000	1,800.00

**Total Purchase Order** **\$7,400.00**

Price Conditions:

New Item A

Remarks:

Ordered by: Darcy Searle

Signature: \_\_\_\_\_

**Note:** The Job Number and the Purchase Order Number must be included on your invoice for payment. If this information is missing, your invoice will be returned to you.



RECEIVED DEC 28 2015

INVOICE

Corporate Office  
 825 Steneri Way • Sparks, NV 89431  
 (775) 352-2700 • Fax (775) 359-6364  
 Toll Free (877) 914-2705

Invoice ID: SC69286  
 Invoice Date: 12/22/2015  
 Customer ID: HILL008  
 Order Number: SC213889  
 Customer PO: 60400

Sold To

Hillcrest Contracting  
 P.O. Box 1898  
 Corona, CA 92878-1878

Ship To

FARREL DRIVE & VISTA CHINO  
 PALM SPRINGS, CA  
 RENTAL PERIOD ~~11/16/15~~ 12/16/15 to 12/28/15

Quantity		Description	Tax	Unit Price	Amount
Ordered	Shipped				
20	20	BARRIER-RENTAL 20' RENTAL PERIOD 11/16/15- 12/16/15	CA-Riverside	40.0000	800.00

*12 days beyond 30 days*

*Mario Sanchez*

VENDOR # \_\_\_\_\_ DEL DATE \_\_\_\_\_  
 JOB # \_\_\_\_\_ P.O.# \_\_\_\_\_  
 ACCT # \_\_\_\_\_ QUANTITY \_\_\_\_\_  
 ITEM # \_\_\_\_\_ PRICE \_\_\_\_\_  
 APPROVAL \_\_\_\_\_ EXTENSION \_\_\_\_\_  
 OK TO P.Y. \_\_\_\_\_ CK'D BY \_\_\_\_\_

New Item A

<u>Terms Summary</u>	<u>Amount</u>
Net 30 days	\$800.00
<u>Tax Summary</u>	<u>Amount</u>
CA Statewide Base Sales and Use Tax	\$80.00
Riverside County District Tax	\$4.00

Remit To  
 Jensen Precast  
 Corporate Headquarters  
 825 Steneri Way  
 Sparks, NV 89431  
 United States of America

SITE CONT: BILL / CELL# 951 283 3982

Sub Total	800.00
Tax	64.00
Freight	0.00
Payments	0.00
Prior Billing	0.00
Grand Total	864.00

Sales Rep: Omar Negrette

USD



**HILLCREST**  
CONTRACTING, INC.

1487 CIRCLE CITY DRIVE  
P.O. BOX 1898  
CORONA, CA 92878-1898

**PURCHASE ORDER**

P. O. No: 60808

Job No: 2812

PHONE (951)273-9600  
FAX (951)273-9608

Date: 10/27/2015

**VENDOR:** TRAFFIC SAFETY SOLUTIONS, L Ship To: FARRELL DR. & VISTA CHINO  
3482 LA MIRADA DRIVE PALM SPRINGS  
756-G-6  
SAN MARCOS, CA 92069  
Phone No. (760) 212-1470 FAX No. (760) 295-4846

**Quote No.**

Job Location: FARRELL DR. RIGHT TURN LANE AT

Item	Description	Quantity	UM	Unit Price	Extended Price
1	Absorb TL3 6 element	1.00	MN	1,395.000	1,395.00
2	Deliver & install absorb	1.00	EA	220.000	220.00
3	Return Charge	1.00	EA	195.000	195.00

**Total Purchase Order \$1,810.00**

Price Conditions:

*Plus  
Tween  
add - \$ 930*

New Item A

Remarks:

Ordered by: Darcy Searle

Signature: \_\_\_\_\_

**Note:** The Job Number and the Purchase Order Number must be included on your invoice for payment. If this information is missing, your invoice will be returned to you.

RECEIVED DEC 21 2015



INLAND EMPIRE DIVISION
13217 LAURELDALE AVE
DOWNEY, CA 90242
Dispatch Inquiry: 855-326-5953
Billing Inquiry: 888-833-3777

Invoice

INVOICE NUMBER: 71-03445-15
INVOICE DATE: 12/14/15

Table with 3 columns: HILLCREST CONTRACTING (Accounts Payable, PO BOX 1898, CORONA CA 91718, Office Phone: 951-273-9600, Cust ID #: 82780), Project Name: 60806/2812/PALM SPRINGS, Job #: 60806/2812/PALM SPRINGS, Ordered By: JERRY BLAIR, P/O Number: 60806/2812/PALM SPRINGS, Phone: 951-273-9600, Job City: PALM SPRINGS CA, JS Contact: JERRY BLAIR, Job Site Phone: 951-273-9600, Job Site Location: FARRELL DR AND VISTA CHINO

Delivery Instructions: 11/13/2015 02:27 PM ALEXA SANDOVAL DELIVERY AND SET UP OF EQUIPMENT 11/16/15

Rental Contract Number: IE02745-15

Start Rent Date: 11/16/15

Table with columns: Status, Qty, Item Description and Rate, Days, From Date, Thru Date, Rate Each, Rate Ext. Row 1: Out, 1, ABSORB 350 6 ELEMENT, 28, 11/16/15, 12/13/15, 1395.00, 1395.00

Table with columns: Qty, Description, Reg Rate, OT Rate, DT Rate, Reg, OT, DT, Labor Subtotal. Row 1: 1, Traffic Control On-site Labor Per Hour DELIVERY/SET UP 11/16/15, 220.00, 1.00, 220.00

New Item A

VENDOR # 8163 DEL DATE
JOB # 2012 P.O.# 6080
ACCT # 4040 QUANTITY
ITEM # 05050 PRICE
APPROVAL EXTENSION
OK TO R.V. CK'D BY

POSTED DEC 22 2015

Handwritten notes: need Thur 12/28/15, 2 weeks @ \$465.00, \$930

TERMS: C.O.D. Accounts, Deposit Estimate Due Upon Delivery. Credit Accounts are due and payable net 30 days from invoice date. This invoice is subject to additional terms and conditions printed on the reverse side hereof, limiting the seller's warranty, obligations and excluding liability for consequential damages.

Invoice Summary table: Rental \$1,395.00, Sales, Others \$220.00, Tax, Total \$1,615.00

# HILLCREST CONTRACTING

*General Engineering Contractors*

*License# 471664A*

City of Palm Springs  
Public Works Department  
3200 Tahquitz Canyon Way  
Palm Springs, CA 92263

Date: December 9, 2015  
Subject: Request for Change Order#004  
Job Title: 09-11

Attention: Mike Lytar

Job Number: 2612

We are sending you  herewith the following  under separate cover:

**REQUEST FOR CHANGE ORDER# 004.0 – Changed field condition:**

Underground Traffic Signal Conduits reverse credit on cco#1      1 LS    \$10,269.00

**Total \$10,269.00**

For your:  Perusal     Approval  Files     Quotation

Sincerely,

Darcy Searle  
Project Manager/QSP

2612- RFC#004.0

Bid Item #24 Backup





December 3, 2015

Hillcrest Contracting, Inc.  
1467 Circle City Dr.  
Corona, CA 92879

Serial No. 14-0035-012

Attention: Ms. Darcy Seale, Project Manager

Reference: Farrell Dr. Right Turn Lane at Vista Chino Project  
City of Palm Springs Project No. 09-11  
Belco Job No. 14-0035, Hillcrest Job No. 2612

Subject: Price Proposal for Traffic Signal Modifications at the Intersection of Vista Chino and Farrell Dr.  
Belco PCO No. 14-0035-1.05

Dear Ms. Seale:

Elecnor Belco Electric is pleased to provide you with a price proposal for the modifications of the traffic signals at the intersection of Vista Chino and Farrell Dr. for the above referenced project. Belco was directed by Caltrans, Transtech and Hillcrest to install the underground traffic signal conduits as per plan. The following details are provided in this proposal.

Bid Item #24

- 1. PCO 14-0035-1.05  
Scope of work: The installation of Conduit Nos. 2, 3, 5 and 6.  
Lump sum price: \$9,780.00

Please provide a change order for this agreed to work. Should you have any questions or concerns, please do not hesitate to contact me at (909) 993-5470 ext. 234.

Sincerely,  
Elecnor Belco Electric, Inc.



[www.elecnorbelco.com](http://www.elecnorbelco.com)

4331 Schaefer Ave.  
Chino, CA 91710  
(909) 993-5470 Office  
(909) 993-5476 Fax  
CA License 738518



Thomas Gebelin  
Project Manager  
Transportation Division



We think about it before we build  
[www.elecnorbelco.com](http://www.elecnorbelco.com)

4331 Schaefer Ave.  
Chino, CA 91710  
(909) 993-5470 Office  
(909) 993-5476 Fax  
CA License 738518

# HILLCREST CONTRACTING

General Engineering Contractors

License# 471664A

City of Palm Springs  
Public Works Department  
3200 Tahquitz Canyon Way  
Palm Springs, CA 92263

Date: December 16, 2015  
Subject: Request for Change Order#005  
Job Title: 09-11

Attention: Mike Lytar

Job Number: 2612

We are sending you  herewith the following  under separate cover:

**REQUEST FOR CHANGE ORDER# 005.0 -Cold Plane:**

Cold Plane Existing Lanes	1 LS	\$5,520.00
	<b>Total</b>	<b>\$5,520.00</b>

For your:  Perusal  Approval  Files  Quotation

Sincerely,

New Item B

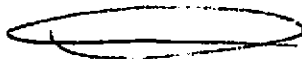

Darcy Searle  
Project Manager/QSP

2612- RFC#005.0

**Details Report For : 2612 FARRELL DR. RIGHT TURN LANE AT VI**

Hillcrest Contracting

JERRY BLAIR

12/16/2015

Ph.	Item	Description	Quantity	U/M	Unit Cost	Total Cost	Margin%	Unit Pricet	Total Price
X	12	COLD PLANE	2,400.00	SF	\$2.00	\$4,806.25	14.85	2.30	\$5,520.00

Activity COLD PLANE Crew EXCAVATION WITH PLANE Activity Qty 2,400 00 SF

Day:	Rate:	2400 SF @	Labor	Days:	TotalCost:	4,806.25
Hour:	300.00 SF		Equipment	1.00	UnitCost:	2.003
			Actual:	1.00		

Labor	Quantity	Hours	Days	Unit Cost	
GENFO GENERAL FOREMAN G	1.00	3.00 HR	1 00	\$79.76	\$239.28
LAB 1 LABORER GROUP 1	2.00	3.00 HR	1 00	\$58.68	\$351.97
<b>Total</b>					<b>\$591.25</b>

Equipment	Quantity	Hours	Days	Unit Cost	
TRPU PICKUP TRUCK	1.00	3.00 HR	1.00	\$20.00	\$60.00
TRW20 WATER TRUCK 2000 G	1.00	3.00 HR	1.00	\$105.00	\$315.00
CPBAR BARTMILL COLDPLANE	1.00	4.00 HR	1.00	\$450.00	\$1,800.00
SWEEP SWEEPER	1.00	4.00 HR	1.00	\$165.00	\$660.00
<b>Total</b>					<b>\$2,835.00</b>

Trucks	Quantity	Unit Cost	
TRKSU SUPER 10 DUMP TRUC	8.00	\$85.00	\$680.00
<b>Total</b>			<b>\$680.00</b>

New Item B

Other	Quantity	Unit Cost	
EQM 3 EQUIPMENT MOVE RA	1.00	\$450.00	\$450.00
DMP2 DUMP FEES-AC/PCC	2.00	\$125.00	\$250.00
<b>Total</b>			<b>\$700.00</b>

Act Note:

Item Note:

# HILLCREST CONTRACTING

General Engineering Contractors

License# 471664A

City of Palm Springs  
Public Works Department  
3200 Tahquitz Canyon Way  
Palm Springs, CA 92263

Date: February 3, 2016  
Subject: Request for Change Order#007  
Job Title: 09-11

Attention: Mike Lytar

Job Number: 2612

We are sending you  herewith the following  under separate cover:

**REQUEST FOR CHANGE ORDER# 007.0 – Belco's Extra work:**

Extra rmvl & replacement of 6 broken/cracked ts pb                      1 LS    \$5,955.45  
  
Total \$5,955.45

For your:  Perusal     Approval     Files     Quotation

Sincerely,



Darcy Searle  
Project Manager/QSP

2612- RFC#007.0

New Item C Backup



February 2, 2016

**Hillcrest Contracting, Inc.**  
1467 Circle City Dr.  
Corona, CA 92879

Serial No. 14-0035-014

**Attention:** Ms. Darcy Seale, Project Manager

**Reference:** Farrell Dr. Right Turn Lane at Vista Chino Project  
City of Palm Springs Project No. 09-11  
Belco Job No. 14-0035, Hillcrest Job No. 2612

**Subject:** Price Proposal for Traffic Signal Modifications at the Intersection of Vista Chino and Farrell Dr.  
Belco PCO No. 14-0035-3.0 & 3.1

Dear Ms. Seale:

Elecnor Belco Electric is pleased to provide you with a price proposal for removal and replacement of 6 broken and cracked traffic signal pull boxes at the intersection of Vista Chino and Farrell Dr. for the above referenced project as directed. The following details are provided in this proposal.

- 1. PCO 14-0035-3.0 and 3.1  
Scope of work: Removal and replacement of 6 broken and cracked traffic signal pull boxes.  
Lump sum price: \$5,671.86

Should you have any questions or concerns, please do not hesitate to contact me at (909) 993-5470 ext. 234.

Sincerely,  
Elecnor Belco Electric, Inc.

Thomas Gebelin  
Project Manager  
Transportation Division



We think about a better world  
[www.elecnorbelco.com](http://www.elecnorbelco.com)

4331 Schaefer Ave.  
Chino, CA 91710  
(909) 993-5470 Office  
(909) 993-5476 Fax  
CA License 738518



4331 SCHAEFER AVE.  
CHINO, CA 91710  
909.993.5470  
909.993.5476 FAX

# DAILY EXTRA WORK REPORT

LICENSE NO. 738518

JOB NUMBER \_\_\_\_\_

DATE 01/13/16 N T W TH F SA SU

JOB NAME Palm Springs

CONTRACTOR / OWNER City of Palm Springs

JOB LOCATION WESTA CLEVO C. FARRER

PERSON OF AUTHORITY \_\_\_\_\_

DESCRIPTION OF EXTRA WORK:

REPLACED 3 TRAFFIC SIGNAL POLES. BOXES NEEDED TO BE REMOVED TO ABANDON OLD CONDUITS ANYWAYS. BOXES WERE CRACKED / BOMBED.

I CONFIRM THE QUANTITY OF TIME AND MATERIAL DESCRIBED HEREIN HAS BEEN USED FOR THE WORK AS STATED ABOVE.

[Signature]

X

BELCO REPRESENTATIVE

CONTRACTOR / OWNER REPRESENTATIVE

LABOR	EMPLOYEE NAME	CLASS	REG HRS	O/T HRS	EMPLOYEE NAME	CLASS	REG HRS	O/T HRS
		SCOTT MANNING	JW	8				
	ADRIAN DUNCAN	LABOR	8					

MATERIAL / RENTAL EQ	QTY	DESCRIPTION	QTY	DESCRIPTION
		3	#6 CHEROKEE Box w/ 120	
	12	BOX RACK		

TOOLS / EQUIP	EQ #	EQUIPMENT DESCRIPTION	REG HRS	O/T HRS	EQ #	EQUIPMENT DESCRIPTION	REG HRS	O/T HRS
		4/8	WALK TRUCK	8				
		w/ Air Compressor	8					

FOR OFFICE USE	BILLING METHOD	BILLING RATES	APPROVED BY _____	DATE _____
	<input type="checkbox"/> GREENBOOK	<input type="checkbox"/> STANDARD		
	<input type="checkbox"/> CALTRANS	<input type="checkbox"/> OTHER		
	<input type="checkbox"/> BACKCHARGE		REC'D IN ACCTING _____	
	<input type="checkbox"/> OTHER _____			

FIELD MATERIAL AND LABOR PRICE SUMMARY (See Price Sheets for Details)				BELCO PCO NO: 3	
DESCRIPTION	MATERIAL \$	LBR HRS.	EXT \$	DATE: 2/1/2016	
MATERIALS PAGE 2	\$285.00	0.00		<b>DESCRIPTION OF WORK OR CHANGE</b> On 1/13/2016 replace 3 traffic signal pull boxes. Boxes were cracked and broken	
MATERIALS PAGE 3	\$0.00	0.00			
MATERIALS PAGE 4	\$0.00	0.00			
MATERIALS PAGE 5	\$0.00	0.00			
MATERIALS PAGE 6	\$0.00	0.00			
MATERIALS PAGE 7	\$0.00	0.00			
SUBTOTAL	\$285.00	0			
SALES TAX @ 0.00%	\$25.05				
FREIGHT @ 4%	\$11.40			<b>COST</b>	
MISCELLANEOUS HARDWARE @ 5%	\$14.25			<b>MARKUP</b> 15%	
<b>TOTAL MATERIAL COSTS:</b>				<b>TOTAL</b> \$338.30    \$50.46    \$388.75	
FIELD LABOR BREAKDOWN	HOURS	RATE	EXT \$		
GENERAL FOREMAN - REGULAR RATE	0	\$90.85	\$0.00	<b>COST</b>	
GENERAL FOREMAN - OT RATE	0	\$128.10	\$0.00		
FOREMAN - REGULAR RATE	8	\$83.75	\$670.00		
FOREMAN - OT RATE	0	\$117.74	\$0.00		
JOURNEYMAN WIREMAN - REG. RATE	0	\$78.85	\$0.00		
JOURNEYMAN WIREMAN - OT RATE	0	\$107.39	\$0.00		
ELEC. APPRENTICE - REGULAR RATE	0	\$87.88	\$0.00		
ELEC. APPRENTICE - OT RATE	0	\$93.65	\$0.00		
LABORER - REGULAR RATE	8	\$84.10	\$672.80		
LABORER - OT RATE	0	\$88.76	\$0.00		
OPERATOR - REGULAR RATE	0	\$83.75	\$0.00		
OPERATOR - OT RATE	0	\$113.82	\$0.00		
<b>TOTAL LABOR COSTS:</b>					<b>TOTAL</b> \$1,182.80    \$238.56    \$1,419.36
ENGINEERING COSTS	HOURS	RATE	EXT \$		
PROJECT MANAGER	0	\$90.00	\$0.00	<b>COST</b>	
DESIGN ENGINEER (COORDINATION)	0	\$75.00	\$0.00		
PROJECT ENGINEER	0	\$80.00	\$0.00		
CAD ENGINEER	0	\$50.00	\$0.00		
PROJECT ASSISTANT	0	\$40.00	\$0.00		
<b>TOTAL INDIRECT COSTS:</b>				<b>TOTAL</b> \$0.00    \$0.00    \$0.00	
CODES	EQUIP./CALTRANS RATES 3/15/15	HOURS	RATE	EXT \$	
08-12	PICKUP TRUCK/HR.	0	\$27.33	\$0.00	<b>COST</b>
20-28	UTILITY WORK TRUCK/HR.	8	\$71.82	\$574.56	
016-025	AIR COMPRESSOR ONLY/HR.	8	\$36.14	\$289.12	
20-28	BATCH TRUCK W/MIXER/HR.	0	\$40.38	\$0.00	
36-48	CRANE TRUCK/HR.	0	\$99.75	\$0.00	
12-20	BUCKET TRUCK/HR.	0	\$71.69	\$0.00	
3AXL	DUMP TRUCK (3 AXLES)/HR.	0	\$72.07	\$0.00	
20-28	DELIVERY TRUCK (20K-28K)/HR.	0	\$36.04	\$0.00	
12-20	WATER TRUCK (12K-20K)/HR.	0	\$33.48	\$0.00	
	DUMP TRAILER/HR.	0	\$15.00	\$0.00	
TM	ARROWBOARD/HR.	0	\$3.39	\$0.00	
2508J	BACKHOE (JD 410G)/HR.	0	\$80.73	\$0.00	
	BACKHOE TRAILER/HR.	0	\$20.00	\$0.00	
	TRENCHER/DAY	0	\$228.00	\$0.00	
<b>TOTAL TOOLS/EQUIP. COSTS:</b>				<b>TOTAL</b> \$863.68    \$128.55    \$992.23	
SUBCONTRACTS	QTY	UM	EXT \$		
			\$0.00	<b>COST</b>	
			\$0.00		
			\$0.00		
<b>TOTAL SUBCONTRACT COSTS:</b>				<b>TOTAL</b> \$0.00    \$0.00    \$0.00	
<b>SUBTOTAL COSTS:</b>				<b>TOTAL</b> \$2,382.78    \$418.56    \$2,799.34	
	SUBTOTAL	PERCENT	EXT \$		
DESIGN SERVICES	\$0.00	7.75%	\$0.00	\$0.00	
BONDING	\$0.00	1.00%	\$0.00	\$0.00	

GRAND TOTAL OF THIS CHANGE ORDER:

\$2,799.34





4331 SCHAEFER AVE.  
CHINO, CA 91710  
909.993.5470  
909.993.5476 FAX

# DAILY EXTRA WORK REPORT

LICENSE NO. 738518

JOB NUMBER \_\_\_\_\_

DATE 10/1/11 M T W TH F SA SU

JOB NAME PALM SPREADS

CONTRACTOR / OWNER CITY of PALM SPRINGS

JOB LOCATION VESTA CTRD @ FAIRFELL

PERSON OF AUTHORITY \_\_\_\_\_

**DESCRIPTION OF EXTRA WORK:**

REPLACE REMAINING 3 PULLBOXES. BOXES HAD TO BE REMOVED TO ABANDON EXISTING CONDUIT ANYWAYS. ~~ONE~~ BOXES WERE CRACKED / BROKEN

I CONFIRM THE QUANTITY OF TIME AND MATERIAL DESCRIBED HEREIN HAS BEEN USED FOR THE WORK AS STATED ABOVE.

X

BELCO REPRESENTATIVE

CONTRACTOR / OWNER REPRESENTATIVE

LABOR	EMPLOYEE NAME	CLASS	REG HRS	O/T HRS	EMPLOYEE NAME	CLASS	REG HRS	O/T HRS
		<u>Scott Maylor</u>	<u>JW</u>	<u>4</u>				
	<u>Adrian Parnes</u>	<u>COCON</u>	<u>8</u>					

MATERIAL / RENTAL EQ	QTY	DESCRIPTION	QTY	DESCRIPTION
		<u>2</u>	<u>#6 CHESTY Box w/ LED</u>	
	<u>1</u>	<u>#5 CHESTY Box w/ LED</u>		
	<u>13</u>	<u>BAK Rock</u>		

TOOLS / EQUIP	BQ #	EQUIPMENT DESCRIPTION	REG HRS	O/T HRS	BQ #	EQUIPMENT DESCRIPTION	REG HRS	O/T HRS
		<u>4/18</u>	<u>WALK TRUCK w/AIR COMPRESSOR</u>	<u>4</u>				
	<u>RENT</u>	<u>MEME EX</u>	<u>4</u>					

FOR OFFICE USE	BILLING METHOD	BILLING RATES	APPROVED BY _____	DATE _____
	<input type="checkbox"/> GREENBOOK	<input type="checkbox"/> STANDARD		
	<input type="checkbox"/> CALTRANS	<input type="checkbox"/> OTHER		
	<input type="checkbox"/> BACKCHARGE		REC'D IN ACCTING _____	
	<input type="checkbox"/> OTHER _____			

FIELD MATERIAL AND LABOR PRICE SUMMARY (See Price Sheets for Details)				BELCO PCO NO: 3.1	
DESCRIPTION	MATERIAL \$	LBR. HRS.	EXT \$	DATE: 2/1/2016	
MATERIALS PAGE 2	\$275.00	0.00		<b>DESCRIPTION OF WORK OR CHANGE</b> On 1/14/2016 replace 3 traffic signal pull boxes. Boxes were cracked and broken	
MATERIALS PAGE 3	\$0.00	0.00			
MATERIALS PAGE 4	\$0.00	0.00			
MATERIALS PAGE 5	\$0.00	0.00			
MATERIALS PAGE 6	\$0.00	0.00			
MATERIALS PAGE 7	\$0.00	0.00			
SUBTOTAL	\$275.00	0			
SALES TAX @ 8.00%	\$24.75			<b>COST</b> <b>MARKUP</b> <b>TOTAL</b>	
FREIGHT @ 4%	\$11.00				15%
MISCELLANEOUS HARDWARE @ 6%	\$13.75				
<b>TOTAL MATERIAL COSTS:</b>				<b>\$324.50      \$48.08      \$373.18</b>	
FIELD LABOR BREAKDOWN	HOURS	RATE	EXT \$		
GENERAL FOREMAN - REGULAR RATE	0	\$90.85	\$0.00	<b>COST</b> <b>MARKUP</b> <b>TOTAL</b>	
GENERAL FOREMAN - OT RATE	0	\$128.10	\$0.00		
FOREMAN - REGULAR RATE	4	\$83.75	\$335.00		
FOREMAN - OT RATE	0	\$117.74	\$0.00		
JOURNEYMAN WIREMAN - REG. RATE	0	\$78.95	\$0.00		
JOURNEYMAN WIREMAN - OT RATE	0	\$107.39	\$0.00		
ELEC. APPRENTICE - REGULAR RATE	0	\$67.88	\$0.00		
ELEC. APPRENTICE - OT RATE	0	\$93.85	\$0.00		
LABORER - REGULAR RATE	8	\$64.10	\$512.80		
LABORER - OT RATE	0	\$88.76	\$0.00		
OPERATOR - REGULAR RATE	0	\$83.78	\$0.00		
OPERATOR - OT RATE	0	\$113.82	\$0.00		
<b>TOTAL LABOR COSTS:</b>					<b>\$847.80      \$189.56      \$1,017.36</b>
ENGINEERING COSTS	HOURS	RATE	EXT \$		
PROJECT MANAGER	0	\$90.00	\$0.00	<b>COST</b> <b>MARKUP</b> <b>TOTAL</b>	
DESIGN ENGINEER (COORDINATION)	0	\$75.00	\$0.00		
PROJECT ENGINEER	0	\$60.00	\$0.00		
CAD ENGINEER	0	\$50.00	\$0.00		
PROJECT ASSISTANT	0	\$40.00	\$0.00		
<b>TOTAL INDIRECT COSTS:</b>				<b>\$0.00      \$0.00      \$0.00</b>	
W CODE#	EQUIP. (CAL TRANS RATES 3/15)	HOURS	RATE	EXT \$	
08-12	PICKUP TRUCK/HR.	0	\$27.33	\$0.00	<b>COST</b> <b>MARKUP</b> <b>TOTAL</b>
20-28	UTILITY WORK TRUCK/HR.	8	\$71.82	\$574.56	
016-026	AIR COMPRESSOR ONLY/HR.	8	\$36.14	\$289.12	
20-28	BATCH TRUCK W/MIXER/HR	0	\$40.38	\$0.00	
38-48	CRANE TRUCK/HR.	0	\$99.75	\$0.00	
12-20	BUCKET TRUCK/HR.	0	\$71.69	\$0.00	
3AXL	DUMP TRUCK (3 AXLES)/HR.	0	\$72.07	\$0.00	
20-28	DELIVERY TRUCK (20K-28K)/HR.	0	\$38.04	\$0.00	
12-20	WATER TRUCK (12K-20K)/HR.	0	\$33.48	\$0.00	
	DUMP TRAILER/HR.	0	\$15.00	\$0.00	
TM	ARROWBOARD/HR.	0	\$3.39	\$0.00	
2609J	BACKHOE (JD 410G)/HR.	0	\$88.73	\$0.00	
	BACKHOE TRAILER/HR.	0	\$20.00	\$0.00	
	Mini X Rental 1 day	1	\$425.00	\$425.00	
<b>TOTAL TOOLS/EQUIP. COSTS:</b>				<b>\$1,288.88      \$193.30      \$1,481.98</b>	
SUBCONTRACTS	QTY	UM	EXT \$		
			\$0.00	<b>COST</b> <b>MARKUP</b> <b>TOTAL</b>	
			\$0.00		
			\$0.00		
<b>TOTAL SUBCONTRACT COSTS:</b>				<b>\$0.00      \$0.00      \$0.00</b>	
<b>SUBTOTAL COSTS:</b>				<b>\$2,460.98      \$411.54      \$2,872.52</b>	
	SUBTOTAL	PERCENT	EXT \$		
DESIGN SERVICES	\$0.00	7.75%	\$0.00	\$0.00	
BONDING	\$0.00	1.00%	\$0.00	\$0.00	

GRAND TOTAL OF THIS CHANGE ORDER:

\$2,872.52

**BELCO  
MATERIALS AND OPERATIONS BREAKDOWN**

PROJECT:

PCO NO:

DIRECTIVE NO:

ESTIMATED BY

CHECKED BY

DATE 2/3/2018

MATERIAL OR OPERATION	QTY	PRICE	PER	EXT. PRICE	LABOR UNIT	PER	EXT. LABOR
No. 6 P-box/ lid	2	75.00		150.00			0.00
3/4 " gravel bag	13	5.00		65.00			0.00
No. 5 P-box/ lid	1	60.00		60.00			0.00
		0.00		0.00			0.00
		0.00		0.00			0.00
		0.00		0.00			0.00
		0.00		0.00			0.00
		0.00		0.00			0.00
		0.00		0.00			0.00
		0.00		0.00			0.00
		0.00		0.00			0.00
		0.00		0.00			0.00
		0.00		0.00			0.00
		0.00		0.00			0.00
		0.00		0.00			0.00
		0.00		0.00			0.00
		0.00		0.00			0.00
		0.00		0.00			0.00
		0.00		0.00			0.00
		0.00		0.00			0.00
		0.00		0.00			0.00
		0.00		0.00			0.00
		0.00		0.00			0.00
		0.00		0.00			0.00
		0.00		0.00			0.00
		0.00		0.00			0.00
		0.00		0.00			0.00
		0.00		0.00			0.00
		0.00		0.00			0.00
		0.00		0.00			0.00
		0.00		0.00			0.00
		0.00		0.00			0.00
		0.00		0.00			0.00
		0.00		0.00			0.00
		0.00		0.00			0.00
		0.00		0.00			0.00
		0.00		0.00			0.00
		0.00		0.00			0.00
		0.00		0.00			0.00
		0.00		0.00			0.00
		0.00		0.00			0.00
		0.00		0.00			0.00
		0.00		0.00			0.00
		0.00		0.00			0.00
		0.00		0.00			0.00
		0.00		0.00			0.00
		0.00		0.00			0.00
		0.00		0.00			0.00
<b>TOTALS</b>				<b>275.00</b>			<b>0.00</b>

# Hillcrest Contracting

GENERAL ENGINEERING CONTRACTORS  
License No. 471664A

Riverside, San Bernadino, Orange, Los Angeles & San Diego Counties

1467 Circle City Drive.  
P.O. Box 1898  
Corona, CA 91718-1898  
Telephone (951) 273-9600  
Fax (951) 273-9608

To: CITY OF PALM SPRINGS

Date: 1/4/2016  
From: Glenn Salsbury  
Quote No. 2250

Phone FAX: Email:

We propose to furnish you labor and material in strict accordance with the plans and specifications as follows:

**PRICE TO INSTALL ADDITIONAL 12" WHITE THERMO CROSS  
AND INSTALL BUTTON DETAIL ON LANE LINE**

Item No.	Description	Quantity	U/M	UnitPrice	Total Price
<b>EXTRAS</b>					
x 13	APPLY ADDITIONAL STRIPING	300	LF	5.00	1,500.00
x 14	INSTALL BUTTON DETAIL ON LANE LINE	200	LF	2.20	440.00
<b>Total for EXTRAS</b>					<b>\$1,940.00</b>
<b>Total Proposal Price:</b>					<b>\$1,940.00</b>

### Special Condition

Due to the volatility of current OIL PRICES we reserve the right to adjust contract unit prices as the oil prices affect our material suppliers. Hillcrest has no control over this economic condition and regret that we must pass this potential cost change to our customers.

Submitted by: \_\_\_\_\_ Date: \_\_\_\_\_

Accepted by: \_\_\_\_\_ Date: \_\_\_\_\_

New Item D



Superior Pavement Markings, Inc.  
 PO Box 278  
 Beaumont, CA 92223  
 Phone 951.845.2799  
 Fax 951.845.6399

License# 776306  
 Union Local 1184  
 DIR# 1000001476

**Change Order #1 for Job B1166**

Submit To:		Contact:	Job Site
HILLCREST CONT, INC 1467 CIRCLE CITY DRIVE CORONA, CA 92878			Farrell Drive Right Turn Lane at Vista Chino C P 09-11 Palm Springs, CA TG:
Date:	Project Manager	Job#	
12/30/15	Dale Shulls	1166	

#	Description	Qty	um	Price	Ext Price
1	Apply Additional 12" White Thermoplastic Crosswalk	300	LF	4.50	1,350.00
2	Instal Button Detail on Lane Line	200	LF	2.00	400.00
					<b>\$1,750.00</b>

Description:  
 Field Memo reference: PER BILL'S REQUEST

Terms : Due and payable upon completion.	<i>Superior Pavement Markings,</i> by: _____ <small>Subject to office approval</small>	<b>ADDITIONAL COST /          CREDIT FOR THIS          CHANGE ORDER</b>	<b>\$1,750.00</b>
--	--	---	-------------------

**Acceptance of Change Order:** I/we accept the within change order. You are authorized to perform the work comprehended hereunder and I/we agree to pay the said amount in accordance with the terms set forth. By signing this change order below I/we agree to the attached Terms and Conditions

Date: \_\_\_\_\_ Owner/Customer: \_\_\_\_\_ by: \_\_\_\_\_

PLEASE SIGN AND REMIT COPY TO ABOVE ADDRESS

New Item D

# Hillcrest Contracting

GENERAL ENGINEERING CONTRACTORS  
License No. 471664A

Riverside, San Bernadino, Orange, Los Angeles & San Diego Counties

1467 Circle City Drive  
P.O. Box 1898  
Corona, CA 91718-1898  
Telephone (951) 273-9600  
Fax (951) 273-9608

To: CITY OF PALM SPRINGS

Date: 1/4/2016  
From: Glenn Salsbury  
Quote No. 2250

Phone FAX: Email:

We propose to furnish you labor and material in strict accordance with the plans and specifications as follows:

**PRICE TO INSTALL ADDITIONAL 12" WHITE THERMO CROSS  
AND INSTALL BUTTON DETAIL ON LANE LINE**

Item No.	Description	Quantity	U/M	Unit Price	Total Price
<b>EXTRAS</b>					
x 13	APPLY ADDITIONAL STRIPING	300	LF	5.00	1,500.00
x 14	INSTALL BUTTON DETAIL ON LANE LINE	200	LF	2.20	440.00
Total for EXTRAS					<b>\$1,940.00</b>
Total Proposal Price:					<b>\$1,940.00</b>

### Special Condition

Due to the volatility of current OIL PRICES we reserve the right to adjust contract unit prices as the oil prices affect our material suppliers. Hillcrest has no control over this economic condition and regret that we must pass this potential cost change to our customers.

Submitted by: \_\_\_\_\_ Date: \_\_\_\_\_

Accepted by: \_\_\_\_\_ Date: \_\_\_\_\_

New Item D

# HILLCREST CONTRACTING

General Engineering Contractors

License# 471664A

City of Palm Springs  
Public Works Department  
3200 Tahquitz Canyon Way  
Palm Springs, CA 92263

Date: November 2, 2015  
Subject: Request for Change Order#003  
Job Title: 09-11

Attention: Mike Lytar

Job Number: 2612

We are sending you  herewith the following  under separate cover:

**REQUEST FOR CHANGE ORDER# 003.0 – Changed field condition:**

The City requested Hillcrest Contracting to provide survey for relocation of the water line for Desert Water.

Survey for Desert Water 1 LS \$805.00

**Total \$805.00**

For your:  Perusal  Approval  Files  Quotation

Sincerely,

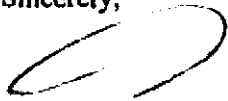

Darcy Searle  
Project Manager/QSP

New Item E

2612- RFC#003.0

# LAND SURVEY AND PLANNING CONSULTANTS

**LSAP Consultants LLC**  
**P.O. Box 1060**  
**Desert Hot Springs**  
**CA 92240**  
**Phone 760-288-2232**  
**Fax 760-671-4761**

**Invoice No. 12056**  
**Bill To** Hillcrest Contracting  
**Address** 1467 Circle City Dr.  
 Corona, CA 92879  
**Phone** (951) 273-9600  
**Fax** (951) 273-9608  
**Email** darcy@hillcrestcontracting.com

**Invoice Date**  
**October 30, 2015**

**INVOICE**

**\$700.00**

**PROPERTY DESCRIPTION:**  
**Vista Chino & Farrell Dr. Palm Springs**

Date	Description	Amount
10/30/2015	Relocation of Water line	\$700.00
	in our letter dated 05-27-15	
	<b>Total Due</b>	<b>\$700.00</b>



10/30/15

30  
488.06  
5 OS WM

32  
488.28  
5 OS BFP

33  
488.28  
5 OS BFP

31  
488.06  
5 OS WM

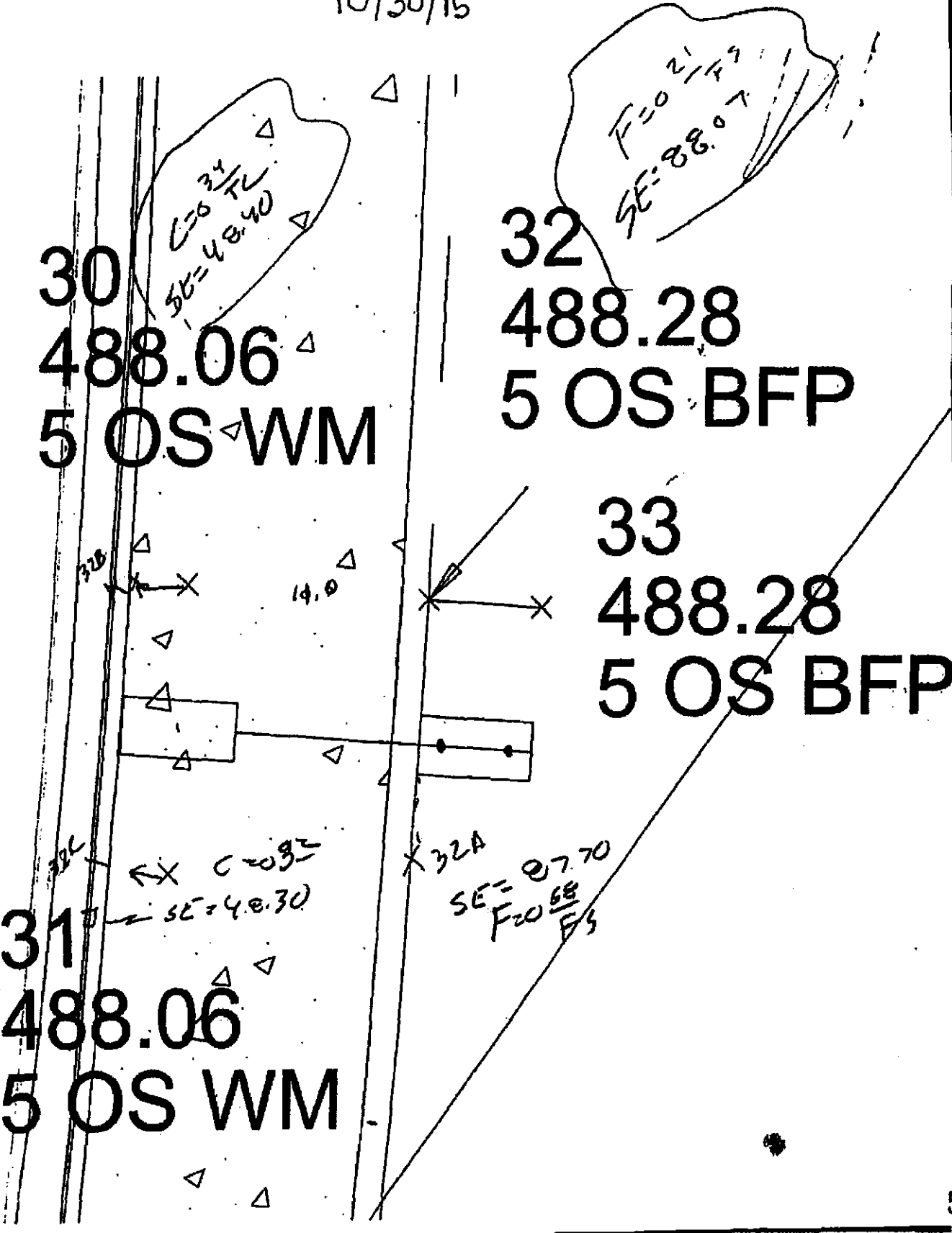

1642  
271.34  
CL WF

1526

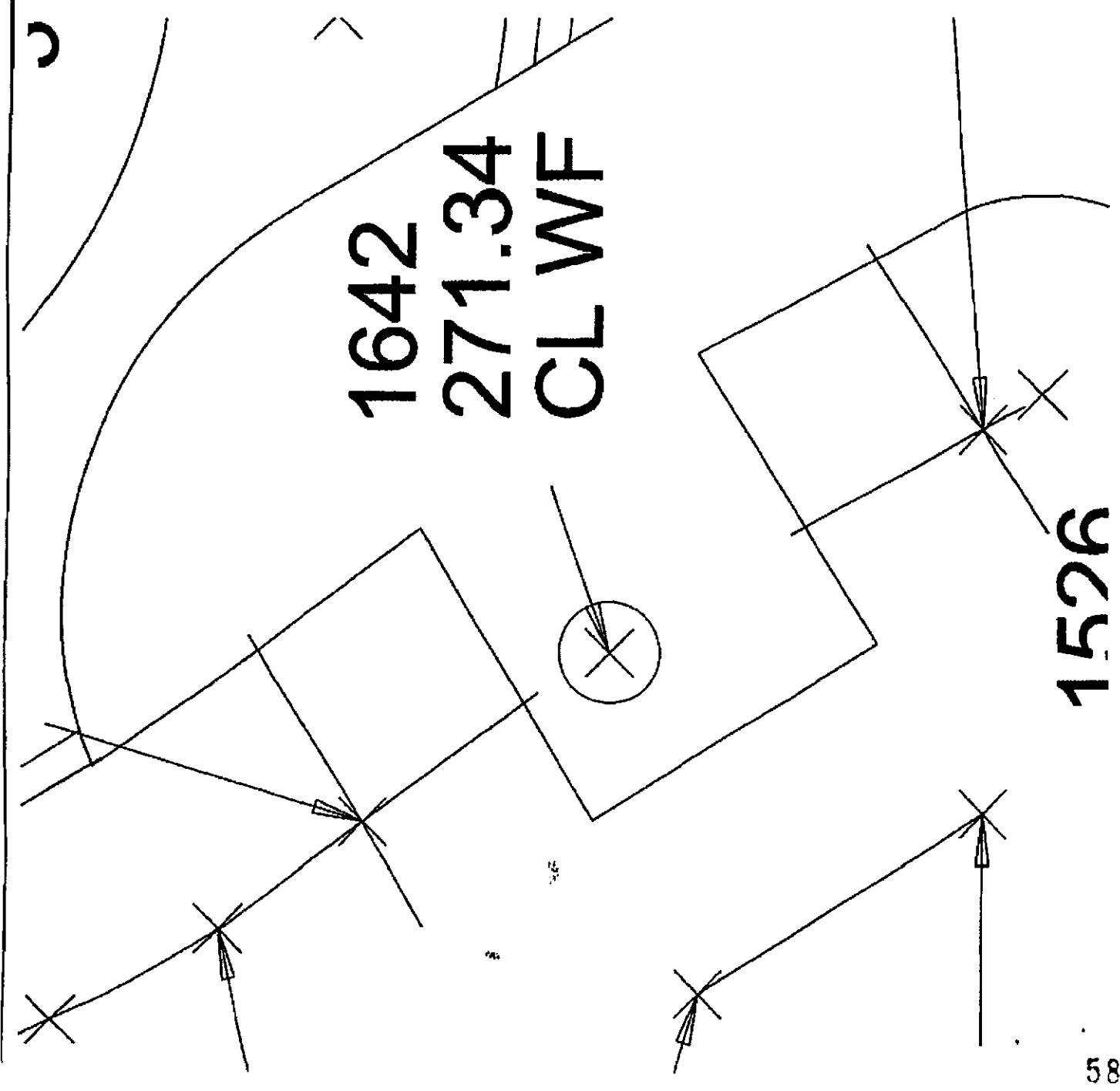

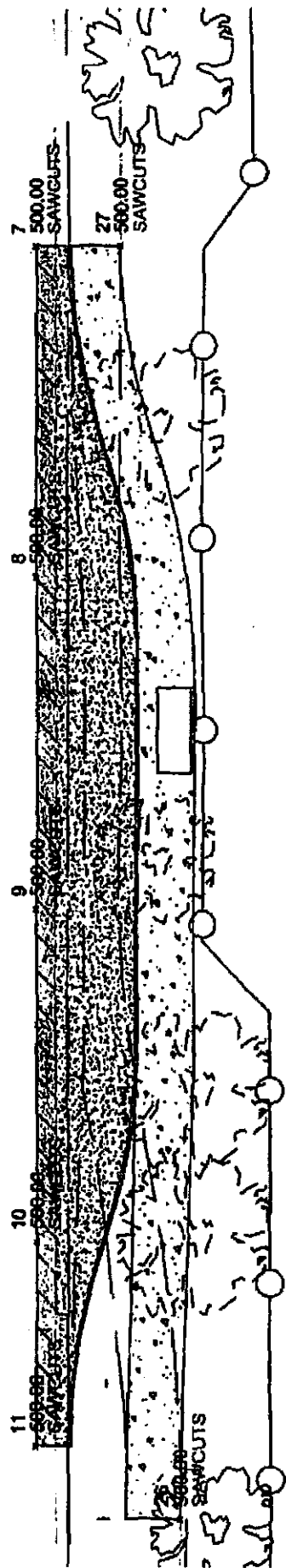

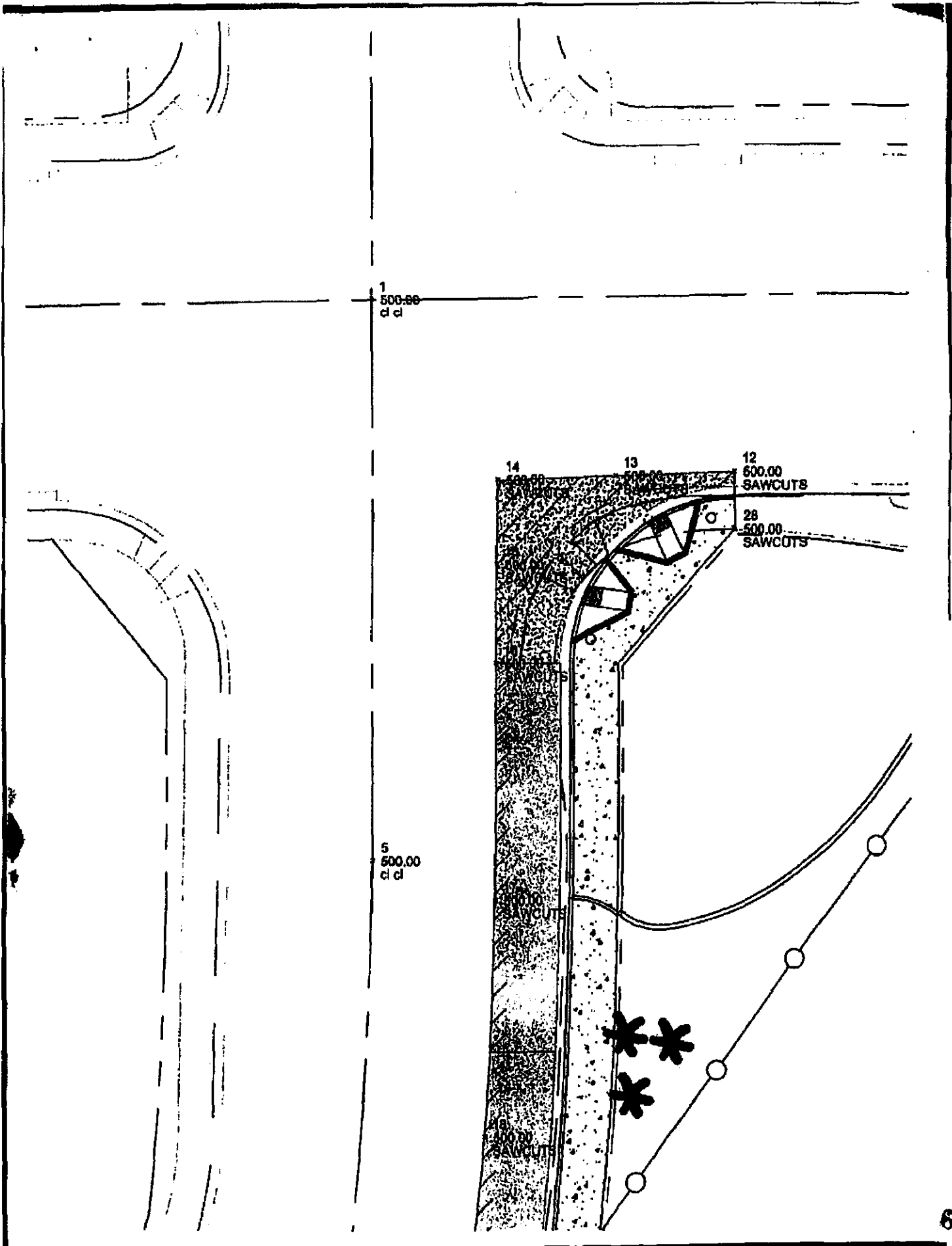

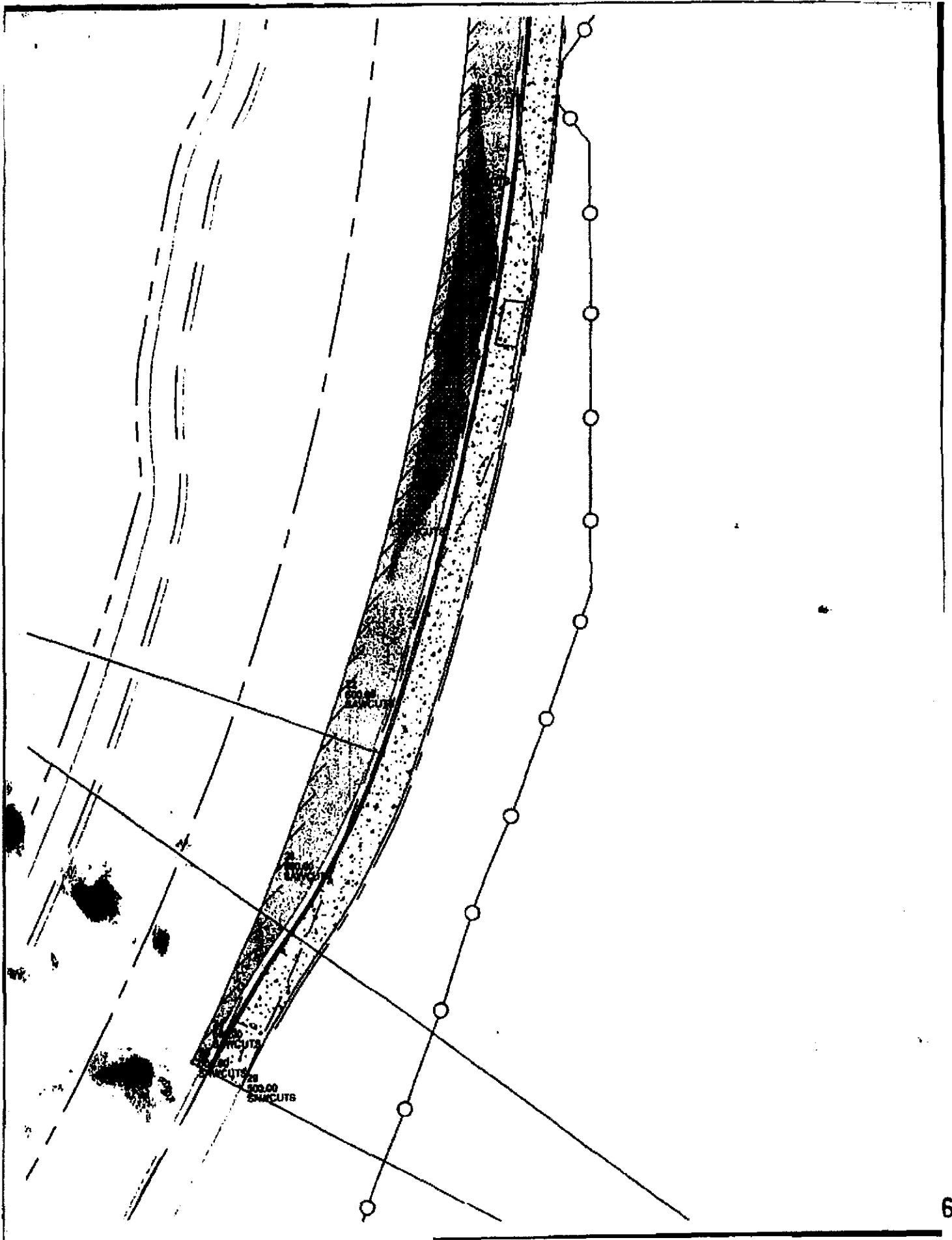

500.00  
500.00  
500.00

SUNGARD PENTAMATION - FUND ACCOUNTING MANAGER  
 DATE: 03/24/16  
 TIME: 16:46:26

CITY OF PALM SPRINGS  
 EXPENDITURE STATUS REPORT

PAGE NUMBER: 3  
 EXPSTAL1

SELECTION CRITERIA: orgn.fund in ('160','133','261') and expledgr.account='60076'  
 ACCOUNTING PERIOD: 9/16

SORTED BY: FUND,FUNCTION,DEPARTMENT,1ST SUBTOTAL,2ND SUBTOTAL,ACCOUNT  
 TOTALED ON: FUND,FUNCTION,DEPARTMENT,1ST SUBTOTAL  
 PAGE BREAKS ON: FUND,FUNCTION,DEPARTMENT

FUND-261 CAPITAL PROJECTS  
 FUNCTION-30 PUBLIC WORKS  
 DEPARTMENT-4491 STREET IMPROVEMENTS  
 1ST SUBTOTAL-5000 CAPITAL

CCO #1 \$ 28,915.85

ACCOUNT	TITLE	BUDGET	PERIOD EXPENDITURES	ENCUMBRANCES OUTSTANDING	YEAR TO DATE EXP	AVAILABLE BALANCE	YTD/ BUD
60076	FARREL/VISTACHINO N/B LA	347,011.97	99,138.82	46,803.98	271,292.14	28,915.85	91.67
	TOTAL CAPITAL	347,011.97	99,138.82	46,803.98	271,292.14	28,915.85	91.67
	TOTAL STREET IMPROVEMENTS	347,011.97	99,138.82	46,803.98	271,292.14	28,915.85	91.67
	TOTAL PUBLIC WORKS	347,011.97	99,138.82	46,803.98	271,292.14	28,915.85	91.67
	TOTAL CAPITAL PROJECTS	347,011.97	99,138.82	46,803.98	271,292.14	28,915.85	91.67
TOTAL REPORT		418,694.73	111,979.54	52,867.93	307,250.84	58,575.96	86.01

SUNGARD PENTAMATION - FUND ACCOUNTING MANAGER  
 DATE: 03/24/16  
 TIME: 16:46:26

CITY OF PALM SPRINGS  
 EXPENDITURE STATUS REPORT

PAGE NUMBER: 2  
 EXPSTALL

SELECTION CRITERIA: orgn.fund in ('160','133','261') and expledgr.account='60076'  
 ACCOUNTING PERIOD: 9/16

SORTED BY: FUND,FUNCTION,DEPARTMENT,1ST SUBTOTAL,2ND SUBTOTAL,ACCOUNT  
 TOTALED ON: FUND,FUNCTION,DEPARTMENT,1ST SUBTOTAL  
 PAGE BREAKS ON: FUND,FUNCTION,DEPARTMENT

CCO # 1 \$ 989.33

FUND-160 SPECIAL PROJECTS  
 FUNCTION-30 PUBLIC WORKS  
 DEPARTMENT-4510 TRAFFIC MITIGATION  
 1ST SUBTOTAL-5000 CAPITAL

ACCOUNT	TITLE	BUDGET	PERIOD EXPENDITURES	ENCUMBRANCES OUTSTANDING	YEAR TO DATE EXP	AVAILABLE BALANCE	YTD/ BUD
60076	FARREL/VISTACHINO N/B LA	989.33	.00	.00	.00	989.33	.00
	TOTAL CAPITAL	989.33	.00	.00	.00	989.33	.00
	TOTAL TRAFFIC MITIGATION	989.33	.00	.00	.00	989.33	.00
	TOTAL PUBLIC WORKS	989.33	.00	.00	.00	989.33	.00
	TOTAL SPECIAL PROJECTS	989.33	.00	.00	.00	989.33	.00

SUNGARD PENTAMATION - FUND ACCOUNTING MANAGER  
 DATE: 03/24/16  
 TIME: 16:46:26

CITY OF PALM SPRINGS  
 EXPENDITURE STATUS REPORT

PAGE NUMBER: 1  
 EXPSTA11

SELECTION CRITERIA: orgn.fund in ('160','133','261') and expledgr.account='60076'  
 ACCOUNTING PERIOD: 9/16

SORTED BY: FUND,FUNCTION,DEPARTMENT,1ST SUBTOTAL,2ND SUBTOTAL,ACCOUNT  
 TOTALED ON: FUND,FUNCTION,DEPARTMENT,1ST SUBTOTAL  
 PAGE BREAKS ON: FUND,FUNCTION,DEPARTMENT

CCO #7 \$ 11,513.02

FUND-133 SPECIAL GAS TAX IMPRVMENT  
 FUNCTION-30 PUBLIC WORKS  
 DEPARTMENT-4298 IMPROVEMENTS 2106 FUND  
 1ST SUBTOTAL-5000 CAPITAL

ACCOUNT	TITLE	BUDGET	PERIOD EXPENDITURES	ENCUMBRANCES OUTSTANDING	YEAR TO DATE EXP	AVAILABLE BALANCE	YTD/BUD
60076	FARREL/VISTACHINO N/B LA	70,693.43	12,840.72	6,063.95	35,958.70	28,670.78	59.44
	TOTAL CAPITAL	70,693.43	12,840.72	6,063.95	35,958.70	28,670.78	59.44
	TOTAL IMPROVEMENTS 2106 FUND	70,693.43	12,840.72	6,063.95	35,958.70	28,670.78	59.44
	TOTAL PUBLIC WORKS	70,693.43	12,840.72	6,063.95	35,958.70	28,670.78	59.44
	TOTAL SPECIAL GAS TAX IMPRVME	70,693.43	12,840.72	6,063.95	35,958.70	28,670.78	59.44



SUNGARD PENTAMATION FUND ACCOUNTING MANAGER  
 DATE: 03/24/16  
 TIME: 16:50:52

CITY OF PALM SPRINGS  
 EXPENDITURE STATUS REPORT

PAGE NUMBER: 1  
 EXPSTALL

SELECTION CRITERIA: orgn.fund='134' and expledgr.account='60076'  
 ACCOUNTING PERIOD: 9/16

SORTED BY: FUND,FUNCTION,DEPARTMENT,1ST SUBTOTAL,2ND SUBTOTAL,ACCOUNT  
 TOTALED ON: FUND,FUNCTION,DEPARTMENT,1ST SUBTOTAL  
 PAGE BREAKS ON: FUND,FUNCTION,DEPARTMENT

CCO #2

FUND-134 MEASURE A IMPROVEMENTS  
 FUNCTION-30 PUBLIC WORKS  
 DEPARTMENT-4498 LOCAL MEASURE A  
 1ST SUBTOTAL-5000 CAPITAL

ACCOUNT	TITLE	BUDGET	PERIOD EXPENDITURES	ENCUMBRANCES OUTSTANDING	YEAR TO DATE EXP	AVAILABLE BALANCE	YTD/ BUD
60076	FARREL/VISTACHINO N/B LA	83,677.50	1,210.00	10.00	33,759.00	49,908.50	40.36
	TOTAL CAPITAL	83,677.50	1,210.00	10.00	33,759.00	49,908.50	40.36
	TOTAL LOCAL MEASURE A	83,677.50	1,210.00	10.00	33,759.00	49,908.50	40.36
	TOTAL PUBLIC WORKS	83,677.50	1,210.00	10.00	33,759.00	49,908.50	40.36
	TOTAL MEASURE A IMPROVEMENTS	83,677.50	1,210.00	10.00	33,759.00	49,908.50	40.36
TOTAL REPORT		83,677.50	1,210.00	10.00	33,759.00	49,908.50	40.36

# **ATTACHMENT 3**



**RECEIVED**  
APR 25 2016  
BY: SL via email

City of Palm Springs

Project: Farrell Dr. Right Turn Lane at Vista Chino

City Project Number: 09-11

Federal Project Number: CML-5282(037)

This letter is to act as the NOC that the project named Farrell Dr. Right Turn Lane at Vista Chino in the City of Palm Springs has been completed and accepted. The project was constructed in accordance with the plans and specifications and the Contractor has met all the requirements of the Contract.

Sincerely,

For Kurt A. Pegg, PE

Resident Engineer

# **ATTACHMENT 4**

**Recording Requested By:**

City of Palm Springs

**When Recorded Mail To:**

Name James Thompson, City Clerk  
Street Address 3200 E. Tahquitz Canyon Way  
City & State Palm Springs, CA 92262

SPACE ABOVE THIS LINE FOR RECORDERS USE

**NOTICE OF COMPLETION**

(CA Civil Code §§ 8180-8190, 8100-8118, 9200-9208)

**NOTICE IS HEREBY GIVEN THAT:**

- The undersigned is an owner of an interest of estate in the hereinafter described real property, the nature of which interest or estate is:  
Fee \_\_\_\_\_ (e.g. fee, leasehold, joint tenancy, etc.)
- The full name and address of the undersigned owner or reputed owner and of all co-owners or reputed co-owners are:  
Name \_\_\_\_\_ Street and No. \_\_\_\_\_ City \_\_\_\_\_ State \_\_\_\_\_  
City of Palm Springs 3200 E. Tahquitz Canyon Way Palm Springs CA
- The name and address of the direct contractor for the work of improvement as a whole is:  
Hillcrest Contracting, Inc. 1467 Circle City Drive, Corona, CA 92879
- This notice is given for (check one):  
 Completion of the work of improvement as a whole.  
 Completion of a contract for a particular portion of the work of improvement (per CA Civ. Code § 8186).
- If this notice is given only of completion of a contract for a particular portion of the work of improvement (as provided in CA Civ. Code § 8186), the name and address of the direct contractor under that contract is:  
Not Applicable.
- The name and address of the construction lender, if any, is:  
Not Applicable.
- On the 10th day of March, 2016, there was completed upon the herein described property a work of improvement as a whole (or a particular portion of the work of improvement as provided in CA Civ. Code § 8186) a general description of the work provided:  
City Project No. 09-11, Farrell Right Turn Lane at Vista Chino (Hwy 111)
- The real property herein referred to is situated in the City of Palm Springs, County of Riverside State of California, and is described as follows:  
Intersection of Vista Chino (Hwy 111) and Farrell Drive
- The street address of said property is:  
Intersection of Farrell Drive and Vista Chino (Hwy 111)
- If this Notice of Completion is signed by the owner's successor in interest, the name and address of the successor's transferor is:  
Not applicable

I certify (or declare) under penalty of perjury under the laws of the State of California that the foregoing is true and correct.

Date: \_\_\_\_\_ By: \_\_\_\_\_

Signature of Owner or Owner's Authorized Agent - Assistant City Manager/City Engineer for City of Palm Springs  
Marcus Fuller

Print Name

**VERIFICATION**

I, Marcus Fuller, state: I am the Assistant City Manager/City Engineer ("Owner", "President", "Authorized Agent", "Partner", etc.) of the Owner identified in the foregoing Notice of Completion. I have read said Notice of Completion and know the contents thereof; the same is true of my own knowledge.

I declare under penalty of perjury under the laws of the State of California that the foregoing is true and correct.

Executed on \_\_\_\_\_, \_\_\_\_\_ (date), at Palm Springs \_\_\_\_\_ (City), CA \_\_\_\_\_ (State).

\_\_\_\_\_  
Signature of Owner or Owner's Authorized Agent

- 
- 
- 

A Notary Public or other officer completing this certificate verifies only the identity of the individual who signed the document to which this certificate is attached, and not the truthfulness, accuracy, or validity of that document.

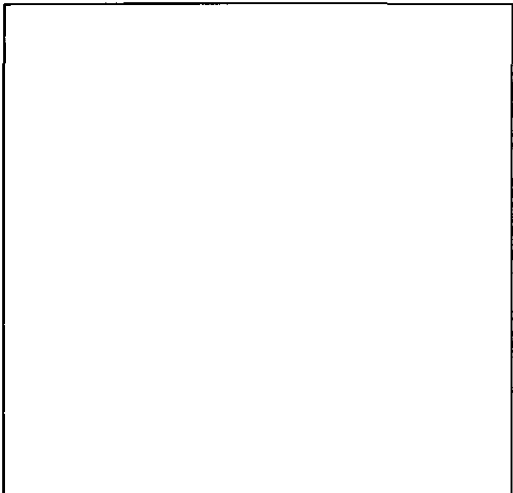

**STATE OF CALIFORNIA**  
**COUNTY OF \_\_\_\_\_**

On \_\_\_\_\_, \_\_\_\_\_ (date), before me, \_\_\_\_\_, Notary Public (name and title of officer) personally appeared \_\_\_\_\_ who proved to me on the basis of satisfactory evidence to be the person(s) whose name(s) is/are subscribed to the within instrument and acknowledged to me that he/she/they executed the same in his/her/their authorized capacity(ies), and that by his/her/their signature(s) on the instrument the person(s), or the entity upon behalf of which the person(s) acted, executed the instrument.

I certify under PENALTY OF PURJURY under the laws of the State of California that the foregoing paragraph is true and correct.

Witness my hand and official seal.

# **ATTACHMENT 5**

Notice of Exemption

2011128225 Form D

To: Office of Planning and Research
P.O. Box 3044, Room 212
Sacramento, CA 95812-3044

From: (Public Agency) City of Palm Springs
3200 East Tahquitz Canyon Way
Palm Springs, CA, 92262

County Clerk
County of Riverside
2724 Gateway Drive
Riverside, CA 92507

(Address)

Project Title: Vista Chino at Farrell Drive Street Improvements

Project Location - Specific:

Southeast corner of the Farrell Drive and Vista Chino (SR 111) intersection

Project Location - City: Palm Springs

Project Location - County: Riverside

Description of Nature, Purpose and Beneficiaries of Project:

The proposed action consists of the demolition of the existing curb, gutter and sidewalk along the easterly side of Farrell Drive in order to create a new dedicated right turn lane onto Vista Chino. The project also includes the relocation of the existing SunLine Transit Agency bus turnout from its present location on the east side of Farrell Drive to the south side of Vista Chino approximately 200 feet east of the intersection. The project also includes the relocation of the traffic signal pole and equipment at the southeast corner and necessary upgrade of the existing traffic signal system.

Name of Public Agency Approving Project: City of Palm springs

Name of Person or Agency Carrying Out Project: Marcus L. Fuller, PE, PLS

Exempt Status: (check one)

- Ministerial (Sec. 21080(b)(1); 15268);
Declared Emergency (Sec. 21080(b)(3); 15269(a));
Emergency Project (Sec. 21080(b)(4); 15269(b)(c));
[X] Categorical Exemption. State type and section number: Existing Facilities, Section 15301(c)
Statutory Exemptions. State code number:

Reasons why project is exempt:

The proposed action is necessary to reduce congestion at the intersection of Vista Chino and Farrell Drive by providing a dedicated right-turn lane from northbound Farrell Drive to east bound Vista Chino. Presently, the northbound Farrell Drive is improved with one dedicated left-turn lane and two through lanes; the right through lane serving a dual role and through lane and right-turn lane. The new dedicated right-turn lane will alleviate the long queue of northbound traffic waiting to proceed through the intersection. The proposed action is made possible by funding through the Congestion Mitigation and Air Quality (CMAQ) federal aid program provided through the Safe, Accountable, Flexible and Efficient Transportation Equity Act - A Legacy for Users. (SAFETEA-LU).

Lead Agency Contact Person: Marcus L. Fuller, PE, PLS Area Code/Telephone/Extension: (760) 323-8253 ext. 8744

If filed by applicant:

- 1. Attach certified document of exemption finding.
2. Has a Notice of Exemption been filed by the public agency approving the project? [X] Yes [ ] No

Signature: Nancy M. Auguston for Date: December 21, 2011 Title: Assistant Public Works Director

- [X] Signed by Lead Agency
[ ] Signed by Applicant
Date received for filing at OPR:

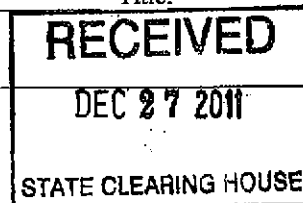

Revised 2005

Marcus L. Fuller



# **ATTACHMENT 6**

**CATEGORICAL EXEMPTION/ CATEGORICAL EXCLUSION DETERMINATION FORM**

**08/RIV/Palm Springs**

**CML 5282 (037)**

Dist.-Co.-Rte. (or Local Agency)

P.M/P.M.

E.A. (State project)

Federal-Aid Project No. (Local project)/ Proj. No.

**PROJECT DESCRIPTION:**

(Briefly describe project, purpose, location, limits, right-of-way requirements, and activities involved.)

*Enter project description in this box. Use Continuation Sheet, if necessary*

The City of Palm Springs proposes to make improvements to the northbound Farrell Drive at the intersection with Vista Chino and eastbound Vista Chino east of the intersection. Improvements include the construction of a new northbound dedicated right turn lane on Farrell Drive. Improvements include relocation of the existing bus stop/turn-out from within the proposed dedicated northbound right-turn lane on Farrell Drive to the south side of Vista Chino immediately east of the intersection. Improvements also include relocation of traffic signal poles and equipment at the southeast corner of the Vista Chino/Farrell Drive intersection, including necessary upgrade of the existing traffic signal system.

**CEQA COMPLIANCE** (for State Projects only)

Based on an examination of this proposal, supporting information, and the following statements (See 14 CCR 15300 et seq.):

- If this project falls within exempt class 3, 4, 5, 6 or 11, it does not impact an environmental resource of hazardous or critical concern where designated, precisely mapped and officially adopted pursuant to law.
- There will not be a significant cumulative effect by this project and successive projects of the same type in the same place, over time.
- There is not a reasonable possibility that the project will have a significant effect on the environment due to unusual circumstances.
- This project does not damage a scenic resource within an officially designated state scenic highway.
- This project is not located on a site included on any list compiled pursuant to Govt. Code § 65962.5 ("Cortese List").
- This project does not cause a substantial adverse change in the significance of a historical resource.

**CALTRANS CEQA DETERMINATION** (Check one)

**Exempt by Statute.** (PRC 21080[b]: 14 CCR 15260 et seq.)

Based on an examination of this proposal, supporting information, and the above statements, the project is:

**Categorically Exempt Class** \_\_\_\_\_. (PRC 21084; 14 CCR 15300 et seq.)

**Categorically Exempt. General Rule exemption.** [This project does not fall within an exempt class, but it can be seen with certainty that there is no possibility that the activity may have a significant effect on the environment (CCR 15061[b][3])

N/A

N/A

Print Name: Environmental Branch Chief

Print Name: Project Manager/DLA Engineer

N/A

N/A

Signature

Date

Signature

Date

**NEPA COMPLIANCE**

In accordance with 23 CFR 771.117, and based on an examination of this proposal and supporting information, the State has determined that this project:

- does not individually or cumulatively have a significant impact on the environment as defined by NEPA and is excluded from the requirements to prepare an Environmental Assessment (EA) or Environmental Impact Statement (EIS), and
- has considered unusual circumstances pursuant to 23 CFR 771.117(b) (<http://www.fhwa.dot.gov/hep/23cfr771.htm> - sec.771.117).

In non-attainment or maintenance areas for Federal air quality standards, the project is either exempt from all conformity requirements, or conformity analysis has been completed pursuant to 42 USC 7506(c) and 40 CFR 93.

**CALTRANS NEPA DETERMINATION** (Check one)

**Section 6004:** The State has been assigned, and hereby certifies that it has carried out, the responsibility to make this determination pursuant to Chapter 3 of Title 23, United States Code, Section 326 and a Memorandum of Understanding (MOU) dated June 7, 2010, executed between the FHWA and the State. The State has determined that the project is a Categorical Exclusion under:

23 CFR 771.117(c): activity (c) (\_\_\_\_)

23 CFR 771.117(d): activity (d)(1)

Activity \_\_\_\_ listed in the MOU between FHWA and the State

**Section 6005:** Based on an examination of this proposal and supporting information, the State has determined that the project is a CE under Section 6005 of 23 U.S.C. 327.

*Chris Benz-Blumberg*  
Print Name: Environmental Branch Chief

*Sean Young for Janet Khumpha*  
Print Name: Project Manager/DLA Engineer

*Chris Benz-Blumberg*  
Signature

*12/19/11*  
Date

*[Signature]*  
Signature

*12/19/2011*  
Date

Briefly list environmental commitments on continuation sheet. Reference additional information, as appropriate (e.g., air quality studies, documentation of conformity exemption, FHWA conformity determination if Section 6005 project; §106 commitments; §4(f); §7 results; Wetlands Finding; Floodplain Finding; additional studies; and design conditions). **Revised June 7, 2010**

**CATEGORICAL EXEMPTION/CATEGORICAL EXCLUSION DETERMINATION FORM**  
**Continuation Sheet**

08/RIV/Palm Springs

CML 5282 (037)

Dist.-Co.-Rte. (or Local Agency)

P.M/P.M.

E.A. (State project)

Federal-Aid Project No. (Local project)/ Proj. No.

Continued from page 1:

**Project Description:**

The City of Palm Springs proposes to make improvements to the northbound Farrell Drive at the intersection with Vista Chino and eastbound Vista Chino east of the intersection. Improvements include the construction of a new northbound dedicated right turn lane on Farrell Drive. Improvements include relocation of the existing bus stop/turn-out from within the proposed dedicated northbound right-turn lane on Farrell Drive to the south side of Vista Chino immediately east of the intersection. Improvements also include relocation of traffic signal poles and equipment at the southeast corner of the Vista Chino/Farrell Drive intersection, including necessary upgrade of the existing traffic signal system.

**Cultural:**

If human remains are discovered, State Health and Safety Code Section 7050.5 states that further disturbances shall cease in any area or nearby area suspected to overlie remains, and the County Coroner contacted. Pursuant to Public Resources code Section 5097.98, if the remains are thought to be native American, the coroner will notify the Most Likely Descendant (MLD). At this time, the person who discovered the remains will contact the Department District 8 Environmental Branch Chief, or his/her designee, so that they may work with the MLD on the respectful treatment and disposition of the remains. Further provisions of PRC 5097.98 are to be followed as applicable.

**Permits:**

NPDES Permit