



COMMUNITY REDEVELOPMENT AGENCY
STAFF REPORT

DATE: February 4, 2009 CONSENT CALENDAR

SUBJECT: APPROVAL OF PLANS, SPECIFICATIONS AND ESTIMATE (PS&E)
AND AUTHORIZATION TO BID THE SOUTH PALM CANYON DRIVE
WIDENING PROJECT, CITY PROJECT NO. 05-03

FROM: David Barakian, Director of Public Works/City Engineer

BY: Public Works and Engineering Department

SUMMARY

The City of Palm Springs proposes the widening of South Palm Canyon Drive from two (2) to four (4) lanes between Murray Canyon Drive and Bogert Trail, including a widened bridge structure and associated improvements within Cherly Creek (Arenas Canyon North drainage channel). The construction documents (Plans, Specifications and Estimate) are completed and, in accordance with 7.03.040 of the Procurement and Contracting Code the Agency is required to approve and adopt plans, specifications and working details, and authorize the bid request for all public projects in excess of \$100,000. Approval of this project will allow staff to proceed with this public project, with a final engineer's estimated cost of \$700,000.

RECOMMENDATION:

- 1) Adopt Resolution No. _____, "A RESOLUTION OF THE COMMUNITY REDEVELOPMENT AGENCY OF THE CITY OF PALM SPRINGS APPROVING THE PLANS, SPECIFICATIONS AND ESTIMATE (PS&E) AND AUTHORIZING BIDDING OF THE SOUTH PALM CANYON DRIVE WIDENING PROJECT, CITY PROJECT NO. 05-03."

STAFF ANALYSIS:

On February 18, 2003, the Engineering Department submitted a grant application for Highway Bridge Replacement and Rehabilitation (HBRR) funding to the California Department of Transportation (Caltrans) for construction of a new 4-lane bridge crossing of the existing low-water crossing of the Arenas Canyon South Drainage channel at South Palm Canyon Drive near Bogert Trail. Upon review, Caltrans

Item RA4.

determined the City's application was eligible for federal funding through the HBRR Program, provided that the City demonstrated that it was moving forward with funding and construction of the widening of South Palm Canyon Drive to four lanes.

Subsequently, on April 21, 2004, the Financing Authority, Community Redevelopment Agency and City Council, approved actions associated with the refinance of City of Palm Springs Financing Authority 1994 Series A & B Local Agency Revenue bonds. The City's actions associated with the refinancing of bonds generated \$5,000,000 for new projects, of which \$1,000,000 was identified for the widening of South Palm Canyon Drive to facilitate the City's HBRR grant application for a new bridge.

On April 5, 2006, the Community Redevelopment Agency awarded a Contract Services Agreement to Rick Engineering Company to provide the Agency with the environmental and civil engineering design services necessary to complete the construction documents (plans, specifications, and estimate) for this project. On September 19, 2007, the City Council adopted a Mitigated Negative Declaration for this project, in accordance with California Environmental Quality Act (CEQA).

The proposed project will widen South Palm Canyon Drive from two (2) to four (4) lanes between Murray Canyon Drive and Bogert Trail, including a widened bridge structure and associated improvements within Cherly Creek (Arenas Canyon North drainage channel). An exhibit showing the proposed improvements is included as Attachment 1.

Final plans have been prepared by the consultant, and environmental permits have been obtained for construction of the project. Section 7.03.040 of the Procurement and Contracting Code requires that for public projects in excess of \$100,000 Council approve and adopt the plans, specifications and working details, and authorize staff to advertise for construction bids. The Engineer's Estimate for this project is \$700,000. Approval of the recommended action will allow staff to proceed with bidding of this project.

FISCAL IMPACT:

Funding for this project is available through Community Redevelopment Agency funds, in account 812-8192-65171.

SUBMITTED:



DAVID J. BARAKIAN
Director of Public Works/City Engineer



THOMAS J. WILSON
Assistant City Manager

Attachments:

1. Plan Exhibits
2. Resolution

ATTACHMENT 1

PLAN EXHIBITS

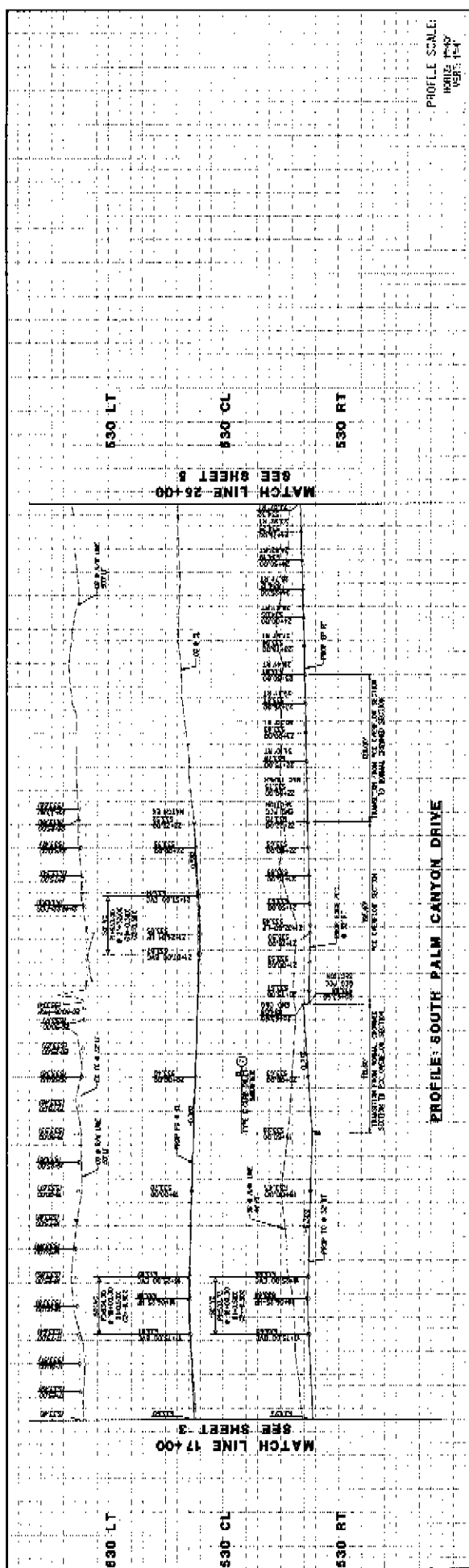

PROFILE SCALE:
 HORIZONTAL: 1" = 100'
 VERTICAL: 1" = 10'

CONSTRUCTION NOTES:

1. EXISTING CURBS AND UTILITY POLES PER CITY OF PALM SPRINGS 175 000 175 00
2. EXISTING CONCRETE SIDEWALK PER CITY OF PALM SPRINGS 175 000 175 00
3. EXISTING ASPHALT DRIVEWAY PER CITY OF PALM SPRINGS 175 000 175 00
4. EXISTING ASPHALT DRIVEWAY PER CITY OF PALM SPRINGS 175 000 175 00
5. EXISTING ASPHALT DRIVEWAY PER CITY OF PALM SPRINGS 175 000 175 00
6. EXISTING ASPHALT DRIVEWAY PER CITY OF PALM SPRINGS 175 000 175 00
7. EXISTING ASPHALT DRIVEWAY PER CITY OF PALM SPRINGS 175 000 175 00
8. EXISTING ASPHALT DRIVEWAY PER CITY OF PALM SPRINGS 175 000 175 00
9. EXISTING ASPHALT DRIVEWAY PER CITY OF PALM SPRINGS 175 000 175 00
10. EXISTING ASPHALT DRIVEWAY PER CITY OF PALM SPRINGS 175 000 175 00
11. EXISTING ASPHALT DRIVEWAY PER CITY OF PALM SPRINGS 175 000 175 00
12. EXISTING ASPHALT DRIVEWAY PER CITY OF PALM SPRINGS 175 000 175 00
13. EXISTING ASPHALT DRIVEWAY PER CITY OF PALM SPRINGS 175 000 175 00
14. EXISTING ASPHALT DRIVEWAY PER CITY OF PALM SPRINGS 175 000 175 00
15. EXISTING ASPHALT DRIVEWAY PER CITY OF PALM SPRINGS 175 000 175 00
16. EXISTING ASPHALT DRIVEWAY PER CITY OF PALM SPRINGS 175 000 175 00
17. EXISTING ASPHALT DRIVEWAY PER CITY OF PALM SPRINGS 175 000 175 00
18. EXISTING ASPHALT DRIVEWAY PER CITY OF PALM SPRINGS 175 000 175 00
19. EXISTING ASPHALT DRIVEWAY PER CITY OF PALM SPRINGS 175 000 175 00
20. EXISTING ASPHALT DRIVEWAY PER CITY OF PALM SPRINGS 175 000 175 00
21. EXISTING ASPHALT DRIVEWAY PER CITY OF PALM SPRINGS 175 000 175 00
22. EXISTING ASPHALT DRIVEWAY PER CITY OF PALM SPRINGS 175 000 175 00
23. EXISTING ASPHALT DRIVEWAY PER CITY OF PALM SPRINGS 175 000 175 00
24. EXISTING ASPHALT DRIVEWAY PER CITY OF PALM SPRINGS 175 000 175 00
25. EXISTING ASPHALT DRIVEWAY PER CITY OF PALM SPRINGS 175 000 175 00
26. EXISTING ASPHALT DRIVEWAY PER CITY OF PALM SPRINGS 175 000 175 00
27. EXISTING ASPHALT DRIVEWAY PER CITY OF PALM SPRINGS 175 000 175 00
28. EXISTING ASPHALT DRIVEWAY PER CITY OF PALM SPRINGS 175 000 175 00
29. EXISTING ASPHALT DRIVEWAY PER CITY OF PALM SPRINGS 175 000 175 00
30. EXISTING ASPHALT DRIVEWAY PER CITY OF PALM SPRINGS 175 000 175 00

NO.	DATE	BY	DESCRIPTION
1	11/21/14	LS	ISSUED FOR PERMITS
2	11/21/14	LS	ISSUED FOR PERMITS
3	11/21/14	LS	ISSUED FOR PERMITS

NO.	DATE	BY	DESCRIPTION
1	11/21/14	LS	ISSUED FOR PERMITS
2	11/21/14	LS	ISSUED FOR PERMITS
3	11/21/14	LS	ISSUED FOR PERMITS

NO.	DATE	BY	DESCRIPTION
1	11/21/14	LS	ISSUED FOR PERMITS
2	11/21/14	LS	ISSUED FOR PERMITS
3	11/21/14	LS	ISSUED FOR PERMITS

NO.	DATE	BY	DESCRIPTION
1	11/21/14	LS	ISSUED FOR PERMITS
2	11/21/14	LS	ISSUED FOR PERMITS
3	11/21/14	LS	ISSUED FOR PERMITS

NO.	DATE	BY	DESCRIPTION
1	11/21/14	LS	ISSUED FOR PERMITS
2	11/21/14	LS	ISSUED FOR PERMITS
3	11/21/14	LS	ISSUED FOR PERMITS

NO.	DATE	BY	DESCRIPTION
1	11/21/14	LS	ISSUED FOR PERMITS
2	11/21/14	LS	ISSUED FOR PERMITS
3	11/21/14	LS	ISSUED FOR PERMITS

NO.	DATE	BY	DESCRIPTION
1	11/21/14	LS	ISSUED FOR PERMITS
2	11/21/14	LS	ISSUED FOR PERMITS
3	11/21/14	LS	ISSUED FOR PERMITS

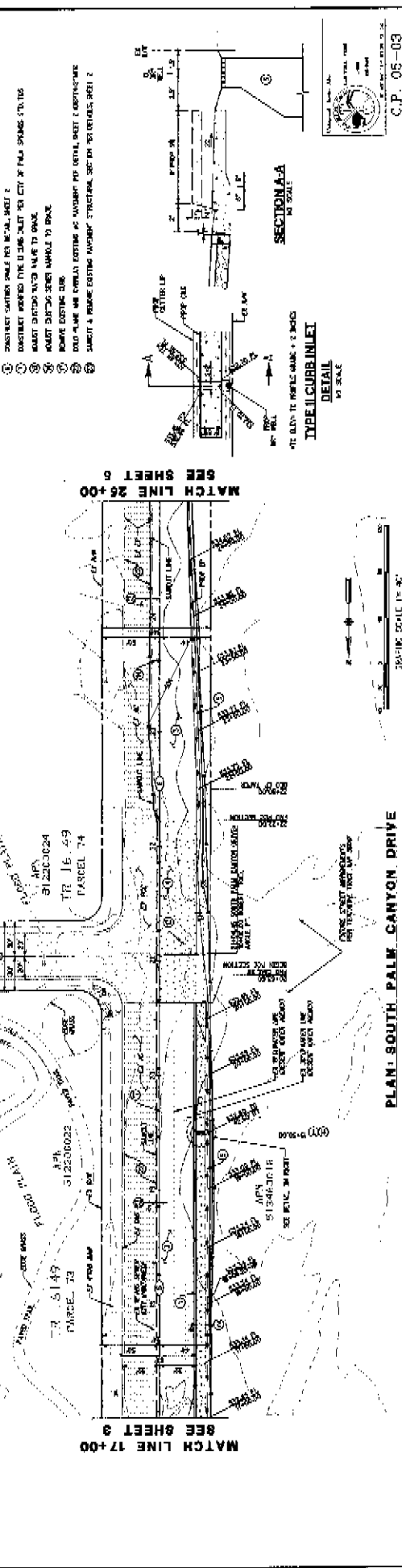

PLAN: SOUTH PALM CANYON DRIVE

SECTION A-A
 1/4" SCALE

TYPE LUBRICANT INLET
 1/4" SCALE

PROFILE SCALE: 1" = 40'

CITY OF PALM SPRINGS, CALIFORNIA
SOUTH PALM CANYON DRIVE
PLAN AND PROFILE

PROJECT NO.: C.P. 05-03
SHEET NO.: 4
OF 19 SHEETS

DATE: 11/21/14
BY: LS
CHECKED BY: [Signature]

APPROVED BY: [Signature]

SCALE: 1" = 40'

PROJECT LOCATION: SOUTH PALM CANYON DRIVE, PALM SPRINGS, CALIFORNIA

PROJECT DESCRIPTION: IMPROVEMENTS TO SOUTH PALM CANYON DRIVE

DESIGNER: RICK ENGINEERING, INC.

DATE: 11/21/14

PROJECT NO.: C.P. 05-03

SHEET NO.: 4

OF 19 SHEETS

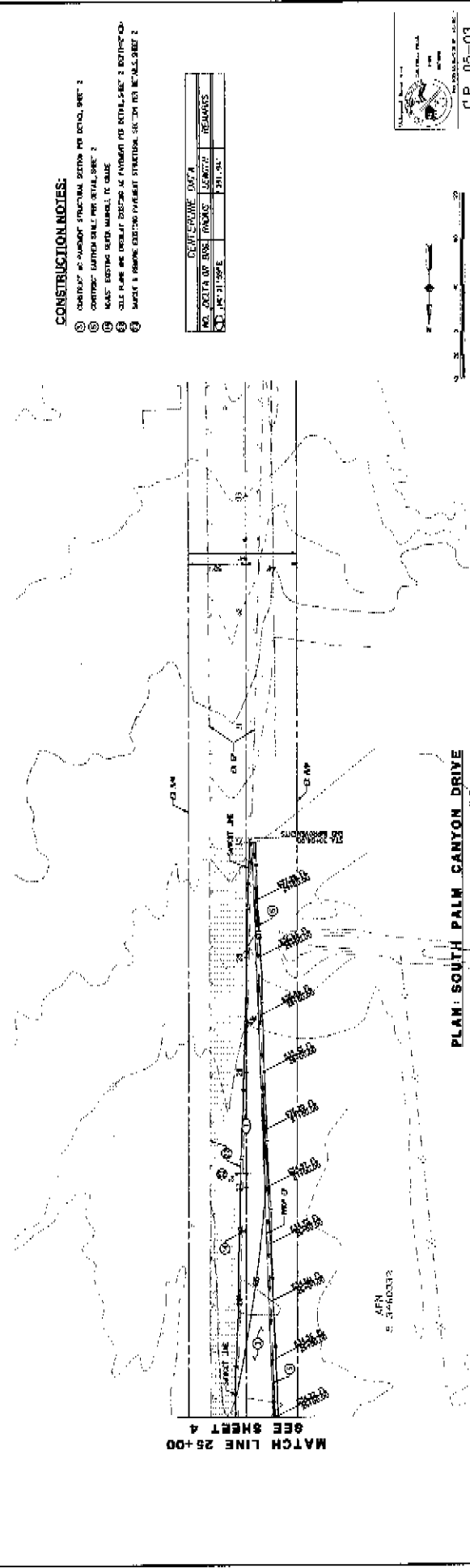
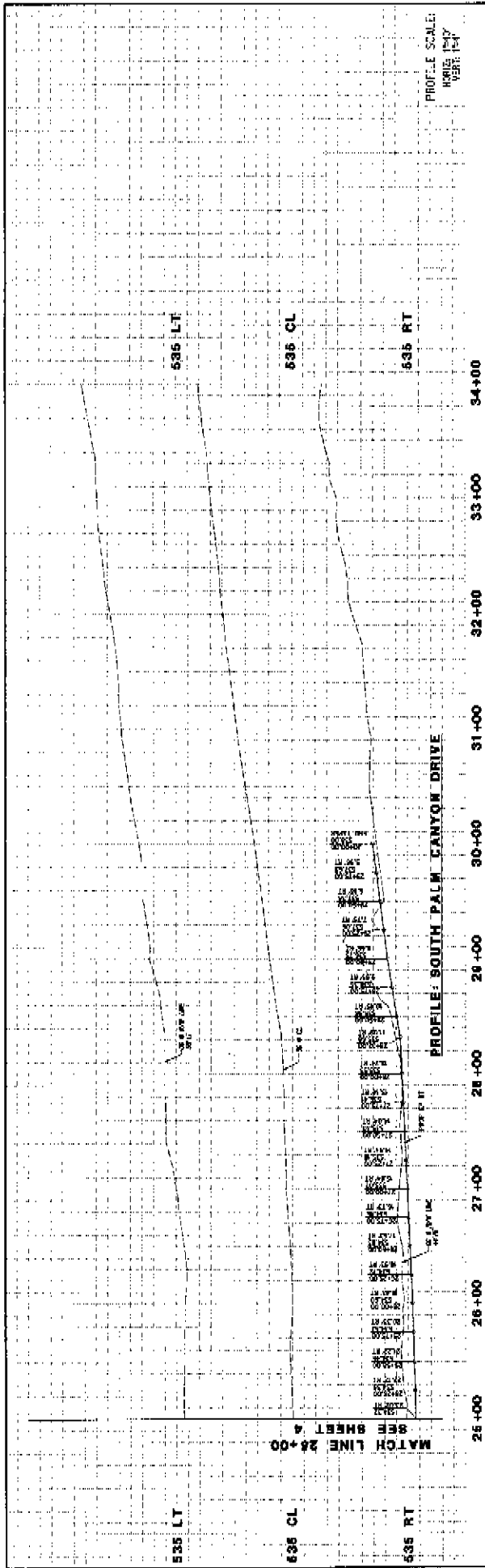

- CONSTRUCTION NOTES:**
1. CHECK FOR ANY OTHER STRUCTURAL DETAILS FOR THIS SHEET.
 2. CHECK FOR ANY OTHER DETAILS FOR THIS SHEET.
 3. CHECK FOR ANY OTHER DETAILS FOR THIS SHEET.
 4. CHECK FOR ANY OTHER DETAILS FOR THIS SHEET.
 5. CHECK FOR ANY OTHER DETAILS FOR THIS SHEET.

NO.	DATE	BY	REVISIONS
1	10/21/2009	SM	ISSUE FOR PERMITS
2			
3			
4			
5			

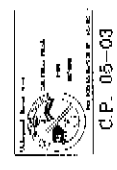

CITY OF PALM SPRINGS, CALIFORNIA		SHEET NO. 5	
SOUTH PALM CANYON DRIVE		SHEET TOTAL 18	
PLAN AND PROFILE		DATE: 10/21/2009	
PROJECT NO. 05-03		DRAWN BY: SM	
CHECKED BY: SM		APPROVED BY: SM	
DESIGNED BY: SM		SCALE: 1" = 40'	
DATE: 10/21/2009		PROJECT: 05-03	
DRAWN: SM		CHECKED: SM	
DESIGNED: SM		APPROVED: SM	
PROJECT: 05-03		SHEET: 5	
DATE: 10/21/2009		SCALE: 1" = 40'	



543 ft

CityGIS

Copyright © 2006 All Rights Reserved. The Information contained herein is the proprietary property of the contributor supplied under license and may not be approved except as licensed by Digital Map Products.

ATTACHMENT 2

RESOLUTION

RESOLUTION NO. _____

A RESOLUTION OF THE COMMUNITY REDEVELOPMENT AGENCY OF THE CITY OF PALM SPRINGS APPROVING THE PLANS, SPECIFICATIONS AND ESTIMATE (PS&E) AND AUTHORIZING BIDDING OF THE SOUTH PALM CANYON DRIVE WIDENING PROJECT, CITY PROJECT NO. 05-03

WHEREAS, the Community Redevelopment Agency of the City of Palm Springs, California, ("Agency"), is constituted under the Community Redevelopment Law (California Health and Safety Code Section 33000 (et. seq.)) to carry out the purpose of redevelopment in the City of Palm Springs, ("City"); and

WHEREAS, pursuant to Section 33447 of the Community Redevelopment Law, the Agency may finance the construction of public improvements that will enhance the environment of residential neighborhoods containing housing for persons and families of low or moderate income, including very low income households; and that will be of benefit to the project area; and

WHEREAS, pursuant to Section 33447 of the Community Redevelopment Law, public improvements eligible for financing including street improvements; and

WHEREAS, on April 21, 2004, the City of Palm Springs Financing Authority, the Agency, and City Council of the City, approved certain actions associated with Merged Project No. 1 and Merged Project No. 2 Tax Allocation Bonds, establishing tax increment revenue specifically allocated to the construction of the South Palm Canyon Drive Widening.

THE COMMUNITY REDEVELOPMENT AGENCY OF THE CITY OF PALM SPRINGS, CALIFORNIA, DOES HEREBY RESOLVE AS FOLLOWS:

The construction documents (Plans, Specifications and Estimate [PS&E]) for the widening of South Palm Canyon Drive from two (2) to four (4) lanes between Murray Canyon Drive and Bogert Trail, including a widened bridge structure and associated improvements within Cherly Creek (Arenas Canyon North drainage channel), City Project No. 05-03, are hereby approved, and construction bidding of City Project No. 05-03 is hereby authorized.

ADOPTED this 4th day of February, 2009.

Steven Pougnet, Chairman

ATTEST:

James Thompson, Assistant Secretary

CERTIFICATION

STATE OF CALIFORNIA)
COUNTY OF RIVERSIDE) ss.
CITY OF PALM SPRINGS)

I, JAMES THOMPSON, Assistant Secretary of the Community Redevelopment Agency of the City of Palm Springs, hereby certify that Resolution No. _____ is a full, true and correct copy, and was duly adopted at a regular meeting of the Community Redevelopment Agency of the City of Palm Springs on February 4, 2009, by the following vote:

AYES:
NOES:
ABSENT:
ABSTAIN:

James Thompson, Assistant Secretary
Community Redevelopment Agency of
the City of Palm Springs, California