



HERMANN DESIGN GROUP
 77-899 WOLF RD.
 SUITE 102
 PALM DESERT, CA
 92211
 LIC# 2754 EXP. 4/30/16
 PH. (760) 777-9131
 FAX (760) 777-9132

OWNER
**RICHARD COOK +
 STEVIN HENDERSON**
 360 W. CABRILLO ROAD
 PALM SPRINGS, CA 92262

PROJECT
RACQUET CLUB GARDEN VILLAS
 360 W. CABRILLO ROAD
 PALM SPRINGS, CA 92262

REVISIONS	DATE	BY

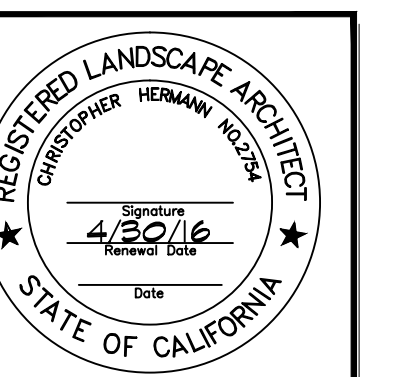

SHEET TITLE
SITE PLAN

DESIGNED BR/CH
 DRAWN BR
 CHECKED -
 DATE 11/14/14
 SCALE 1"=20'-0"
 JOB NO.

SHEET
L1.0
 OF 2 SHEETS

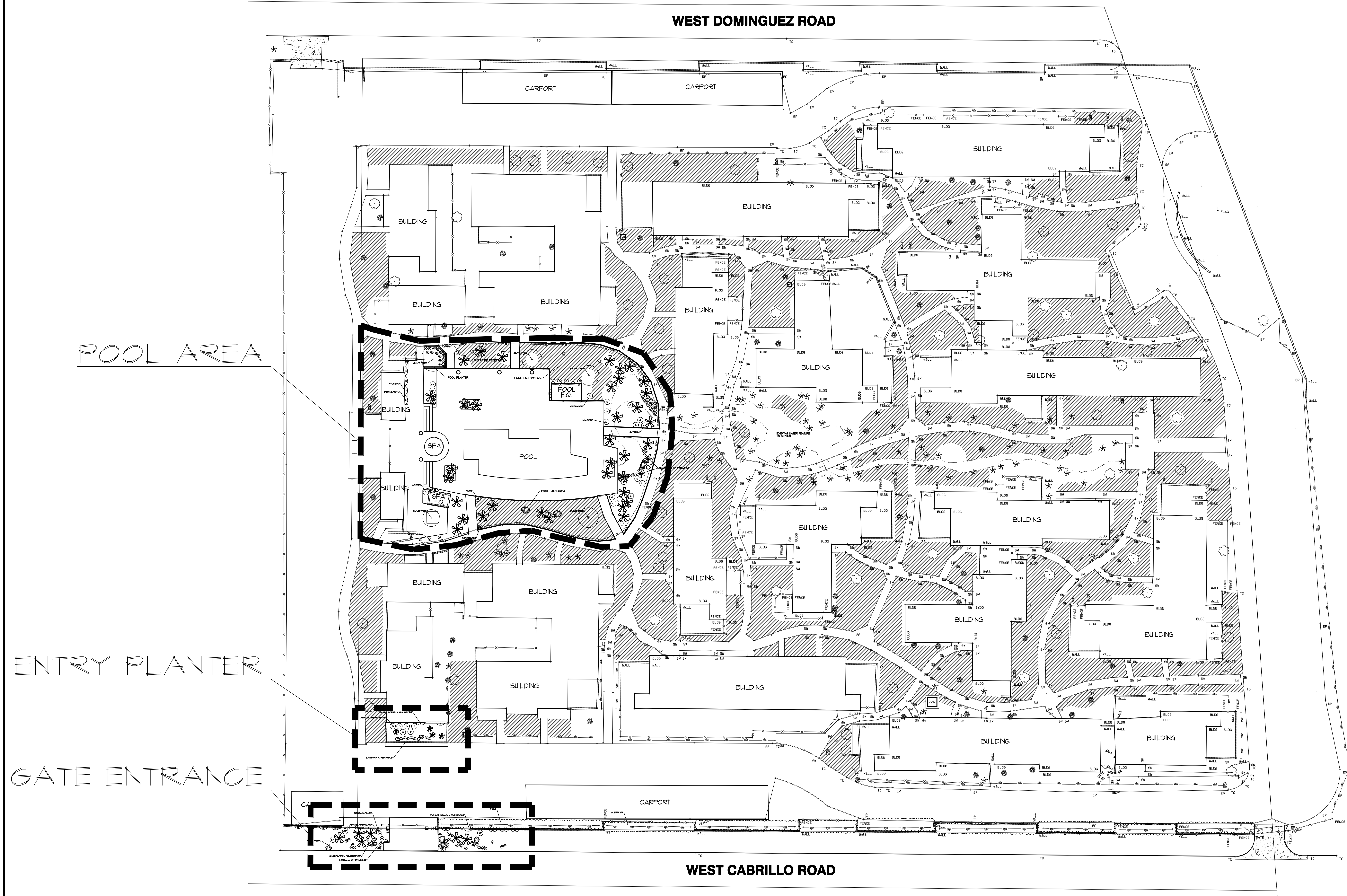

POOL AREA

ENTRY PLANTER

GATE ENTRANCE

WEST DOMINGUEZ ROAD

WEST CABRILLO ROAD

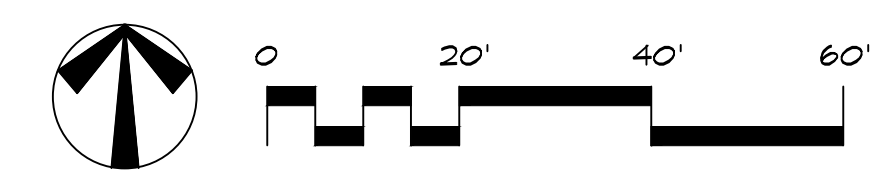



PLANT LEGEND

SYMBOL	QTY.	BOTANICAL NAME COMMON NAME	SIZE	SPACING	REMARKS
SHRUBS					
		HESPERALOE PARVIFLORA "BRAKE LIGHTS"	5 GAL.	AS SHOWN	FULL 4 BUSHY
		AGAVE AMERICANA CENTURY PLANT	15 GAL.	AS SHOWN	FULL 4 BUSHY
		ALOE X 'HERCULES' HERCULES ALOE	15 GAL.	AS SHOWN	FULL 4 BUSHY
		CAESALPINIA PULCHERRIMA RED MEXICAN BIRD OF PARADISE	15 GAL.	AS SHOWN	FULL 4 BUSHY
		EVOLVULUS GLOMERATUS "HAWAIIAN BLUE EYES"	5 GAL.	AS SHOWN	FULL 4 BUSHY
		AGAVE GEMINIFLORA TWIN FLOWERED AGAVE	5 GAL.	AS SHOWN	FULL 4 BUSHY
		ALOE VERA MEDICINAL ALOE	5 GAL.	AS SHOWN	FULL 4 BUSHY
		RUSSELLIA EQUISETIFORMIS FIRECRACKER PLANT	5 GAL.	AS SHOWN	FULL 4 BUSHY
		DASYLIRION WHEELERI DESERT SPOON	5 GAL.	AS SHOWN	FULL 4 BUSHY
		FESTUCA GLAUCA BLUE FESCUE	5 GAL.	AS SHOWN	FULL 4 BUSHY
		FICUS MICROCARPA NITIDA 'COLUMNAR' INDIAN LAUREL FIG	15 GAL.	2' O.C.	HEDGE
		FOUQUIERIA SPLENDENS OCOTILLO	7 CANE MIN.	AS SHOWN	ALL CANES MIN. 6' HIGH
		AGAVE DESMETTIANA SMOOTH AGAVE	5 GAL.	AS SHOWN	BOLD GREEN TEXTURE
		PEDILANTHUS MACROCARPUS LADY SLIPPER	5 GAL.	AS SHOWN	FULL 4 BUSHY
		AGAVE PARRYI PARRY'S AGAVE	5 GAL.	AS SHOWN	FULL 4 BUSHY
		CARISSA "GREEN CARPET" TRAILING NATAL PLUM	5 GAL.	AS SHOWN	FULL 4 BUSHY
		AGAVE VILMORINIANA OCTOPUS AGAVE	5 GAL.	AS SHOWN	FULL 4 BUSHY
VINES/GROUNDCOVERS					
		DURANTA REPENS SKYFLOWER	5 GAL.	AS SHOWN	STAKED
		LANTANA X 'NEW GOLD' NEW GOLD LANTANA	5 GAL.	AS SHOWN	FULL 4 BUSHY
		BERMUDA GRASS BULLSEYE SHADE TOLERANT			BY: WEST COAST TURF
INSTALL 2" THICK LAYER OF DECOMPOSED GRANITE IN PLANTER AREAS ALONG THE SIDE YARDS ONLY. COLOR TO BE SELECTED.					
ROCK WORK					
		DECOMPOSED GRANITE 3/8" COLOR T.B.S.			
		RIVER ROCK COBBLE COLOR T.B.S.			

HG
HERMANN DESIGN GROUP
77-899 WOLF RD.
SUITE 102
PALM DESERT, CA
92211
LIC# 2754 EXP. 4/30/16
PH. (760) 777-9131
FAX (760) 777-9132

OWNER
**RICHARD COOK +
STEVEN HENDERSON**
360 W. CABRILLO ROAD
PALM SPRINGS, CA 92262

PROJECT
RACQUET CLUB GARDEN VILLAS
360 W. CABRILLO ROAD
PALM SPRINGS, CA 92262

REVISIONS	DATE	BY

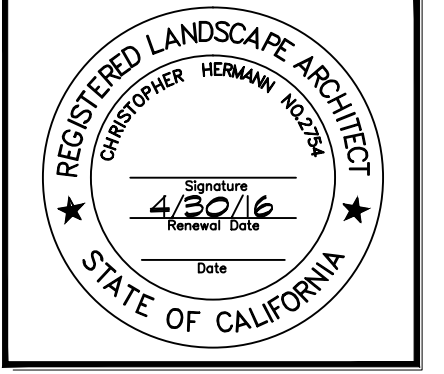

SHEET TITLE	
PLANTING PLAN	
DESIGNED	BR/CH
DRAWN	BR
CHECKED	-
DATE	11/14/14
SCALE	1"=10'-0"
JOB NO.	

SHEET
L2.0
OF 8 SHEETS

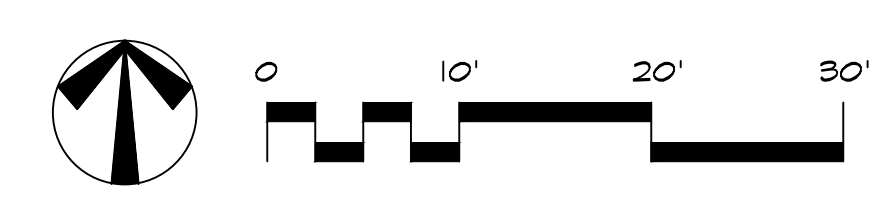



A: CABRILLO ENTRANCE
Racquet Club Garden Villas





A: CABRILLO ENTRANCE
Racquet Club Garden Villas



Racquet Club Garden Villas



B: ENTRY PLANTER
Racquet Club Garden Villas



Racquet Club Garden Villas



B: ENTRY PLANTER
Racquet Club Garden Villas





Garden Villas at the Racquet Club
POOL RULES

1. SWIMMING & HOT TUB RULES ARE FROM 8:00 AM TO 6:00 PM.
2. SWIMMING POOL & HOT TUB ARE FOR THE USE OF GUESTS ONLY.
3. ALL GUESTS MUST BE ACCOMPANIED BY A RESIDENT ADULT AT ALL TIMES.
4. CHILDREN UNDER 12 MUST BE ACCOMPANIED BY AN ADULT AT ALL TIMES.
5. CHILDREN UNDER 12 MUST WEAR DIAPERS AT ALL TIMES.
6. CHILDREN UNDER 12 MUST WEAR DIAPERS AT ALL TIMES.
7. CHILDREN UNDER 12 MUST WEAR DIAPERS AT ALL TIMES.
8. CHILDREN UNDER 12 MUST WEAR DIAPERS AT ALL TIMES.
9. CHILDREN UNDER 12 MUST WEAR DIAPERS AT ALL TIMES.
10. CHILDREN UNDER 12 MUST WEAR DIAPERS AT ALL TIMES.
11. CHILDREN UNDER 12 MUST WEAR DIAPERS AT ALL TIMES.
12. CHILDREN UNDER 12 MUST WEAR DIAPERS AT ALL TIMES.
13. CHILDREN UNDER 12 MUST WEAR DIAPERS AT ALL TIMES.
14. CHILDREN UNDER 12 MUST WEAR DIAPERS AT ALL TIMES.
15. CHILDREN UNDER 12 MUST WEAR DIAPERS AT ALL TIMES.
16. CHILDREN UNDER 12 MUST WEAR DIAPERS AT ALL TIMES.
17. CHILDREN UNDER 12 MUST WEAR DIAPERS AT ALL TIMES.
18. CHILDREN UNDER 12 MUST WEAR DIAPERS AT ALL TIMES.
19. CHILDREN UNDER 12 MUST WEAR DIAPERS AT ALL TIMES.
20. CHILDREN UNDER 12 MUST WEAR DIAPERS AT ALL TIMES.

C: POOL PLANTER
 Racquet Club Garden Villas





Garden Villas at the Racquet Club
POOL RULES

1. SWIMMING & HOT TUB RULES ARE FROM 8:00 AM TO 6:00 PM.
2. SWIMMING POOL & HOT TUB ARE FOR THE USE OF RESIDENTS ONLY.
3. ALL GUESTS MUST BE ACCOMPANIED BY A RESIDENT ADULT AT ALL TIMES.
4. CHILDREN UNDER 12 MUST BE SUPERVISED BY AN ADULT AT ALL TIMES.
5. CHILDREN UNDER 12 MUST NOT BE PERMITTED IN HOT TUBS.
6. CHILDREN UNDER 12 MUST NOT BE PERMITTED IN HOT TUBS.
7. CHILDREN UNDER 12 MUST NOT BE PERMITTED IN HOT TUBS.
8. CHILDREN UNDER 12 MUST NOT BE PERMITTED IN HOT TUBS.
9. CHILDREN UNDER 12 MUST NOT BE PERMITTED IN HOT TUBS.
10. CHILDREN UNDER 12 MUST NOT BE PERMITTED IN HOT TUBS.
11. CHILDREN UNDER 12 MUST NOT BE PERMITTED IN HOT TUBS.
12. CHILDREN UNDER 12 MUST NOT BE PERMITTED IN HOT TUBS.
13. CHILDREN UNDER 12 MUST NOT BE PERMITTED IN HOT TUBS.
14. CHILDREN UNDER 12 MUST NOT BE PERMITTED IN HOT TUBS.

C: POOL PLANTER
Racquet Club Garden Villas





D: POOL EQ. FRONTAGE
Racquet Club Garden Villas





D: POOL EQ. FRONTAGE
Racquet Club Garden Villas





E: POOL LAWN AREA
Racquet Club Garden Villas





E: POOL LAWN AREA
Racquet Club Garden Villas

