



ARCHITECTURAL REVIEW COMMITTEE MEMORANDUM

DATE: September 18, 2023

CONSENT

SUBJECT: A REQUEST BY TREE DISPENSARY FOR APPROVAL OF A SIGN PERMIT FOR TWO WALL SIGNS ON AN EXISTING BUILDING AND A DIRECTIONAL SIGN LOCATED AT 63758 ORR WAY, ZONE M-2. (CASE SNP-2023-0049) (AR).

FROM: Department of Planning Services

PROJECT DESCRIPTION:

Review the design of two proposed wall signs for an existing cannabis business and a small direction sign, located at 63758 Orr Way. The proposed signs will vary in size; sign 1 will be 22.2-square feet and sign 2 will be 6.25-square feet. The directional sign will be located within a planter in the parking lot area. Business signage for a cannabis dispensary is subject to Section 93.23.15(F)(3)(a) for architectural review.

RECOMMENDATION:

That the Architectural Review Committee approve the application as submitted.

BACKGROUND INFORMATION:

<i>Related Relevant City Actions by Planning, Fire, Building, etc...</i>	
2001	Building constructed.

STAFF ANALYSIS:

<i>Site Area</i>	
Net Acres	.38 Acres

<i>Conformance to Development Standards</i>	
Conformance to Development Standards	The project was analyzed for conformance to development standards as listed in PSZC Section 93.20.05 as part of the sign application (SNP-2023-0049).

ZONING CODE REQUIREMENTS:

Pursuant to Palm Springs Zoning Code Section 92.17.1.01(A)(5) cannabis dispensaries and cannabis lounges are permitted in the M-2 Zone subject to the development standards stated in Palm Springs Zoning Code Section 93.23.15. Section 93.23.15(F)(3)(a) of the PSZC states that any signage for a cannabis facility must be reviewed by the Architectural Review Committee and shall conduct final review for design, size, placement, and materials.

Main Identification Signs		
Allowed	Proposed	Meet Code?
One main sign per street frontage. Within 100 Ft. of R.O.W.: 1 sq ft per lineal foot of frontage (not to exceed 50 SF).	Sign 1- 22.2 SF Sign 2- 6.25 SF Sign 3 – 5.8 SF	Yes
Over 50 feet of lineal frontage: an additional 1 square feet of sign area for each 4 feet of frontage in excess of 50 lineal feet.	Building frontage – 69 Feet.	

SIGN DESIGN:

As mentioned above, the proposed signs will vary in size. Sign 1 will read “TREE DISPENSARY” and will be internally illuminated. Sign 2 will indicate the entrance, and Sign 3 will indicate Vendor and Customer parking area. Signs 2 and 3 will not be illuminated.

Architectural Review Criteria and Findings:

PSZC Section 94.04.00(E) requires the approval authority to evaluate the application and make findings for conformance to the following criteria:

	<i>Criteria and Findings [PSZC 94.04.00(E)]</i>	<i>Compliance</i>
11.	<i>Appropriateness of signage locations and dimensions relative to the building façade(s), or appropriateness of the site location for any freestanding signage, as may be warranted for the development type;</i>	Y
	The proposed signs comply with the PSZC and is the appropriate size. The proposed location on the east elevation, will provide proper wayfinding for customers locating the site.	

CONCLUSION:

Based upon the above criteria, Staff believes that the proposed signs are a simple design placed in an appropriate location and conform to the standards of the PSZC. Staff

recommends approval.

PREPARED BY:	Alex Rubalcava, Assistant Planner
REVIEWED BY:	Edward Robertson, Principal Planner
REVIEWED BY:	Christopher Hadwin, Planning Director

ATTACHMENTS:

1. Vicinity Map
2. Sign Plans



Department of Planning Services Vicinity Map

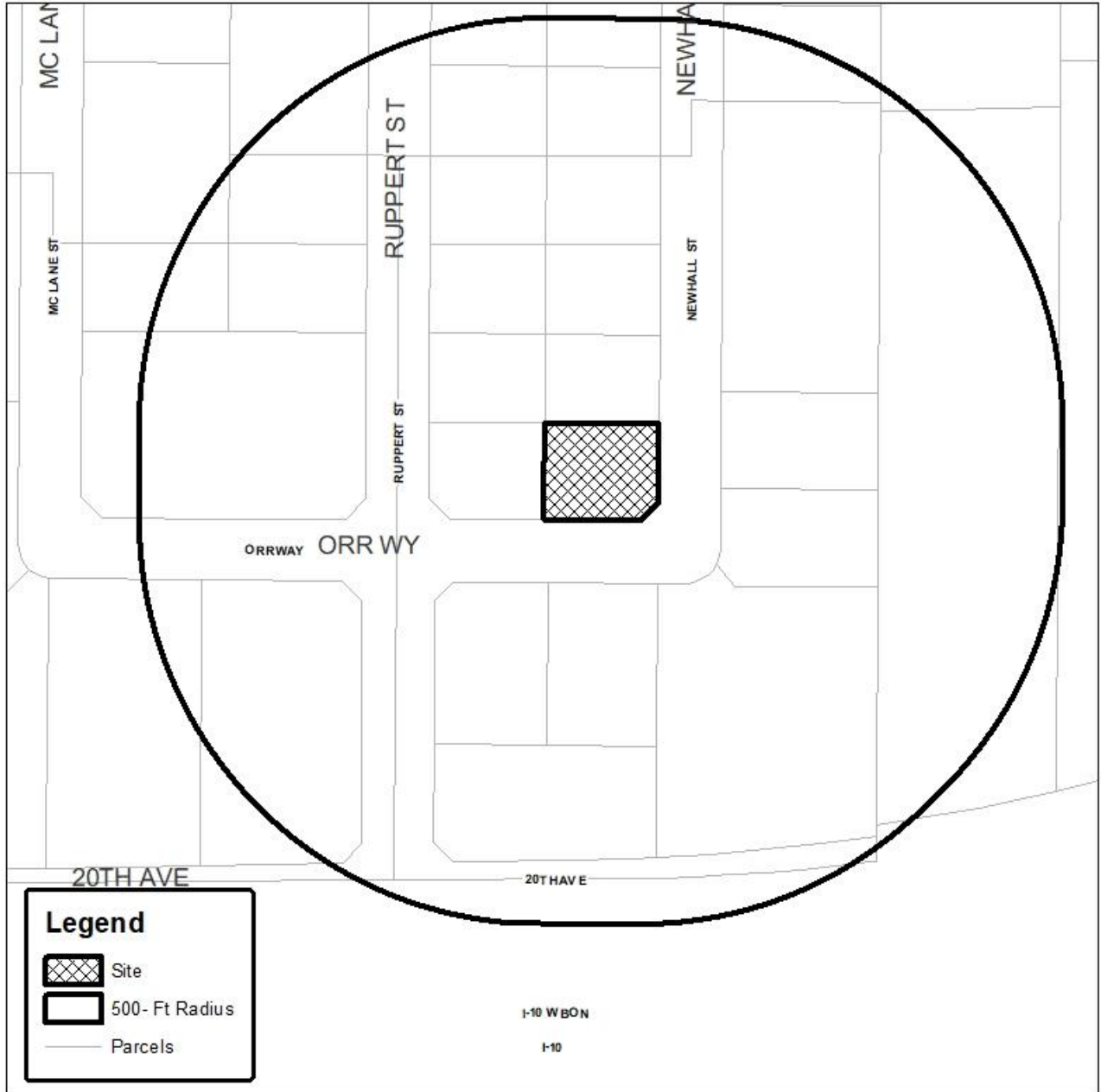

CITY OF PALM SPRINGS
63758 Orr Way



.063 aluminum face

1/2" white acrylic

5" black returns

signs specs

*Internally Illuminated
Acrylic Thickness: 1/2"*

*Aluminum Thickness: .063
Face Color: Black*

Return Color: Black

*Mounting: Back
Standoff: Standoff
LED Color: White
w/ Photocell*

Building Linear Footage 69 ft **Sign SqFt 22.2 Sqft**



night view

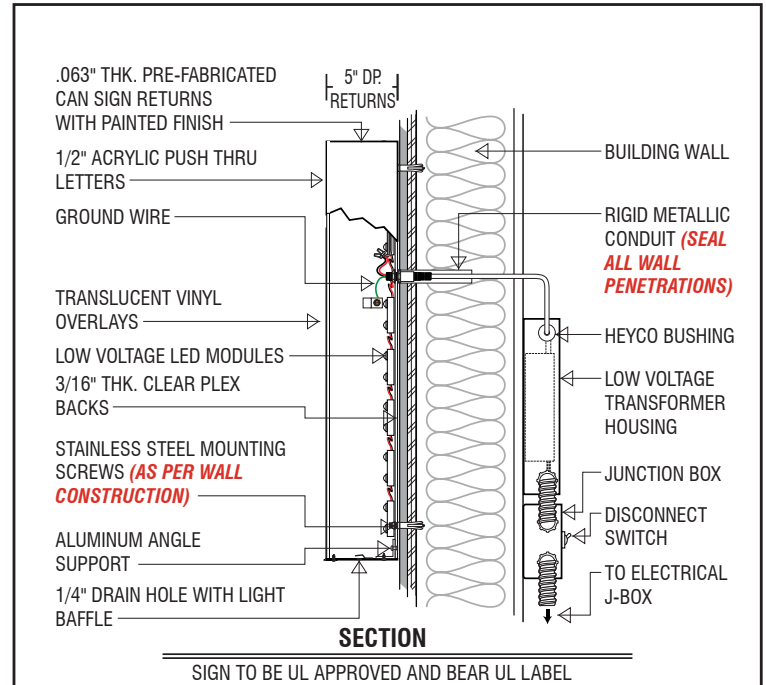

REVERSE PAN CHANNEL LETTERS WITH LED ILLUMINATION
LED Illuminated Diagram

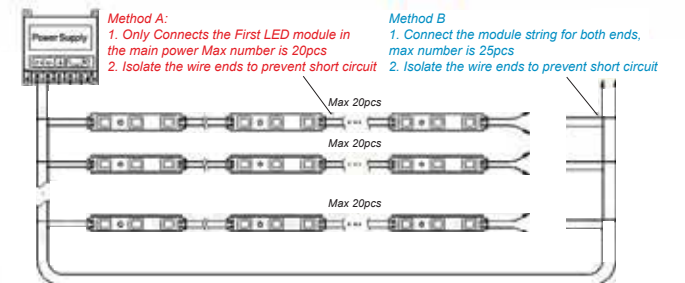

UI Approval Components Consisting Of Low Voltage(12v) LED Modules, With Minimum Light Output Of 120 Lumens/ft.

CANYON
PRINT & SIGNS
67990 E. Palm Canyon Drive
Cathedral City, CA 92234

Business Name:
Tree Dispensary
Business Address:
63758 Orr Way
Palm Springs, CA.
Designer:
GA

Phone :
xxx-xxx-xxxx
Fax:
xxx-xxx-xxxx
Date: 7-24-2023

Unauthorized reproduction in whole or part is strictly prohibited unless there is exclusive permission by authorized agents from Canyon Print and Signs. Copyrighted, trademarked, registered material are the responsibility of purchasing agent, Canyon Print and Signs cannot be held liable for use of said logos or content. Client agrees that colors are approximate. Not all Pantone or PMS colors can be exactly duplicated with digital CMYK four color printing. Variations may occur from digital proof to hard copy or final printed product. We will do our best to match any specific color requests. If specific Pantone colors need to be printed please notify us ahead of time so we can do our best to print proofs and/or arrange for possible different printing methods. Additional charges may apply.

Client Approval

Landlord Approval **A1**

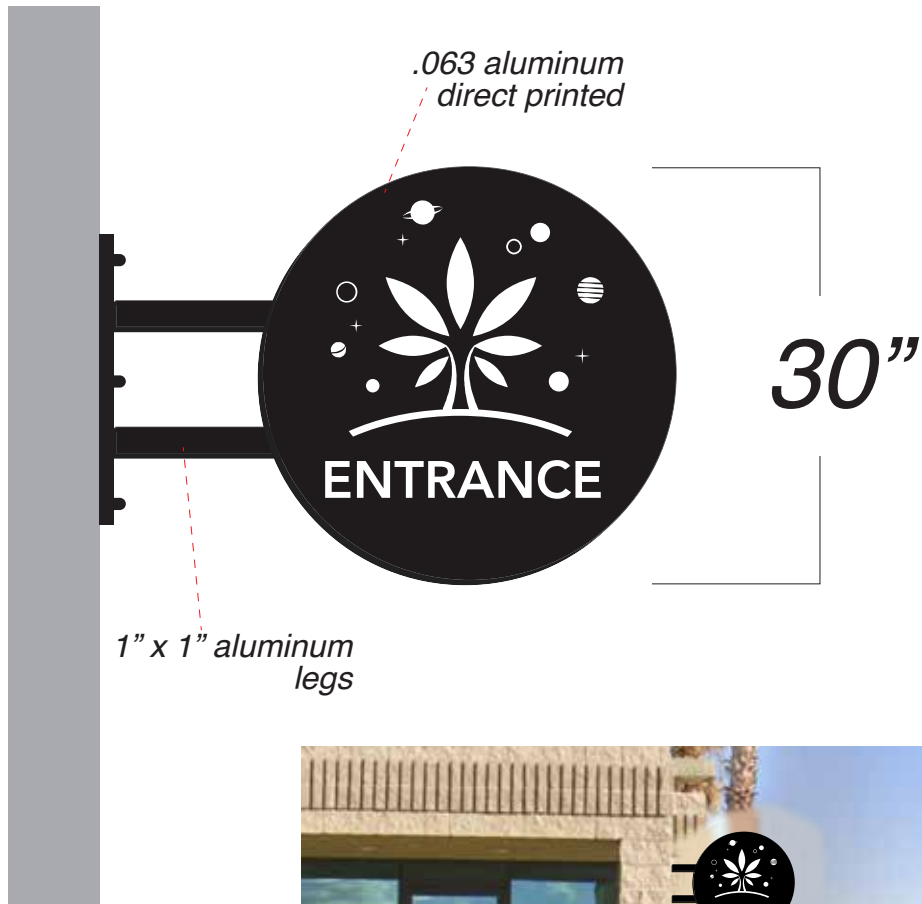

signs specs

Non Illuminated

Aluminum Thickness: .063

Face Color: Black

Return Color: Black

Mounting: 1"x1" Aluminum legs

Standoff:



Building Linear Footage

69 ft

Sign SqFt

6.25 Sqft

CANYON
PRINT & SIGNS
67990 E. Palm Canyon Drive
Cathedral City, CA 92234

Business Name:
Tree Dispensary

Business Address:
63758 Orr Way
Palm Springs, CA.

Designer:
GA

Phone :
xxx-xxx-xxxx

Fax:
xxx-xxx-xxxx

Date: 7-24-2023

Unauthorized reproduction in whole or part is strictly prohibited unless there is exclusive permission by authorized agents from Canyon Print and Signs. Copyrighted, trademarked, registered material are the responsibility of purchasing agent, Canyon Print and Signs cannot be held liable for use of said logos or content. Client agrees that colors are approximate. Not all Pantone or PMS colors can be exactly duplicated with digital CMYK four color printing. Variations may occur from digital proof to hard copy or final printed product. We will do our best to match any specific color requests. If specific Pantone colors need to be printed please notify us ahead of time so we can do our best to print proofs and/or arrange for possible different printing methods. Additional charges may apply.

Client Approval

Landlord Approval

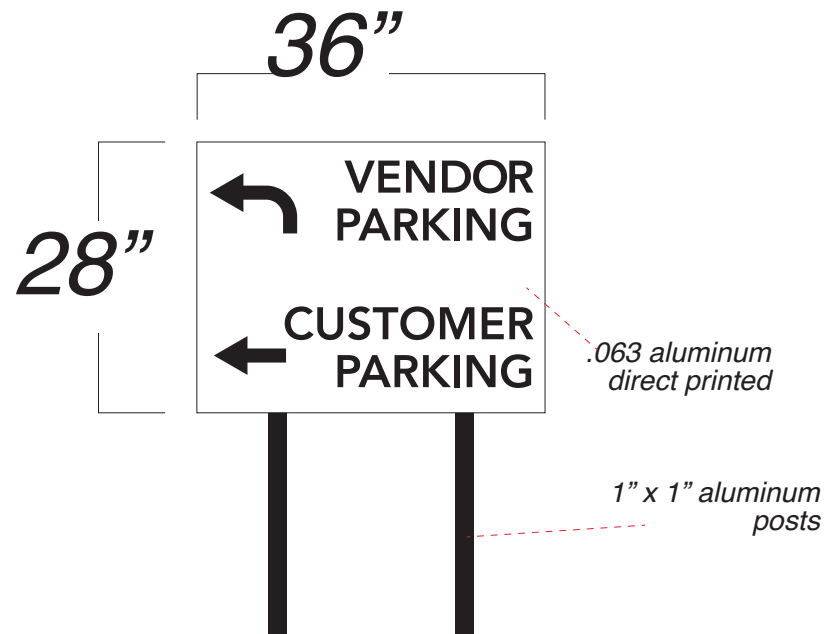

signs specs

Aluminum Thickness: .063
Face Color: White